

S1

KINGS CROSS CENTRAL

Applied Landscape Design

Materials Tracker to Discharge:

Planning Application ref.: 2017/5204/P

Reserved matter condition 2C, 2D

Building S1, Kings Cross Central

ALD Project Ref: 829/19

Document Ref: ALD829_RP901

Document Revision: P01

Current Issue Date: 04.07.2019

ALD working date: 04.07.2019

Reason For Issue: PLANNING

Prepared By: Applied Landscape Design Ltd
Landscape Architect

Client: ARGENT(KCCGLP)



INTRODUCTION





This document has been prepared to discharge the following planning conditions as highlighted below:



Application Ref. 2017/5204/P - S1 Kings Cross

CONDITION	DETAILS OF CONDITION	NOTES
2	Prior to commencement of the relevant part of the development hereby approved, the following details shall be submitted to and approved in writing by the Local Planning Authority:	
2A	Details including sample panels of all external materials and finishes. The material under this condition shall be displayed in the form of a samples board to be retained on site for the duration of the relevant works	Not covered within this document
2B	Detailed drawings of all windows and external doors.	Not covered within this document
2C	Details including samples panel of typical paving, setts and other hard landscape surface treatments. The samples to demonstrate all materials and typical variations of pattern relationships within those materials	Information included within this document
2D	Details of all soft landscaping within the public realm	Information included within this document, refer to accompanying plan MP005
2E	Details of landscaping features and plant species to be incorporated within the roof terraces .	Not covered within this document
2F	Details of lighting within the public realm, to include location, design, specification, fittings and fixtures Thereafter the relevant part of the works shall be carried out in accordance with the details thus approved.	Not covered within this document

NOTE: Information provided does not cover details relating to roof gardens or terraces (to be submitted separately by others).

PAVING MATERIALS



Material Code	Material Details	Location	Detail drawing number	Supplier	Photo	Location example
NATURAL STONE						
P1	Scoutmoor Sandstone Paving 600-900mm long x 600mm wide x 50mm deep Diamond Sawn Finish	Handyside Street & Canal Reach footpaths	ALD829_LD701	Miller Druck		Handyside Street (R1 Footpaths)
P2	Scoutmoor Sandstone Paving 394mm length x 194mm width x 50mm depth Diamond Sawn finish	North & East side of S1	ALD829_LD702	Miller Druck		Q&R Jellicoe gardens (North of building R1)
P3	Scoutmoor Sandstone Paving 94mm length x 94mm width x 50mm depth Diamond Sawn finish	Along East, South & West Facade of S1	ALD829_LD703 & ALD829_LD733			North & East of P1
P4	Scoutmoor Sandstone Paving 94mm length x 94mm width x 50mm depth Cropped finish	Along East Facade of S1	ALD829_LD703	Miller Druck		North & East of P1

P5	Granite Setts 200mm - 300mm random lengths x 100mm width x 150mm depth Bush Hammered Colour Mix: 10% Smokey Black, 30% Albion Grey, 25% Millennium Mauve, 25% Millennium Pink, 10% Elelanor Red	Canal Reach bus layby	ALD829_LD704	Miller Druck		Stable Street / Sitewide Kings Cross
P6	Crossland Hill sandstone blister tactile paving 400mm long x 400mm wide x 50mm deep	Handyside Street (Pedestrian Crossing)	ALD829_LD705 & LD710	Miller Druck		Handyside Street / Granary Square/ Goods Way



PAVING MATERIALS



Material Code	Material Details	Location	Detail drawing number	Supplier	Photo	Location example
---------------	------------------	----------	-----------------------	----------	-------	------------------

SETTS & GRAVELS

P7	Reclaimed Granite Setts - 'Rough-Top' Band 1: 120-250mm x 80-100mm wide x approx. 100mm deep Band 2: 120-250mm x 101-115mm wide x approx. 100mm deep Band 3: 120-250mm x 116-125mm wide x approx. 100mm deep Sourced from wider Kings Cross Central site (subject to availability or approved source)	South of S1, Handyside street (cycle parking areas)	ALD829_LD722	Miller Druck		Sitewide Kings Cross
P8	Resin bonded gravel (Temporary finish) Trent 3-6mm resin bonded gravel	North East of S1	ALD829_LD706	Addagrip		Cubitt Park

PAVING MATERIALS

Material Code	Material Details	Location	Detail drawing number	Supplier	Photo	Location example
KERBS & EDGES						
E1	Granite Kerb / Edging 1000mm length x 300mm width x 200mm depth Fine Picked Royal White	Road kerbs generally (East, West and South)	ALD832_LD708	Miller Druck		Sitewide Kerbs ie. Stable Street
E2	Steel edging - 10mm thick grade 316 stainless steel edging. Satin polished finish.	North and east of S1	ALD829_LD706	Kent Stainless		North and South of Cubitt square

Material Code	Material Details	Location	Detail drawing number	Supplier	Photo	Location example
STREET FURNITURE						
F1	Sheffield satin polished stainless steel cycle stand 1140mm height (750mm above ground) x 1000mm width x 50mm \varnothing	South of S1	ALD829_LD721	Kent Stainless		Sitewide Kings Cross
F2	Royal White granite chippings 6-10mm	South and West of S1	ALD829_LD722	Miller Druck		Sitewide Treepits



APPENDIX A: S1/ PUBLIC REALM - PAVING TYPICAL DETAILS & LANDSCAPE GENERAL ARRANGEMENT PLAN

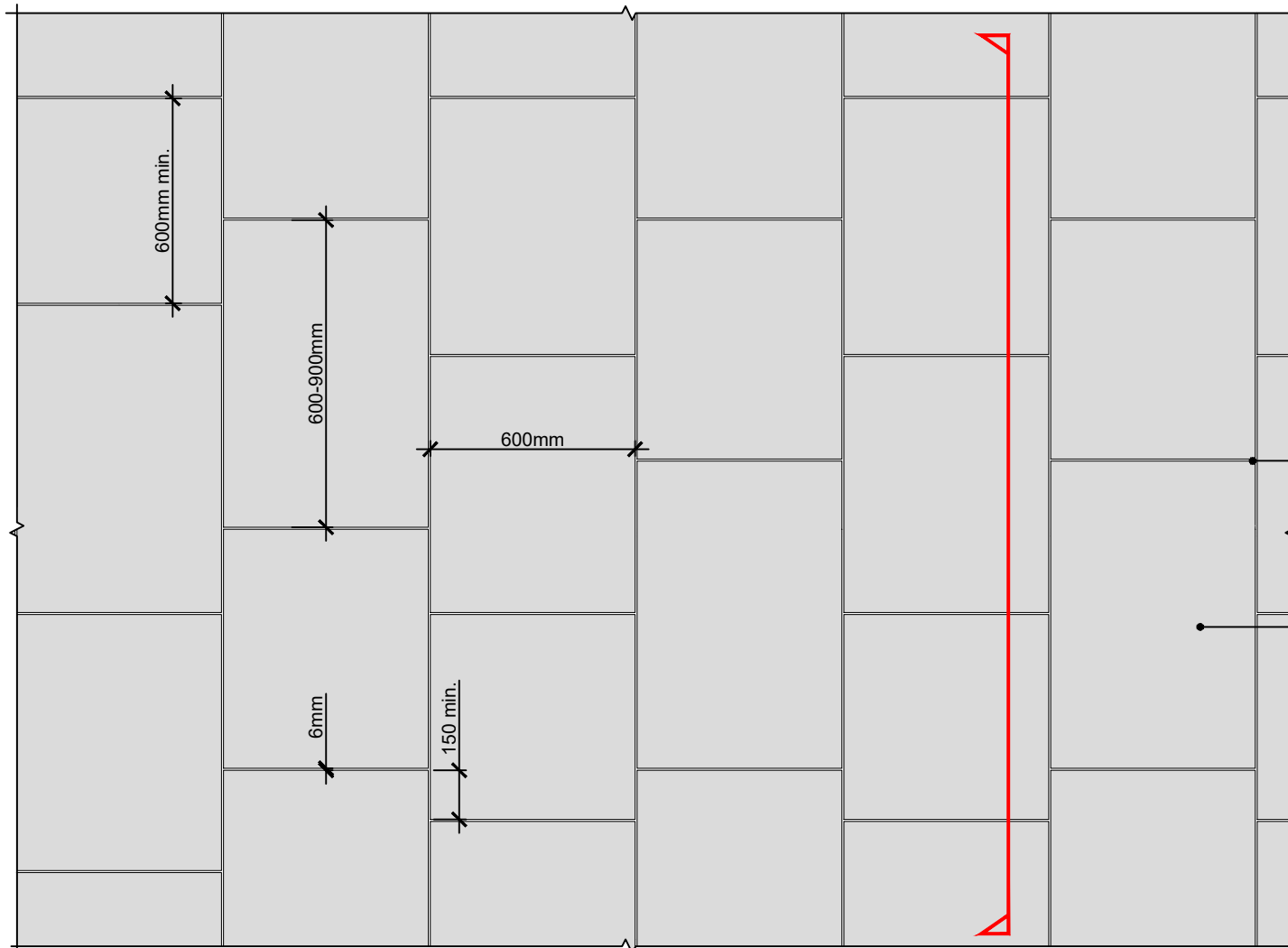

NOTE:

- REFER TO PLAN LAYOUT FOR PAVING SETTING OUT AND CENTRELINE ALIGNMENT.
- WHERE TEMPORARY SCOUTMOOR PAVINGS TO BE INSTALLED, PAVING TO BE LAID ON 40mm SHARP SAND / CEMENT BEDDING (6:1) IN LIEU OF TACTILE PAVING (FUTURE INSTALLATION). PAVING TO BE CUT TO ALIGN WITH FUTURE T2 TACTILES- REFER TO PLAN LAYOUT FOR PRECISE EXTENTS. INSTALLED TO RANDOM PATTERN WITH 6mm SAND JOINTS AND 150mm MIN. UNIT OVERLAP.

6mm TUFFGROUT JOINT COLOURED TO MATCH PAVING BY STEINTEC OR EQUAL & APPROVED

SCOUTMOOR SANDSTONE PAVING -TYPE 1a
DIAMOND SAWN FINISH 600mm WIDE X 600-900mm LENGTHS X 50mm DEEP BY MILLER DRUCK OR EQUAL AND APPROVED.

- MINIMUM OVERLAP BETWEEN PAVING UNITS = 150mm

- MINIMUM PAVING UNIT AT KERB INTERFACE = 300mm.

- WHERE SANDSTONE ABUTS OTHER PAVING, SLOT DRAINS, EDGES OR BUILDING FACADE MINIMUM UNIT LENGTH = 300mm

6mm TUFFGROUT JOINT COLOURED TO MATCH PAVING BY STEINTEC OR EQUAL & APPROVED

SCOUTMOOR SANDSTONE PAVING (TYPE 1a) - DIAMOND SAWN FINISH 600mm WIDE X 600-900mm LENGTHS X 50mm DEEP BY MILLER DRUCK OR EQUAL AND APPROVED.

40mm DEPTH TUFFBED BEDDING MORTAR BY STEINTEC OR EQUAL AND APPROVED

SUB BASE AND PAVING BUILD UP TO PBA DETAIL AND SPECIFICATION.

01a PLAN LAYOUT ON SANDSTONE PAVING -TYPE 1a TO STREETScape FOOTPATH
SCALE: 1:20 @ A3

SCOUTMOOR SANDSTONE PAVING (TYPE 1b) - DIAMOND SAWN FINISH 600mm WIDE X 600-900mm LENGTHS X 50mm DEEP BY MILLER DRUCK OR EQUAL AND APPROVED.

40mm SHARP SAND / CEMENT BEDDING (6:1) TO TEMPORARY SANDSTONE PAVING

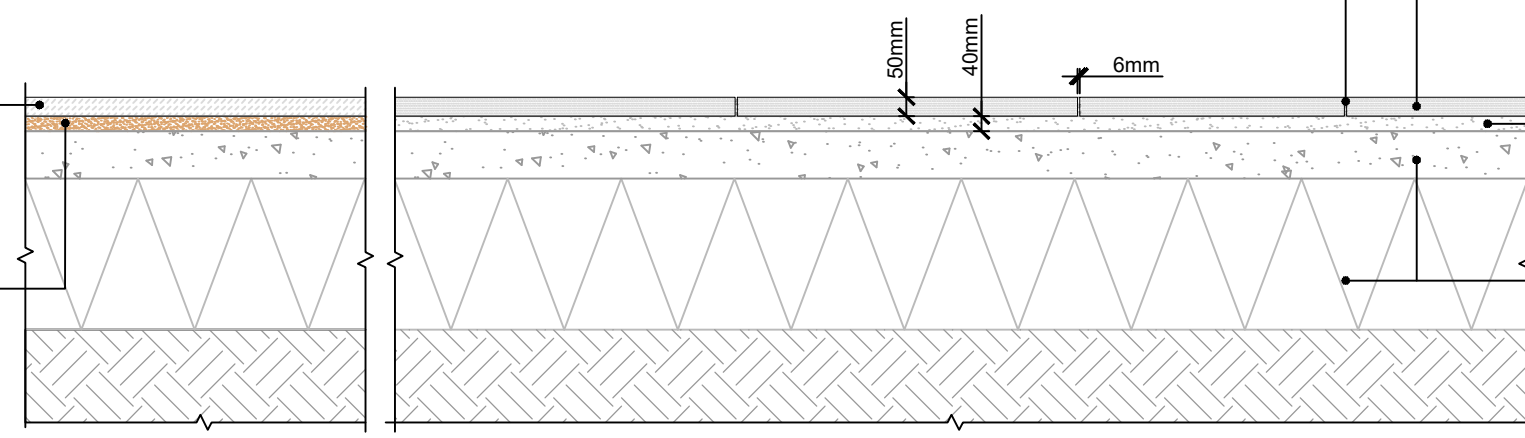

01b SECTION OF SANDSTONE PAVING -TYPE 1a & 1b TO STREETScape FOOTPATH
SCALE: 1:20 @ A3

LANDSCAPE ARCHITECT:



The Threshing Barn
Bignell Park Barns
Chesterton
Oxfordshire
OX26 1TD

Tel: 01869 249776
Fax: 01869 327513
Email: mail@appliedlandscape.co.uk

© 2019 Applied Landscape Design Limited. All rights reserved.

Rev.	Update	Date
P02	STAGE 4 ISSUE: EMPLOYERS REQUIREMENTS	21.06.2019
P01	FIRST ISSUE FOR INFORMATION	15.04.2019

PROJECT:
S1 Public Realm, KXC

CLIENT:
**KING'S CROSS CENTRAL
GENERAL PARTNERS LTD
(KCCGLP)**

drawn: AJ	checked: KmJ
scale: 1:20 @ A3	date: 15.04.2019
status: INFORMATION	xref file ref: ALD829_PR-LDbase

DRAWING TITLE:
**HARDWORKS DETAIL
SANDSTONE PAVING - TYPE 1**

PROJECT NO. 829/19	DRAWING NUMBER: LD701	REVISION: P02
------------------------------	---------------------------------	-------------------------

NOTE:
 WHERE TEMPORARY SCOUTMOOR PAVING IS TO BE INSTALLED, PAVING TO BE LAID ON 25/40mm SHARP SAND / CEMENT BEDDING (6:1) IN LIEU OF PERMANENT PAVING (FUTURE INSTALLATION). PAVING TO BE CUT TO ALIGN WITH PERMANENT SANDSTONE FINISHES ADJACENT - REFER TO PLAN LAYOUT FOR PRECISE EXTENT OF TEMPORARY PAVING. INSTALLED TO APPROVED PATTERN WITH 6mm SAND JOINTS.

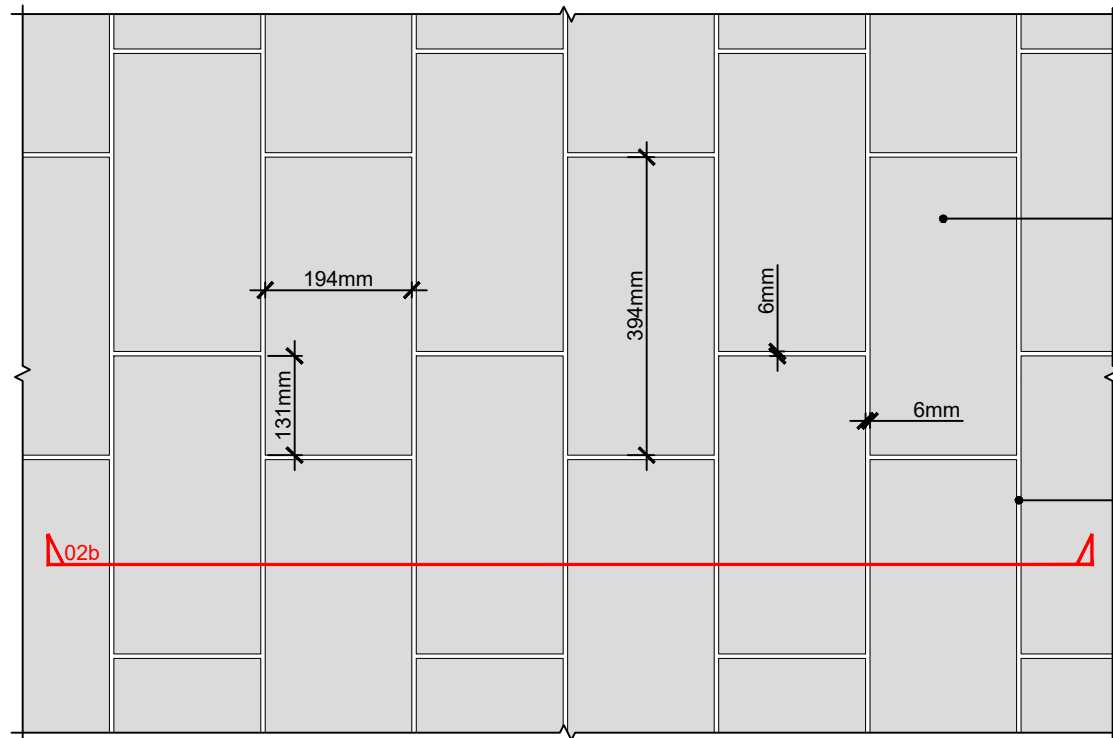

SCOUTMOOR SANDSTONE PAVING -TYPE 2a. DIAMOND SAWN FINISH 194mm WIDE X 394mm LONG X 50mm DEEP BY MILLER DRUCK OR EQUAL AND APPROVED. INSTALLED WITH 6mm JOINTS ON A 1/3 STAGGER PATTERN AS SHOWN.

6mm WIDE 'TUFFGROUT' MORTAR JOINT BY STEINTEC OR EQUAL.

02a PLAN LAYOUT ON SANDSTONE PAVING - TYPE 2a
 SCALE: 1:10 @ A3

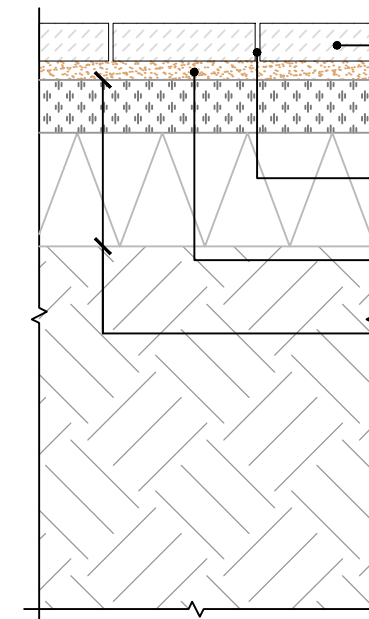

DIAMOND SAWN SCOUTMOOR (TYPE 2b) OR EQUAL AND APPROVED SANDSTONE PAVING. 194mm WIDE X 394mm LONG X 50mm DEEP.

6mm SAND JOINTS TO TEMPORARY SANDSTONE PAVING.

25mm DEEP SHARP SAND /CEMENT BEDDING (6:1)

SUB BASE AND PAVING BUILD UP TO PBA DETAIL AND SPECIFICATION

02c SECTION THROUGH SANDSTONE PAVING - 2b NORTH OF BUILDING S1 AT SITE BOUNDARY
 SCALE: 1:10 @ A3

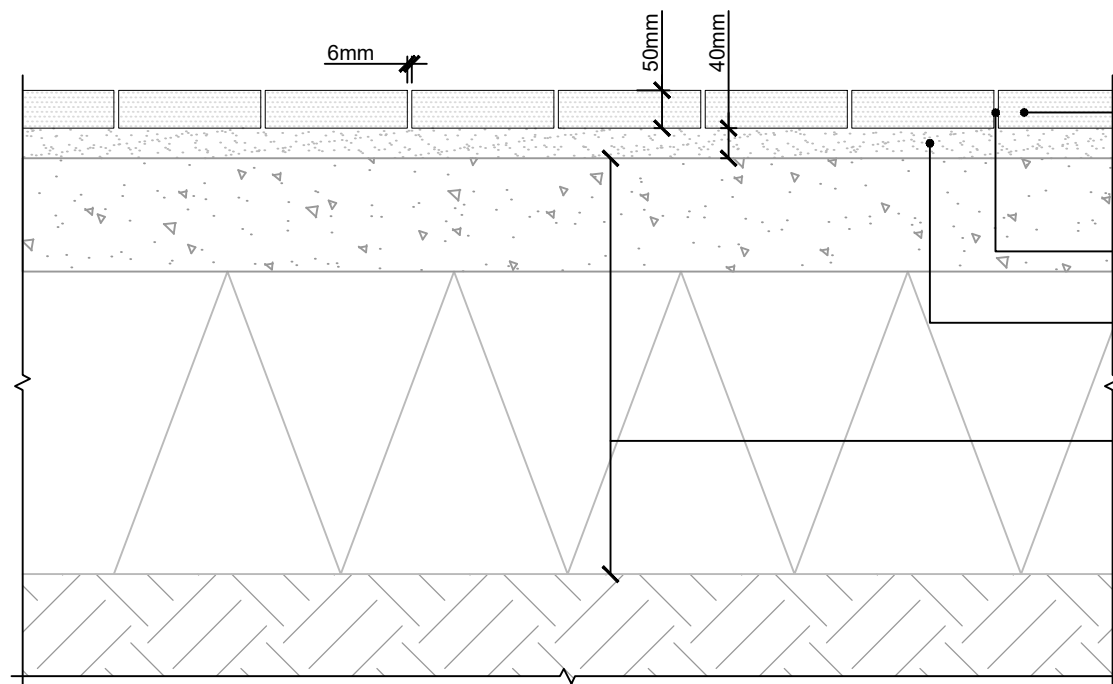

SCOUTMOOR SANDSTONE PAVING -TYPE 2a. DIAMOND SAWN FINISH 194mm WIDE X 394mm LONG X 50mm DEEP BY MILLER DRUCK OR EQUAL AND APPROVED.

6mm WIDE 'TUFFGROUT' MORTAR JOINT BY STEINTEC OR EQUAL.

40mm DEPTH TUFFBED BEDDING MORTAR BY STEINTEC OR EQUAL AND APPROVED

SUB BASE AND PAVING BUILD UP TO PBA DETAIL AND SPECIFICATION

02b SECTION THROUGH SANDSTONE PAVING -TYPE 2a
 SCALE: 1:10 @ A3

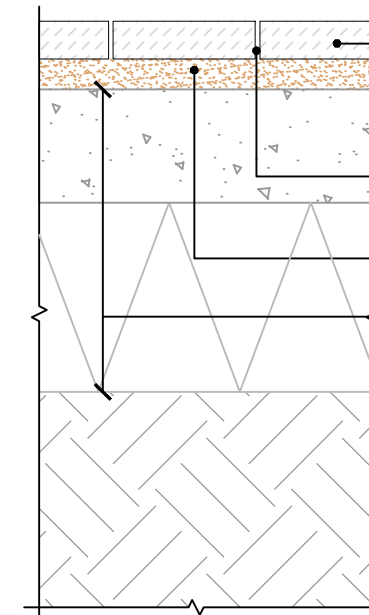

DIAMOND SAWN SCOUTMOOR (TYPE 2b) OR EQUAL AND APPROVED SANDSTONE PAVING. 194mm WIDE X 394mm LONG X 50mm DEEP.

6mm SAND JOINTS TO TEMPORARY SANDSTONE PAVING.

40mm SHARP SAND /CEMENT BEDDING (6:1)

SUB BASE AND PAVING BUILD UP TO PBA DETAIL AND SPECIFICATION

02d SECTION THROUGH SANDSTONE PAVING -TYPE 2b NORTH EAST OF BUILDING S1 AT ENTRANCE DOOR RECESS
 SCALE: 1:10 @ A3

LANDSCAPE ARCHITECT:



The Threshing Barn
 Bignell Park Barns
 Chesterton
 Oxfordshire
 OX26 1TD

Tel: 01869 249776
 Fax: 01869 327513
 Email: mail@appliedlandscape.co.uk

© 2019 Applied Landscape Design Limited. All rights reserved.

Rev.	Update	Date
P02	STAGE 4 ISSUE: EMPLOYERS REQUIREMENTS	21.06.2019
P01	FIRST ISSUE FOR INFORMATION	15.04.2019

PROJECT:
S1 Public Realm, KXC

CLIENT:
KING'S CROSS CENTRAL GENERAL PARTNERS LTD (KCCGLP)

drawn: AJ	checked: KmJ
scale: 1:10 @ A3	date: 15.04.2019
status: INFORMATION	xref file ref: ALD829_PR-LDbase

DRAWING TITLE:
HARDWORKS DETAIL SANDSTONE PAVING - TYPE 2

PROJECT NO. 829/19	DRAWING NUMBER: LD702	REVISION: P02
------------------------------	---------------------------------	-------------------------

6mm WIDE 'TUFFGROUT' MORTAR JOINT BY STEINTEC OR EQUAL AND APPROVED.

CROSSLAND HILL SANDSTONE MILLED BLISTER TACTILE PAVING BY MILLER DRUCK OR EQUAL AND APPROVED. 400mm WIDE X 400mm LONG X 50mm DEEP. INSTALLED WITH 6mm JOINTS IN A STACK BOND AS SHOWN.
NOTE: ADJACENT SANDSTONE PAVING TYPE 2a TO BE WHOLE FULL WIDTH ROW

SCOUTMOOR SANDSTONE PAVING -TYPE 3b. CROPPED FINISH 94mm WIDE X 94mm LONG X 50mm DEEP BY MILLER DRUCK OR EQUAL AND APPROVED. INSTALLED STACK BOND PATTERN WITH 6mm JOINTS AS SHOWN.
NOTE: WHOLE UNIT TO ADJACENT PAVING, NO CUTS PERMITTED

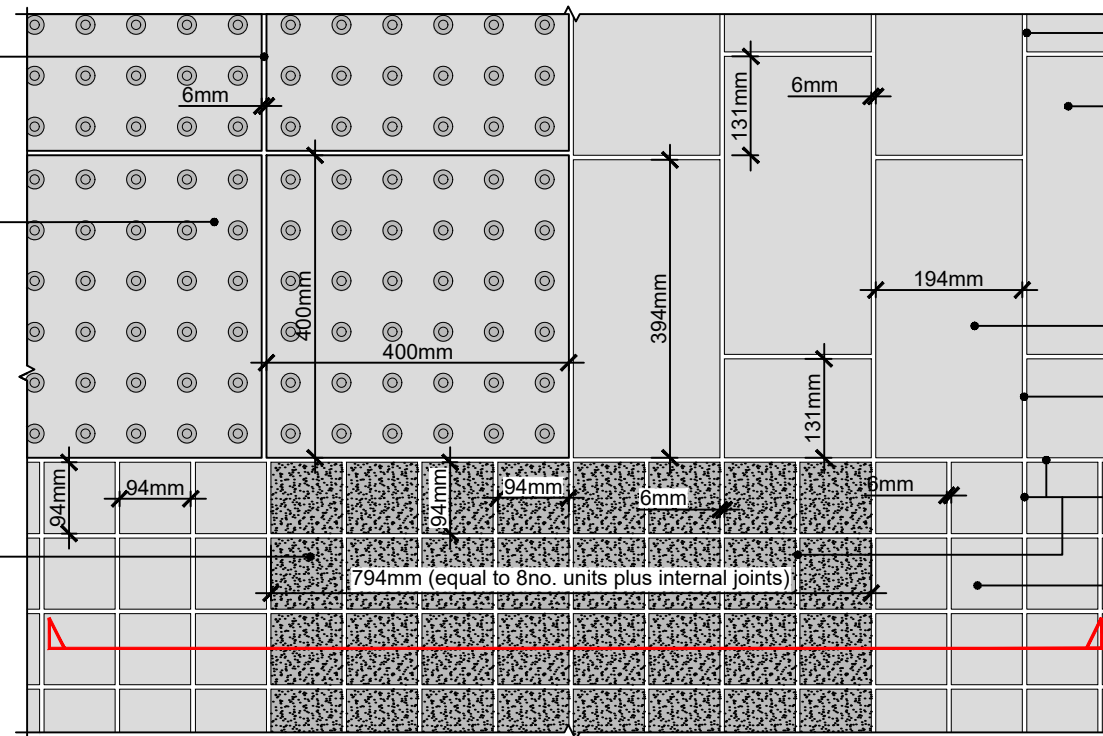

6mm WIDE 'TUFFGROUT' MORTAR JOINT BY STEINTEC OR EQUAL AND APPROVED.

SCOUTMOOR SANDSTONE PAVING -TYPE 2a. DIAMOND SAWN FINISH 194mm WIDE X 394mm LONG X 50mm DEEP BY MILLER DRUCK OR EQUAL AND APPROVED. INSTALLED WITH 6mm JOINTS ON A 1/3 STAGGER PATTERN AS SHOWN.

FULL LENGTH UNIT AT INTERFACE WITH SETTS.

JOINT OF SANDSTONE PAVERS TO ALIGN WITH EVERY SECOND JOINT OF SANDSTONE SETTS AS SHOWN.

6mm WIDE 'TUFFGROUT' MORTAR JOINT BY STEINTEC OR EQUAL AND APPROVED.

SCOUTMOOR SANDSTONE PAVING -TYPE 3a. DIAMOND SAWN FINISH 94mm WIDE X 94mm LONG X 50mm DEEP BY MILLER DRUCK OR EQUAL AND APPROVED. INSTALLED STACK BOND PATTERN WITH 6mm JOINTS AS SHOWN.
NOTE: WHOLE UNIT TO ADJACENT PAVING, NO CUTS PERMITTED.

03a PLAN LAYOUT ON SANDSTONE PAVING TYPE 3b & 3b
SCALE: 1:10 @ A3

SCOUTMOOR SANDSTONE PAVING -TYPE 3b. CROPPED FINISH 94mm WIDE X 94mm LONG X 50mm DEEP BY MILLER DRUCK OR EQUAL AND APPROVED.

40mm DEPTH TUFFBED BEDDING MORTAR BY STEINTEC OR EQUAL AND APPROVED

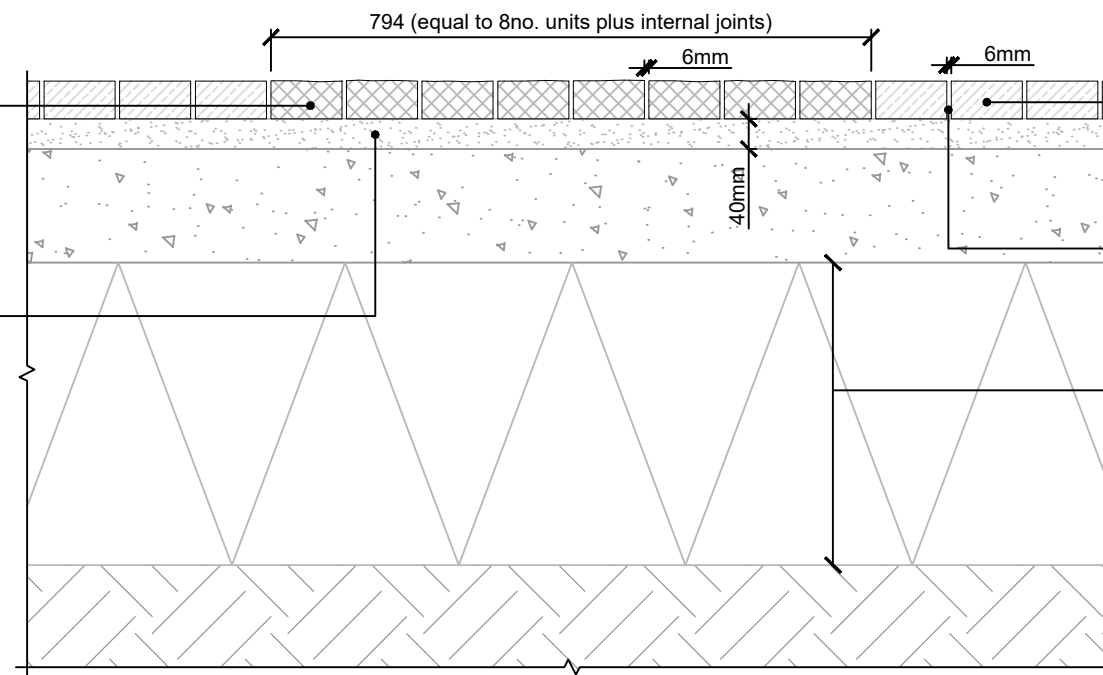

SCOUTMOOR SANDSTONE PAVING -TYPE 3a. DIAMOND SAWN FINISH 94mm WIDE X 94mm LONG X 50mm DEEP BY MILLER DRUCK OR EQUAL AND APPROVED.

6mm WIDE 'TUFFGROUT' MORTAR JOINT BY STEINTEC OR EQUAL.

SUB BASE AND PAVING BUILD UP TO PBA DETAIL AND SPECIFICATION

03a SECTION THROUGH SANDSTONE PAVING TYPE 3b & 3b
SCALE: 1:10 @ A3

LANDSCAPE ARCHITECT:



The Threshing Barn
Bignell Park Barns
Chesterton
Oxfordshire
OX26 1TD

Tel: 01869 249776
Fax: 01869 327513
Email: mail@appliedlandscape.co.uk

© 2019 Applied Landscape Design Limited. All rights reserved.

Rev.	Update	Date
P02	STAGE 4 ISSUE: EMPLOYERS REQUIREMENTS	21.06.2019
P01	FIRST ISSUE FOR INFORMATION	15.04.19

PROJECT:
S1 Public Realm, KXC

CLIENT:
**KING'S CROSS CENTRAL
GENERAL PARTNERS LTD
(KCCGLP)**

drawn: AJ	checked: KmJ
scale: 1:10 @ A3	date: 15.04.2019
status: INFORMATION	xref file ref: ALD829_PR-LDbase

DRAWING TITLE:
**HARDWORKS DETAIL
SANDSTONE PAVING - TYPE 3**

PROJECT NO. 829/19	DRAWING NUMBER: LD703	REVISION: P02
------------------------------	---------------------------------	-------------------------

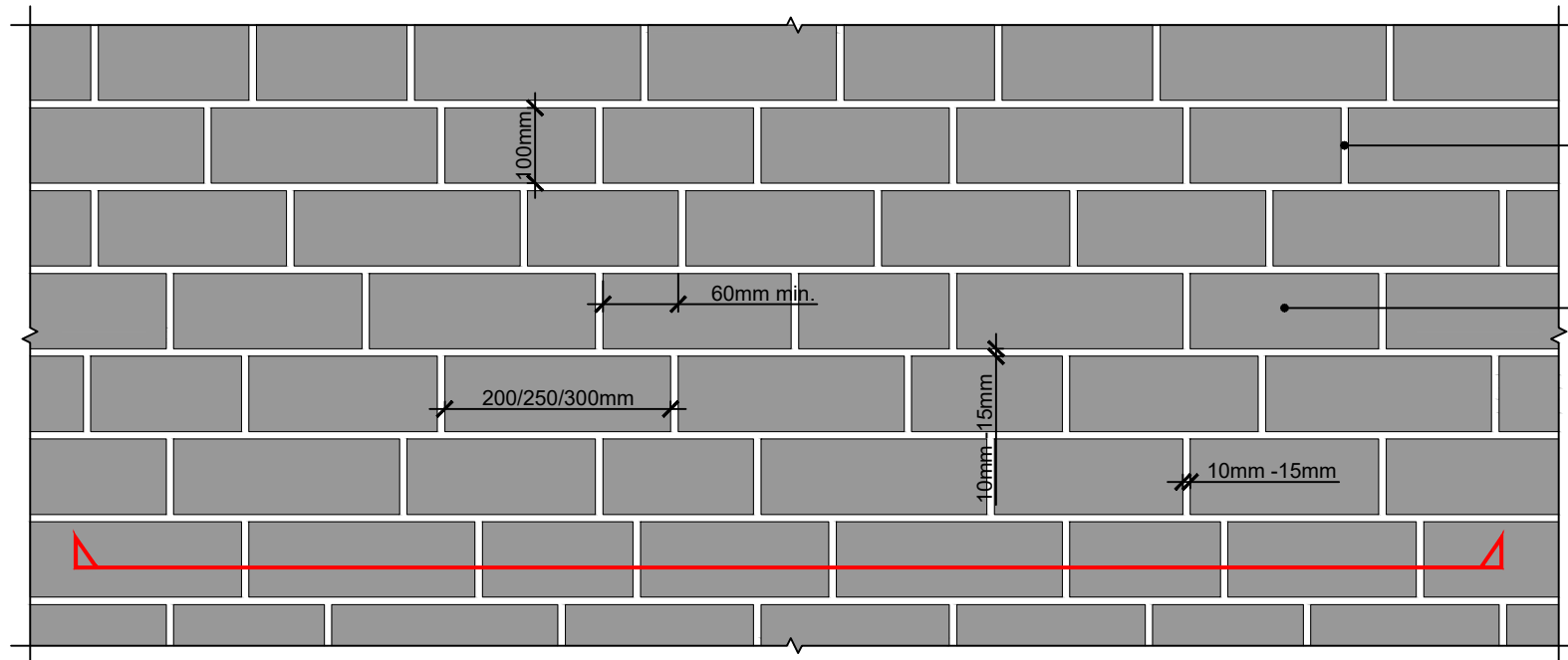

10-15mm TUFFGROUT JOINT COLOURED TO MATCH PAVING BY STEINTEC OR EQUAL & APPROVED

GRANITE SETTS - FINE PICKED
100mm WIDE x 200/250/300mm LONG x 150mm DEEP
LAID IN RANDOM PATTERN BY MILLER DRUCK OR EQUAL AND APPROVED.

COLOUR MIX : ALBION GREY (30%)
MILLENNIUM MAUVE (25%)
MILLENNIUM PINK (25%)
ELEANOR RED (10%)
SMOKEY BLACK (10%)

MINIMUM UNIT LENGTH AT INTERFACE WITH OTHER PAVING & EDGES = 100mm.

04a PLAN LAYOUT ON GRANITE SETTS TO BUS LAYBY AND LOADING BAY ENTRANCE
SCALE: 1:10 @ A3

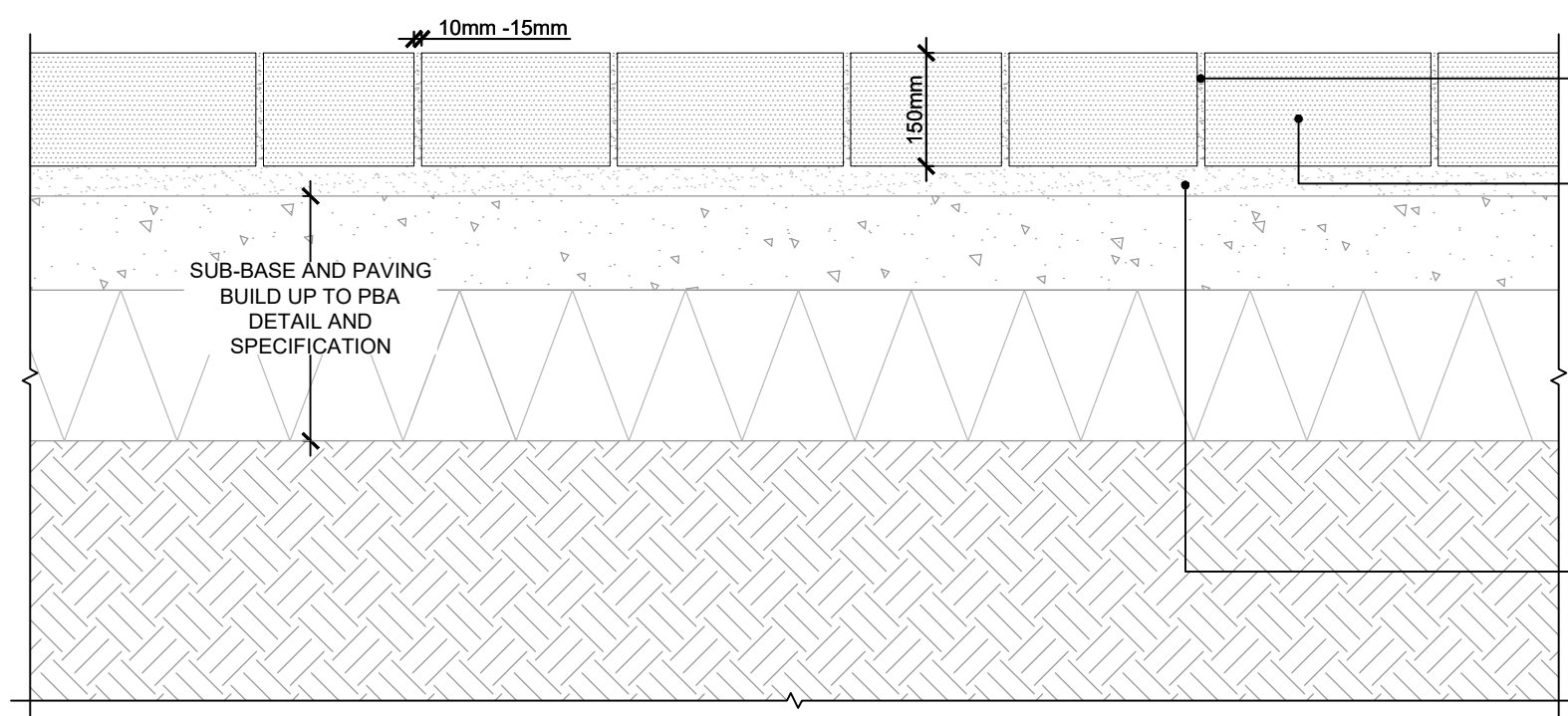

10-15mm TUFFGROUT JOINT COLOURED TO MATCH PAVING BY STEINTEC OR EQUAL & APPROVED

GRANITE SETTS TYPE 1 - FINE PICKED
100mm WIDE x 200/250/300mm LONG x 150mm DEEP
LAID IN RANDOM PATTERN BY MILLER DRUCK OR EQUAL AND APPROVED.

COLOUR MIX : ALBION GREY (30%)
MILLENNIUM MAUVE (25%)
MILLENNIUM PINK (25%)
ELEANOR RED (10%)
SMOKEY BLACK (10%)

MINIMUM UNIT LENGTH AT INTERFACE WITH OTHER PAVING = 100mm. (ADJACENT PAVING VARIES)

40mm DEPTH TUFFBED BEDDING MORTAR BY STEINTEC OR EQUAL AND APPROVED

04b SECTION THROUGH GRANITE SETTS TO BUS LAYBY AND LOADING BAY ENTRANCE
SCALE: 1:10 @ A3

LANDSCAPE ARCHITECT:



The Threshing Barn
Bignell Park Barns
Chesterton
Oxfordshire
OX26 1TD

Tel: 01869 249776
Fax: 01869 327513
Email: mail@appliedlandscape.co.uk

© 2019 Applied Landscape Design Limited. All rights reserved.

Rev.	Update	Date
P02	STAGE 4 ISSUE: EMPLOYERS REQUIREMENTS	21.06.2019
P01	FIRST ISSUE FOR INFORMATION	15.04.2019

PROJECT:
S1 Public Realm, KXC

CLIENT:
**KING'S CROSS CENTRAL
GENERAL PARTNERS LTD
(KCCGLP)**

drawn: AJ	checked: KmJ
scale: 1:10 @ A3	date: 15.04.2019
status: INFORMATION	xref file ref: ALD829_PR-LDbase

DRAWING TITLE:
**HARDWORKS DETAIL
- GRANITE SETT PAVING**

PROJECT NO. 829/19	DRAWING NUMBER: LD704	REVISION: P02
------------------------------	---------------------------------	-------------------------

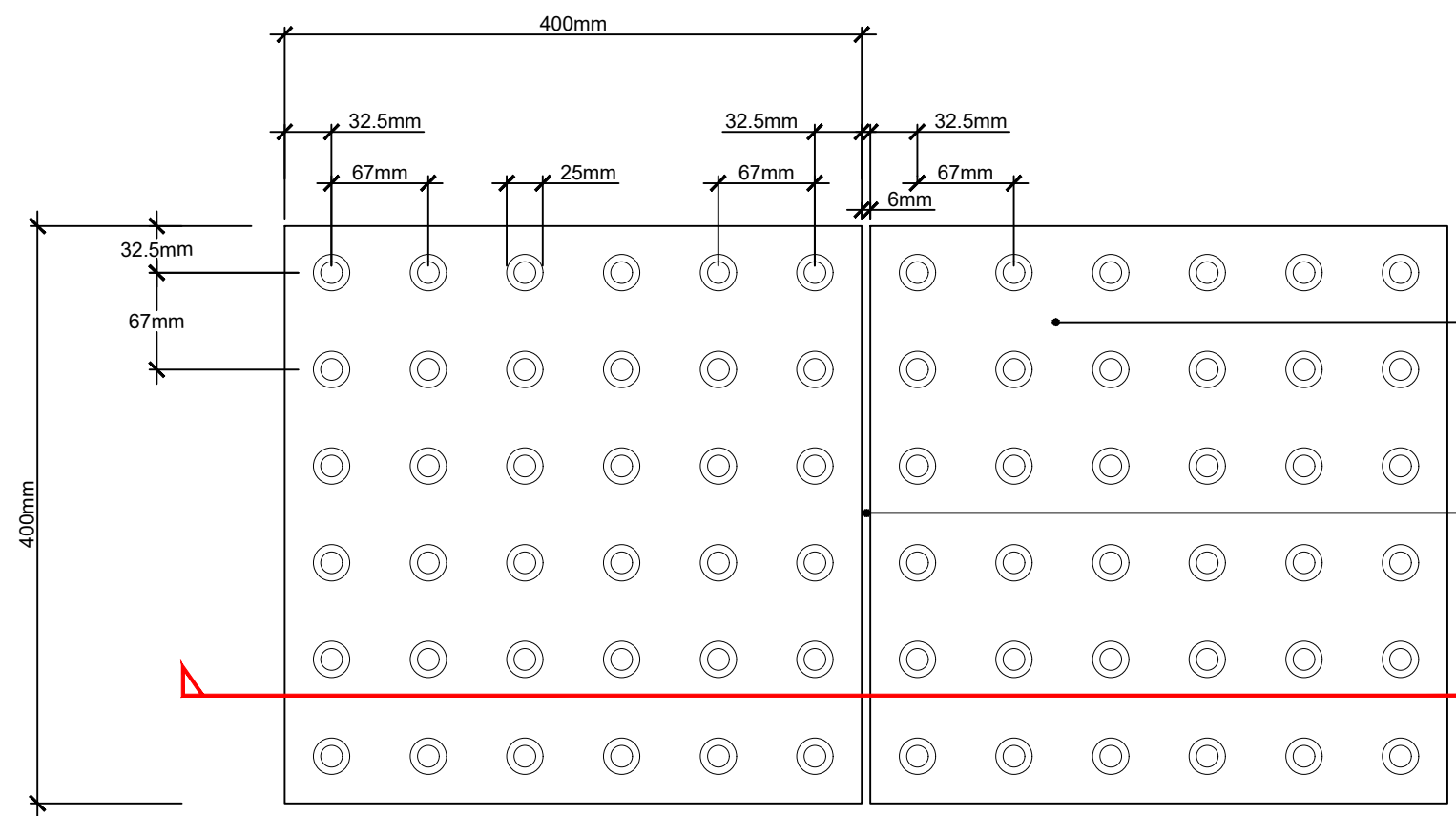

NOTE:
 TACTILE UNITS TO THE HANDYSIDE CROSSING POINT ARE TO BE LAID BUTT JOINTED- REFER TO ALD DRAWING ALD829_MP001 FOR LOCATION & ALD829_LD711 FOR SECTION DETAIL.

LENGTH 400mm x 400mm WIDTH x 50mm DEPTH.
 (75mm DEPTH IN TRAFFICABLE AREAS).
 UNCONTROLLED CROSSINGS - CROSSLAND HILL
 SANDSTONE MILLED BLISTER TACTILE PAVING.
 BY MILLER DRUCK OR EQUAL AND APPROVED

6mm TUFFGROUT JOINT COLOURED TO MATCH PAVING
 BY STEINTEC OR EQUAL AND APPROVED

05a PLAN LAYOUT OF TACTILE PAVING
 SCALE 1:5 @ A3

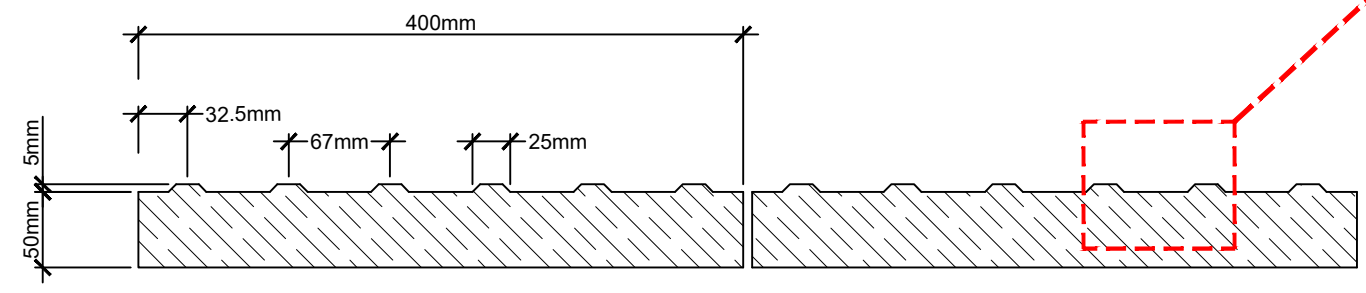
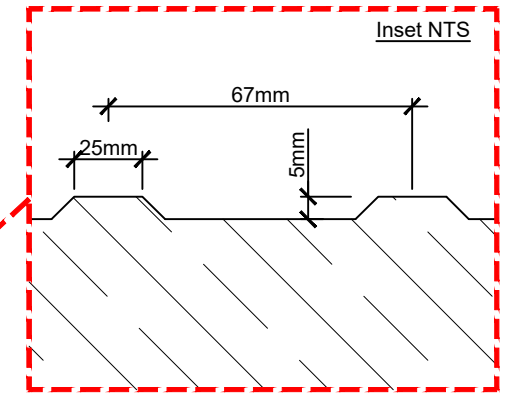

05b SECTION THROUGH TACTILE PAVING
 SCALE 1:5 @ A3

LANDSCAPE ARCHITECT:



The Threshing Barn
 Bignell Park Barns
 Chesterton
 Oxfordshire
 OX26 1TD

Tel: 01869 249776
 Fax: 01869 327513
 Email: mail@appliedlandscape.co.uk

© 2019 Applied Landscape Design Limited. All rights reserved.

Rev.	Update	Date
P02	STAGE 4 ISSUE: EMPLOYERS REQUIREMENTS	21.06.2019
P01	FIRST ISSUE FOR INFORMATION	15.04.2019

PROJECT:
S1 Public Realm, KXC

CLIENT:
**KING'S CROSS CENTRAL
 GENERAL PARTNERS LTD
 (KCCGLP)**

drawn: AJ	checked: KmJ
scale: 1:5 @ A3	date: 15.04.2019
status: INFORMATION	xref file ref: ALD829_PR-LDbase

DRAWING TITLE:
**HARDWORKS DETAIL
 - TACTILE PAVING**

PROJECT NO. 829/19	DRAWING NUMBER: LD705	REVISION: P02
------------------------------	---------------------------------	-------------------------

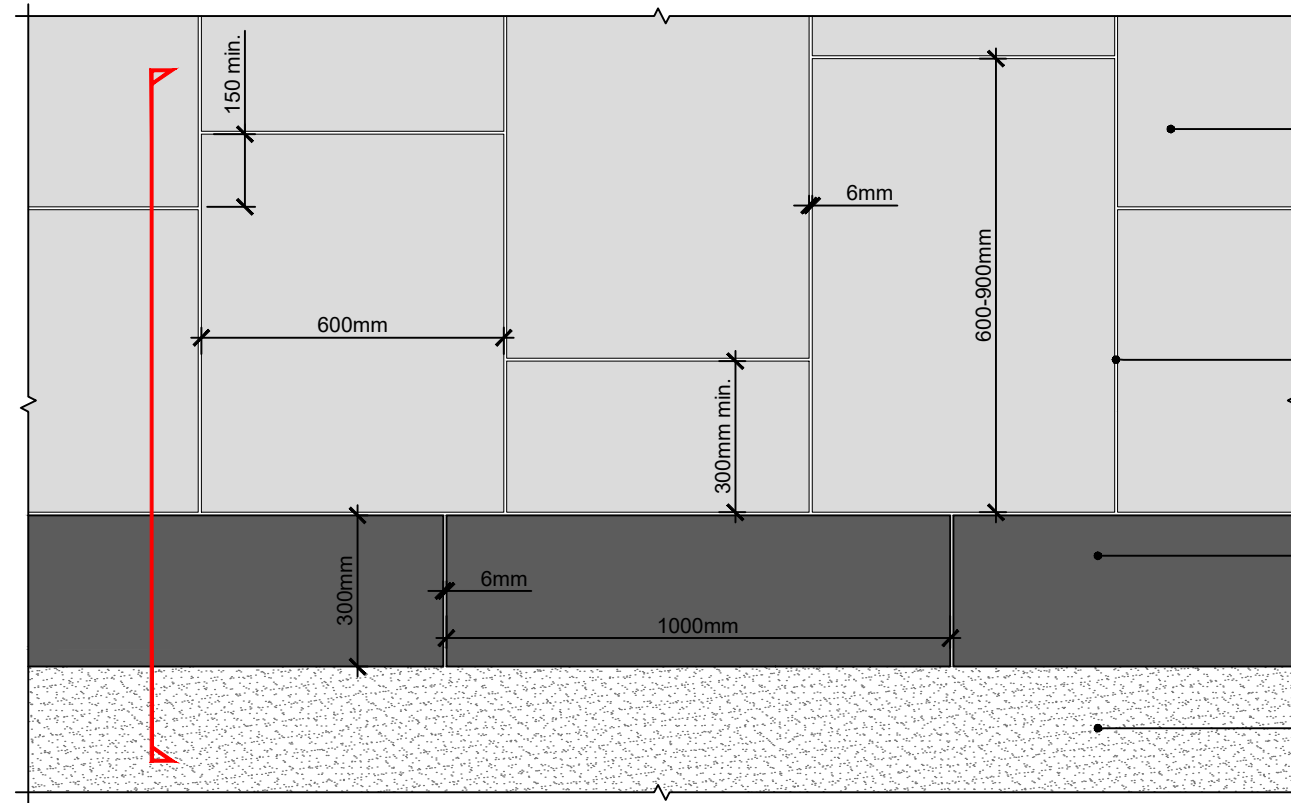

SCOUTMOOR SANDSTONE PAVING - TYPE 1a - DIAMOND SAWN FINISH 600mm WIDE x 600-900mm LENGTHS x 50mm DEEP BY MILLER DRUCK OR EQUAL AND APPROVED.

- MINIMUM OVERLAP BETWEEN PAVING UNITS = 150mm
- MINIMUM PAVING UNIT AT KERB INTERFACE = 300mm.

6mm TUFFGROUT JOINT COLOURED TO MATCH PAVING BY STEINTEC OR EQUAL & APPROVED

FINE PICKED UPSTAND GRANITE KERB, ROYAL WHITE, 300mm WIDE x 1000mm LONG x 200mm DEEP BY MILLER DRUCK OR EQUAL AND APPROVED.

MACADAM VEHICULAR CARRIAGEWAY TO PBA DETAIL AND SPECIFICATION (OUTSIDE SCOPE OF WORKS).

08a PLAN LAYOUT OF SANDSTONE PAVING TYPE 1a INTERFACE WITH KERB
SCALE: 1:15 @ A3

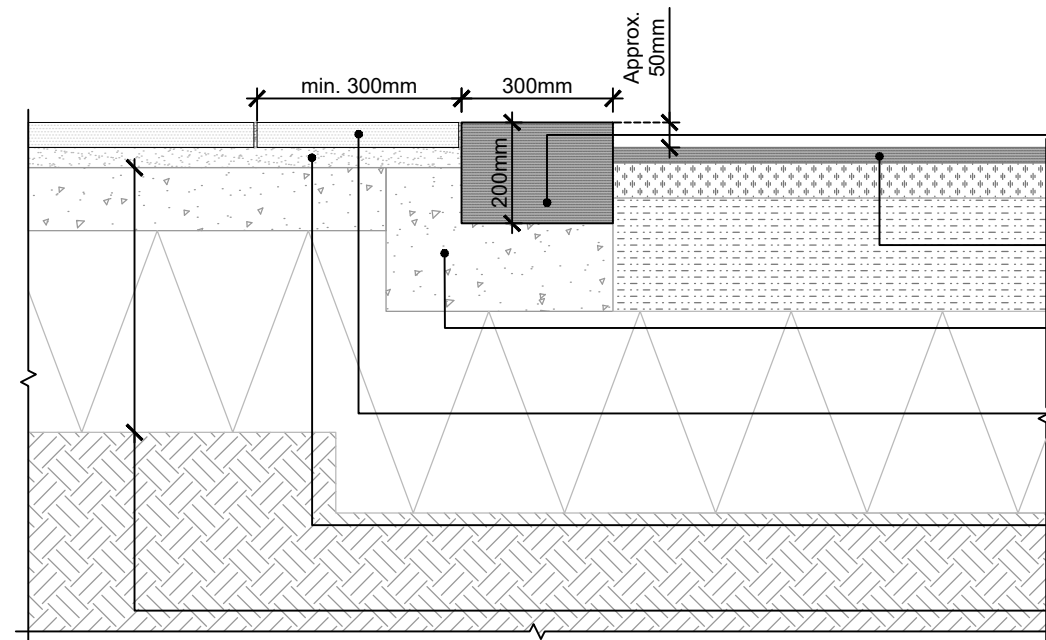

FINE PICKED UPSTAND GRANITE KERB, ROYAL WHITE, 300mm WIDE x 1000mm LONG x 200mm DEEP BY MILLER DRUCK OR EQUAL AND APPROVED.

MACADAM ROADWAY WEARING COURSE TO PBA DETAIL AND SPECIFICATION (OUTSIDE SCOPE OF WORKS).

KERB HAUNCHING AND SUB-BASE TO PBA DETAIL AND SPECIFICATION

SCOUTMOOR SANDSTONE PAVING (TYPE 1a) - DIAMOND SAWN FINISH 600mm WIDE x 600-900mm LENGTHS x 50mm DEEP BY MILLER DRUCK OR EQUAL AND APPROVED.

40mm DEPTH TUFFBED BEDDING MORTAR BY STEINTEC OR EQUAL AND APPROVED

SUB-BASE AND PAVING BUILD UP TO PBA DETAIL AND SPECIFICATION

08b SECTION THROUGH SANDSTONE PAVING TYPE 1a INTERFACE WITH KERB
SCALE: 1:15 @ A3

LANDSCAPE ARCHITECT:



The Threshing Barn
Bignell Park Barns
Chesterton
Oxfordshire
OX26 1TD

Tel: 01869 249776
Fax: 01869 327513
Email: mail@appliedlandscape.co.uk

© 2019 Applied Landscape Design Limited. All rights reserved.

Rev.	Update	Date
P02	STAGE 4 ISSUE: EMPLOYERS REQUIREMENTS	21.06.2019
P01	FIRST ISSUE FOR INFORMATION	15.04.19

PROJECT:
S1 Public Realm, KXC

CLIENT:
**KING'S CROSS CENTRAL
GENERAL PARTNERS LTD
(KCCGLP)**

drawn: AJ	checked: KmJ
scale: 1:15 @ A3	date: 15.04.2019
status: INFORMATION	xref file ref: ALD829_PR-LDbase

DRAWING TITLE:
**HARDWORKS DETAIL
- SANDSTONE TYPE 1 &
GRANITE KERB INTERFACE**

PROJECT NO. 829/19	DRAWING NUMBER: LD708	REVISION: P02
------------------------------	---------------------------------	-------------------------

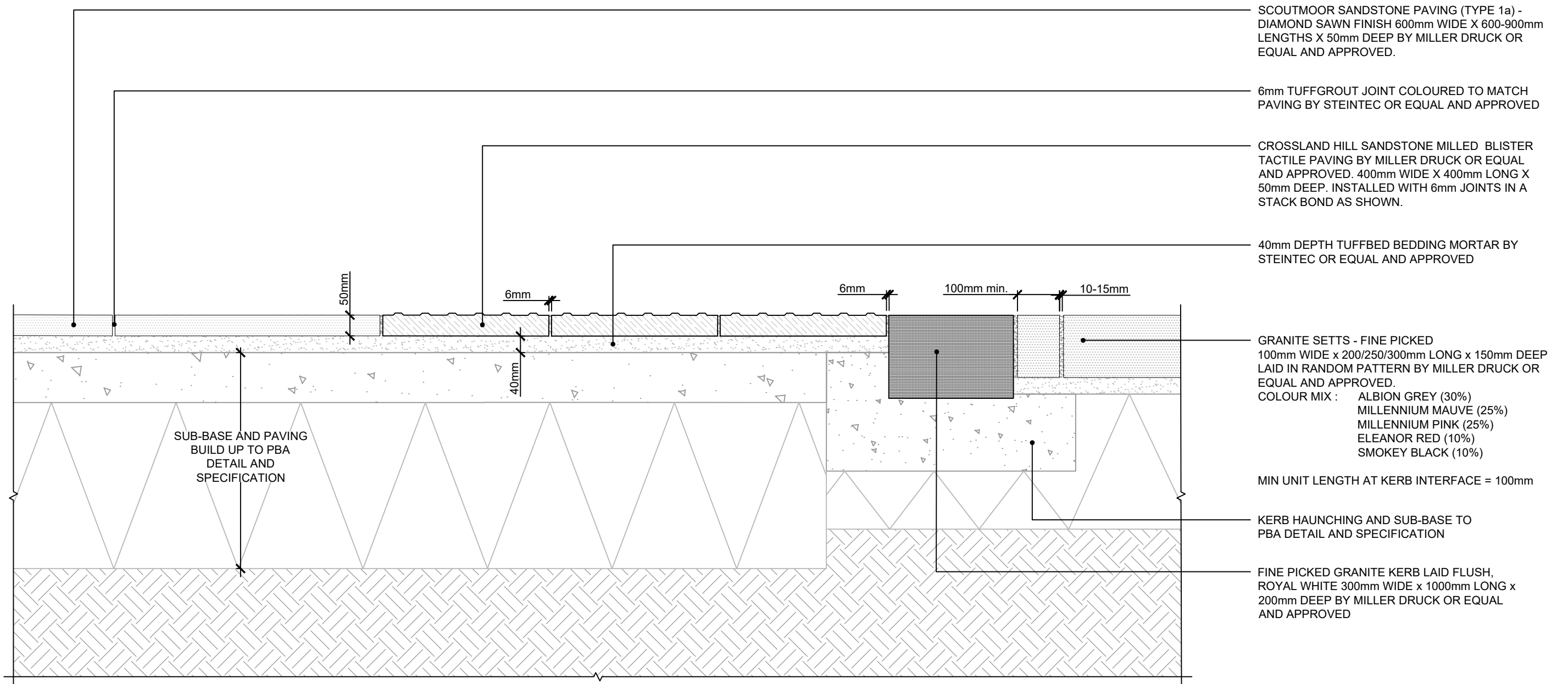

10 SECTION THROUGH UNCONTROLLED PEDESTRIAN CROSSING EAST OF BUILDING S1
SCALE: 1:10 @ A3

LANDSCAPE ARCHITECT:

ALD
The Threshing Barn
Bignell Park Barns
Chesterton
Oxfordshire
OX26 1TD

Tel: 01869 249776
Fax: 01869 327513
Email: mail@appliedlandscape.co.uk

applied landscape design

© 2019 Applied Landscape Design Limited. All rights reserved.

Rev.	Update	Date
P02	STAGE 4 ISSUE: EMPLOYERS REQUIREMENTS	21.06.2019
P01	FIRST ISSUE FOR INFORMATION	15.04.2019

PROJECT:
S1 Public Realm, KXC

CLIENT:
**KING'S CROSS CENTRAL
GENERAL PARTNERS LTD
(KCCGLP)**

drawn: AJ	checked: KmJ
scale: 1:10 @ A3	date: 15.04.2019
status: INFORMATION	xref file ref: ALD829_PR-LDbase

DRAWING TITLE:
**HARDWORKS DETAIL
- SECTION THROUGH UNCONTROLLED
PEDESTRIAN CROSSING - TYPE 1**

PROJECT NO. 829/19	DRAWING NUMBER: LD710	REVISION: P02
------------------------------	---------------------------------	-------------------------

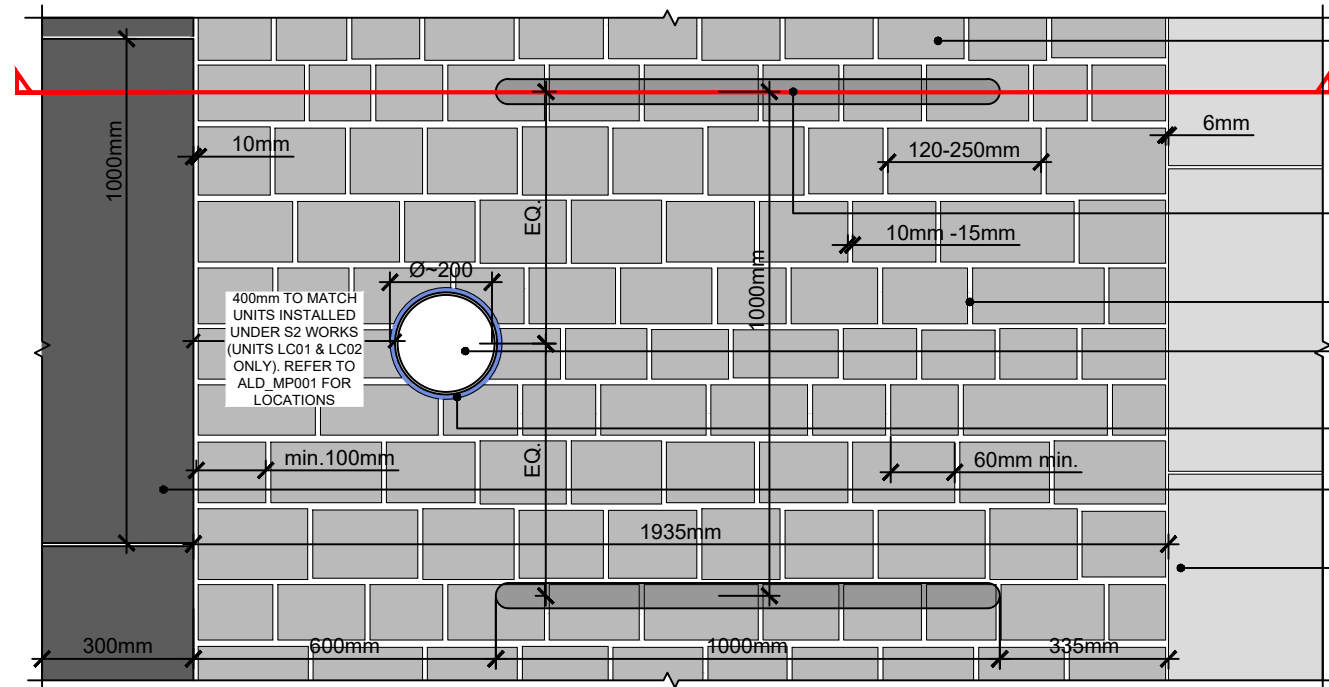

- RECLAIMED GRANITE SETTS ROUGH - SOURCED FROM SITE AND / OR APPROVED SOURCE. CONTRACTOR TO CONFIRM MIX AVAILABILITY. 120-250mm LENGTH x 3 BAND WIDTHS x APPROX. 100mm DEPTH.
- BAND 1 90-105mm WIDTH
- BAND 2 105-125mm WIDTH
- BAND 3 125-140mm WIDTH
- 1140mm HEIGHT (750mm ABOVE GROUND) x 1000mm WIDE x 50mm Ø. SATIN FINISH GRADE 316 SHEFFIELD STAINLESS STEEL CYCLE HOOP BY KENT STAINLESS OR EQUAL AND APPROVED. SET OUT AT 1m CENTRES. 4no. SET EQUIDISTANCE TO TREE SURROUNDS AT EITHER END.
- 10-15mm WIDE TUFFSAND 'GENERATION B' PERMEABLE JOINTING MEDIUM BY STEINTEC OR EQUAL AND APPROVED.
- EXISTING ROOT FIXED LIGHTING COLUMN BY OTHERS. REFER TO PBA SPECIFICATION FOR DETAILS, SIZES, COLOURS AND FINISHES. LIGHT COLUMN TO BE REMOVED THROUGHOUT INITIAL CONSTRUCTION ACTIVITIES AND REINSTATED TO PBA DETAIL AND SPECIFICATION
- 10mm MASTIC SEALANT JOINT AROUND COLUMN BASE, COLOURED TO MATCH PAVING TO PBA DETAIL AND SPECIFICATION.
- FINE PICKED UPSTAND GRANITE KERB, ROYAL WHITE, 300mm WIDE x 1000mm LONG x 200mm DEEP BY MILLER DRUCK OR EQUAL AND APPROVED.
- SCOUTMOOR SANDSTONE PAVING -TYPE 1a - DIAMOND SAWN FINISH 600mm WIDE x 600-900mm LENGTHS x 50mm DEEP BY MILLER DRUCK OR EQUAL AND APPROVED.
- MINIMUM OVERLAP BETWEEN PAVING UNITS = 150mm
- WHERE SANDSTONE ABUTS OTHER PAVING MINIMUM UNIT LENGTH = 300mm

21a PLAN LAYOUT OF STAINLESS STEEL CYCLE HOOP INTERFACE WITH RECLAIMED GRANITE SETTS
SCALE: 1:15 @ A3

NOTE:
OFFSET DISTANCES OF CYCLE HOOPS, LIGHT COLUMNS (LC01 & LC02) AND RECLAIMED SETT PAVING IN RELATION TO KERB LINE TO MATCH EXISTING FEATURES INSTALLED TO HANDYSIDE STREET FOOTWAY UNDER S2 WORKS AS SHOWN IN ADJACENT DETAILS.

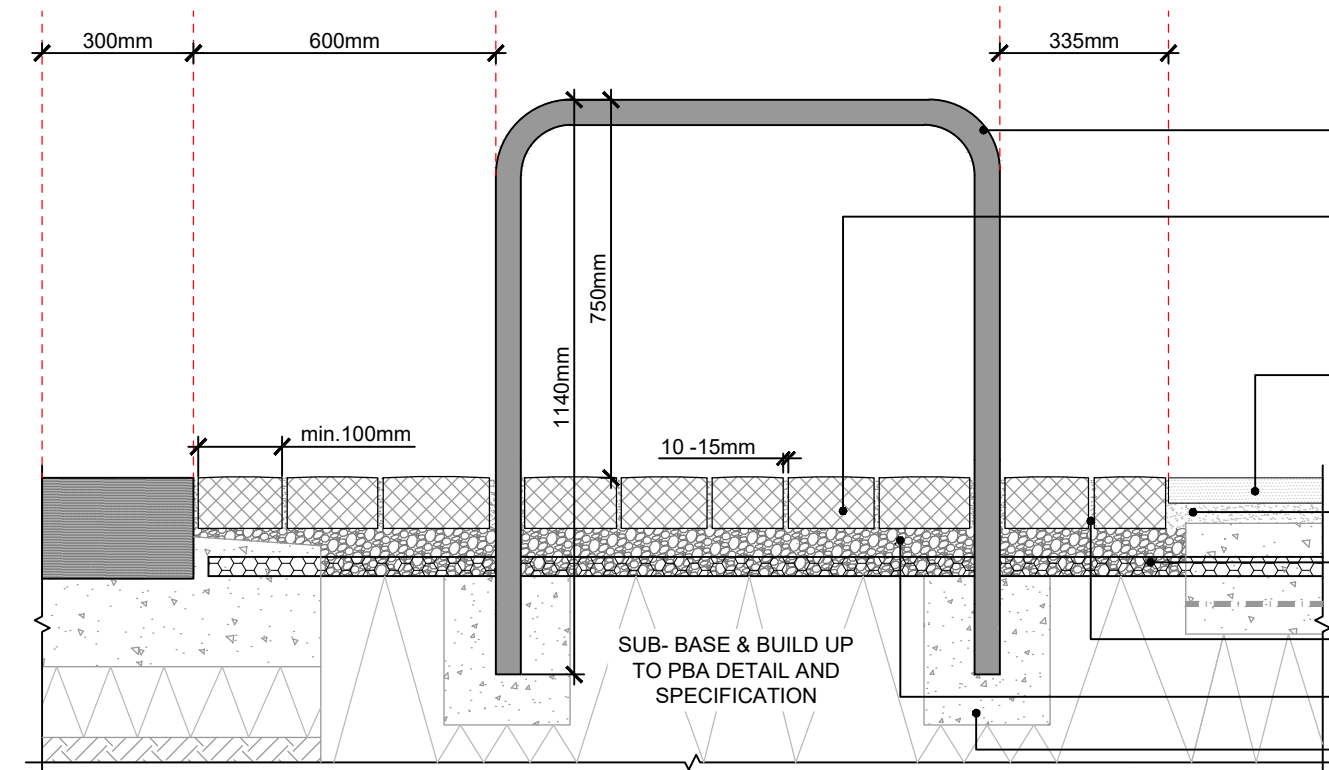

- 1140mm HEIGHT (750mm ABOVE GROUND) x 1000mm WIDE x 50mm Ø. SATIN FINISH GRADE 316 SHEFFIELD STAINLESS STEEL CYCLE HOOP BY KENT STAINLESS OR EQUAL AND APPROVED
- RECLAIMED GRANITE SETTS ROUGH - SOURCED FROM SITE AND / OR APPROVED SOURCE. CONTRACTOR TO CONFIRM MIX AVAILABILITY. 120-250mm LENGTH x 3 BAND WIDTHS x APPROX. 100mm DEPTH.
- BAND 1 80-100mm WIDTH
- BAND 2 101-115mm WIDTH
- BAND 3 116-125mm WIDTH
- SCOUTMOOR SANDSTONE PAVING -TYPE 1a - DIAMOND SAWN FINISH 600mm WIDE x 600-900mm LENGTHS x 50mm DEEP BY MILLER DRUCK OR EQUAL AND APPROVED.
- MINIMUM OVERLAP BETWEEN PAVING UNITS = 150mm
- WHERE SANDSTONE ABUTS OTHER PAVING MINIMUM UNIT LENGTH = 300mm
- 40mm DEPTH TUFFBED BEDDING MORTAR BY STEINTEC OR EQUAL AND APPROVED
- GOLPA RIGID HEXAGONAL REINFORCEMENT LAYER BY GEOSYNTHETICS OR EQUAL AND APPROVED. 38mm THICK, OVERLAPPED INTO CONCRETE EITHER SIDE BY 500mm min.
- 10-15mm WIDE TUFFSAND 'GENERATION B' PERMEABLE JOINTING MEDIUM BY STEINTEC OR EQUAL AND APPROVED.
- SETTS TO BE BEDDED ON 40mm (min.) LAYER OF TUFFGRIT BEDDING GRIT BY STEINTEC OR EQUAL & APPROVED.
- CYCLE HOOP FOUNDATIONS TO PBA DETAIL AND SPECIFICATION.

21b SECTION OF STAINLESS STEEL CYCLE HOOP INTERFACE WITH RECLAIMED GRANITE SETTS
SCALE: 1:15 @ A3

LANDSCAPE ARCHITECT:



The Threshing Barn
Bignell Park Barns
Chesterton
Oxfordshire
OX26 1TD

Tel: 01869 249776
Fax: 01869 327513
Email: mail@appliedlandscape.co.uk

© 2019 Applied Landscape Design Limited. All rights reserved.

Rev.	Update	Date
P02	STAGE 4 ISSUE: EMPLOYERS REQUIREMENTS	21.06.2019
P01	FIRST ISSUE FOR INFORMATION	15.04.2019

PROJECT:
S1 Public Realm, KXC

CLIENT:
**KING'S CROSS CENTRAL
GENERAL PARTNERS LTD
(KCCGLP)**

drawn: AJ	checked: KmJ
scale: 1:15 @ A3	date: 15.04.2019
status: INFORMATION	xref file ref: ALD829_PR-LDbase

DRAWING TITLE:
**HARDWORKS DETAIL
- LIGHTING COLUMN / CYCLE
STAND IN RECLAIMED SETTS**

PROJECT NO. 829/19	DRAWING NUMBER: LD721	REVISION: P02
------------------------------	---------------------------------	-------------------------

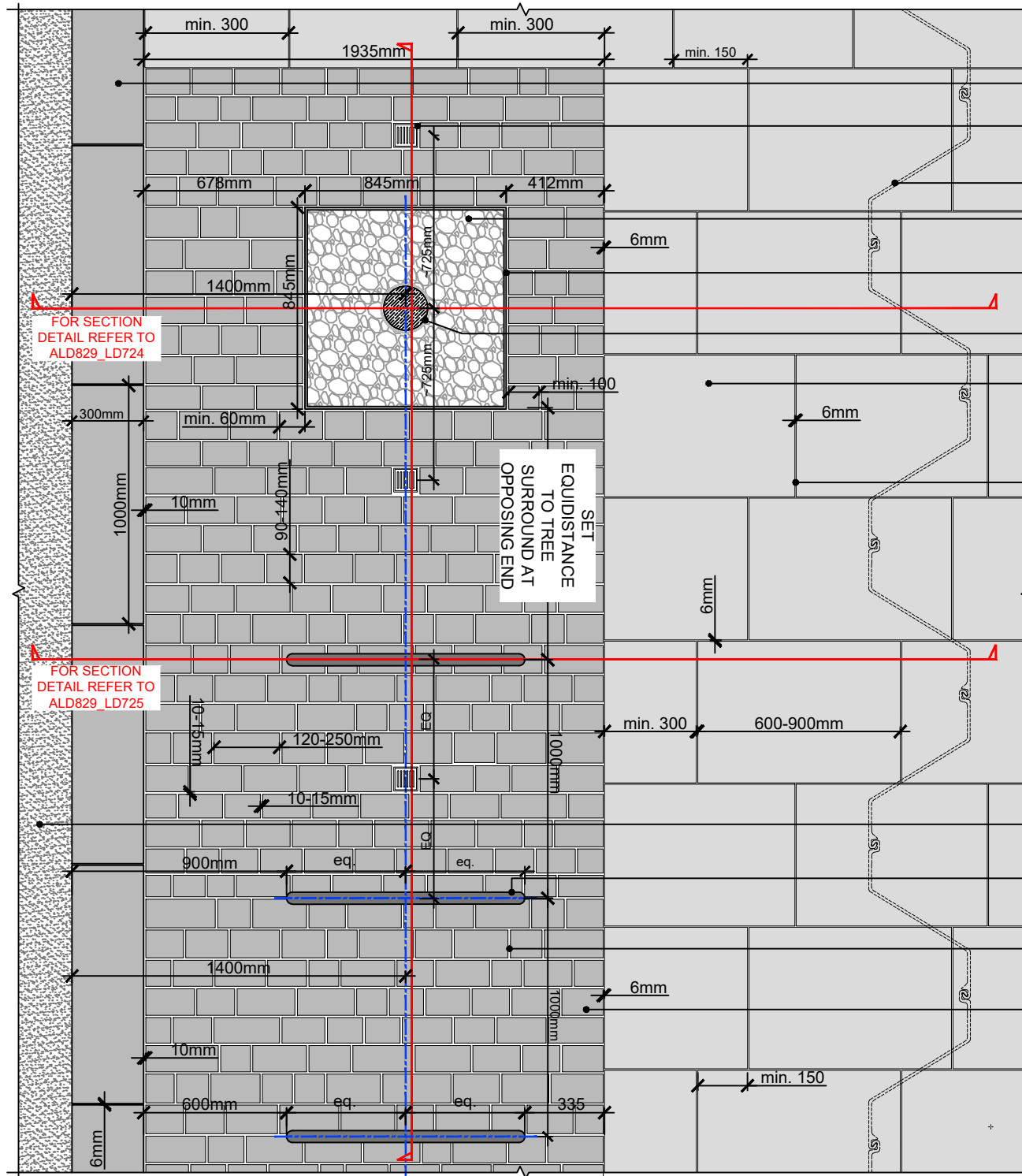

- FINE PICKED UPSTAND GRANITE KERB, ROYAL WHITE 300mm WIDE x 1000mm LONG x 200mm DEEP BY MILLER DRUCK OR EQUAL AND APPROVED
- 100mm x 100mm ROOTRAIN ARBORVENT ALUMINIUM & STAINLESS STEEL AERATION CAP BY GREENBLUE URBAN OR EQUAL. MATERIAL AS PER MANUFACTURERS STANDARD PRODUCT. 3no. PER TREE AS SHOWN
- APPROXIMATE LINE OF PLASTIC SHEET PILING INSTALLED UNDER PREVIOUS WORKS.
- 75mm DEPTH ROYAL WHITE GRANITE CHIPPINGS (6-10mm) BY MILLER DRUCK OR EQUAL & APPROVED. INSTALLED OVER SUB-BASE OF LECA LIGHTWEIGHT AGGREGATE.
- 845mm x 845mm x 10mm THICK x 150mm HIGH GRADE 316 STAINLESS STEEL TREE SURROUND BY KENT STAINLESS OR EQUAL. SATIN POLISHED FINISH.
- 10mm THICK DRAINAGE MAT COLLAR AROUND BASE OF TREE TO FULL DEPTH OF GRAVEL MULCH INFILL.
- SCOUTMOOR SANDSTONE PAVING - TYPE 1a - DIAMOND SAWN FINISH 600mm WIDE x 600-900mm LENGTHS x 50mm DEEP BY MILLER DRUCK OR EQUAL AND APPROVED.
- MINIMUM OVERLAP BETWEEN PAVING UNITS = 150mm
- MINIMUM PAVING UNIT AT KERB INTERFACE = 300mm.
- 6mm TUFFGROUT MORTAR JOINT COLOURED TO MATCH PAVING BY STEINTEC OR EQUAL AND APPROVED

NOTE:
 OFFSET DISTANCES OF TREE SURROUNDS, CYCLE HOOPS, AND RECLAIMED SETT PAVING IN RELATION TO KERB LINE TO MATCH EXISTING FEATURES INSTALLED TO HANDYSIDE STREET FOOTWAY UNDER S2 WORKS AS SHOWN IN ADJACENT DETAIL.

- EXISTING MACADAM VEHICULAR CARRIAGEWAY. WHERE RESURFACING IS REQUIRED REFER TO PBA DETAIL AND SPECIFICATION (OUTSIDE SCOPE OF WORKS)
- 1140mm HEIGHT (750mm ABOVE GROUND) x 1000mm WIDE x 50mm Ø. SATIN FINISH GRADE 316 SHEFFIELD STAINLESS STEEL CYCLE HOOP BY KENT STAINLESS OR EQUAL AND APPROVED. SET OUT AT 1m CENTRES. 4no. SET EQUIDISTANCE TO TREE SURROUNDS AT EITHER END.
- JOINTING TO GRANITE SETTS ONLY (ABOVE TREE PIT EXTENTS) TO BE 10-15mm WIDE TUFFSAND 'GENERATION B' PERMEABLE JOINTING MEDIUM BY STEINTEC OR EQUAL AND APPROVED.
- RECLAIMED GRANITE SETTS ROUGH - SOURCED FROM SITE AND / OR APPROVED SOURCE. CONTRACTOR TO CONFIRM MIX AVAILABILITY.
 BAND 1 90-105mm WIDTH
 BAND 2 105-125mm WIDTH
 BAND 3 125-140mm WIDTH

22 PLAN LAYOUT OF CYCLESTANDS & TREE SURROUND IN RECLAIMED SETTS OVER TREEPIT
 SCALE: 1:25 @ A3

LANDSCAPE ARCHITECT:



The Threshing Barn
 Bignell Park Barns
 Chesterton
 Oxfordshire
 OX26 1TD

Tel: 01869 249776
 Fax: 01869 327513
 Email: mail@appliedlandscape.co.uk

© 2019 Applied Landscape Design Limited. All rights reserved.

Rev.	Update	Date
P02	STAGE 4 ISSUE: EMPLOYERS REQUIREMENTS	21.06.2019
P01	FIRST ISSUE FOR INFORMATION	15.04.19

PROJECT:
S1 Public Realm, KXC

CLIENT:
**KING'S CROSS CENTRAL
 GENERAL PARTNERS LTD
 (KCCGLP)**

drawn: AJ	checked: KmJ
scale: 1:25 @ A3	date: 15.04.2019
status: INFORMATION	xref file ref: ALD829_PR-LDbase

DRAWING TITLE:
**HARDWORKS DETAIL
 - CYCLE STANDS & TREE
 SURROUND PLAN LAYOUT**

PROJECT NO. 829/19	DRAWING NUMBER: LD722	REVISION: P02
------------------------------	---------------------------------	-------------------------

FACADE DETAIL TAKEN FROM ARCHITECT DETAILS. REFER TO MCMULLEN DRAWINGS FOR DETAILED INFORMATION.

CLADDING PIECE TO FACADE BY MCMULLEN. OUTER FACE OF CLADDING SETS POSITION OF SLOT DRAIN

10mm THICK STAINLESS STEEL ANGLE FRAME TO FACADE TO MCMULLEN DETAILS

10mm WIDE MASTIC JOINT (COLOURED TO MATCH PAVING) AT BUILDING INTERFACE INSTALLED OVER 10MM THICK COMPRESSIBLE BOARD. MASTIC SPECIFICATION TO PBA DETAIL.

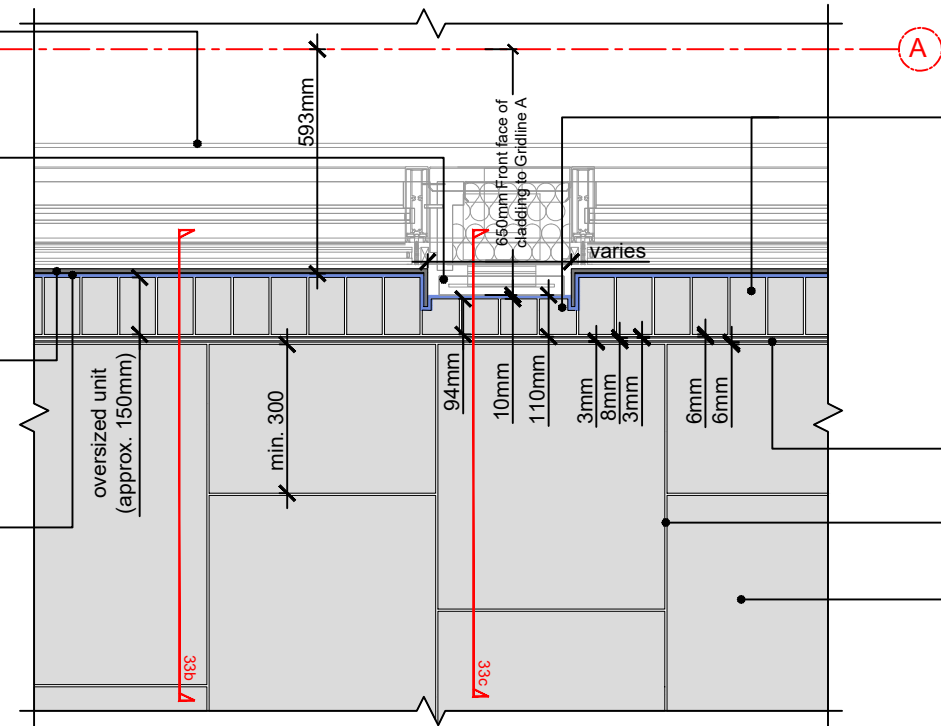

SCOUTMOOR SANDSTONE PAVING -TYPE 3a. DIAMOND SAWN FINISH 94mm WIDE X 94mm LONG (OR OTHERWISE INDICATED) X 50mm DEEP BY MILLER DRUCK OR EQUAL AND APPROVED. NEXT TO CLADDING PIECE. 1no. ROW OF OVERSIZED UNITS ALONG METAL FRAME. INSTALLED STACK BOND PATTERN WITH 6mm JOINTS AS SHOWN.

- FULL 94mm X 94mm UNIT ACCROSS EXTENT OF STONE CLADDING UNIT.
- OVERSIZED UNIT ACROSS EXTENT OF METAL ANGLE INSET
- WIDTH OF STONE CLADDING PIECE vs METAL ANGLE INSET VARIES DEPENDENT ON LOCATION

STAINLESS STEEL SLOTDRAIN TO PBA DETAIL AND SPECIFICATION. VISIBLE AT PAVING SURFACE WITH 8mm WIDE THROAT.

6mm WIDE 'TUFFGROUT' MORTAR JOINT BY STEINTEC OR EQUAL & APPROVED.

SCOUTMOOR SANDSTONE PAVING - TYPE 1a DIAMOND SAWN FINISH 600mm WIDE x 600-900mm LENGTHS x 50mm DEEP BY MILLER DRUCK OR EQUAL AND APPROVED. NOTE: WHERE SANDSTONE ABUTS OTHER PAVING, SLOT DRAIN OR A BUILDING FACADE MINIMUM UNIT LENGTH = 300mm

33a PLAN LAYOUT OF SANDSTONE PAVING INTERFACE WITH FACADE AT SILL SCALE: 1:20 @ A3

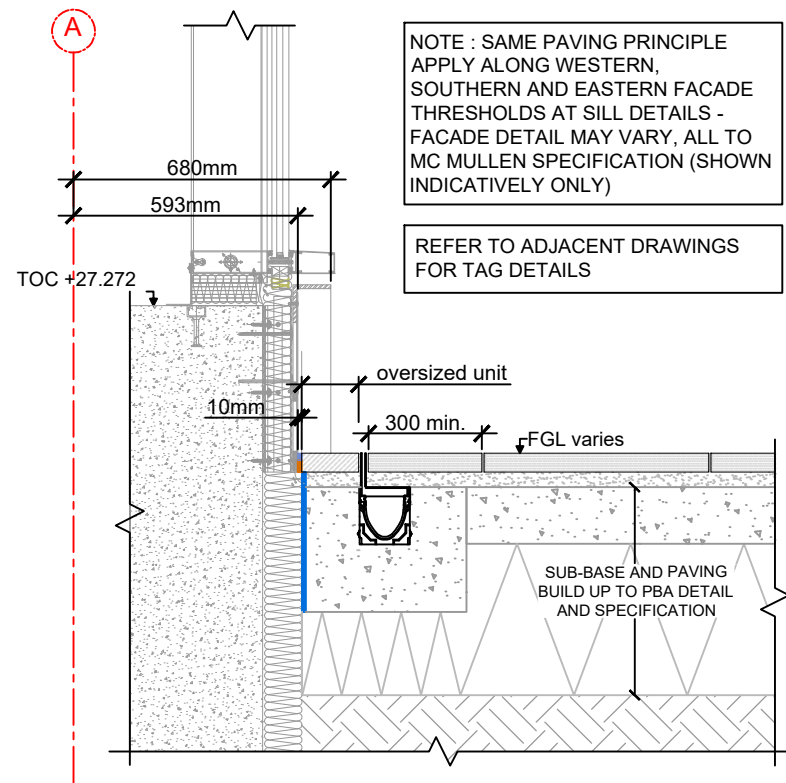

NOTE : SAME PAVING PRINCIPLE APPLY ALONG WESTERN, SOUTHERN AND EASTERN FACADE THRESHOLDS AT SILL DETAILS - FACADE DETAIL MAY VARY, ALL TO MC MULLEN SPECIFICATION (SHOWN INDICATIVELY ONLY)

REFER TO ADJACENT DRAWINGS FOR TAG DETAILS

33b SECTION THROUGH THRESHOLD AT SILL INTERFACE / METAL FRAME SCALE: 1:20 @ A3

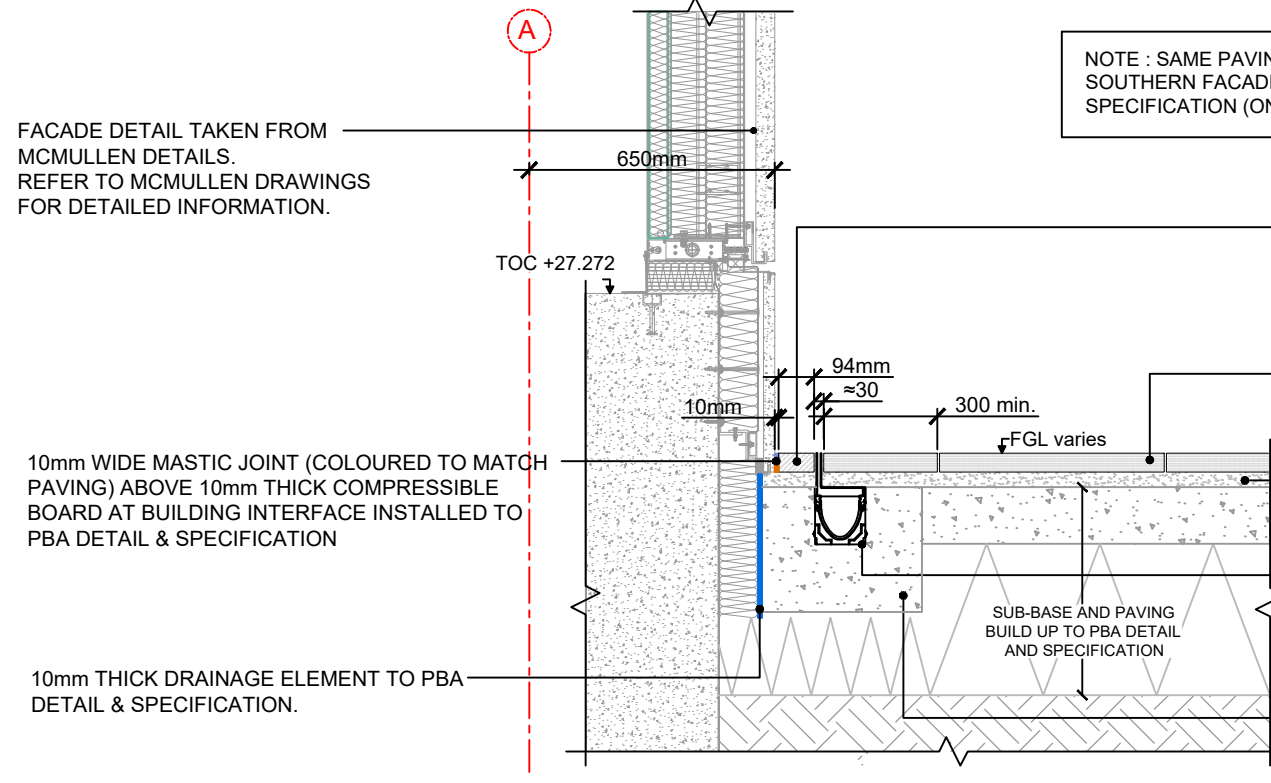

NOTE : SAME PAVING PRINCIPLE APPLY ALONG WESTERN AND SOUTHERN FACADE - FACADE DETAIL MAY VARY, ALL TO MC MULLEN SPECIFICATION (ONLY SHOWN INDICATIVELY)

SCOUTMOOR SANDSTONE PAVING -TYPE 3a. DIAMOND SAWN FINISH 94mm WIDE X 94mm LONG (OR OTHERWISE INDICATED) X 50mm DEEP BY MILLER DRUCK OR EQUAL AND APPROVED.

SCOUTMOOR SANDSTONE PAVING -TYPE 1a DIAMOND SAWN FINISH 600mm WIDE x 600-900mm LENGTHS x 50mm DEEP BY MILLER DRUCK OR EQUAL AND APPROVED.

40mm DEPTH TUFFBED BEDDING MORTAR BY STEINTEC OR EQUAL AND APPROVED

STAINLESS STEEL SLOTDRAIN TO PBA DETAIL AND SPECIFICATION. VISIBLE AT PAVING SURFACE WITH 8mm WIDE THROAT.

CONCRETE FOUNDATION/HAUNCHING TO PBA DETAIL & SPECIFICATION.

33c SECTION THROUGH THRESHOLD AT SILL INTERFACE/CLADDING PIECE SCALE: 1:20 @ A3

LANDSCAPE ARCHITECT:



The Threshing Barn
Bignell Park Barns
Chesterton
Oxfordshire
OX26 1TD

Tel: 01869 249776
Fax: 01869 327513
Email: mail@appliedlandscape.co.uk

© 2019 Applied Landscape Design Limited. All rights reserved.

P02	STAGE 4 ISSUE: EMPLOYERS REQUIREMENTS	21.06.2019
P01	FIRST ISSUE FOR INFORMATION	15.04.2019
Rev.	Update	Date

PROJECT:
S1 Public Realm, KXC

CLIENT:
KING'S CROSS CENTRAL
GENERAL PARTNERS LTD
(KCCGLP)

drawn: AJ	checked: KmJ
scale: 1:20 @ A3	date: 15.04.2019
status: INFORMATION	xref file ref: ALD829_PR-LDbase

DRAWING TITLE:
**THRESHOLD DETAIL 03
- WEST FACADE /SANDSTONE
SETT INTERFACE**

PROJECT NO. 829/19	DRAWING NUMBER: LD733	REVISION: P01
------------------------------	---------------------------------	-------------------------

KEY

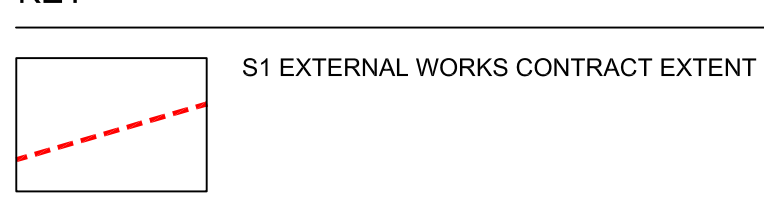

HARD SURFACING

- SANDSTONE PAVING TYPE 1a: To Footpath**
600mm width x 600mm - 900mm length x 50mm depth Scoutmoor Sandstone Diamond Sawn by Miller Druck or equal and approved. Installed with 6mm joints. Refer to drawing ALD829_LD701
- SANDSTONE PAVING TYPE 1b: Temporary**
600mm width x 600mm - 900mm length x 50mm depth Scoutmoor Sandstone Diamond Sawn by Miller Druck or equal and approved. Installed with 6mm joints on sand/cement bedding until crossing opens. Refer to drawing ALD829_LD701
- SANDSTONE PAVING TYPE 2a: To Footpath**
384mm length x 194mm width x 50mm depth Scoutmoor Sandstone Diamond Sawn by Miller Druck or equal and approved. Installed with 6mm joints. Refer to drawing ALD829_LD702
- SANDSTONE PAVING TYPE 2b: Temporary**
384mm length x 194mm width x 50mm depth Scoutmoor Sandstone Diamond Sawn by Miller Druck or equal and approved. Installed with 6mm joints on sand/cement bedding until crossing opens. Refer to drawing ALD829_LD702
- SANDSTONE SETTS TYPE 3a: To building threshold**
94mm length x 94mm width x 50mm depth Scoutmoor Sandstone Diamond Sawn by Miller Druck or equal and approved. Installed with 6mm joints. Refer to drawing ALD829_LD703
- SANDSTONE SETTS TYPE 3b: To building threshold**
94mm length x 94mm width x 50mm depth Cropped Scoutmoor Setts by Miller Druck or equal and approved. Installed with 6mm joints. Refer to drawing ALD829_LD703

- GRANITE SETTS: To bus layby**
200/250/300mm length x 100mm width x 150mm depth Granite setts sawn fine picked by Miller Druck or equal and approved. Installed with 10mm-15mm joints. Colour mix: 10% smokey black, 30% alblon grey, 25% millennium mauve, 25% millennium pink and 10% eleanor red. Refer to drawing ALD829_LD704
- RECLAIMED ROUGH TOP GRANITE SETTS**
90-140mm wide x 100-300mm lengths x 100mm deep around trees and cycle parking zones as shown. 10-15mm wide joints filled with 'Tuffsand' Generation B' jointing medium by Steintec. Refer to drawings ALD829_LD722
- RESIN BONDED GRAVEL: Temporary finish**
Trent 3-6mm resin bonded gravel by Addagrip or equal and approved. Refer to drawing ALD829_LD706
- TACTILE PAVING: To Pedestrian Crossing**
400mm length x 400mm width x 50mm depth tactile blister paving with milled blisters. Installed with 6mm joints. Crossland Hill Sandstone by Miller Druck or equal and approved. Refer to drawing ALD829_LD705 & LD710
- TACTILE PAVING: To Handyside Street Pedestrian Crossing**
400mm length x 400mm width x 50mm depth tactile blister paving with milled blisters. Installed with 6mm joints. Crossland Hill Sandstone by Miller Druck or equal and approved. Refer to drawing ALD829_LD705 & LD711

KERBS & EDGES

- GRANITE KERB**
300mm wide x 200mm depth x 1000mm length Royal White granite stone kerb by Miller Druck or equal and approved. Various upstand heights and radii, to PBA detail and specification. Refer to drawing ALD832_LD708.
- GRANITE KERB**
300mm wide x 300mm depth x 1000mm length Royal White granite stone kerb by Miller Druck or equal and approved. Various upstand heights, to PBA detail and specification. Refer to drawing ALD832_LD709.
- PROPOSED PCC PIN KERB**
Temporary concrete pin kerb to contain finishes prior to future phases to north & west. 50mm wide x 150mm deep x 915mm long. Installed butt jointed. Refer to drawing ALD829_LD706
- EXISTING PCC PIN KERB TO BE REMOVED**
Temporary concrete pin kerb installed under S2 works to be removed on installation of resin bonded finishes to S2
- STEEL EDGING - North and east of S1**
10mm thick grade 316 stainless steel edging by Kent Stainless or equal and approved. Satin polished finish. Refer to drawing ALD829_LD706 & LD713
- TREEPIT SHEET PILING & ROOT BARRIER**
Existing sheet piling installed under previous works. Green dashed line represents rootbarrier (e.g. ReRoot 1000 by Greenleaf or equal), to create treepit trenches as shown. Refer to drawing ALD829_LD722
- SLOT DRAINS - EXPOSED THROAT**
To PBA detail and specification.

FURNITURE

- CYCLE STANDS - South of S1**
1140mm height (750mm above ground) x 1000mm width x 50mm ø Stainless steel cycle hoop by Kent Stainless steel or equal and approved on reclaimed granite setts surround. Refer to drawings ALD829_LD721
- STAINLESS STEEL TREE SURROUND & GRAVEL INFILL - South and west of S1**
10mm thick x 845mm x 845mm (on plan) grade 316 stainless steel tree surround, satin polished finish by Kent Stainless. Inside filled with 6-10mm Royal White granite chippings by Miller Druck Stone. Refer to drawings ALD829_LD722
- TREE AERATION/WATERING GRILLE: Tree surrounds south and west of S1**
100 x 100mm Rooter Aluminium & stainless steel aeration cap by GreenBlue Urban or equal. 2no. grilles per tree. Refer to ALD drawings ALD829_LD722
- ACCESS COVERS**
Varied types and sizes. Refer to ALD829_HL101 and ALD829_SCH001 for access cover schedule.
- PEDESTAL CARD READER: Reception & cycle store access doors**
80 x 80mm stainless steel pedestal card reader. All by others. For below ground fixing detail refer to PBA detail and specification.
- LIGHTING TYPE 1 - West of S1**
Proposed lighting to PBA details and specification. Refer to ALD drawings ALD829_LD714
- LIGHTING TYPE 2 - South of S1**
Existing lighting fixture to be removed and stored off site during S1 construction phase and replaced at location as indicated. Refer to ALD drawings ALD829_LD714 & LD721

SOFT LANDSCAPE

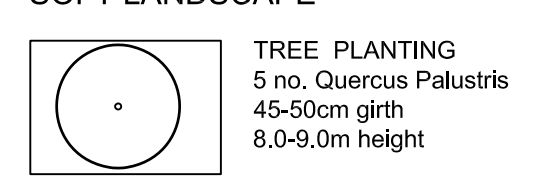

TREE PLANTING
5 no. Quercus Palustris
45-50cm girth
8.0-9.0m height

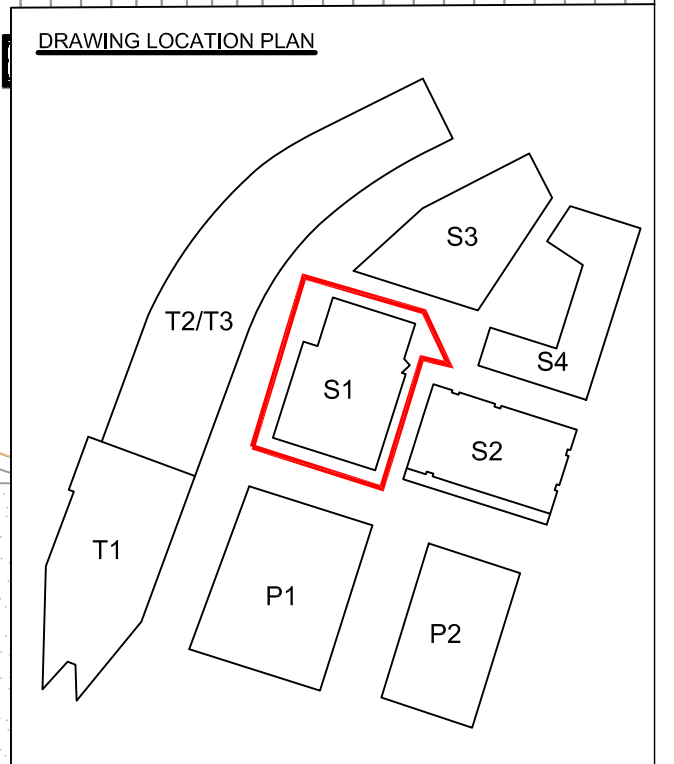
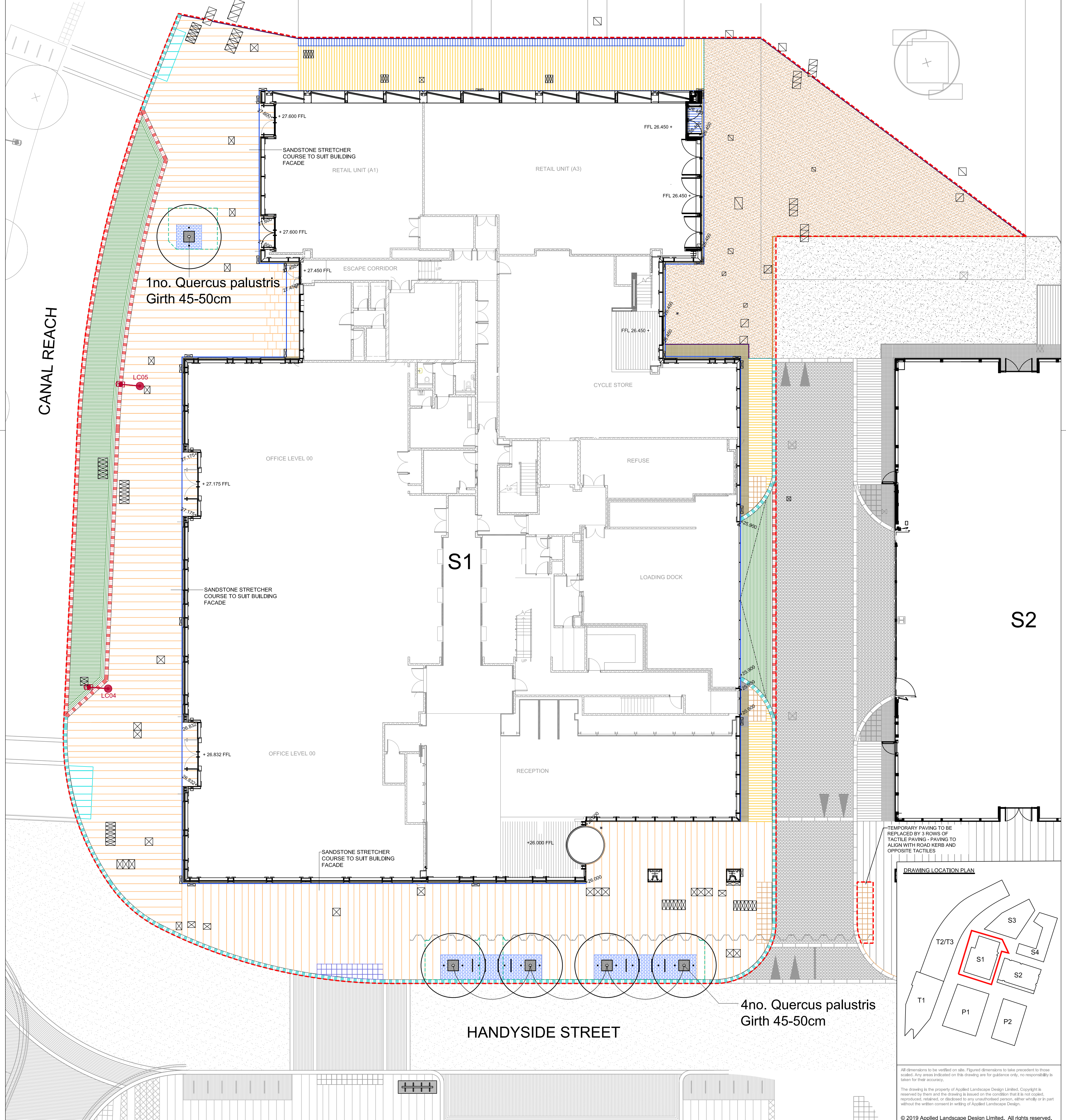
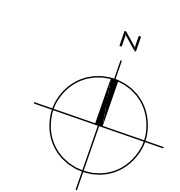

All dimensions to be verified on site. Figured dimensions to take precedent to those scaled. Any areas indicated on this drawing are for guidance only, no responsibility is taken for their accuracy.

This drawing is the property of Applied Landscape Design Limited. Copyright is reserved by them and the drawing is issued on the condition that it is not copied, reproduced, re-used, or disclosed to any unauthorised person, either wholly or in part without the written consent in writing of Applied Landscape Design.

© 2019 Applied Landscape Design Limited. All rights reserved.

LANDSCAPE ARCHITECT:

The Threshing Barn
Bignell Park Barns
Cheserton
Oxfordshire
OX26 1TD

Tel: 01869 249776
Fax: 01869 327513
Email: mail@appliedlandscape.co.uk

Rev.	Update	Date
P01	ISSUE FOR PLANNING	04.07.19

PROJECT: **S1 Public Realm, KXC**

CLIENT: **KING'S CROSS CENTRAL GENERAL PARTNERS LTD (KCCGLP)**

drawn: **AJ/MF**
scale: **1:150 @ A1**
status: **INFORMATION**

checked: **KmJ**
date: **04.07.2019**
ref file ref: **ALD829_MPbase**

DRAWING TITLE: **BUILDING S1 PUBLIC REALM GENERAL ARRANGEMENT(PLANNING)**

PROJECT NO: **ALD829** DRAWING NUMBER: **MP005** REVISION: **P01**