

01 Window Section-Existing
Scale 1:10@A1 1:20@A3

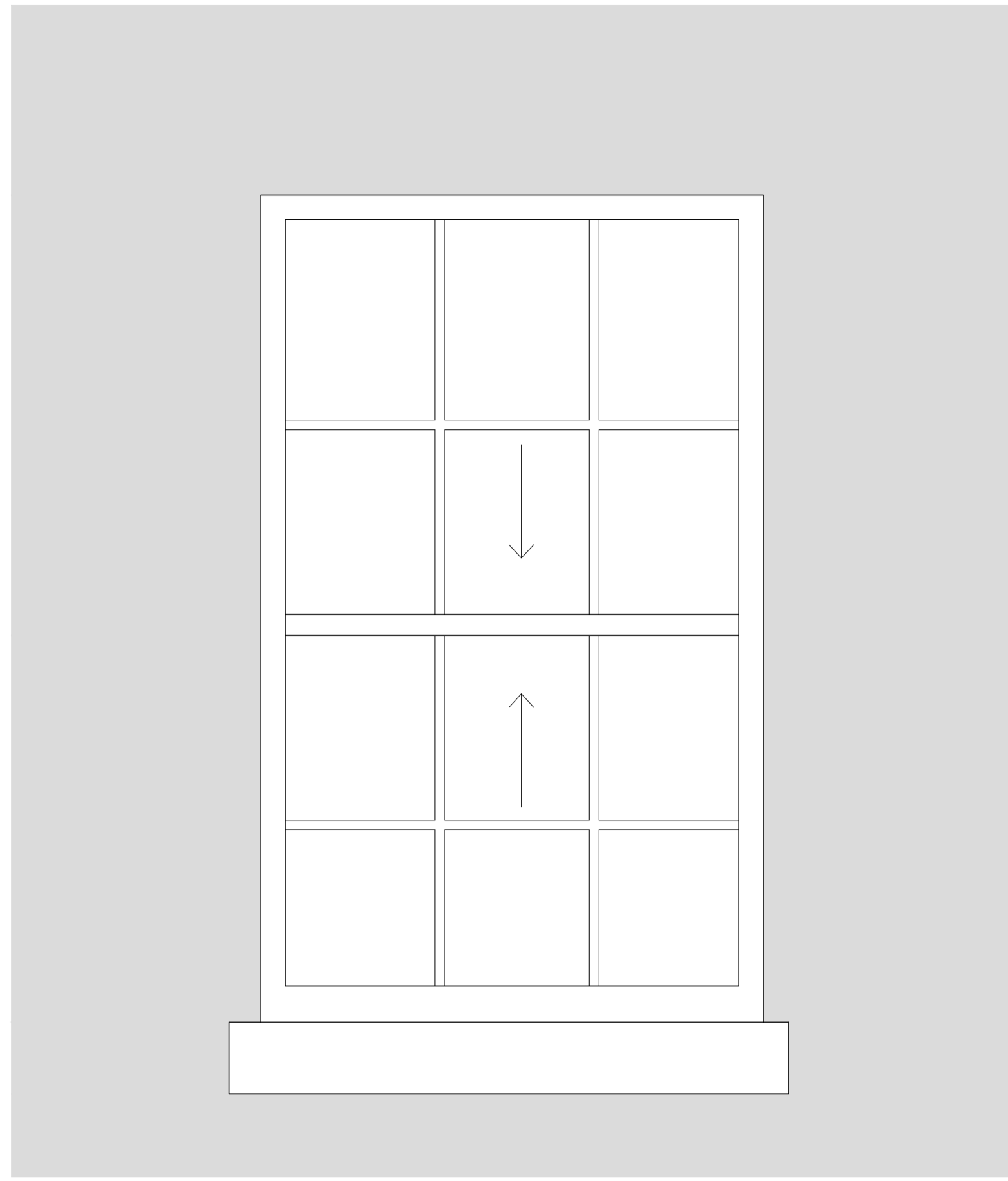

02 External Window Elevation-Existing
Scale 1:10@A1 1:20@A3

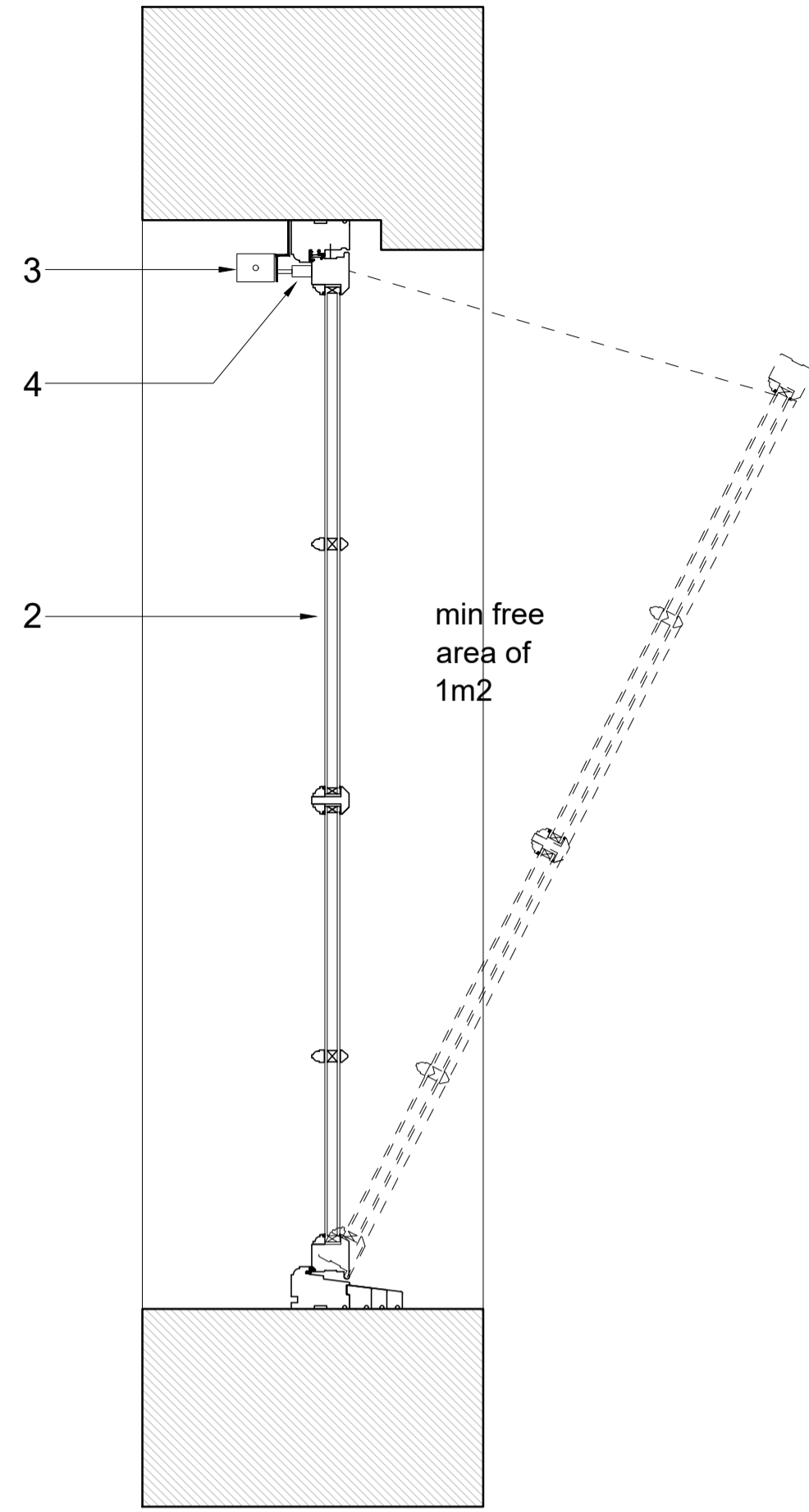

01 Window Section-Proposed
Scale 1:10@A1 1:20@A3

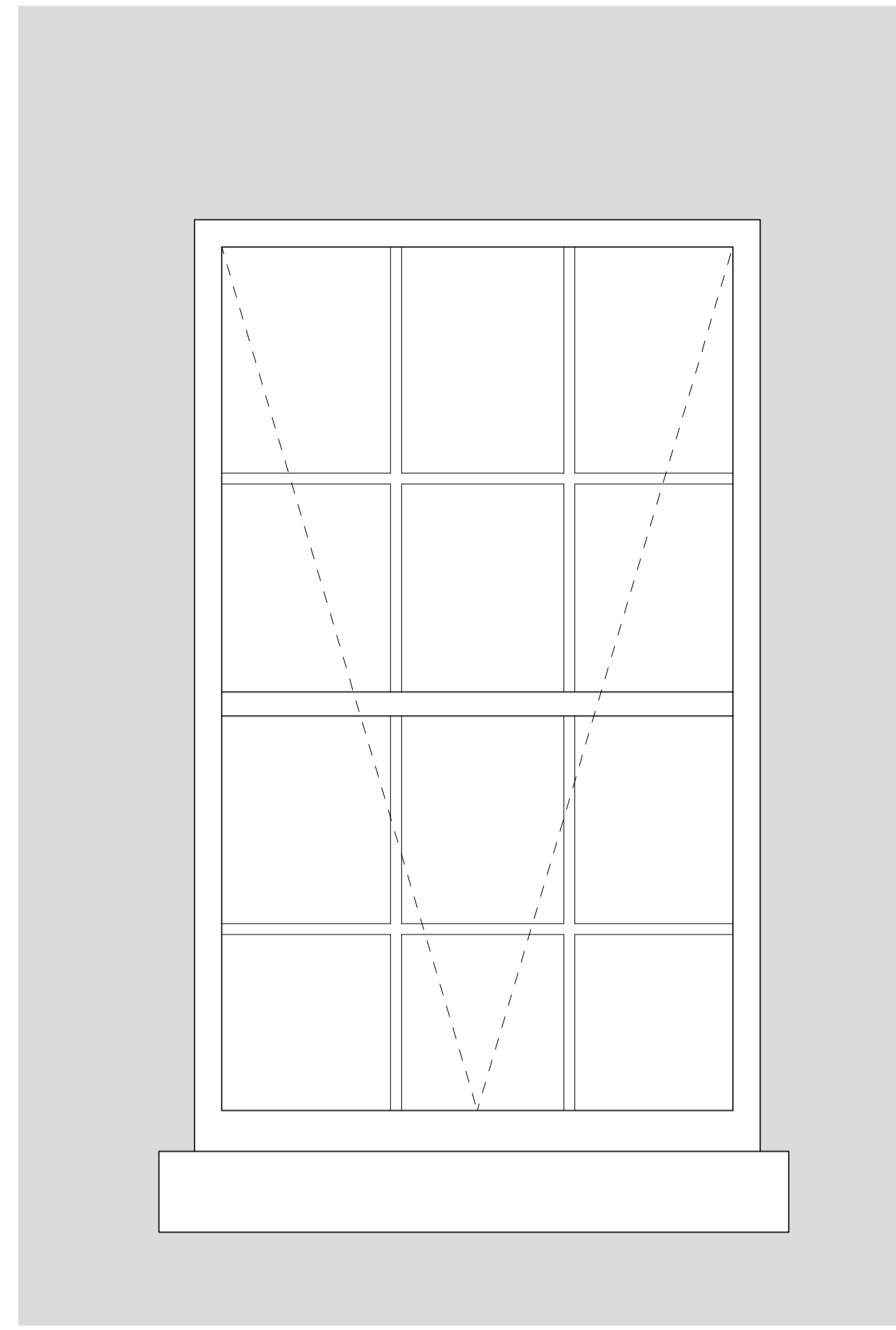

02 External Window Elevation-Proposed
Scale 1:10@A1 1:20@A3

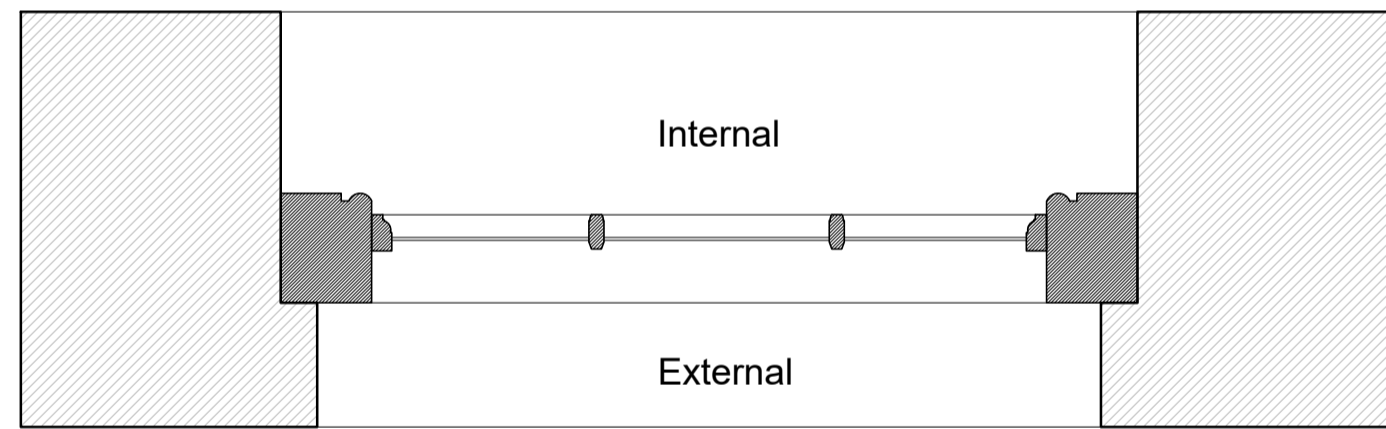

03 Window Plan -Existing
Scale 1:10@A1 1:20@A3

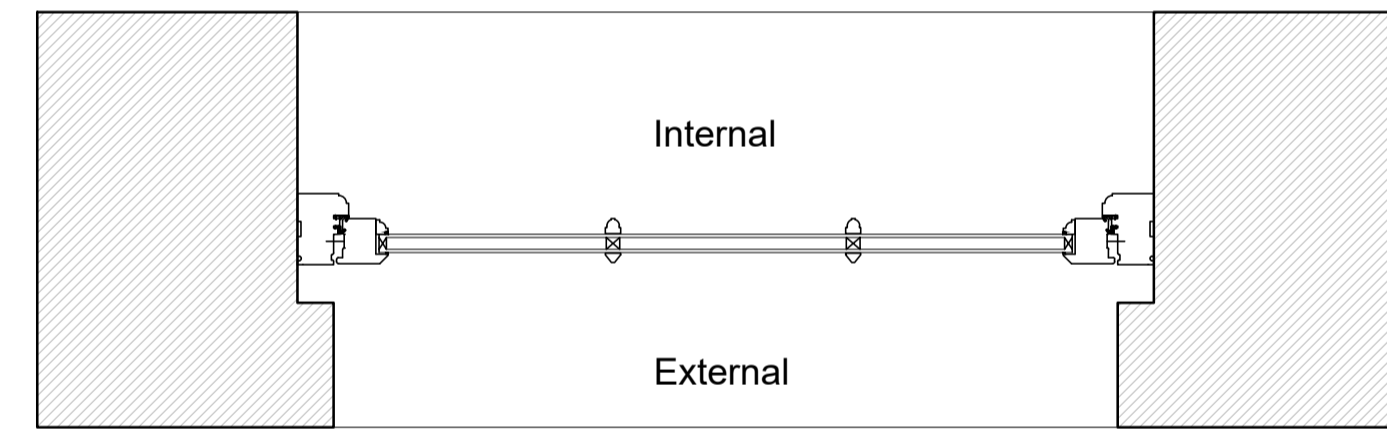

03 Window Plan - Proposed
Scale 1:10@A1 1:20@A3



Key Elevation
Scale 1:200@A1 1:400@A3

Notes

- Dimensions are in millimeters unless stated otherwise.
- Levels are in metres above AOD unless stated otherwise.
- All drawings to be read in conjunction with relevant specifications, all relevant engineers and specialists' drawings and specifications + any other documents as specified by Thirdway Architecture.
- Report any discrepancies in writing to Thirdway Architecture.
- All dimensions are subject to site survey and are to be verified on site by the contractor before proceeding.

© Thirdway Architecture Ltd

Key

1. Existing timber sash window
2. New bespoke timber 'dummy sash window' to match existing window style and paint colour
3. Actuator, to sit discreetly behind window frame
4. Vent bracket

Note:
Existing window profile and opening size to be surveyed by window specialist prior to detail design and fabrication

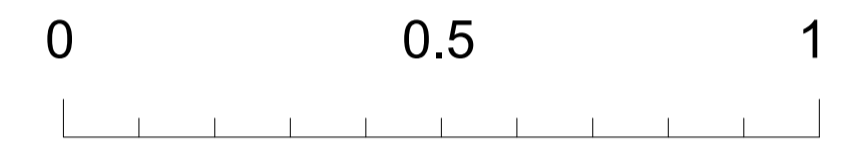

Scale bar 1:10@A1 1:20@A3

Rev.	Date	Description
-	02/05/19	ISSUE FOR PLANNING

Key

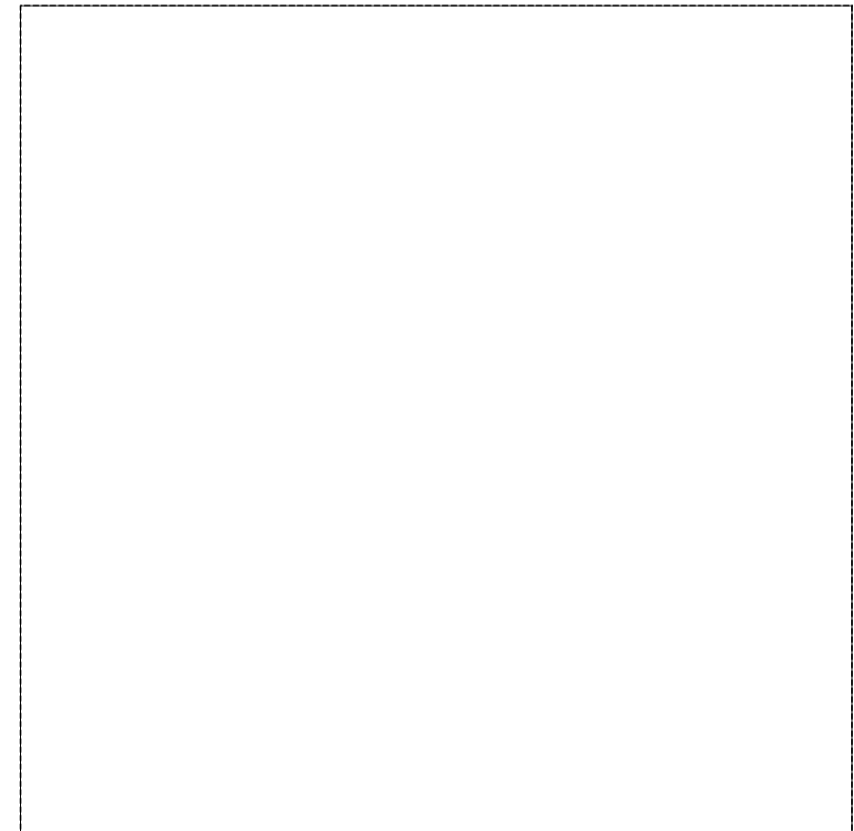

Project
12-22 Theobalds Road

Client
Fenglen Properties Ltd.

Drawing Title
AOV Windows - Typical Details

Scale @ A1 1:10 Scale @ A3 1:20



Morelands 5-23 Old Street London EC1V9HL www.thirdwayarchitecture.com 020 7054 1145

Number 032-TWA-XX-XX-DR-AR-37000 Revision -