

PROPOSED ACOUSTIC DETAILS AS REQUIRED TO DISCHARGE CONDITION 9 OF PLANNING APPROVAL 2016/6366/P

FLOOR TO WALL
JUNCTIONS TO ACOUSTIC
CONSULTANT'S
RECOMMENDATIONS.
REFER TO SECTION 4.7 OF
ACOUSTIC REPORT

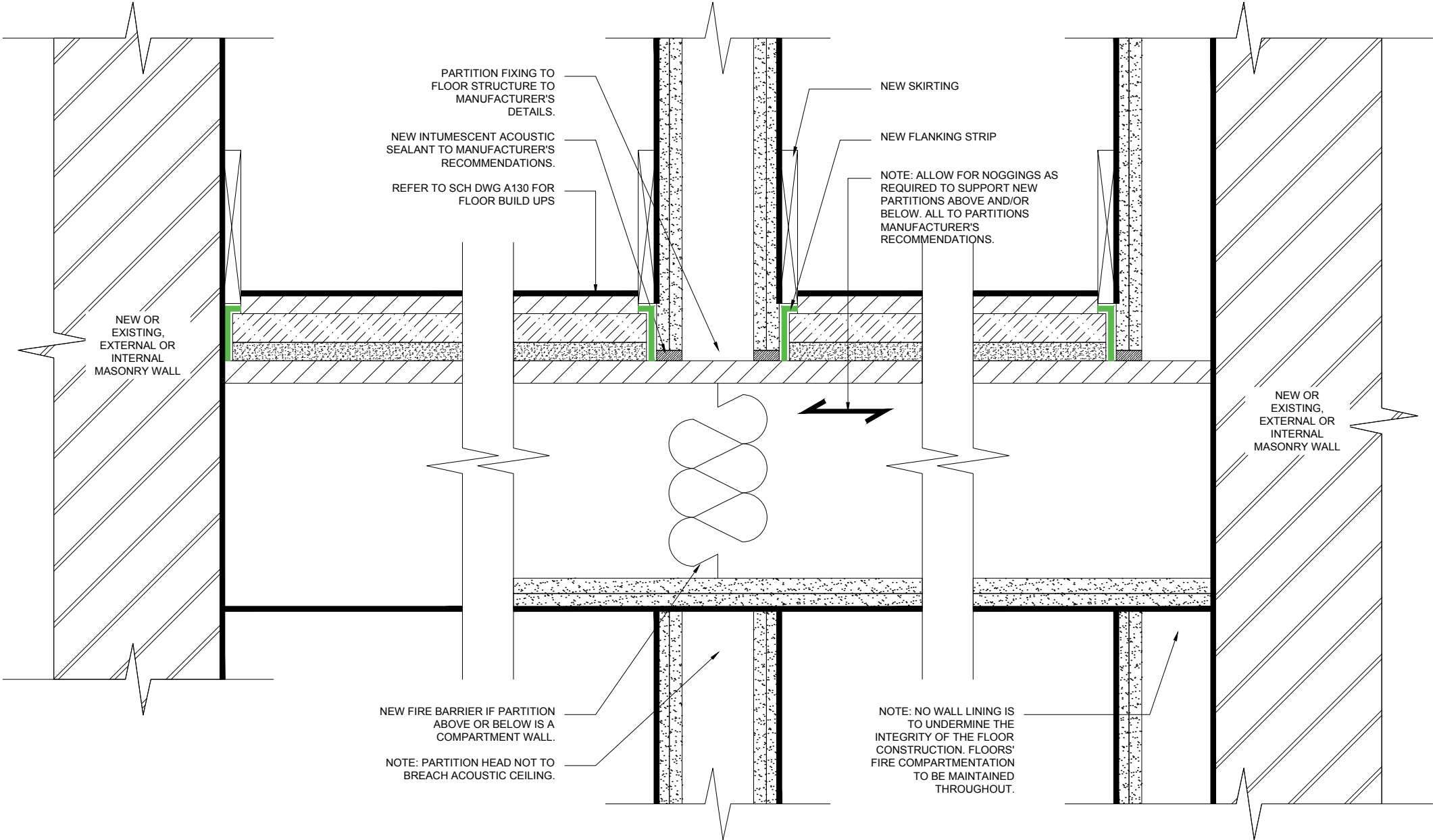

PROPOSED JUNCTIONS BETWEEN FLOORS & MASONRY WALLS & INTERNAL PARTITIONS - SECTION DETAILS
SCALE 1:5 @ A3

1

- NOTES:**
- FLOOR BUILD UP VARIES. REFER TO SCH DWG A131 FOR FLOOR TYPES.
 - NEW PARTITIONS TYPES & NEW WALL LININGS TYPES VARY.
 - FLOOR FINISHES VARY.

SCALE 1:5 @A3
0 0.25m

DRAWING STATUS
PLANNING CONDITION

NOTES:
1. DO NOT SCALE FROM THIS DRAWING.
2. ALL DIMENSIONS ARE TO BE VERIFIED ON SITE BY THE CONTRACTOR.
3. ANY DISCREPANCY FOUND BETWEEN THIS DRAWING AND ANY OTHER DOCUMENTS MUST BE REPORTED IMMEDIATELY TO THE CONTRACT ADMINISTRATOR.
4. REMOVE THIS DRAWING FROM CURRENCY WHEN A REVISED DRAWING IS ISSUED.
5. COPYRIGHT OF THIS DRAWING REMAINS WITH SCH ARCHITECTS.
6. THIS DRAWING IS TO BE READ IN CONJUNCTION WITH THE EMPLOYER'S AND CONSULTANT'S PROJECT DOCUMENTS.

A3

PLANNING
NOT FOR CONSTRUCTION

24.07.19

ISSUED TO LONDON
BOROUGH OF CAMDEN FOR
DISCHARGE OF CONDITION 9

SMITH C-H
ARCHITECTS

23 WEXNER BUILDING
2 STRYPE STREET
LONDON E1 7LF
TEL : 020 7377 8710
email : mail@sch-architects.com
www.sch-architects.com

ARCHITECTS • DESIGNERS

CLIENT

WHITE LION
ESTATES LTD.

PROJECT

72 - 80 LEATHER LANE
LONDON, EC1N 7TR

SCALE
1:5 @ A3

DATE
18.07.2019

DRAWN
AT

CHKD
DS

DRAWING TITLE

PROPOSED FLOOR & WALL
JUNCTIONS - SECTION DETAILS
CONDITION 9

PROJECT NO.
723

DRAWING NO.
A136

REV.
-