

PROPOSED ACOUSTIC DETAILS AS REQUIRED TO DISCHARGE CONDITION 9 OF PLANNING APPROVAL 2016/6366/P

FLOOR JUNCTION WITH
RISER TO ACOUSTIC
CONSULTANT'S
RECOMMENDATIONS.
REFER TO SECTION 4.8.4
OF ACOUSTIC REPORT

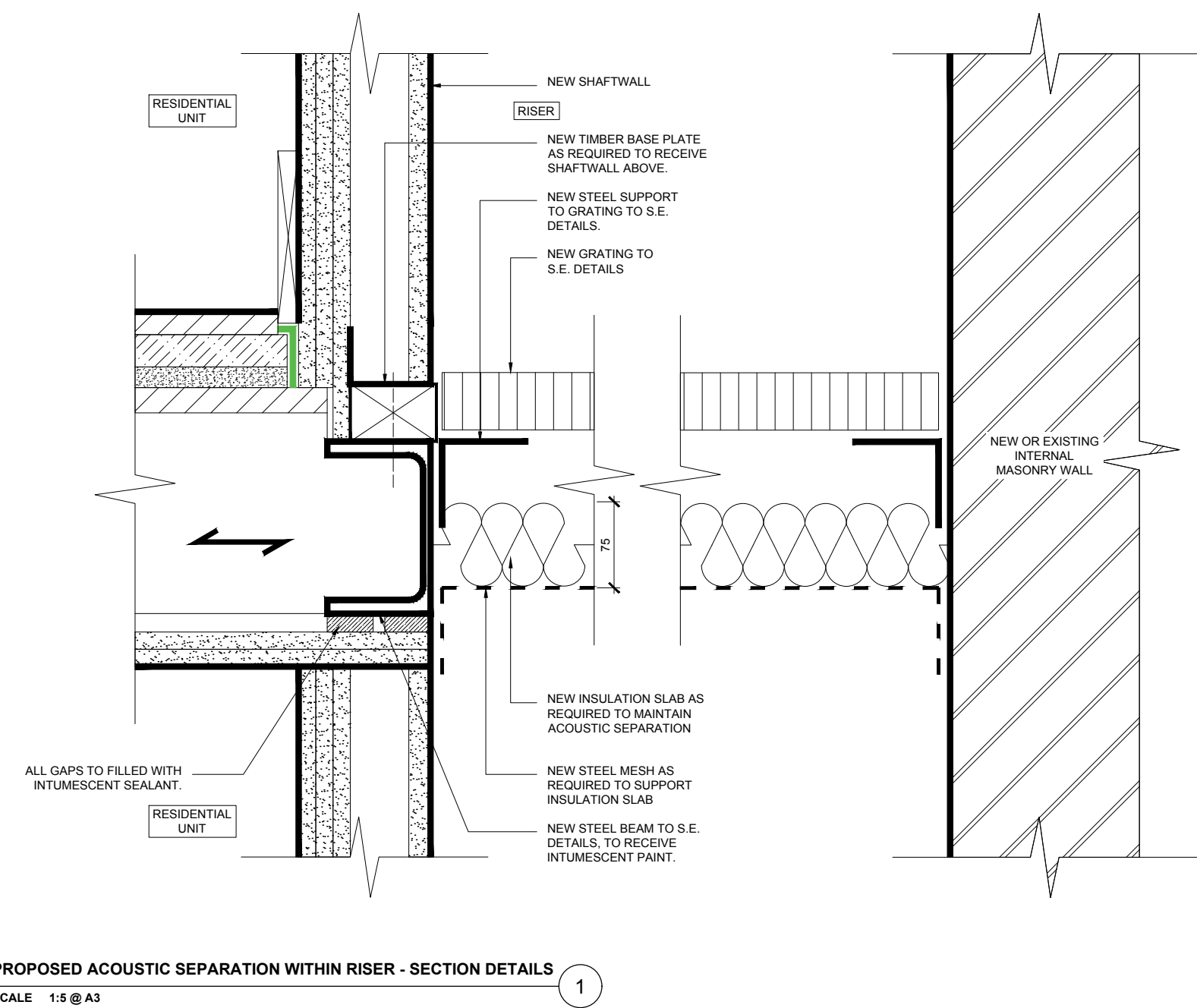

- NOTES:**
- FLOOR BUILD UP VARIES. REFER TO SCH DWG A131 FOR FLOOR TYPES.
 - NEW PARTITIONS TYPES & NEW WALL LININGS TYPES VARY.
 - FLOOR FINISHES VARY.

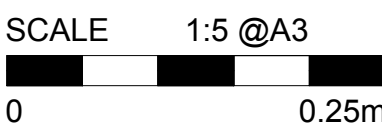

DRAWING STATUS PLANNING CONDITION	
NOTES: 1. DO NOT SCALE FROM THIS DRAWING. 2. ALL DIMENSIONS ARE TO BE VERIFIED ON SITE BY THE CONTRACTOR. 3. ANY DISCREPANCY FOUND BETWEEN THIS DRAWING AND ANY OTHER DOCUMENTS MUST BE REPORTED IMMEDIATELY TO THE CONTRACT ADMINISTRATOR. 4. REMOVE THIS DRAWING FROM CURRENCY WHEN A REVISED DRAWING IS ISSUED. 5. COPYRIGHT OF THIS DRAWING REMAINS WITH SCH ARCHITECTS. 6. THIS DRAWING IS TO BE READ IN CONJUNCTION WITH THE EMPLOYER'S AND CONSULTANT'S PROJECT DOCUMENTS.	
A3	PLANNING NOT FOR CONSTRUCTION
24.07.19 ISSUED TO LONDON BOROUGH OF CAMDEN FOR DISCHARGE OF CONDITION 9	
SMITH C-H ARCHITECTS 23 WEXNER BUILDING 2 STRYPE STREET LONDON E1 7LF TEL : 020 7377 8710 email : mail@sch-architects.com www.sch-architects.com	
ARCHITECTS • DESIGNERS	
CLIENT WHITE LION ESTATES LTD.	
PROJECT 72 - 80 LEATHER LANE LONDON, EC1N 7TR	
SCALE 1:5 @ A3	DATE 18.07.2019
DRAWN AT	CHKD DS
DRAWING TITLE PROPOSED ACOUSTIC SEPARATION WITHIN RISER SECTION DETAILS - CONDITION 9	
PROJECT NO. 723	DRAWING NO. REV. A138 -