

- Existing lightwell slab to be demolished for mechanical services penetration. Refer to proposed architectural drawings for new slab scope of work;
- New toilets to use existing drainage routes. Allowance to be made for opening up works to new drainage outlets;
- Structural openings for existing fireplaces. Make allowance for opening up works and/or fireplace repairs. Refer to services engineers' + architectural drawings for services strategy within significant heritage rooms;
- Structural openings for air supply within underside of seat structure. Refer to propose architectural drawings for repair/upgrade and reinstatement scope of works.
- Make allowance for H/L openings for walls for ventilation grilles. Refer to services engineers' + architectural drawings for services strategy within significant heritage rooms;
- Local builders work openings for ducts to low level FCUs.
- Existing gallery raked seating removed. Existing structure retained.
- Opening in roof slab to allow for exhaust ventilation from below
- Section of balustrade removed and adjusted to suit new raised floor level at landing.
- Builders work openings for services risers - refer to services engineers drawings for sizes of holes. Note: as existing structural layout is unknown, additional fabric may need to be removed to facilitate structural reinforcement.

**Notes:**  
 Drawings are based on survey data and may not accurately represent what is physically present.  
 All dimensions are to be verified on site before proceeding with the work.  
 All dimensions are in millimeters unless noted otherwise.  
 Purcell shall be notified in writing of any discrepancies.

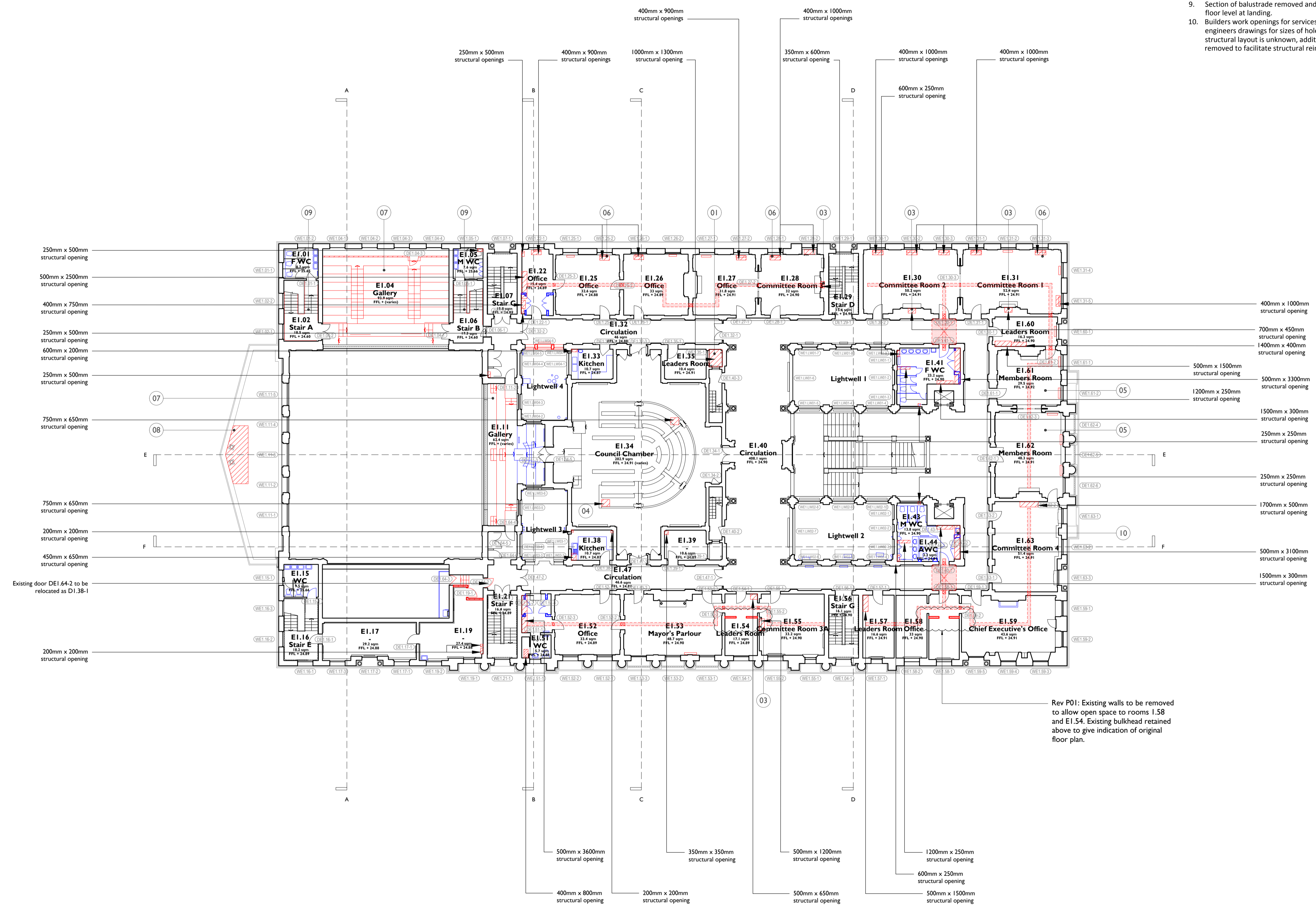

**Demolitions & Alterations Key**

- Original fabric defined as that documented in Archive Drawings. Where date of fabric is unknown, it is assumed as original.
- Original Fabric: Section of Wall/Slab to be Demolished
  - Original Fabric: Item to be Demolished
  - Overhead - 300mm wide opening to ceiling for high level concealed cable distribution - make good after installation
  - Overhead: Whole bay of vaulted ceiling to be removed for cabling distribution and reinstated
  - Original Fabric: High level opening in wall for services distribution
  - Floor trenches in slab for cable distribution
  - Manhole: Opening in slab
  - Non-Original Fabric: Section of Wall to be Demolished
  - Non-Original Fabric: Item to be Demolished
  - Window Number
  - Door Number
  - Annotation Item

Drawings to be read in conjunction with:  
 Internal Repairs & Builder's Works drawing series (93)000 for key spaces  
 Conservation Strategy Report CTH-PUR-MP-00-SP-A-00005

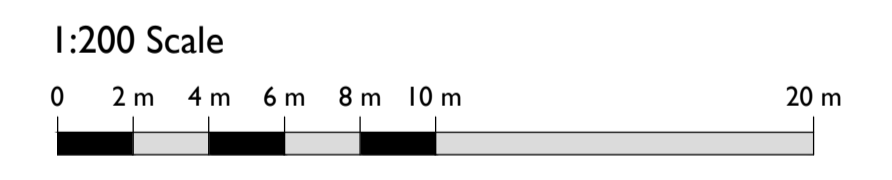

SS P01	08 Jul 2019	NS	NS
SS P00	17 Apr 2019	OB	NS

ISSUE	DATE	DRAWN	CHECKED	DESCRIPTION
<b>DRAWING TITLE</b>	GA PROPOSED DEMOLITIONS AND STRIP OUT FIRST FLOOR LEVEL PLAN			
<b>DRAWING NO.</b>	CTH-PUR-MP-01-DR-A-91002			
<b>REVISION</b>	SS P01			
<b>SIZE &amp; SCALE</b>	A1L 1:200			
<b>DRAWING STATUS</b>	SS SUITABLE FOR PLANNING			

**I 91002 1:200 @ A1**  
**FIRST FLOOR LEVEL PLAN PROPOSED DEMOLITIONS AND STRIP OUT**

