

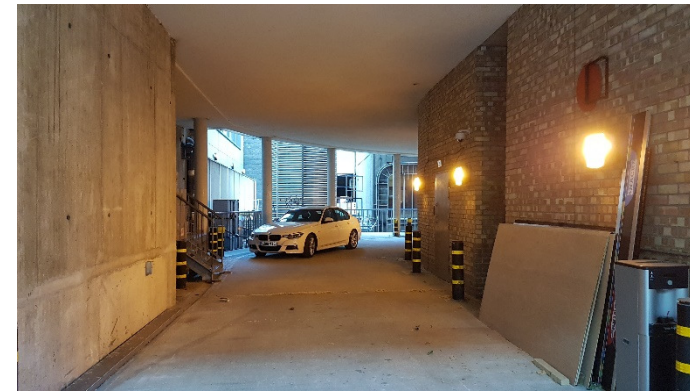

▲ photo A: view from gate at Gordon Street pavement



▲ photo C: view from Taviton Street



▲ photo D: view within Taviton Street gate



▲ photo F: existing plant tower

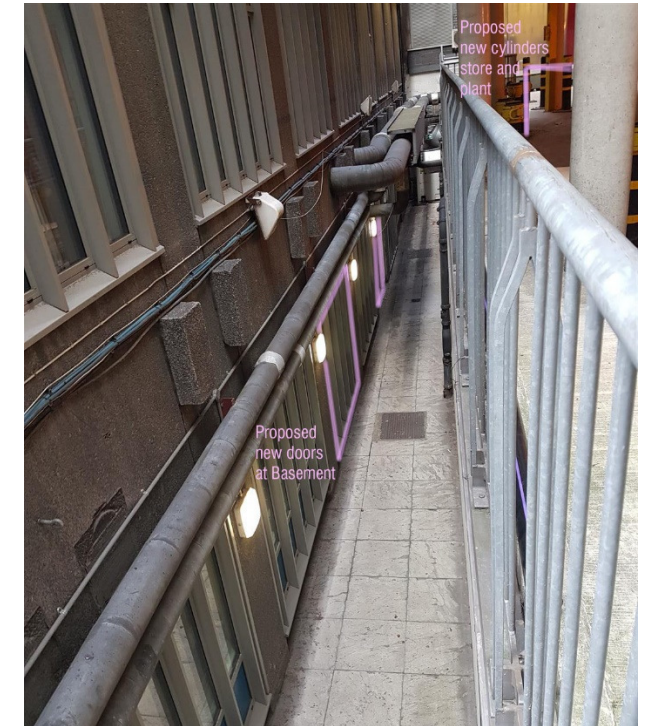

▲ photo J



▲ photo B: existing rear plant compound



▲ photo E: markup of proposed AHU and cylinders store location



▲ photo G ▼ photo H: private roadway below SSEES building



▲ photo K: existing doors

▲ photo L: existing windows

