

EAGLE STREET

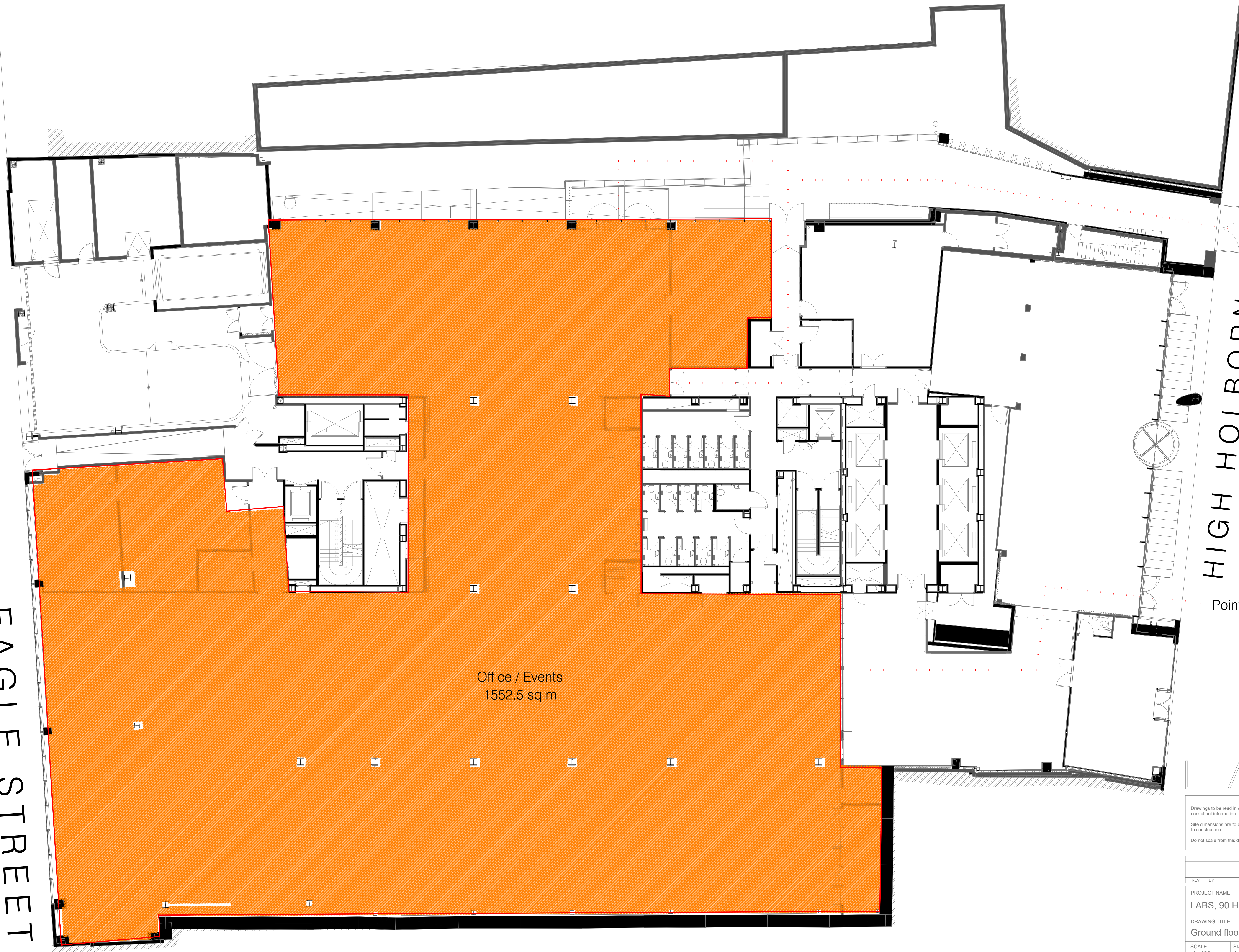

Point of access

HIGH HOLBORN

Point of access

LABS

NOTES:
Drawings to be read in conjunction with all other architectural & design consultant information.
Site dimensions are to be confirmed on site by contractor or joiner prior to construction.
Do not scale from this drawing.

REV	BY	DESCRIPTION	DATE

PROJECT NAME:
LABS, 90 High Holborn, Camden

DRAWING TITLE:
Ground floor proposed events

SCALE: 1 : 100	SIZE: A1	DATE: 12/06/19	BY: YR	STATUS:
PROJECT REF:	DRAWING NUMBER: HH-PL-ET01	REVISION:		

