

8A Rowley Way - proposed kitchen elevations

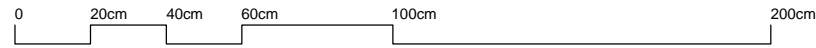

- 1.01 Walls: Existing textured paint sanded, plaster skim where necessary to make good and new matt white paint finish.
- 1.02 Floor: Lino flooring as Marmoleum Concrete 'Kaolin' by Forbo.
- 2.02 Balustrade: Black paint to existing posts,rails and panels, striped/sanded down and retreated to bring them backas close as possible to the original timber finish.
- 7.01 600mm deep counter: Glazed porcelain tiles as 96mmx96mm (laid at 100mm centres) 'Chocolate' colour Tessera by Reed Harris. .
- 7.02 410mm deep Counter: Glazed porcelain tiles as 96mmx96mm (laid at 100mm centres) 'Chocolate' colour Tessera by Reed Harris. Round corner and double round corner specials to edges.
- 7.03 Wall splashback: 96mm x 96mm glazed porcelain tiles laid at 100mm centres. As 'Chocolate' Tessera by Reed Harris.
- 7.04 Cupboards: Bespoke timber shelves and cupboards made from Beech wood/ Beech plywood.
- 7.05 Draws : Bespoke timber draws made from Beech wood / Beech plywood.
- 7.06 Light fixture: New wall mounted light fitting as Artimide Dioscuri 25cm dia.
- 7.07 Riser finish: New plaster skim to make good and matt white paint finish.
- 7.08 Oven and hob: New fitted electric oven and hob.
- 7.09 Sink: Stainless steel basin.
- 7.10 Partition: Remaining area of original blockwork wall retained.
- 7.11 Shelves (above): Bespoke timber shelves made from beech plywood.
- 7.12 Sockets: New electricity sockets flush with wall.
- 7.13 Services: Location of existing water, gas and electric runs retained, replacement water pipes where necessary.

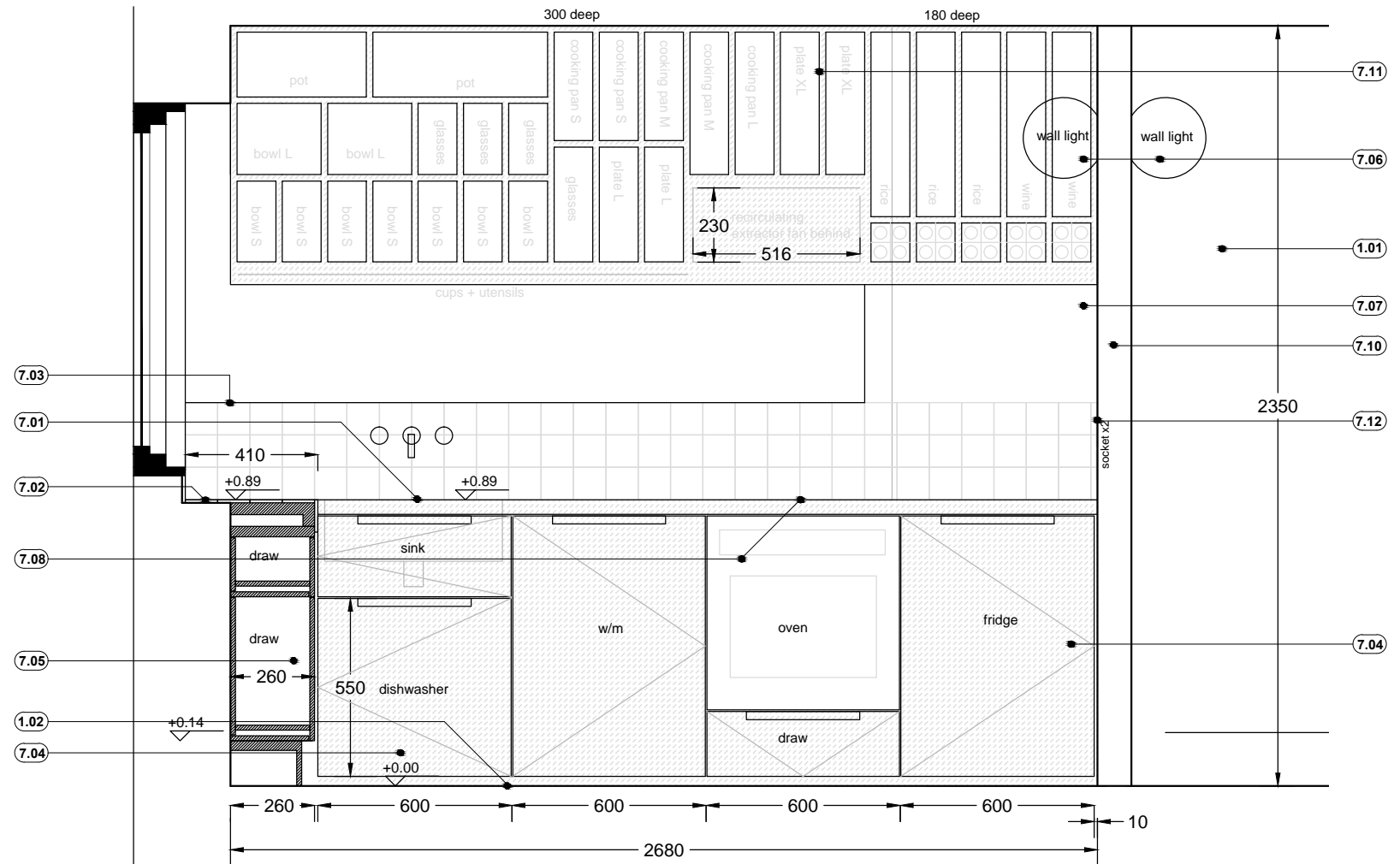

Elevation AA (West) 1:20@A3

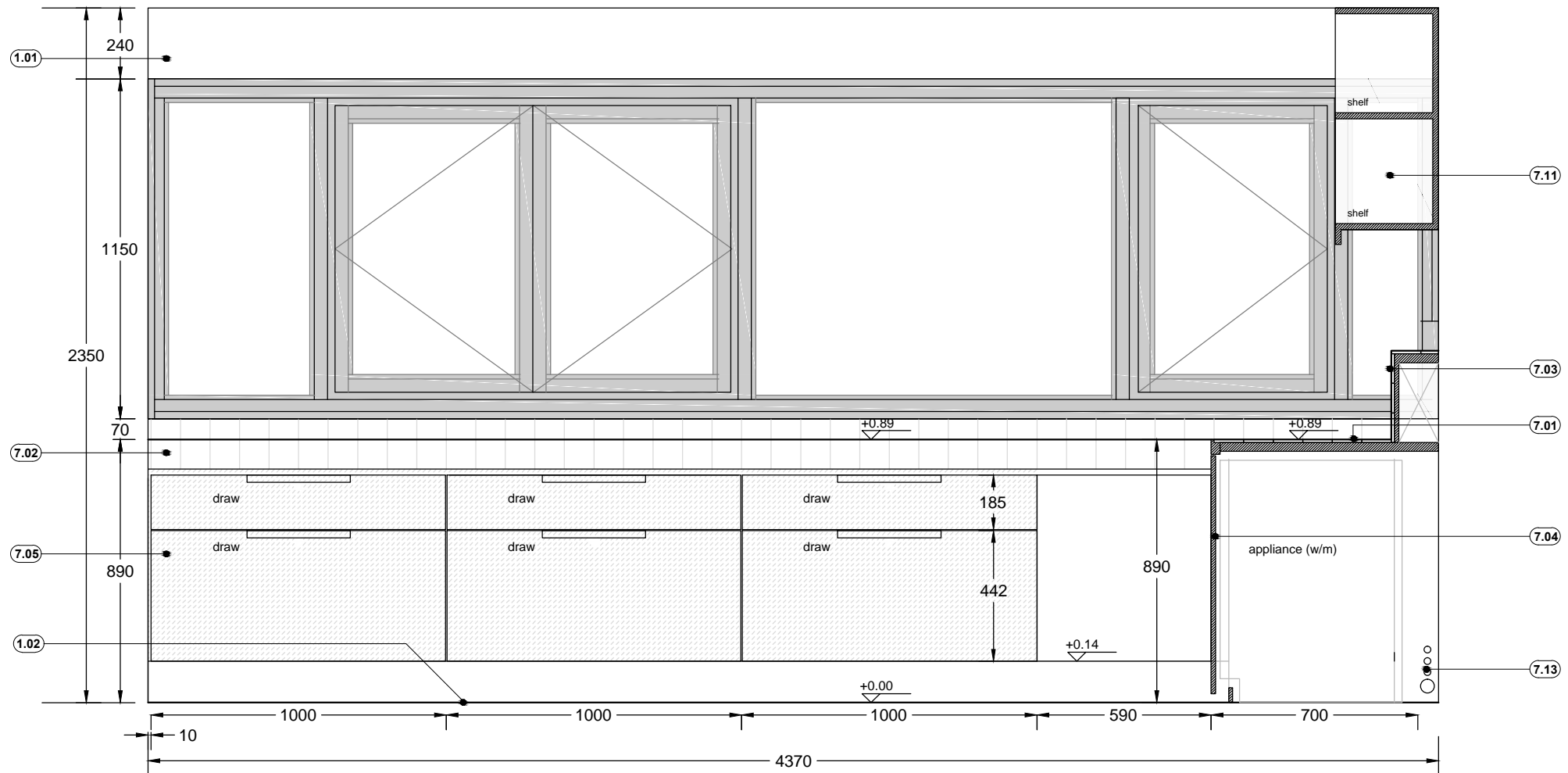

Elevation BB (South) 1:20@A3

DRAFT

revB: 191007_JW
revA: 191003_JW

8A Rowley Way

Proposed kitchen elevations

Status PLANNING

DWG no. 100.006 revB

Date 2018.12.20

By WallaceLiu