

CLIENT:
3 Verulam Buildings

PROPERTY:
**1 Verulam Buildings,
 Gray's Inn, London
 WC1R 5NT**

DRAWING TITLE:
**Proposed General
 Arrangement Plan**

REV.	DATE:	DESCRIPTION:
B	12.07.19	New partitions offset from window surrounds
A	28.05.19	Updated to reflect preferred scheme S103

NOTES:
 No dimensions are to be scaled from this drawing. All dimensions are to be checked on site, where discrepancy occurs between specification and drawings the supervising officer must be notified.

SCALE @ A1: **1:50** DATE: **23.04.19**

DRAWING NUMBER: **102229-PR01**

DRAWN: EM	CHECKED: PR	REV: B
------------------	--------------------	---------------

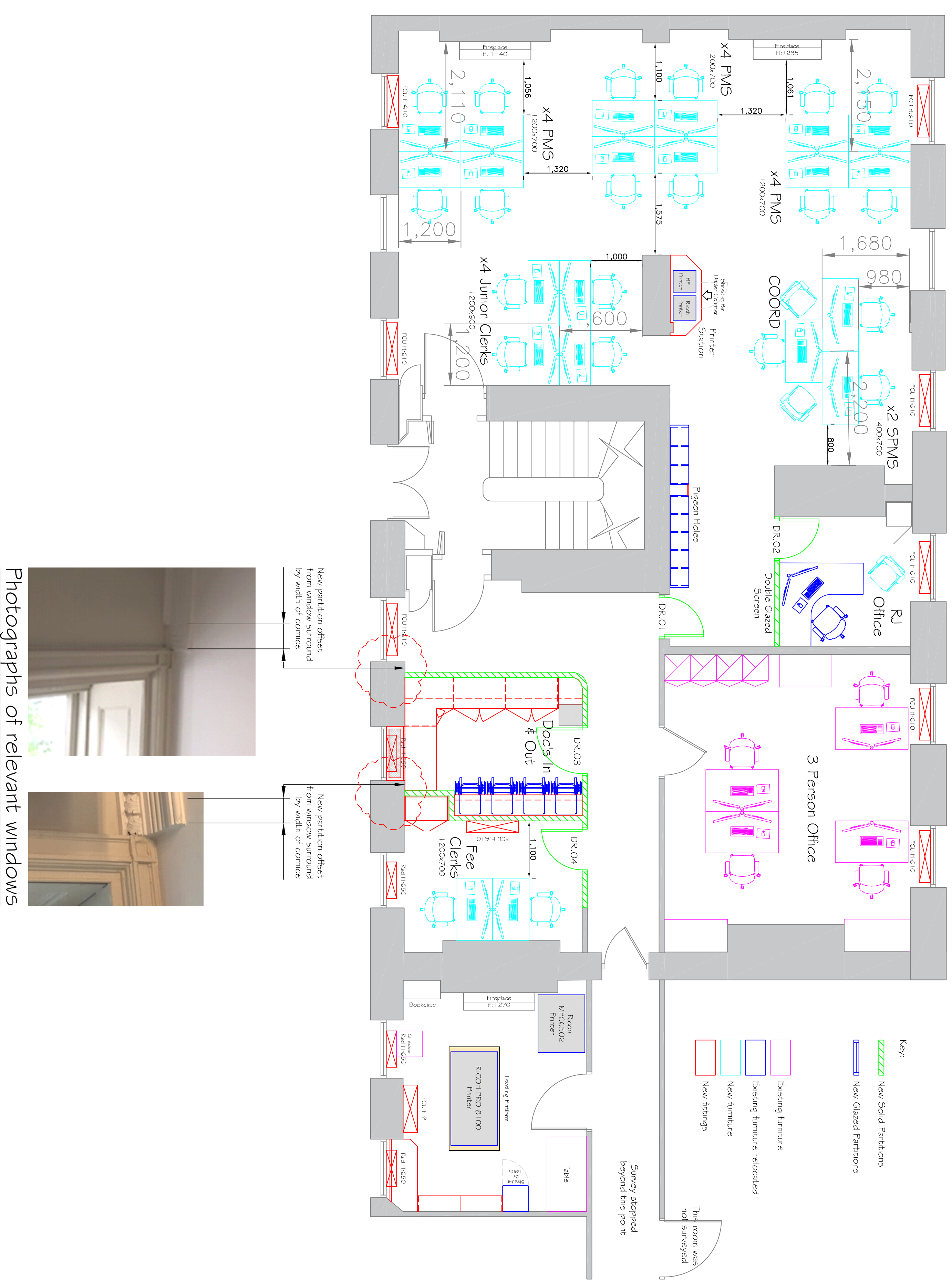

Photographs of relevant windows