

© Portakabin Limited 2007  
 This drawing is the property of Portakabin Limited,  
 it must not be copied or reproduced or divulged  
 to anyone without written permission.  
 Rev. Date By

\* NOTE O/ALL WIDTH FOR  
 CONTINENTAL EUROPEAN  
 BUILDINGS

DOOR & WINDOW POSITIONS MAY BE  
 DIFFERENT TO THOSE SHOWN ON  
 CONTRACT DRAWINGS

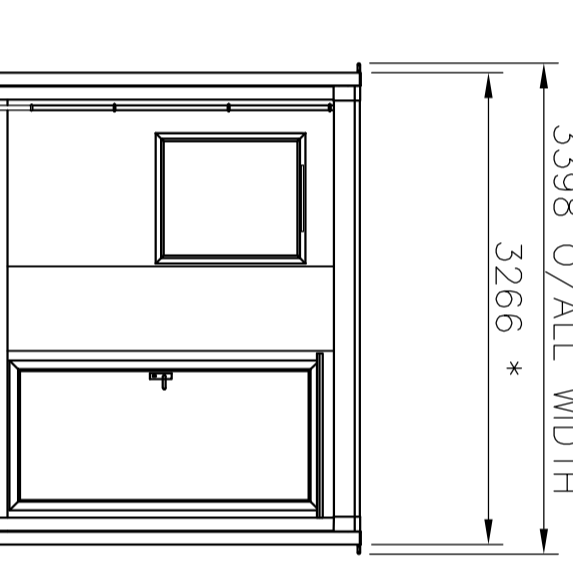

END ELEVATION

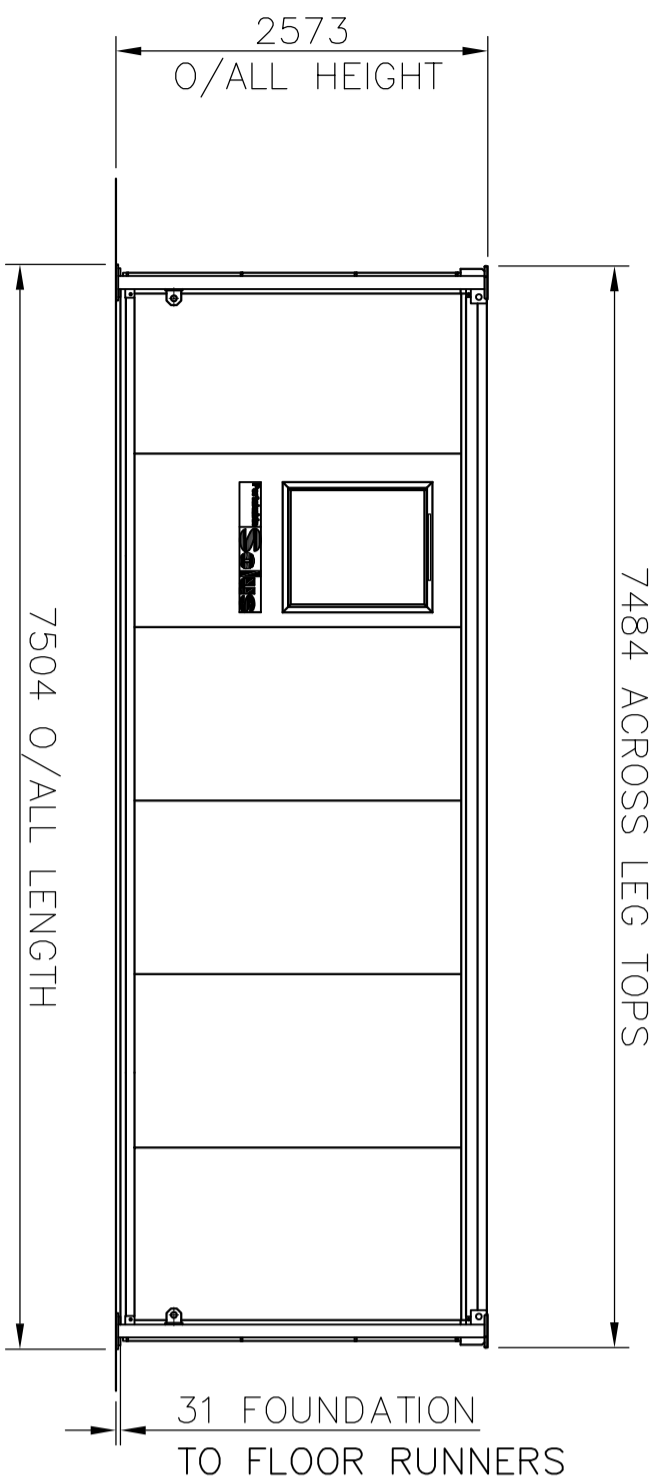

REAR ELEVATION

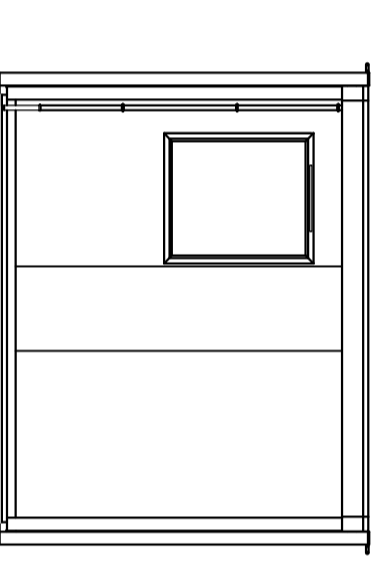

END ELEVATION

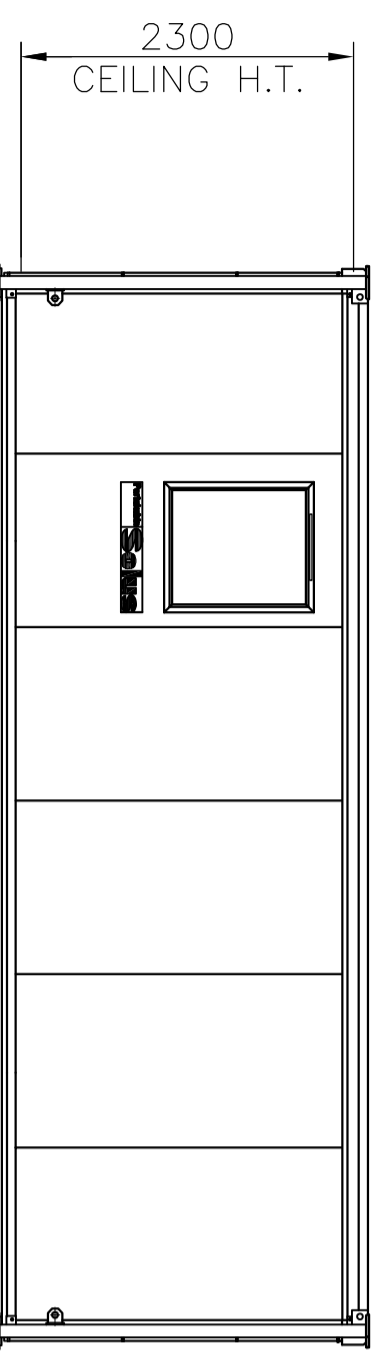

FRONT ELEVATION

- STANDARD COLOURS**
- External : Wall Cladding,  
 Fascia, Corner &  
 Bottom Wall Trims  
 Door leaf
- Sales & Scottish Divisions - Albatross nearest BS ref. 18 B 17
  - Hire & European Divisions - Goosewing Grey nearest BS ref. 10 A 05
  - Sales & Scottish Divisions - Britannia Blue nearest BS ref. 18 E 58
  - Hire - Merlin Grey nearest BS ref. 18 B 25
  - Portlao & Events - Poppy Red nearest BS ref. 04 E 53
  - European Division - Goosewing Grey nearest BS ref. 10 A 05
  - Silver Anodised Aluminium.
  - Manhattan Grey NCS S 2502-Y RAL-DS 080 70 05.
  - Sales & Scottish Divisions - Britannia Blue nearest BS ref. 18 E 58
  - Hire - Grey nearest RAL 7042
  - Portlao & Events - Blue Grey nearest BS ref. 18 B 29
  - European Divisions - Blue nearest BS ref. 00 E 55
  - White nearest BS ref. 10 A 05
  - Grey to BS4800 ref. 10 A 05
  - Hot dipped galvanised
- Door Frame  
 Door Furniture  
 Windows
- Roof  
 Outer Legs  
 Inner Legs

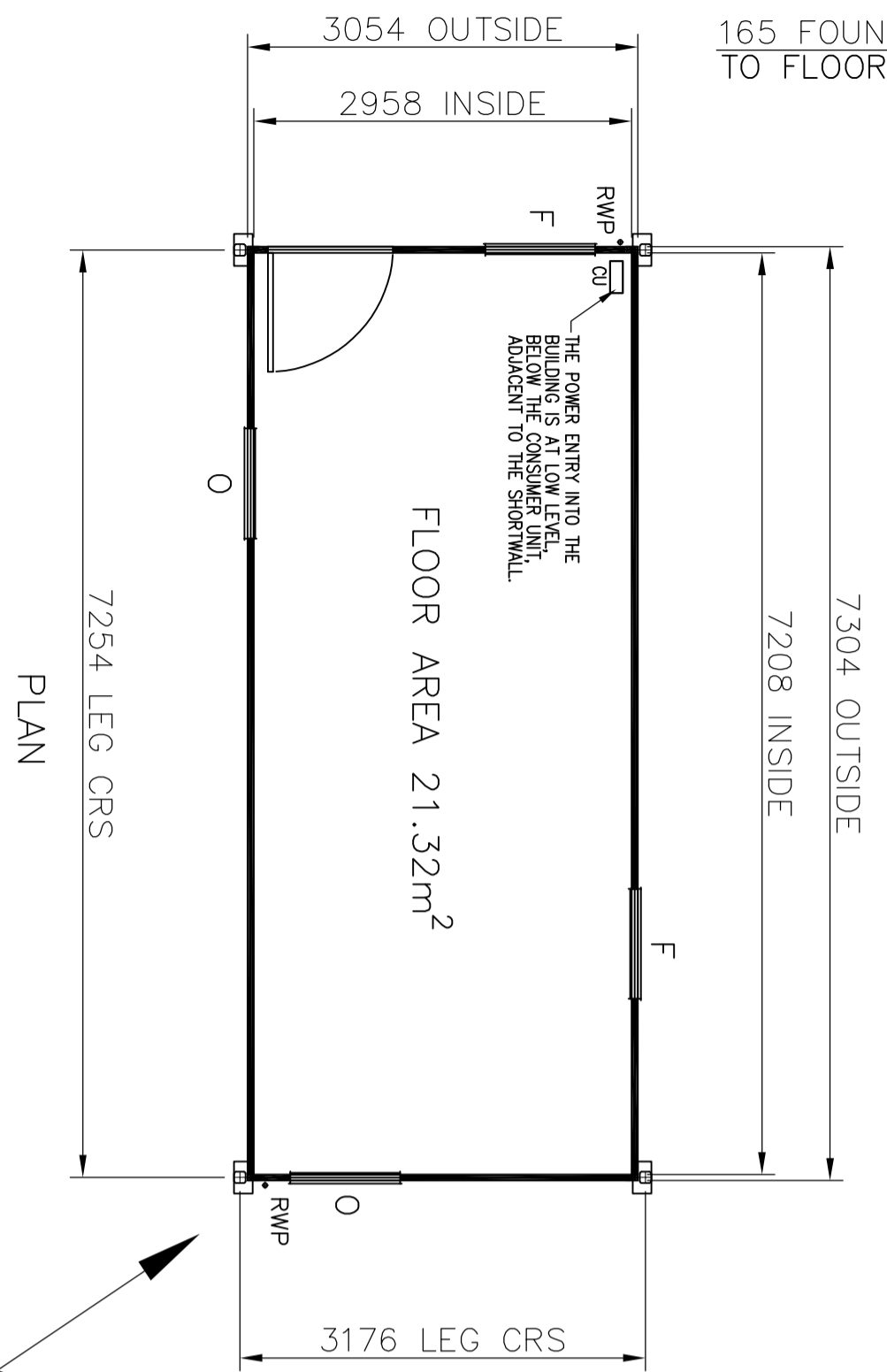

PLAN

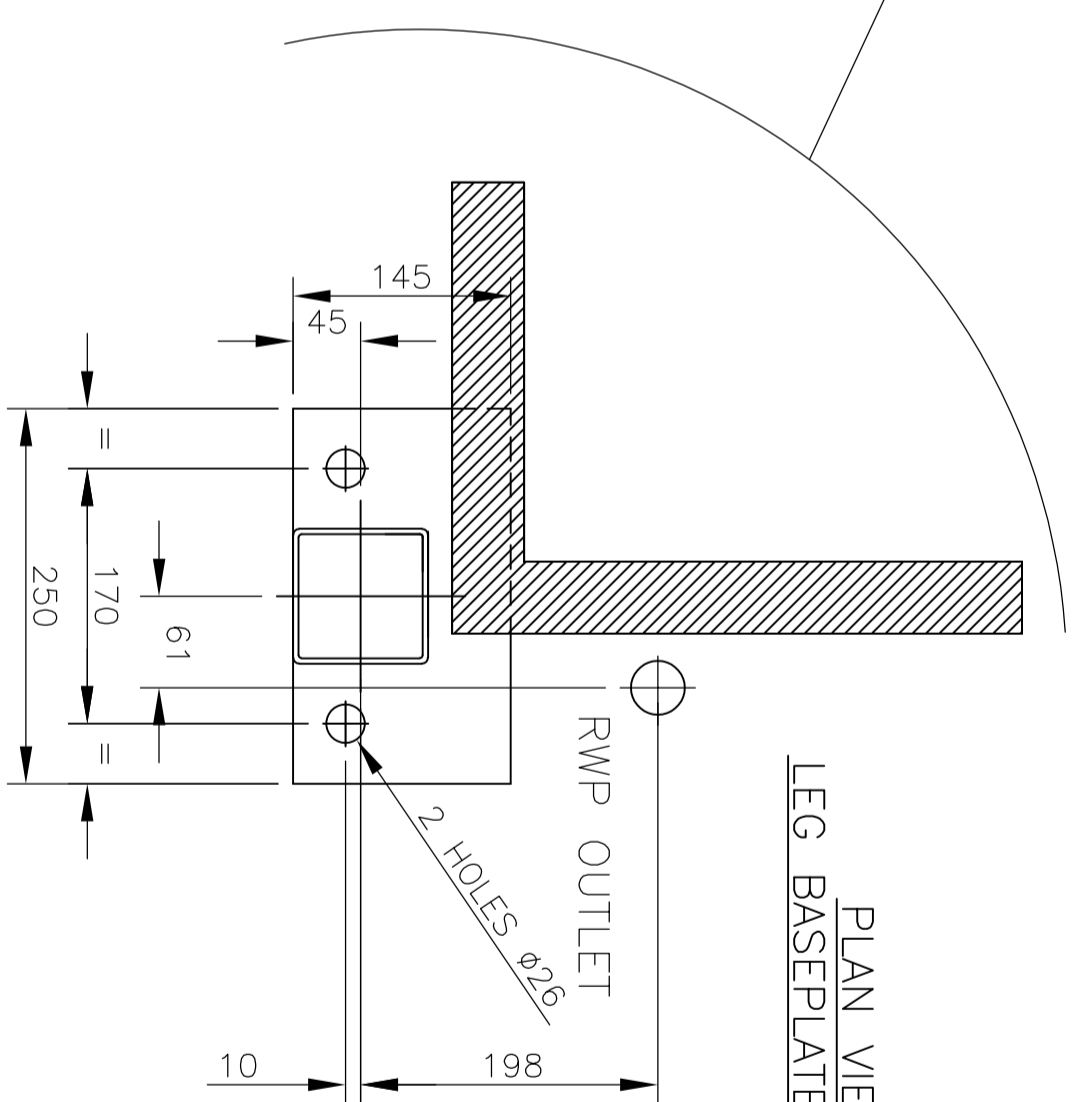

PLAN VIEW  
 LEG BASEPLATE DETAIL

- KEY**
- O OPEN WINDOW
  - F FIXED WINDOW
  - RWP RAIN WATER PIPE
  - CU CONSUMER UNIT

**FOUNDATIONS**

Simple foundations of level hardstandings are required to be capable of taking the foundation design load at each foot position of 26kN, which includes the dead weight of the building, imposed floor load of 3kN/m<sup>2</sup>, imposed roof load of 0.75kN/m<sup>2</sup>, and a basic wind speed to meet the requirements of BS6399: Part 2.

The foundations are to be designed in accordance with BS8004 with level tops of a tolerance of ±3mm.

The area of ground under the building, plus a surrounding 500mm must be no higher than 50mm below the tops of the building foundations.

All buildings are to be anchored to the foundations via the baseplate using M20 anchor bolts, unless it can be established that no climatic or other forces are likely to be applied so as to exceed the intrinsic stability of the building in its unloaded state.

All Lodastrut legs should be fully retracted onto the safety stops with the leg pins fitted through the outer legs and secured by the locking cotter.

It is recommended that professional advice is obtained for the design of the foundations.

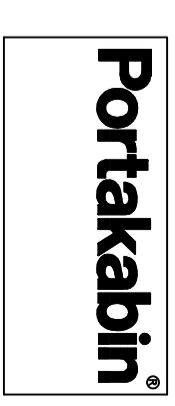

Portakabin Limited Huntington York YO32 9PT  
 Telephone 01904 611655 Fax 01904 611644

Project	PORTAKABIN SOLUS	
Client		
Title	SPECIFICATION DRAWING SLO72 LODASTRUT LEG OPTION	
Date	2.10.07	Drawn R.SCHOFIELD
Scale	1:5 & 1:50	
Dwg. No.	DQ2692	Rev. D