

SIDE ELEVATION AS PROPOSED

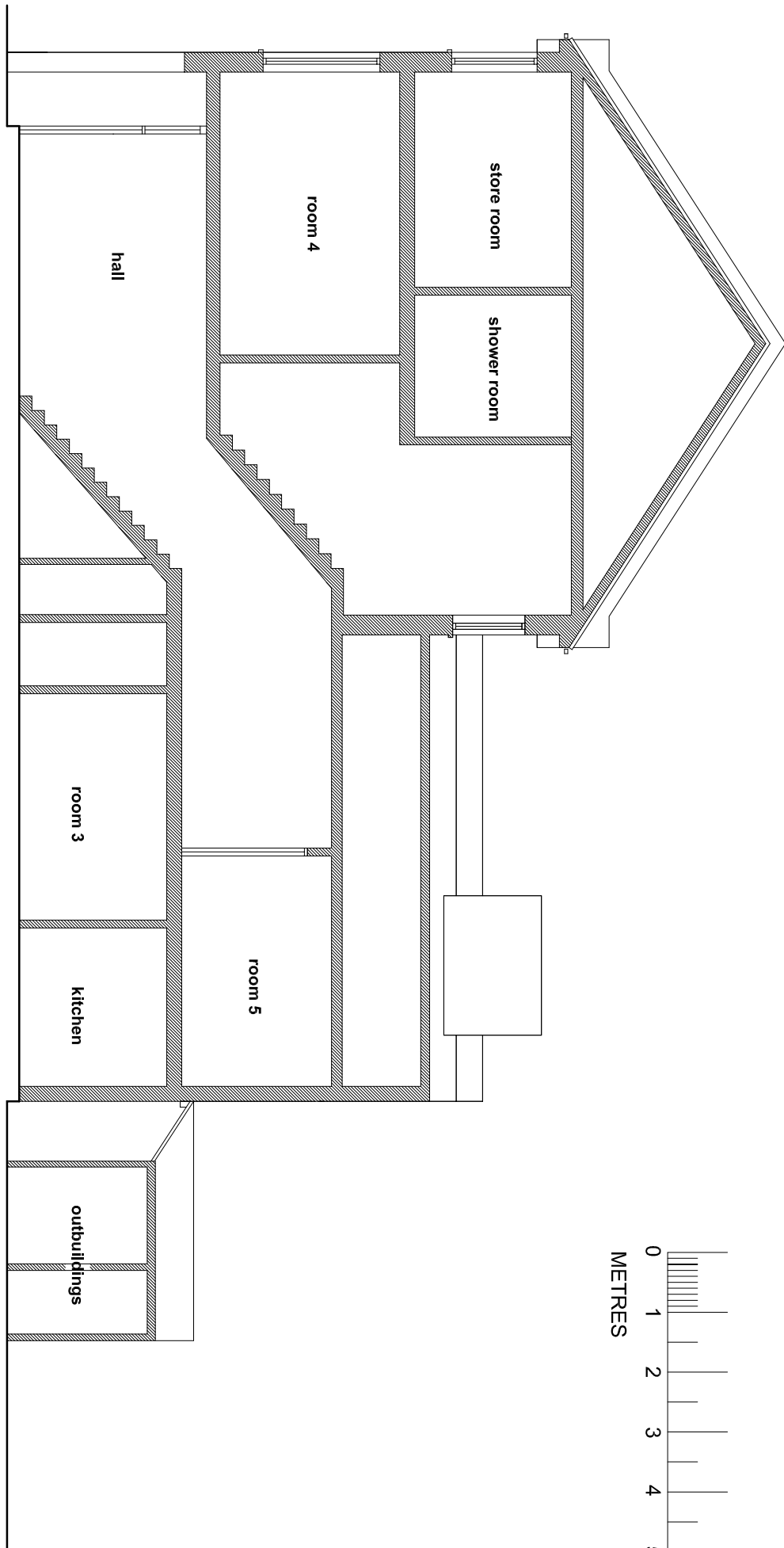

LONG SECTION AS EXISTING

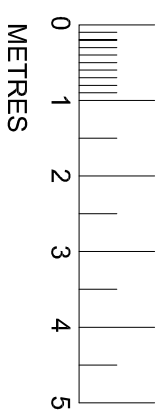

REV A - GF EXTENSION AND DORMERS CHANGED RR JUNE 14TH 2019

PROPOSED WORKS AT
17 FORDWYCH ROAD
LONDON NE2 3TN

LONG SECTIONS
AS EXISTING AND AS PROPOSED

1:100 @ A3

DRAWN RR 25.03.19

RICHARD ROBINSON RIBA
RR ARCHITECTS
3 PACIFIC COURT
RIVERSIDE
SHOREHAM BY SEA BN43 5RW
01273 452 634 07860 632 542
E-MAIL richard@rr-architects.co.uk

