

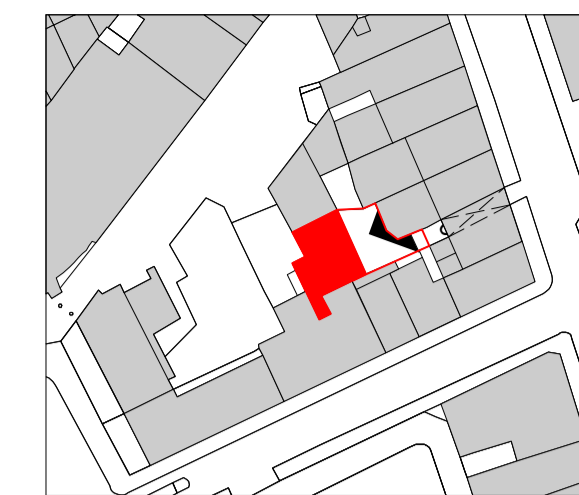

KEY PLAN



NOTES

- Do not scale from this drawing.
- 1. Existing Brick
- 2. Reclaimed Brick
- 3. Standing Seam Zinc Roof
- 4. Timber Framed Double Glazed Window
- 5. Reclaimed Engineering Brick
- 6. Zinc Rainwater Pipe
- 7. Timber Framed Fixed Double Glazing with Privacy Glass
- 8. Timber Framed Fixed Double Glazing with Clear Glass
- 9. Timber Framed Stable Door with Double Glazing

12.06.19 Planning
REV DATE FOR



David Kohn Architects

Bedford House
125-133 Camden High Street
London NW1 7JR

+44(0)20 7424 8596
info@davidkohn.co.uk

www.davidkohn.co.uk

PROJECT
Wheatsheaf Yard

PROJECT ADDRESS
50c Red Lion Street
London
WC1R 4PF

CLIENT
Patricia Lennox-Boyd & Jamie Stevens

RIBA Plan of Work
Stage 3

DRAWING TITLE
Proposed Elevation - Front

DRAWING NUMBER
218-PL15-01

CURRENT REVISION DATE FIRST ISSUED
* 12.06.19

CURRENT ISSUE DRAWN BY
Planning JD

SCALE CHECKED BY
1:50 @ A1 JL
1:100 @ A3



KEY PLAN

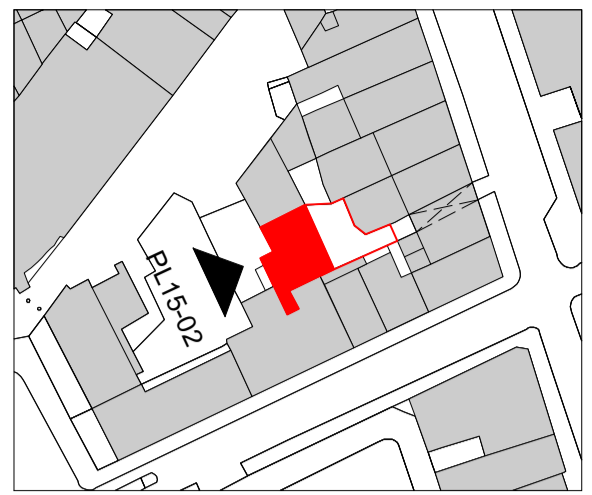

NOTES

- Do not scale from this drawing.
- 1. Reclaimed Brick
- 2. Existing Brick
- 3. Timber Framed Double Glazed Window
- 4. Timber Framed Stable Door with Double Glazing

- 12.06.19 Planning
REV DATE FOR



David Kohn Architects

Bedford House
125-133 Camden High Street
London NW1 7JR

+44(0)20 7424 8596
info@davidkohn.co.uk

www.davidkohn.co.uk

PROJECT
Wheatsheaf Yard

PROJECT ADDRESS
50c Red Lion Street
London
WC1R 4PF

CLIENT
Patricia Lennox-Boyd & Jamie Stevens

RIBA Plan of Work
Stage 3

DRAWING TITLE
Proposed Elevation - Rear

DRAWING NUMBER
218-PL15-02

CURRENT REVISION * DATE FIRST ISSUED
12.06.19

CURRENT ISSUE DRAWN BY
Planning JD

SCALE CHECKED BY
1:50 @ A1 JL
1:100 @ A3

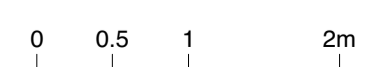

KEY PLAN

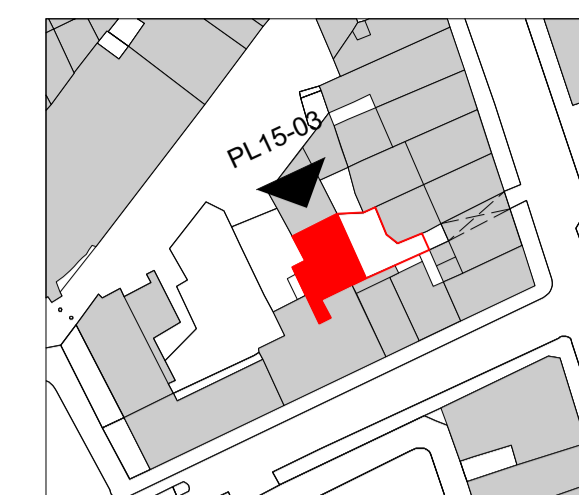

NOTES

- Do not scale from this drawing.
- 1. Standing Seam Zinc Roof
- 2. Timber Framed Stable Door with Double Glazing
- 3. Zinc Rainwater Pipe
- 4. Existing Brick
- 5. Reclaimed Brick
- 6. Timber Framed Double Glazed Window with Privacy Glass
- 7. Timber Framed Fixed Double Glazing with Privacy Glass
- 8. Corrugated Metal Sheetting

12.06.19 Planning
REV DATE FOR



David Kohn Architects

Bedford House
125-133 Camden High Street
London NW1 7JR

+44(0)20 7424 8596
info@davidkohn.co.uk

www.davidkohn.co.uk

PROJECT
Wheatsheaf Yard

PROJECT ADDRESS
50c Red Lion Street
London
WC1R 4PF

CLIENT
Patricia Lennox-Boyd & Jamie Stevens

RIBA Plan of Work
Stage 3

DRAWING TITLE
Proposed Elevation - Side

DRAWING NUMBER
218-PL15-03

CURRENT REVISION * DATE FIRST ISSUED
12.06.19

CURRENT ISSUE DRAWN BY
Planning JD

SCALE CHECKED BY
1:50 @ A1 JL
1:100 @ A3

