

List of changes from consented scheme:

- Basement lowered by 85mm.
- Side extension lowered by 200mm.
- Dormer cheeks made to match dimensions as per existing dormer windows in courtyard.
- Basement lightwells shown with amendments to stair and wall.

2 x new DT01 dormers on south roof slope
 3 x new DT03 dormers on south roof slope
 New west single storey extension serving Unit 5
 New single glazed leaded doors
 Red brick, to match existing
 Stone quoins

1 x Bat Box
 New tiled roof
 New east extension serving Unit 1
 New single glazed leaded window
 New single glazed leaded door
 Red brick, to match existing
 New steps to lightwell
 Conversion of 3 existing windows to New single glazed leaded doors for external access
 New balustrade type BT02

PROPOSED SOUTH ELEVATION



EXISTING SOUTH ELEVATION

Revisions					Revisions						
Rev	Date	By	Description	Checked	Approved	Rev	Date	By	Description	Checked	Approved
P1	21.12.18	TS	For NMA Issue	JM	RH						
P2	06.06.19	AD	NMA Re-issue	ASP	RH						
P3	13.06.19	AD	NMA Re-issue - Rev Cloud Updates	RB	RH						

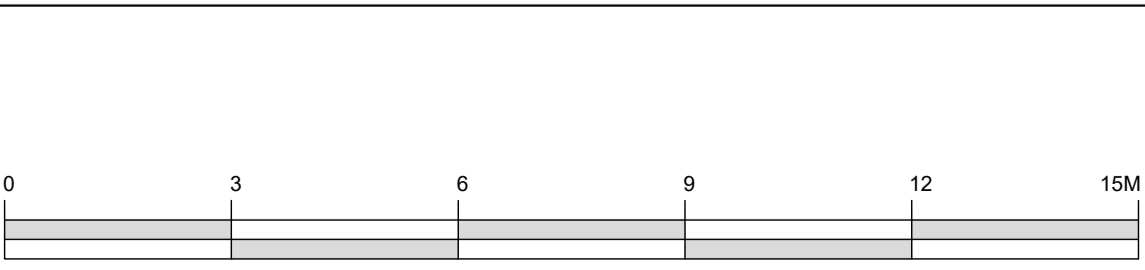

For electrical services (inc. lighting and cctv) refer to MEP engineer drawings
 For finishes refer to 289_1_2_Planning Facing Materials_1128L

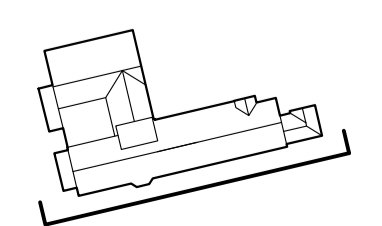

Client Sign Off	North	Approved / Originator: Tate Harmer	Unit 1182, Stamford Works, 3 Gilbert Street, London N16 8JH Tel: +44 (0)207 241 7481 Email: studio@tateharmer.com	Do not scale. All dimensions to be checked on site. This drawing is copyright.
		Client: Platinum Land	8 Quagga House, 1 Duke of York Square, Kings Road, London, SW3 4LY	
		Project: Belsize Park Firestation	Date of Origin: 28.11.17	Drawn By: TS
		Drawing Title: Proposed and Existing South Elevation	Scale: 1:100 @ A1	Drawing Status: Planning
		Drawing Number: BFS THA PR PA 300 P3		