

DO NOT SCALE
 THIS DRAWING IS © IAN RITCHIE ARCHITECTS LTD
 Dimensions to be verified on site.
 Figure dimensions to take preference to those scaled.
 All discrepancies to be clarified with the project architect.
 Unless otherwise stated all levels to be AGD.
 This drawing is the property of Ian Ritchie Architects Ltd. and is
 issued on the condition it is not reproduced, related or
 disclosed to any unauthorised person, either wholly or in part without
 written consent.

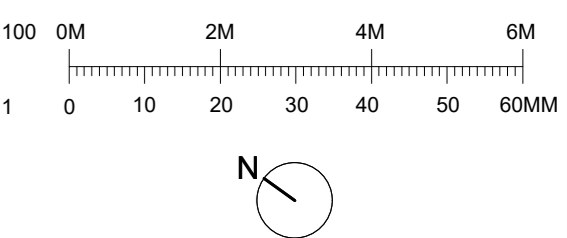

- AREAS OF HIGH HERITAGE VALUE TO BE SAFE GUARDED
- AREAS OF EXISTING CIRCULATION SPACE WITH ORIGINAL FEATURES RETAINED (The areas shown are a minimum and may be extended subject to future phasing requirement)
- INTERNAL AREAS WHERE REMOVAL OF PARTITIONS IS PERMISSIBLE TO CREATE OPEN PLAN LAB, TEACHING + WRITE-UP SPACE

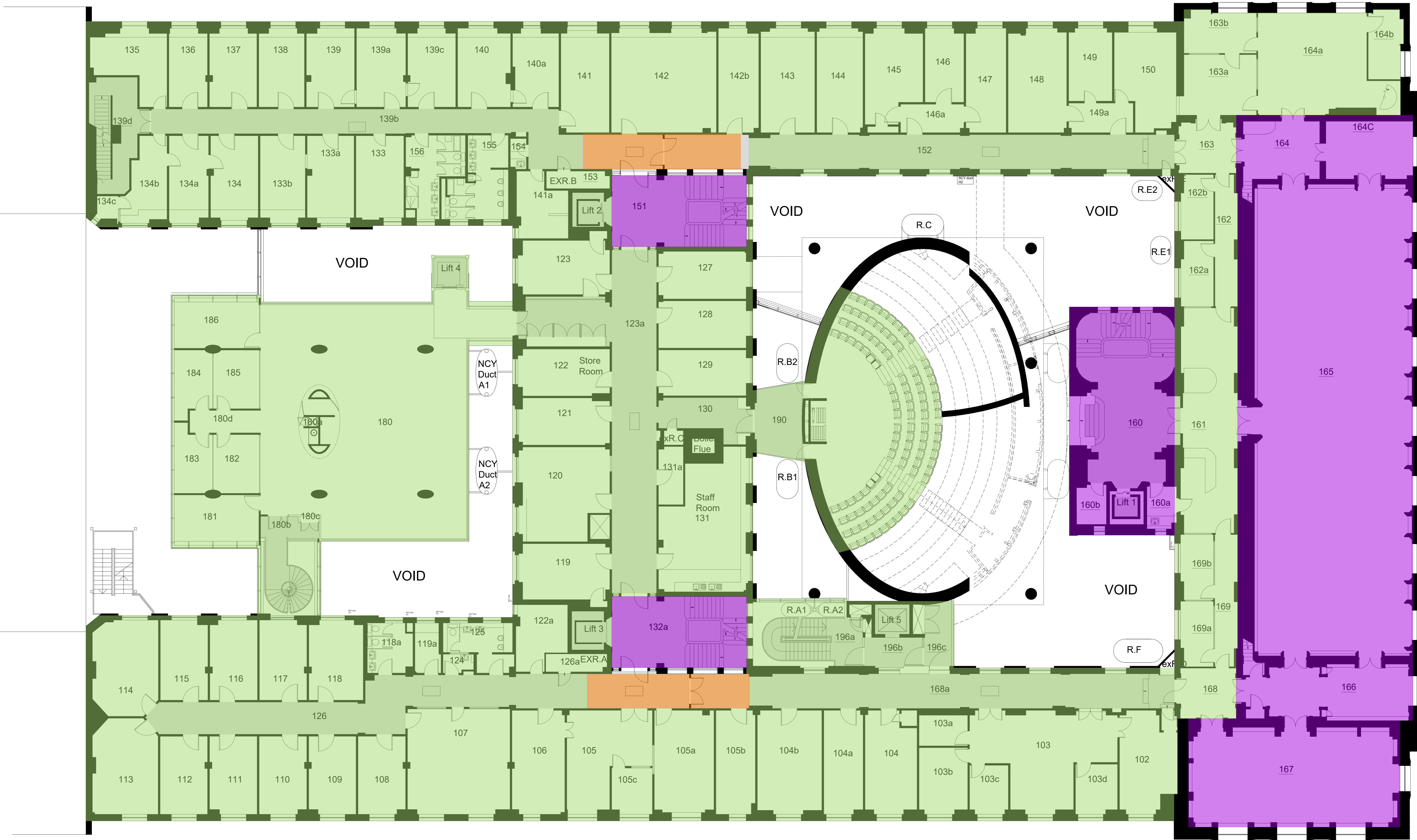

01 Level 01 - Plan - Conservation Strategy
 08-2031 Scale = 1:100

Rev	Date	By	Ch	App	Description
3A	28.06.19TR	CR	AS		Issued for Planning
Job Title LONDON SCHOOL OF HYGIENE AND TROPICAL MEDICINE (KEPPEL STREET)					
Drawing Title Level 01 - Plan Conservation Strategy					
<small>IAN RITCHIE ARCHITECTS LTD</small> 110 Three Cat Street London E14 6AZ Tel: (+44) 2073381100 Fax: (+44) 2073381199					
Status PLANNING					
Scale 1:100@A0		Date 28.06.2019			
Drawn TR	Checked CR	Approved AS			
Job No. 739	Drawing No. 739-01-02-08-2031	Rev. 3A			