

DO NOT SCALE  
 THIS DRAWING IS © IAN RITCHIE ARCHITECTS LTD  
 Dimensions to be verified on site.  
 Figure dimensions to take preference to those scaled.  
 All discrepancies to be clarified with the project Architect.  
 Unless otherwise stated all levels to be AOD.  
 This drawing is the property of Ian Ritchie Architects Ltd. and is  
 issued on the condition it is not reproduced, related or  
 disclosed to any unauthorised person, either wholly or in part without  
 written consent.

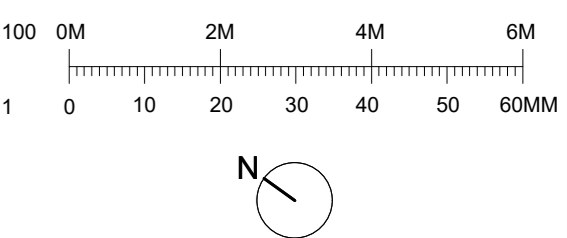

KEY:  
 — Existing  
 — Proposed  
 - - Site Boundary (at this level)  
 Phase 2b / 2c Works

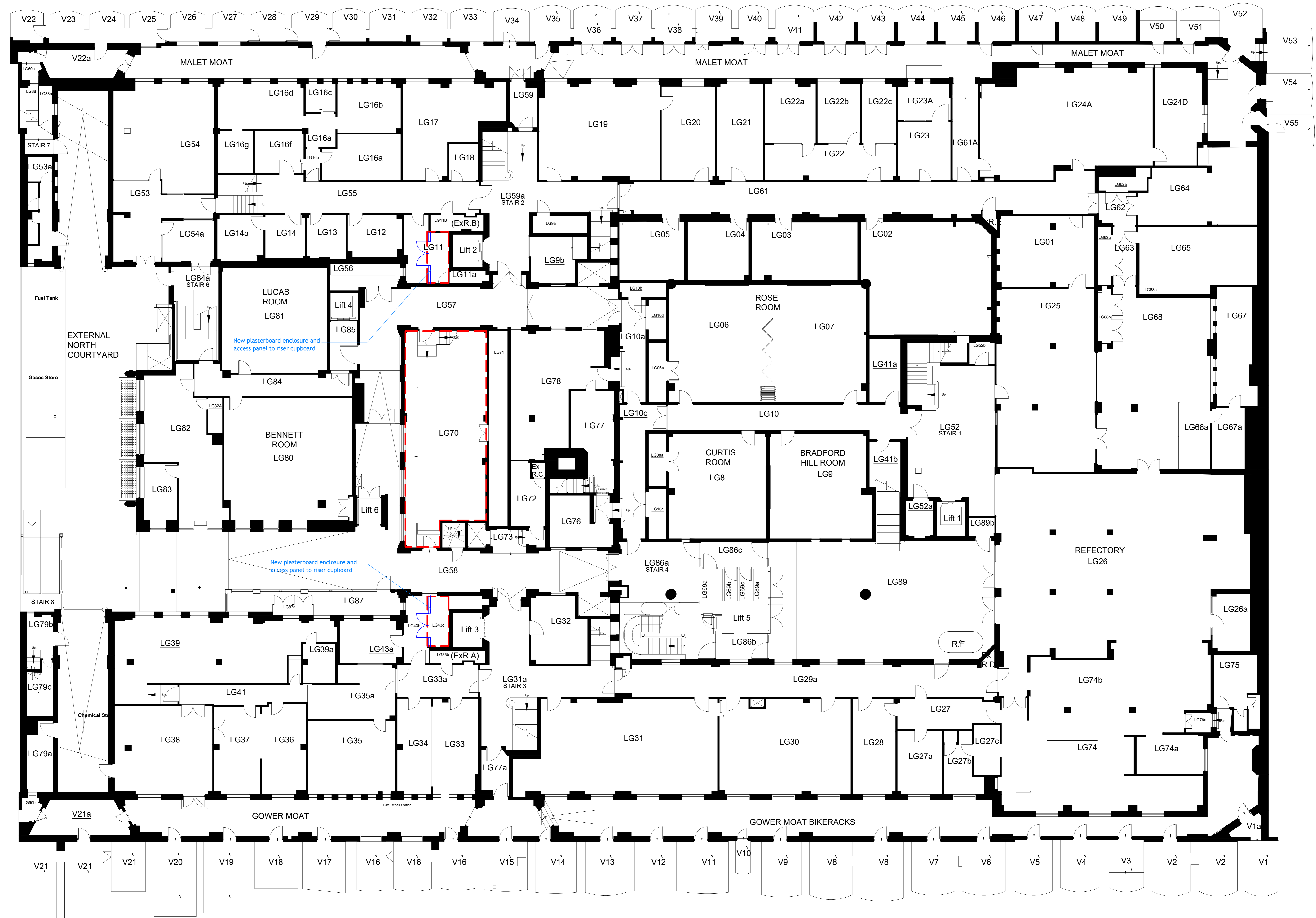

01 Existing Lower Ground Floor Level Plan  
 08-2007 Scale = 1:100

Rev	Date	By	CR	AS	Description
2A	28.06.19	TR	CR	AS	Issued for Planning
Job Title					
LONDON SCHOOL OF HYGIENE AND TROPICAL MEDICINE (KEPPEL STREET)					
Drawing Title					
GA Plan - Lower Ground Floor Level Proposed					
Status					
PLANNING					
Scale		Date			
1:100@A0		28.06.2019			
Drawn	TR	Checked	CR	Approved	AS
Job No.	739	Drawing No.	08-2007	Rev.	3A