

DO NOT SCALE
 THIS DRAWING IS THE PROPERTY OF IAN RITCHIE ARCHITECTS LTD.
 Dimensions to be verified on site.
 Planned dimensions to take preference to these scaled.
 All discrepancies to be clarified with the project architect.
 Unless otherwise stated all levels to be AOD.
 This drawing is the property of Ian Ritchie Architects Ltd. and is
 issued on the condition it is not reproduced, retained or
 disclosed to any unauthorised person, either wholly or in part without
 written consent.

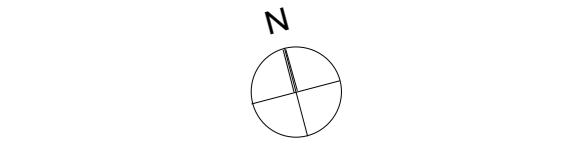

— EXISTING
 — NEW CONSTRUCTION
 — SITE BOUNDARY
 Phase 2b / 2c Works

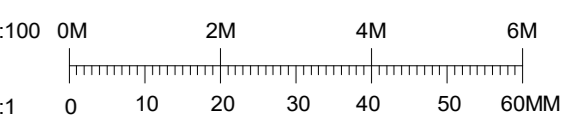
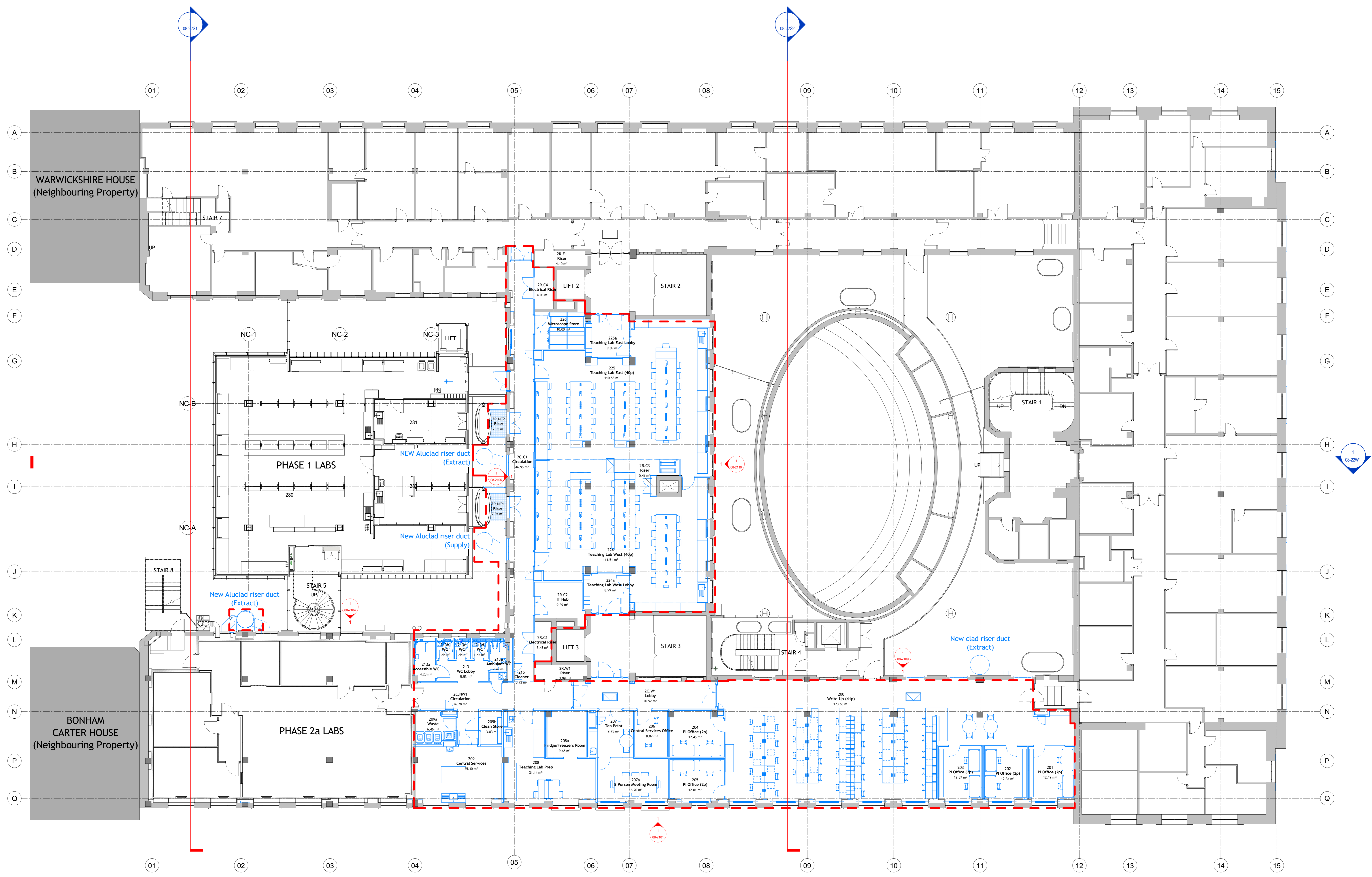

1 GA Plan - Planning - Level 2 Proposed
 1 : 100

3A | 28.06.19 | TR | CR | AS | Issued for Planning
 Rev. Date | By | CA | Description
 Job Title
**LONDON SCHOOL OF HYGIENE
 AND TROPICAL MEDICINE
 (KEPPEL STREET)**

Drawing Title
**GA Plan - Level 02 -
 Proposed**

IAN RITCHIE ARCHITECTS LTD
 110 Three Cabs Street London E14 6AZ
 Tel: (+44) 2073381100 Fax: (+44)
 2073381199

Status PLANNING		
Scale 1:1000(A0)	Date 24.06.19	
Drawn TR	Checked CR	Approved AS
Job No. 739	Drawing No. 739-IRAL-Q2- 08-2002	Rev. 3A