

DO NOT SCALE  
 THIS DRAWING IS THE PROPERTY OF IAN MITCHELL ARCHITECTS LTD  
 Dimensions to be verified on site.  
 Figure dimensions to take preference to those scaled.  
 All discrepancies to be clarified with the project Architect.  
 Unless otherwise stated all levels to be AOD.  
 This drawing is the property of Ian Mitchell Architects Ltd. and is  
 issued on the condition it is not reproduced, related or  
 disclosed to any unauthorised person, either wholly or in part without  
 written consent.

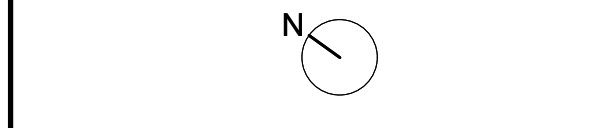
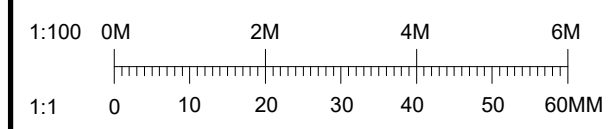

KEY:  
 — Existing  
 — Proposed  
 - - Site Boundary (at this level)  
 - - Phase 2b / 2c Works

MALET STREET

KEPPEL STREET

GOWER STREET

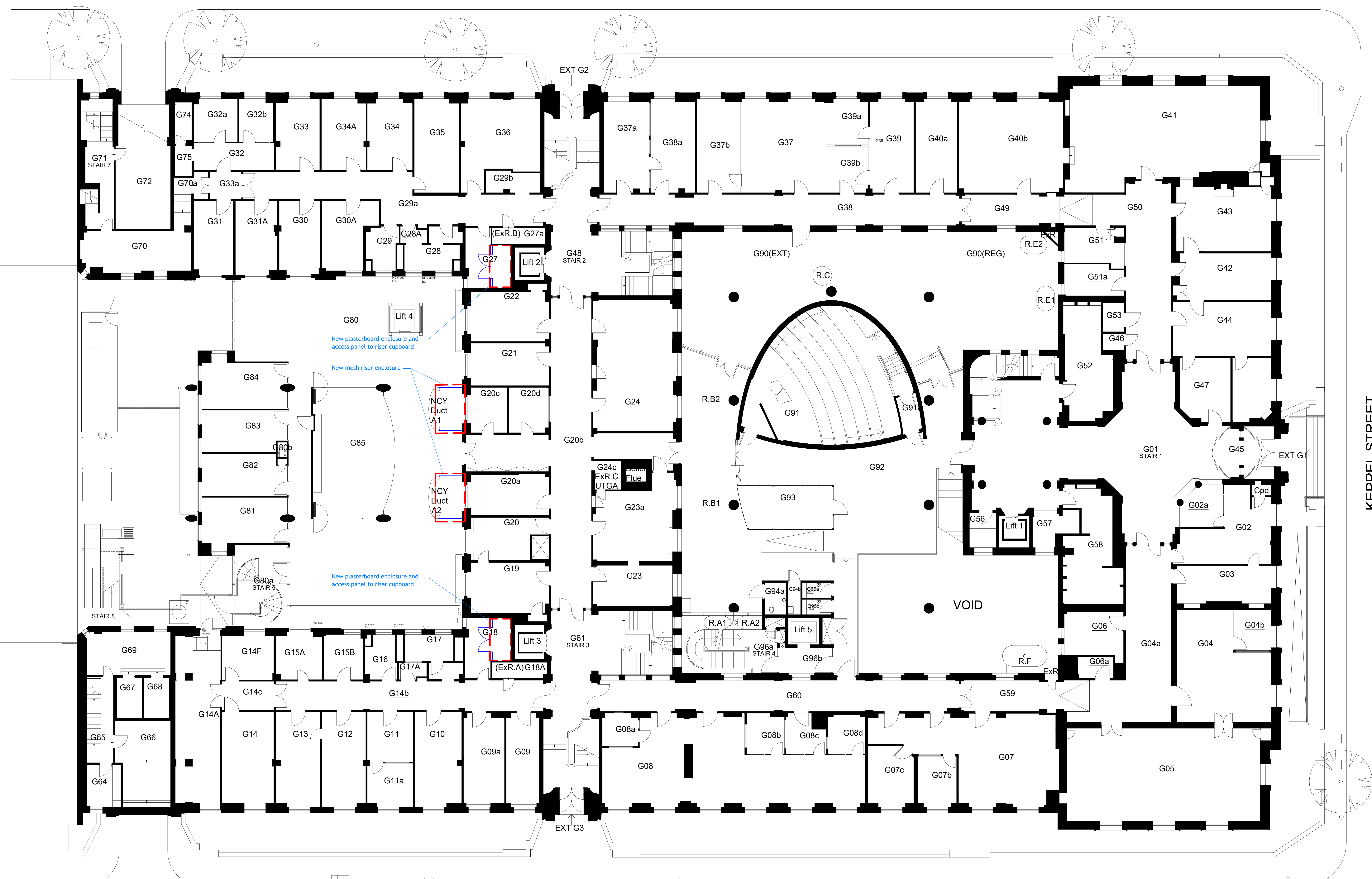

01 Existing Ground Floor Level Plan  
 08-2000 Scale = 1:100

Rev	Date	By	CR	AS	Issued for Planning
3A	28.06.18	TR	CR	AS	Issued for Planning
Job Title					
LONDON SCHOOL OF HYGIENE AND TROPICAL MEDICINE (KEPPEL STREET)					
Drawing Title					
GA Plan Proposed					
IAN MITCHELL ARCHITECTS LTD 110 Three Cat Street London E14 6AZ Tel: (+44) 2073381100 Fax: (+44) 2073381199					
Status PLANNING					
Scale 1:100@A0		Date 28.06.2019			
Drawn TR	Checked CR	Approved AS			
Job No. 739	Drawing No. 08-2000	Rev. 3A			