

DO NOT SCALE  
 THIS DRAWING IS THE PROPERTY OF SAN RITCHIE ARCHITECTS LTD.  
 Dimensions to be verified on site.  
 All discrepancies to be clarified with the project Architect.  
 Unless otherwise stated all levels to be AOD.  
 This drawing is the property of San Ritchie Architects Ltd. and is issued on the condition it is not reproduced, retained or disclosed to any unauthorised person, either wholly or in part without written consent.

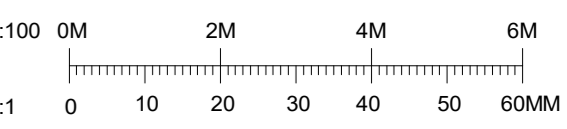

KEY:  
 - - - SITE BOUNDARY  
 Phase 2b / 2c Works  
 — EXISTING  
 ■ ELEMENT TO BE REMOVED

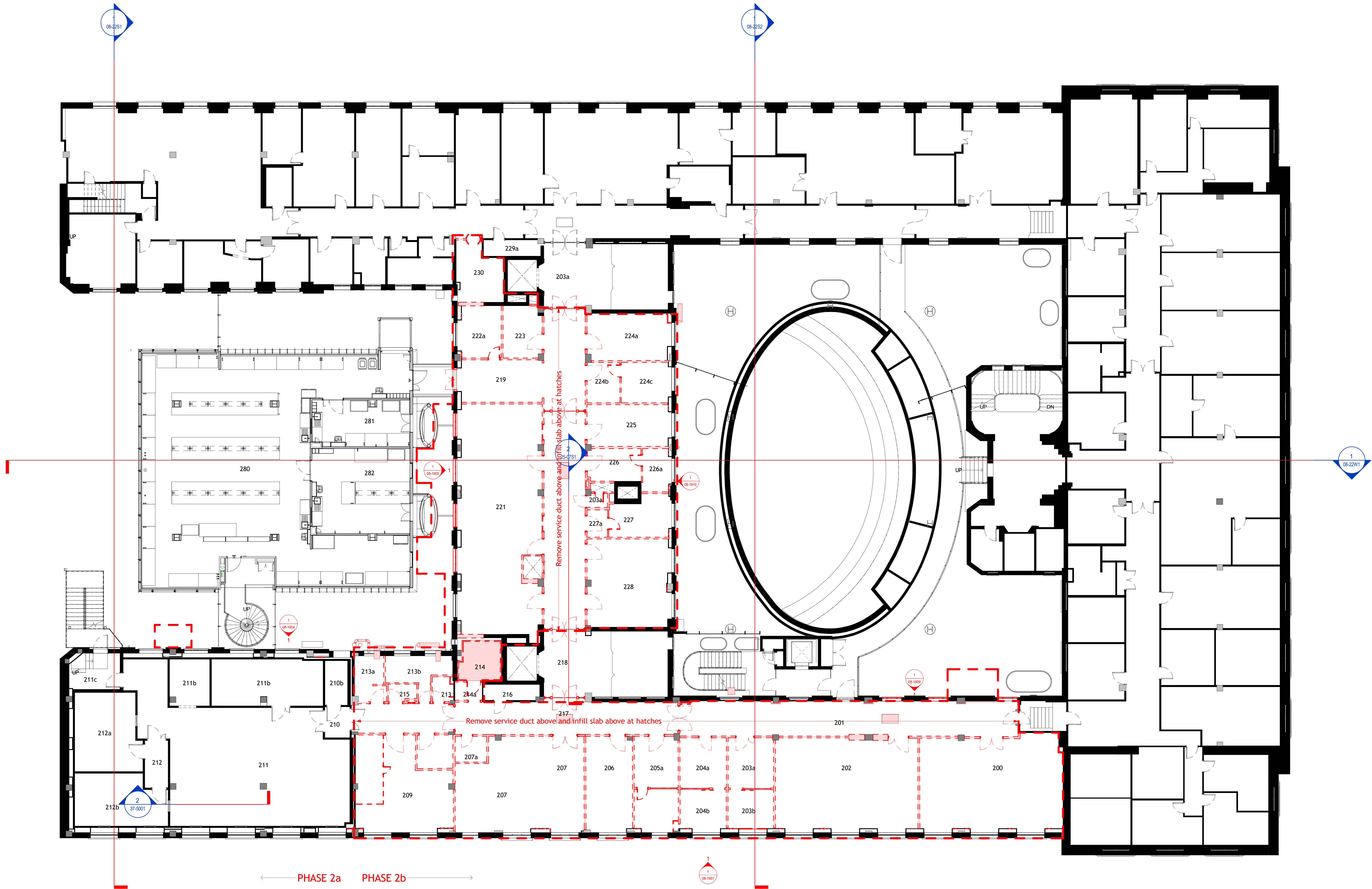

1 Planning GA Existing - Level 2  
 1 : 100

3A	28.06.19	TR	CR	AS	Issued for Planning
Rev	Date	By	CA	Ap	Description
Job Title					
LONDON SCHOOL OF HYGIENE AND TROPICAL MEDICINE (KEPPEL STREET)					
Drawing Title					
GA Plan - Level 02 - Existing					
Status					
PLANNING					
Scale		Date			
1:100(A0)		24.06.19			
Drawn	TR	Checked	CR	Approved	AS
Job No.	739	Drawing No.	739-IAL-Q2-08-1802	Rev.	3A

SAN RITCHIE ARCHITECTS LTD  
 110 Three Cabs Street London E14 6AZ  
 Tel: (+44) 2073381100 Fax: (+44) 2073381199