

Copyright. All Rights Reserved.  
 This work is copyright and cannot be produced or copied in any form or by any means (graphic, electronic or mechanical including photocopying) without the written permission of the originator. Any licensee, express or implied, to use this document or any purpose whatsoever is restricted to the terms of the agreement or implied agreement between the originator and the instructing party.  
 DO NOT SCALE FROM THIS DRAWING. WORK ONLY FROM FIGURED DIMENSIONS.  
 THIS DRAWING TO BE READ IN CONJUNCTION WITH RELEVANT CONSULTANT'S DRAWINGS.

KEY PLAN

REV P02 | DATE 27/06/2019 | DRAWN / CHECKED / APPROVED KK / BW / BW  
 Sheet titled amended

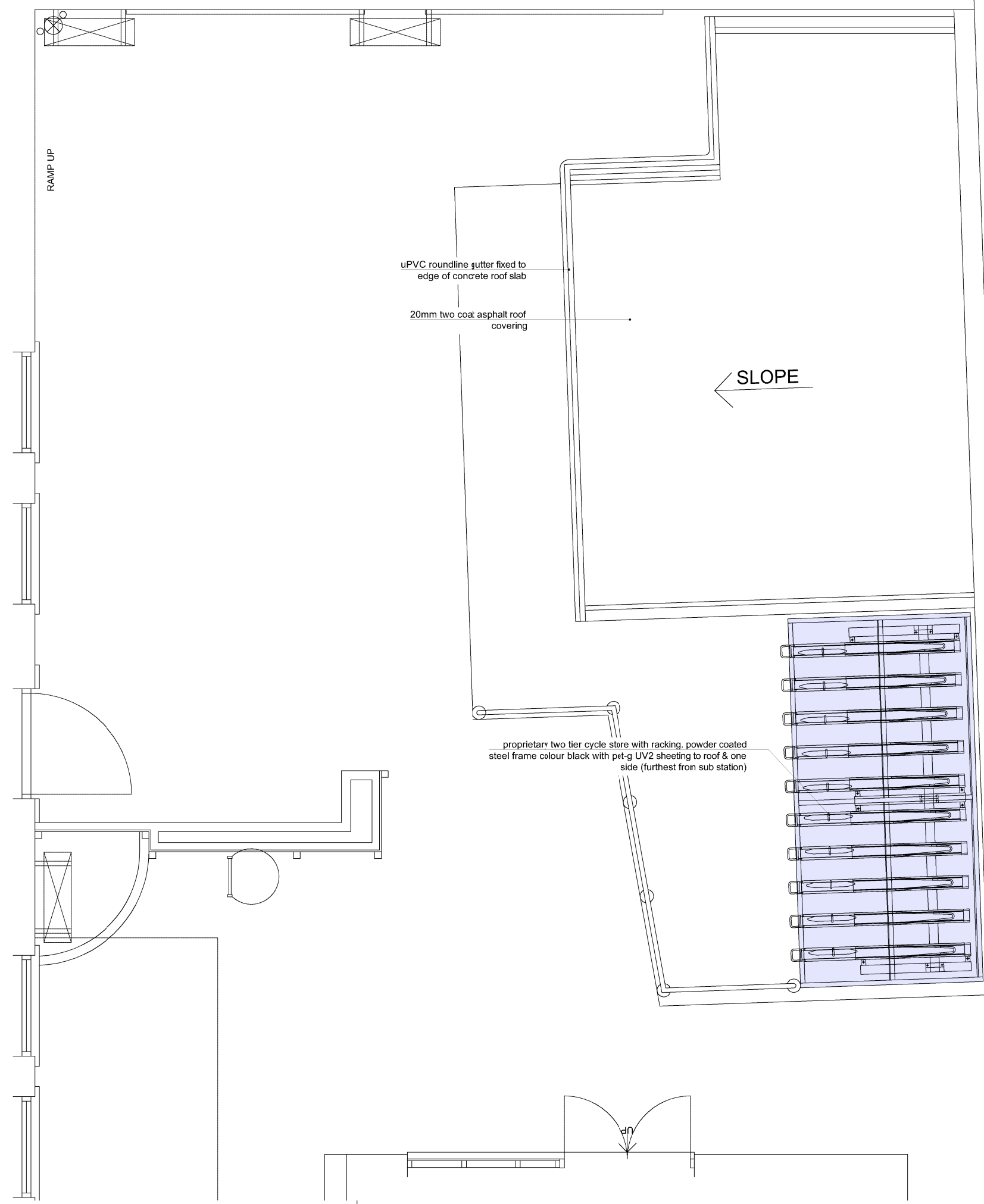

Roof Plan 1:100

4 Northington Street  
 London WC1N 2JG  
 +44 (0)20 7490 1900  
 london@medicalarchitecture.com  
 medicalarchitecture.com



CLIENT  
 UNIVERSITY COLLEGE LONDON HOSPITALS

PROJECT  
 8-11 Queen Square  
 Mains Power Infrastructure

TITLE  
 Proposed Roof Plan

STAGE 02 | STATUS -

PROJECT NUMBER 775 | SCALE @A3 1:50

DRAWING NUMBER 5846-MAA-81-RF-DR-A-310-S3-P01 | REVISION P01

FILE REFERENCE \\LON-SRV-01\Projects\775\_UCLH\_ElectricalInfrastructure\Design\Location\01\_Zone\DWG\8-11QS