

Replacement window. Cill height raised by 100mm.
 Window height increased by 100mm. Composite double-glazed window of aluminium (external) and natural timber (internal). External finish: Dark grey anodised aluminium.

New top hung recessed/ inline 'Conservation' roof window. External finish (frame): Aluminium Colour: Anthracite Grey

TOP FLOOR FLAT

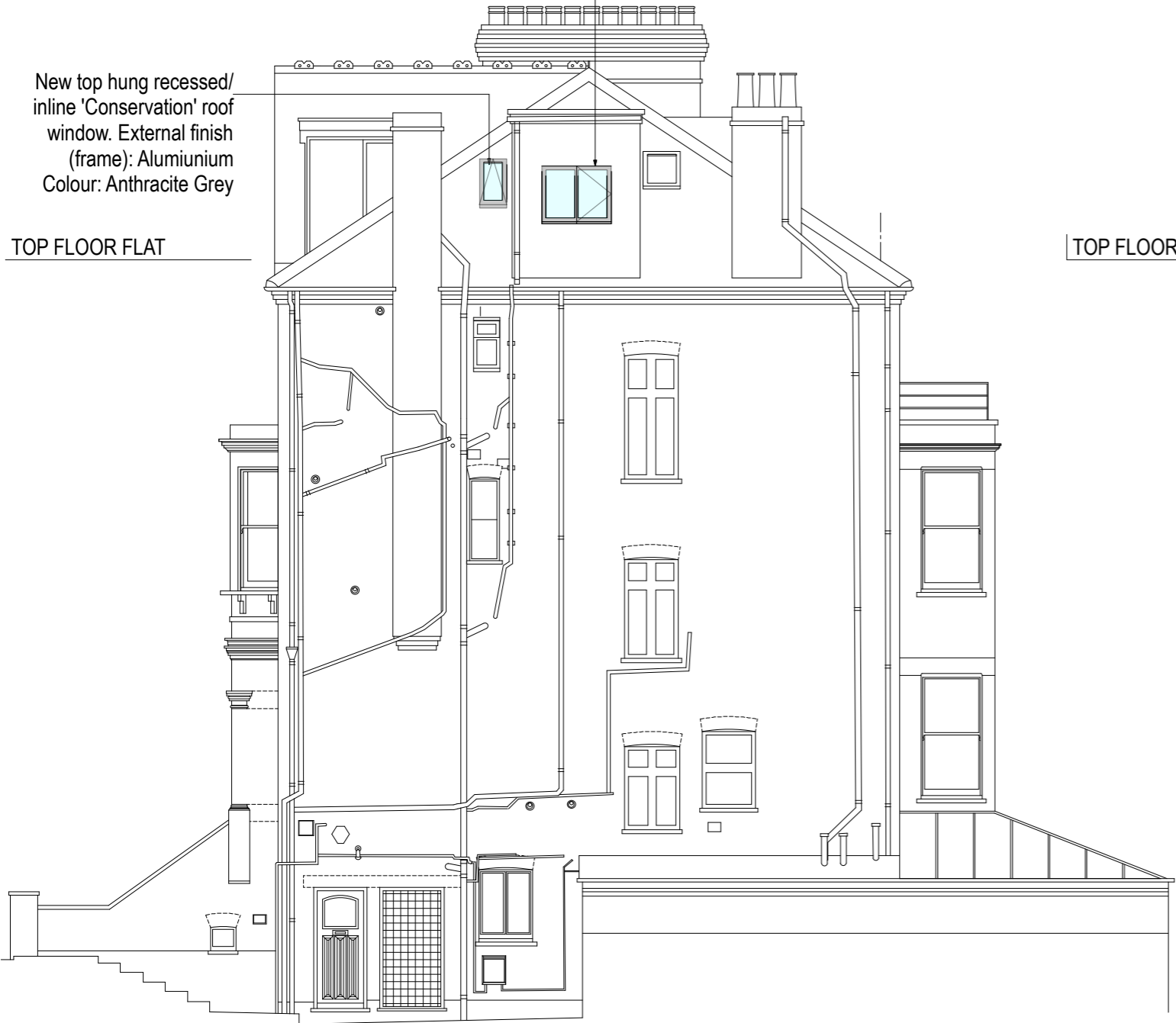

SIDE ELEVATION: AS PROPOSED

New top hung recessed/ inline 'Conservation' roof window.
 External finish (frame): Aluminium Colour: Anthracite Grey

Replacement cladding to roof and cheeks of existing dormer: Standing seam zinc cladding and roof in pre-patinated zinc. Colour: Grey

Existing railing altered: Height increased to meet current building regulations.
 Painted steel railings Colour: black

TOP FLOOR FLAT



REAR ELEVATION: AS PROPOSED

TOP FLOOR FLAT, 17 TANZA ROAD NW3

SIDE & REAR ELEVATIONS: AS PROPOSED
 SCALE 1-100 @ A3

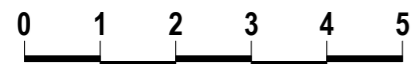

SCALE - METRES

NOTES/REVISIONS		charlick + nicholson architects studio 116 westbourne studios 242 acklam road london W10 5JJ 020 8968 0022 mail@charlicknicholson.co.uk	DWG NO.	TNZ - PP - 23	REV	B
<small>Dimensions to be verified on site. Do not scale. Copyright: all rights reserved. This drawing must not be reproduced without permission.</small>			CLIENT	F KELLY		
A	29.03.2019 ISSUED FOR PLANNING		PROJ. TITLE	TOP FLOOR FLAT, 17 TANZA ROAD, NW3		
B	30.05.2019 REVISED FOR PLANNING. ROOFLIGHT SIDE FRONT GABLE OMITTED, CABRIO AT REAR REPLACED WITH ROOF WINDOW		DWG TITLE	ELEVATIONS SIDE AND REAR - AS PROPOSED		
		SCALE	1-100	A3	DATE	29.01.19