

1 Vehicle Management Plan
Scale 1:100@A1

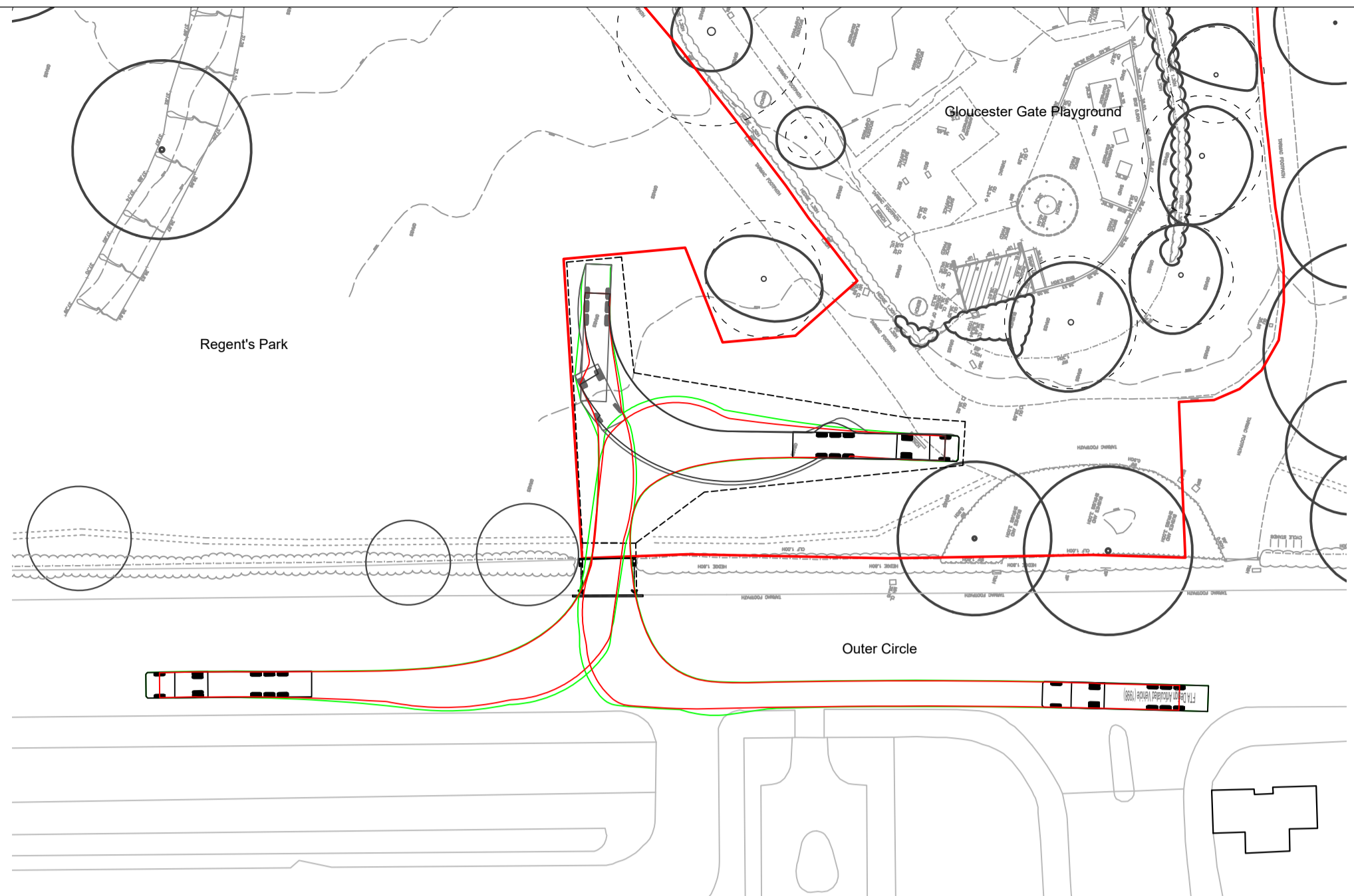

2 Vehicle Tracking - 40T Artic Lorry
Scale 1:500@A1

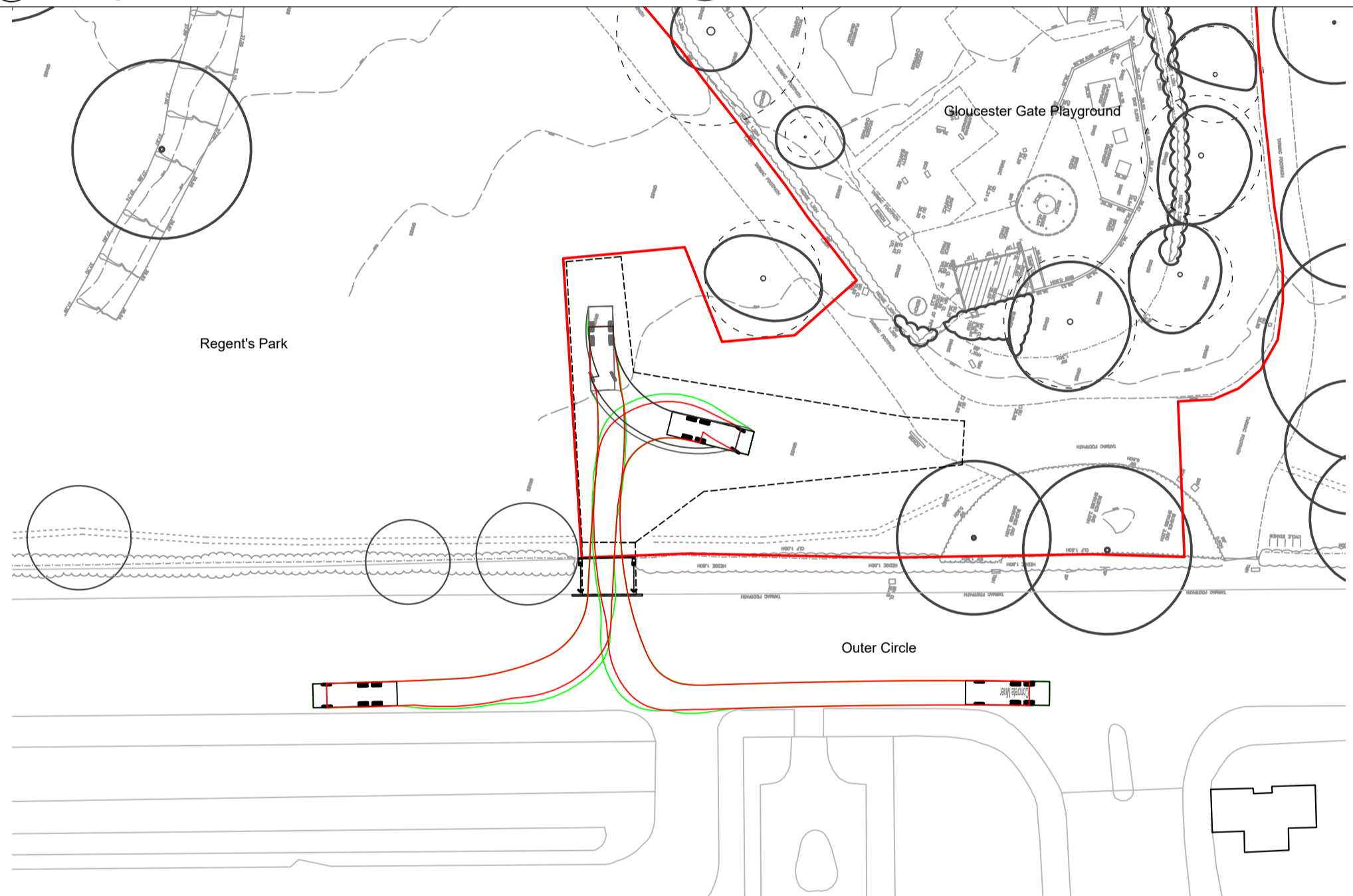

3 Vehicle Tracking - Concrete Mixer
Scale 1:500@A1

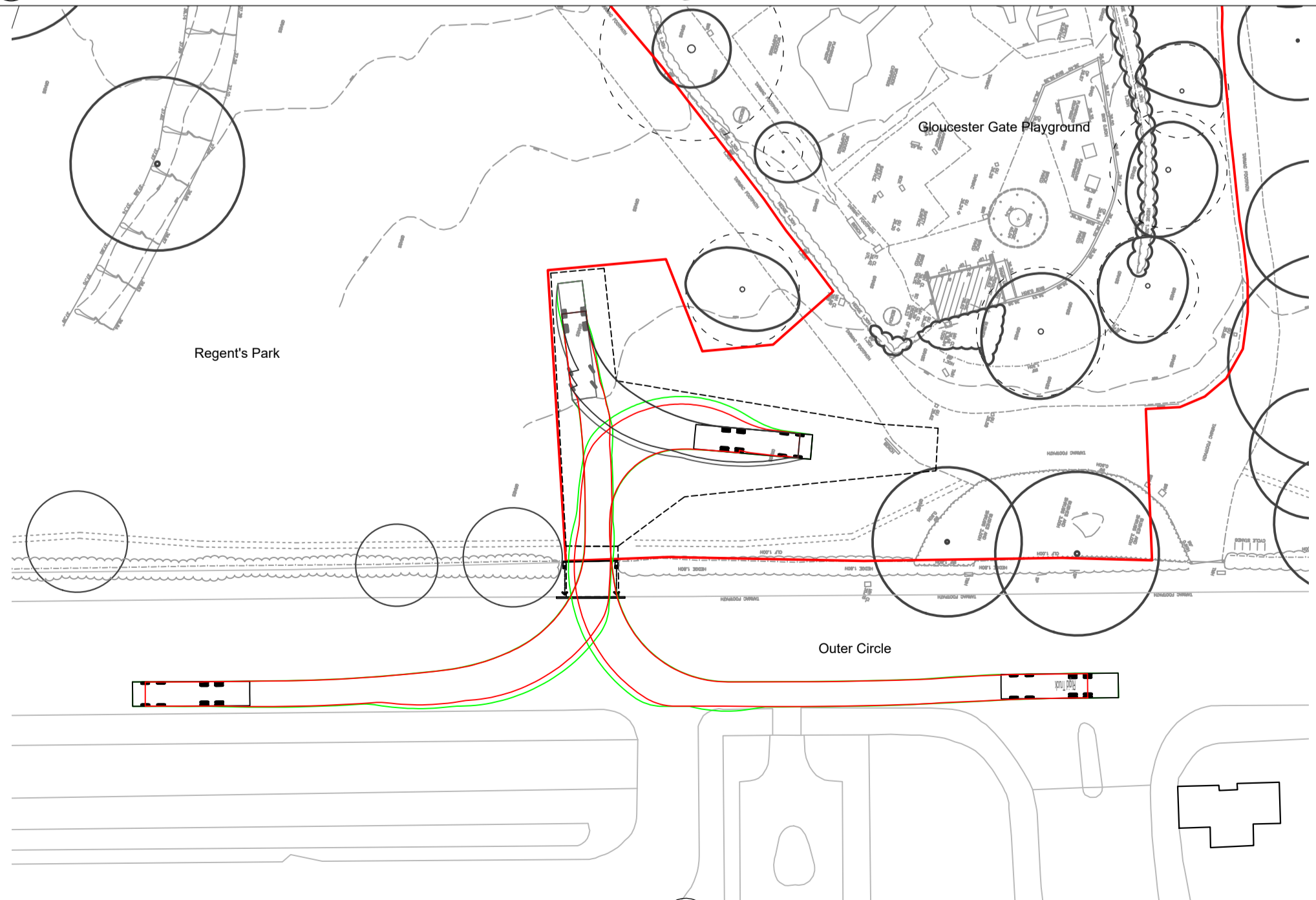

4 Vehicle Tracking - Rigid Truck
Scale 1:500@A1

FTA Design Articulated Vehicle (1998)

Overall Length	16.480m
Overall Width	2.550m
Overall Body Height	3.870m
Min Body Ground Clearance	0.515m
Max Track Width	2.470m
Lock to lock time	8.95s
Kerb to Kerb Turning Radius	8.560m

Key

	Application Boundary
	Existing trees Dashed line indicates Root Protection Area. Refer to Arboricultural Report for further details.

Drawing Notes
 Site start date: Monday 1st July 2019
 Site completion date: Friday 22nd November 2019
 Refer to Construction Traffic Management Plan by idverde for further details on all traffic management details.

Concrete Mixer

Overall Length	9.360m
Overall Width	2.890m
Overall Body Height	4.027m
Min Body Ground Clearance	0.358m
Max Track Width	2.413m
Lock to lock time	6.00s
Kerb to Kerb Turning Radius	8.210m

Rigid Truck

Overall Length	12.000m
Overall Width	2.950m
Overall Body Height	3.928m
Min Body Ground Clearance	0.412m
Track Width	2.471m
Lock to lock time	6.00s
Kerb to Kerb Turning Radius	11.960m

Iss	Date	Description	Des	CHK
B	18.06.19	Issued for Planning	JV	-
A	18.06.19	Issued for Planning	JV	-

LUC London
 43 Chalton Street, London, NW1 1JD
 +44 (0)20 7383 5784
 london@landuse.co.uk
 www.landuse.co.uk

Project
Gloucester Gate Playground
 The Regent's Park

Client
 The Royal Parks

Scale @A1
 Status
PLANNING

Drawing Title
Vehicle Management Plan

Job Nr 10335
 Drawing Nr 10335-LD-PLN-110
 Issue B