

GENERAL NOTES:
 This drawing is copyright of KSR architects. This drawing must be read in conjunction with the Designer's Risk Assessment, specification and all other relevant documentation and drawings. KSR architects accept no liability for any expense, loss or damage of whatsoever nature and however arising from any variation made to this drawing or in the execution of the work to which it relates which has not been referred to them and their approval obtained.
 Areas are based on unchecked survey and are approximate only.
 Do not scale from this drawing or the digital data, only figured dimensions are to be used. Refer to linear scale for guidance.
 Check all dimensions on site prior to carrying out any works and advise any discrepancy

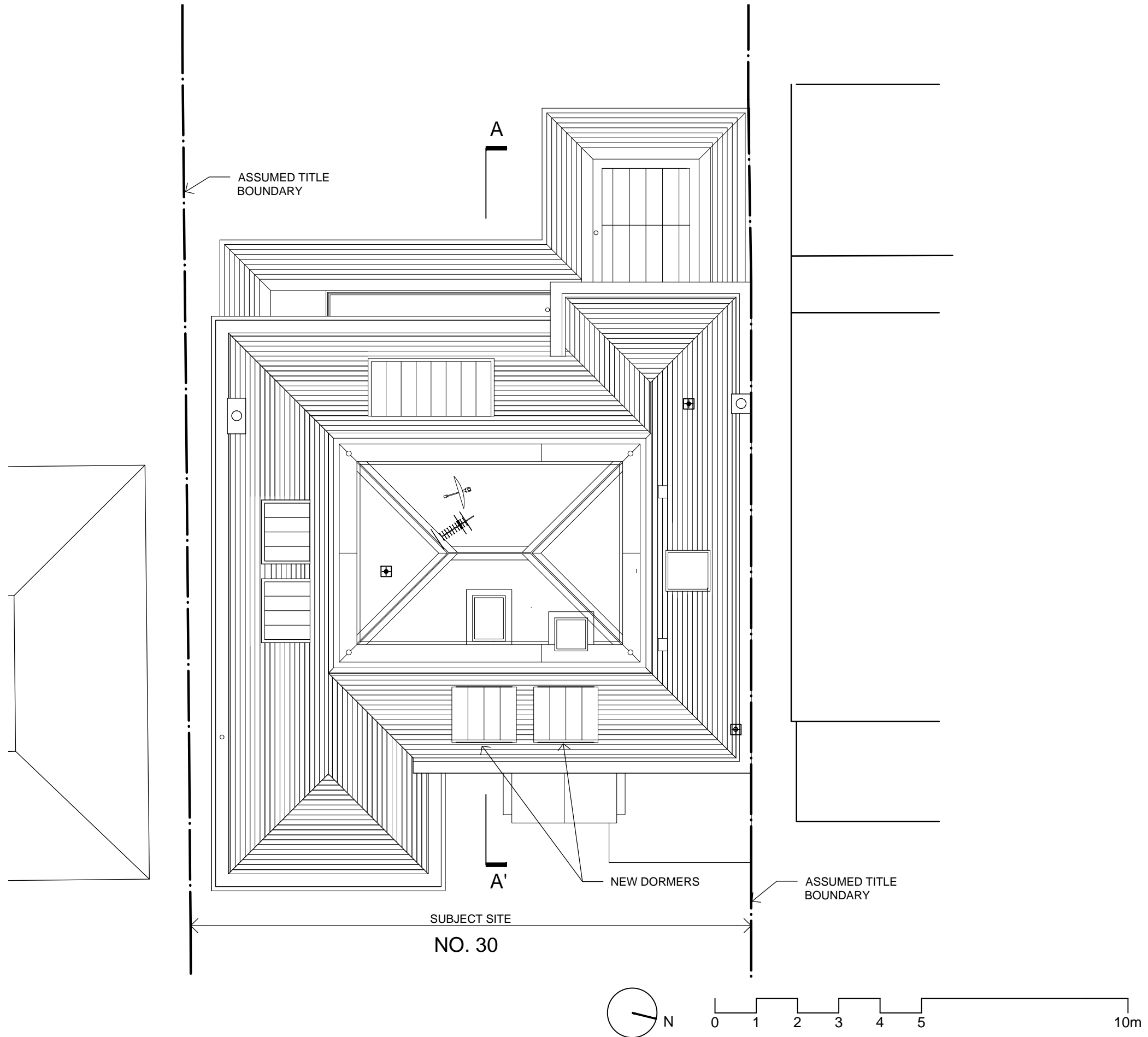

KSR ARCHITECTS & INTERIOR DESIGNERS

KSR Architects LLP
 14 Greenland Street
 London NW1 0ND
 mail@ksrarchitects.com
 t: +44 (0)20 7692 5000
 www.ksrarchitects.com

30 Ellerdale Road
 NW3 6BB London

Proposed roof plan

Date: 24/05/2019 Status: Information

Scale: 1:100 @ A3 © KSR Architects

Project Ref: Drawing No: Revision:

18043 P130 .