

01 Internal Elevation 01 - Proposed 1:50

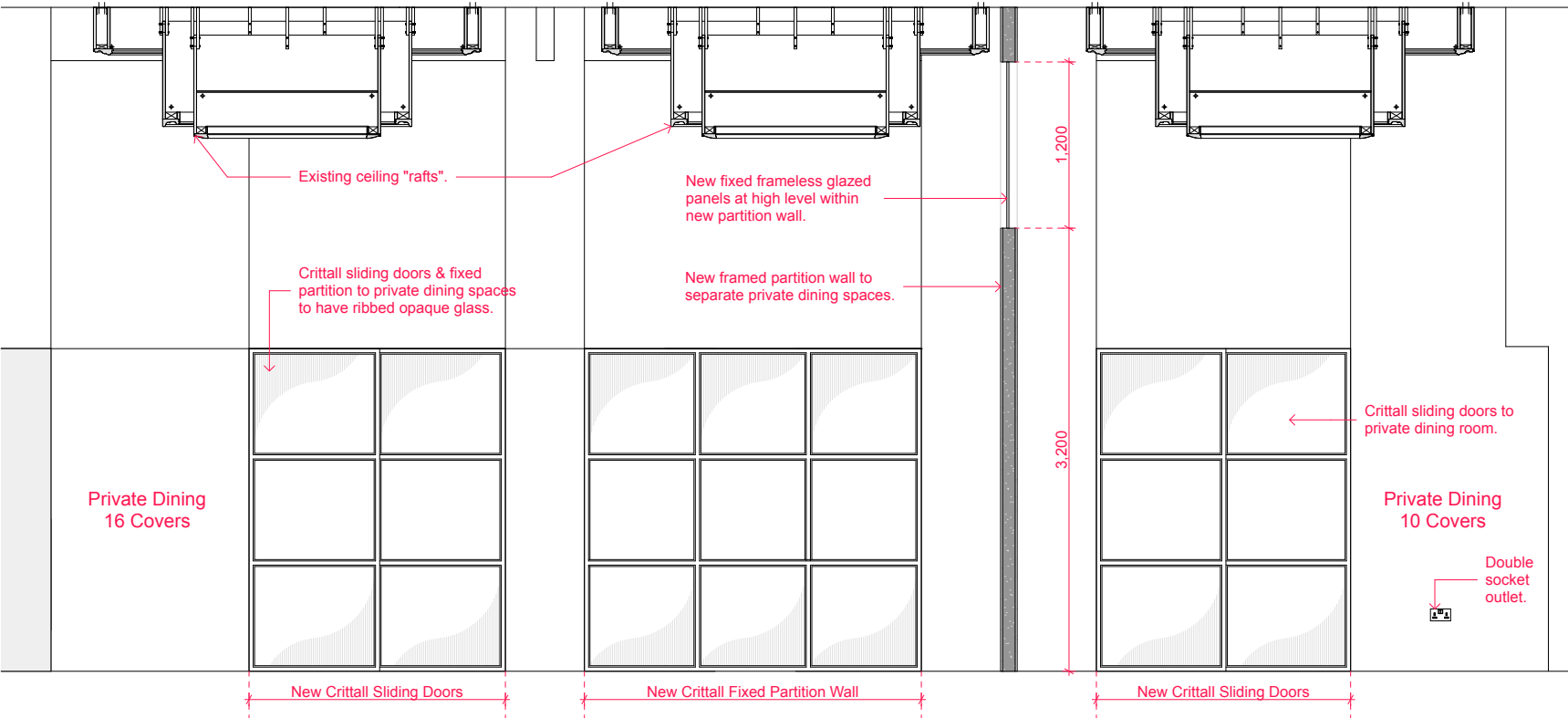

02 Internal Elevation 02 - Proposed 1:50

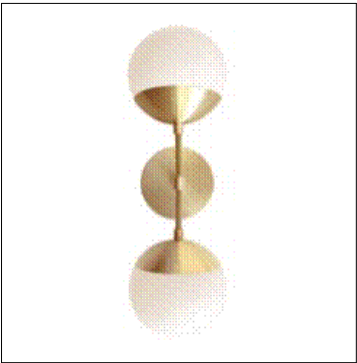

Main restaurant - Proposed light fitting

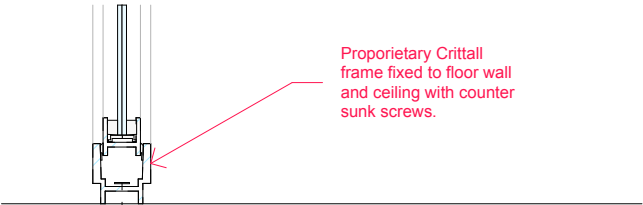

03 Steel framed glazed partition detail 1:5

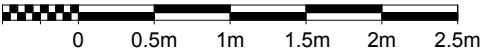

Job Title	Gezzelig Restaurant, 193 - 197 High Holborn
Client	THA
Status	PLANNING
Format	A3
Scale	1:50, 1:100, 1:5 @ A3
Drawn by	Date
16/04/2019	
Notes	
Revisions	
Architect	trevor horne architects Studio 1 56a Orsman Rd London N1 5QJ t: 020 7253 0600 e: info@trevorhorne.com
Internal Elevations - Proposed	
GezelligPLA17	