

LEGEND

- 01. Existing brickwork wall rebuilt due to movement/cracking to match the existing.
- 02. Frameless double glazed roof and wall panels.
- 03. Polyester Powder Coated double glazed sliding doors.
- 04. Existing opening width increased by 600mm (300mm either side).
- 05. Stone paving.
- 06. Original dwelling house side elevation.
- 07. Original dwelling house balcony.
- 08. Existing fence retained and unchanged.

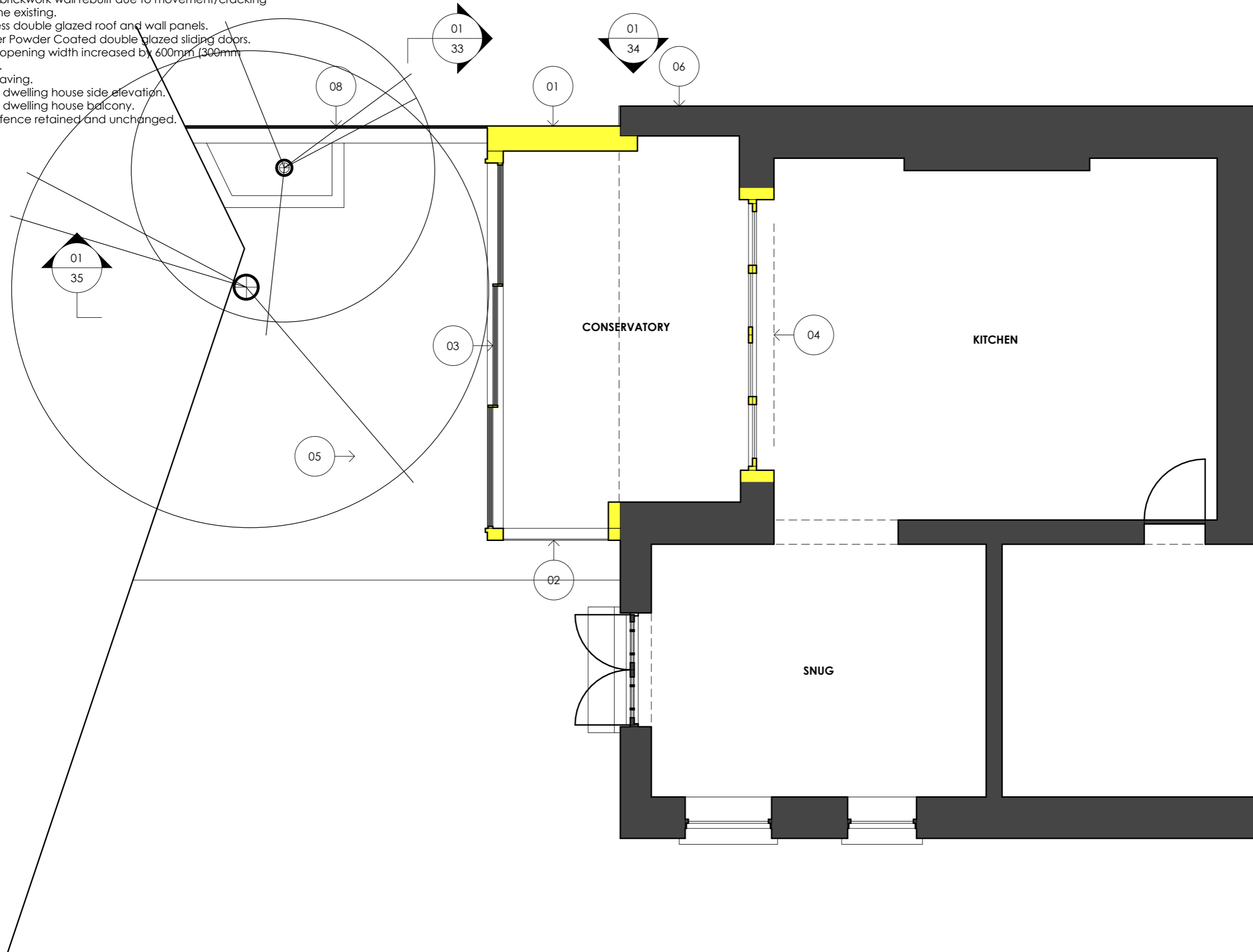

01
31

PROPOSED LOWER GROUND FLOOR PLAN

1:50@A3

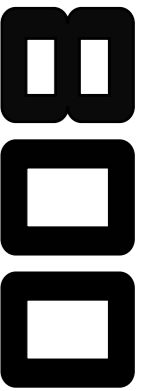
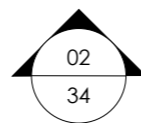
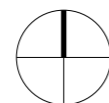

LEGEND

- Original dwelling house
- New works

Client
Mr & Mrs Jacobson

Project
29 Langland Gardens
London
NW3 6QE

Drawing
Proposed
Lower Ground Floor Plan

Dwg No. 229-31 **Rev** A

Scale 1:50@A3 **Date** May 2019

800 Group
Cranborne Road
Potters Bar
Hertfordshire
EN6 3JN

Telephone
01707 663 075

Facsimile
01707 662 076