

- SOIL DRAIN
- COMBINED DRAIN
- SURFACE WATER DRAIN
- EXISTING DRAIN
- MANHOLE
- ⊕ TREES TO BE REMOVED
- ⊙ TREES TO REMAIN
- ELECTRIC SUPPLY
- GAS SUPPLY

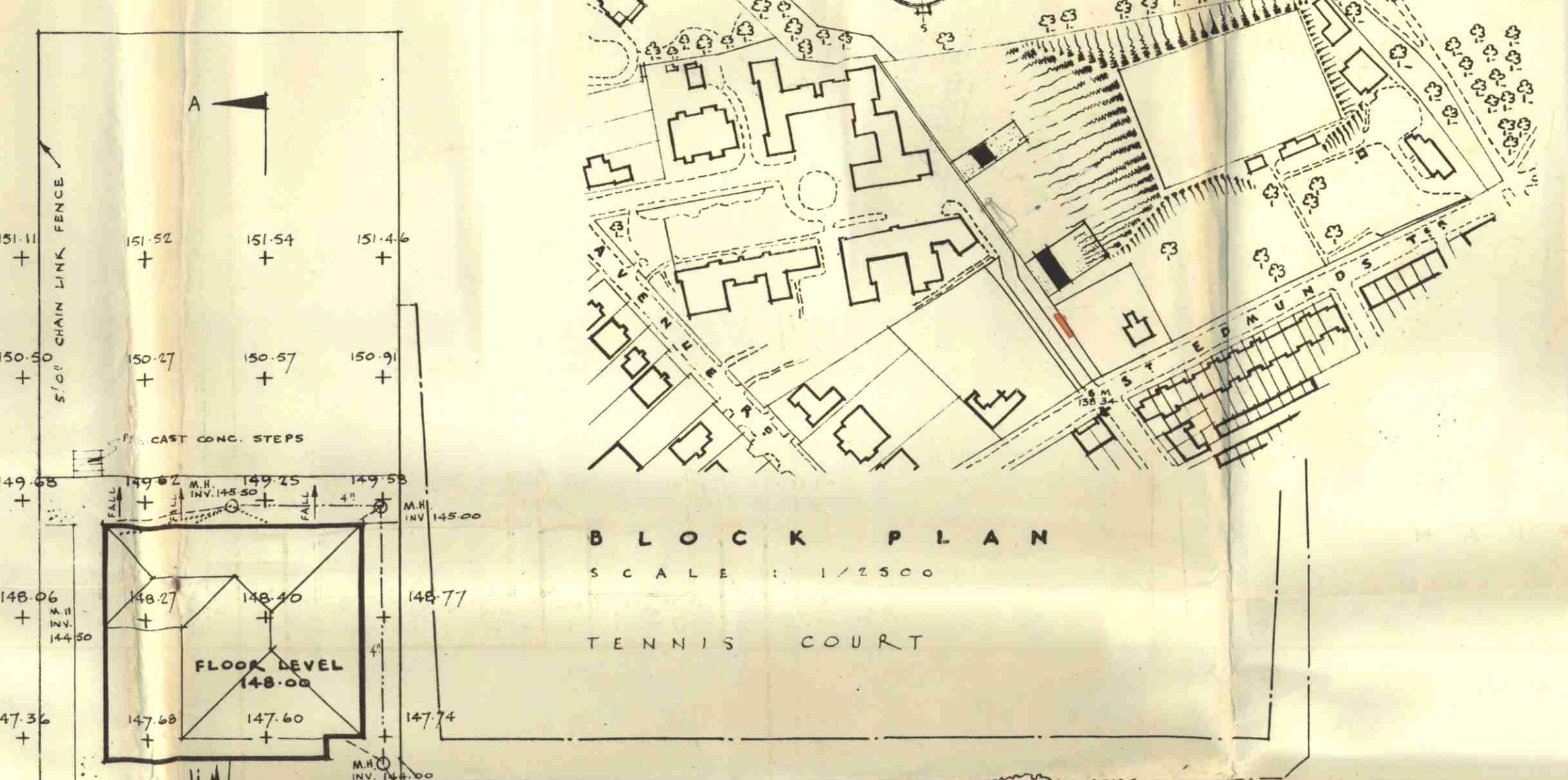

SITE PLAN

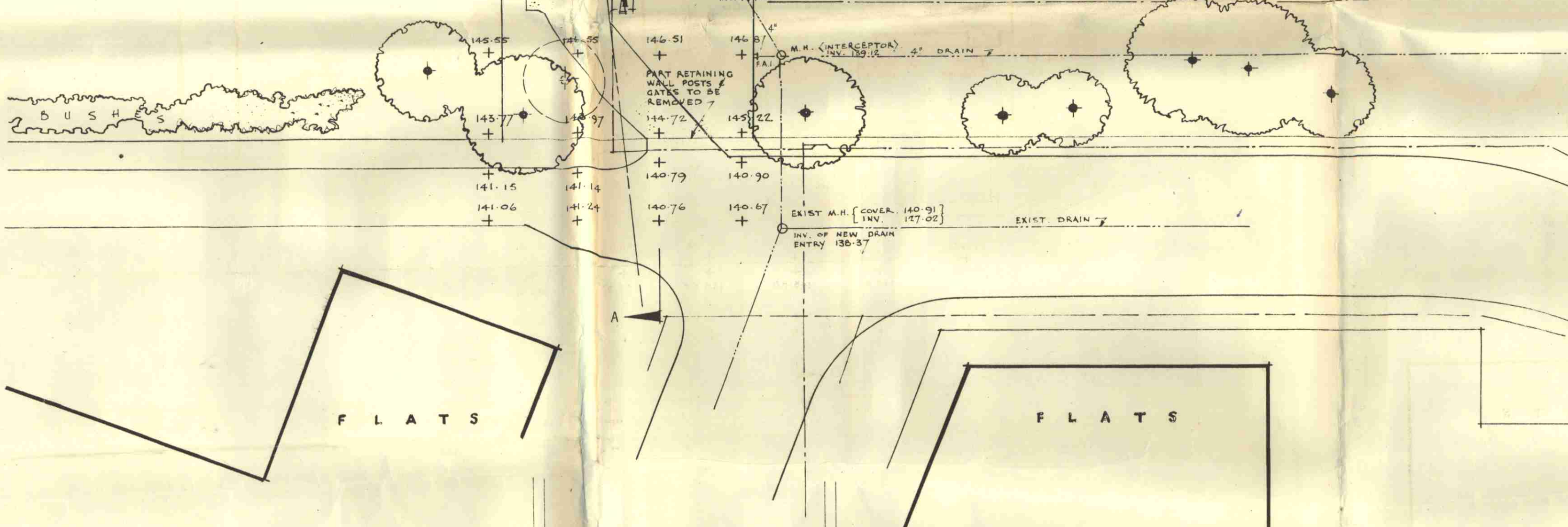

SECTION A-A

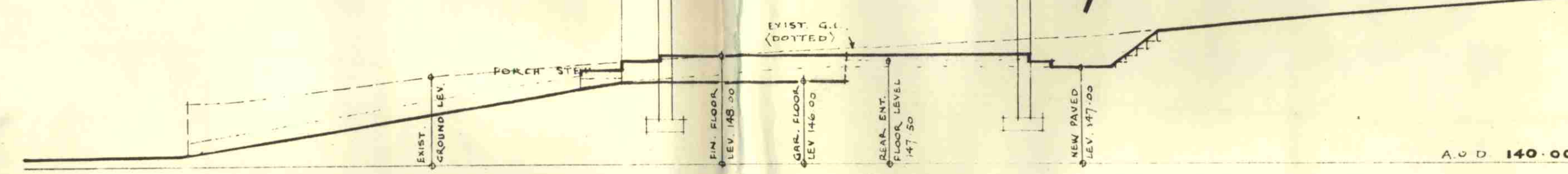

SECTION B-B

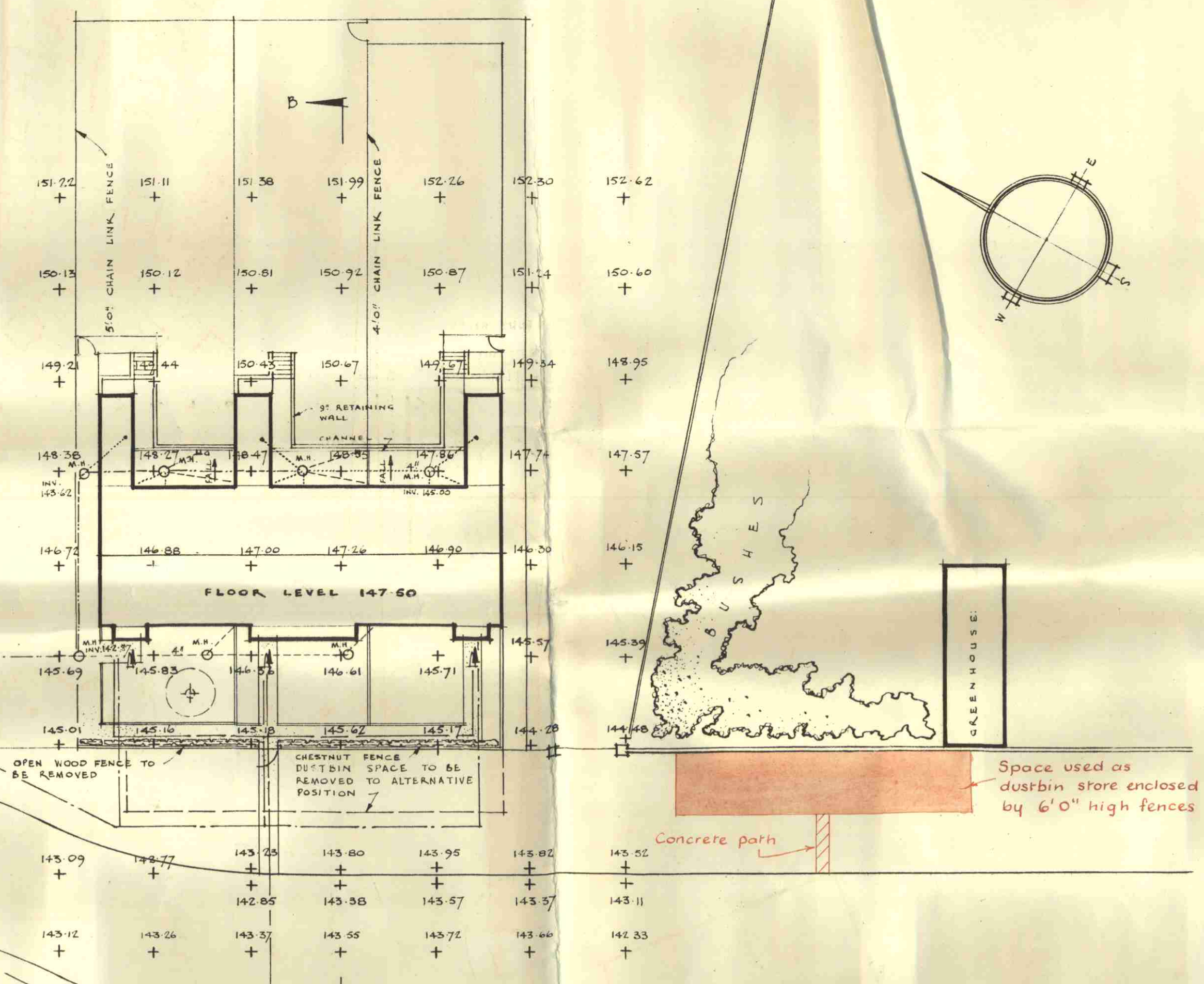
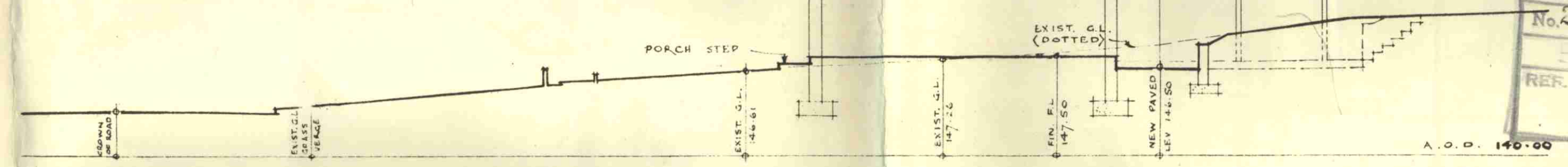

Space used as dustbin store enclosed by 6'0" high fences

Concrete path

ARCHITECTURAL
No. 5348
19 MAR 1956
REF. TO ACKD.

REVISED: NOV. 53
JUL. 54

DRAWING N° 9/2
SCALE: 1/160 of 1100-1100
DATE: SEP. 53

METROPOLITAN WATER BOARD
HOUSES BARROW HILL WORKS

C. D. SHOTT, F.R.I.C.S., P.A.I.
SURVEYOR TO THE BOARD
175 ROSEBERY AVE. E.C.1