



Sacha Barnes Ltd

Landscape Architecture · Landscape Planning · Arboriculture · Design · Management
Ecology · Horticulture · Recreation & Outdoor Play · Landscape Heritage

Site Monitoring Report - Supporting the Addendum to: Tree Report & Arboricultural Impact Assessment Ref: SB/JS/616

Land at 6 Templewood Avenue, London NW3.

Date: May 2019.

Reference: SB/JS/616/SM.

Jeremy Sacha (Director) Dip LA MLI, Dip ISM · Miriam Sacha (Director)
The Colin Sanders Innovation Centre · Mewburn Road · Banbury · Oxfordshire · OX16 9PA
Telephone (01295) 817640 · Fax 01295 817601 · Mobile Jeremy 0780 709 4350
Email enquiries@sachabarnes.com Web www.sachabarnes.com

The following information supports the Addendum to: Tree Report & Arboricultural Impact Assessment (Ref: SB/JS/616) – Land at 6 Templewood Avenue, London NW3.

Contents

1. Site Monitoring Report Sheet – Recorded 9th May 2019. With photographic record.
2. Plan showing locations of Trial Pit excavations.
3. Updated Tree Schedule.
4. Updated Tree Survey and Protection Plan.

Sacha Barnes Ltd - Landscape and Arboriculture Consultants

Site Monitoring Report Sheet 1

Site Address : 6 Templewood Avenue, London NW3.

Development: Erection of Orangery.

Date and Time of Visit: 9th May 2019 at 10.00am.

SB Ref: SB/JS/616

Tree protection measures:

As per approved plan?

Present		Not Present	
Protective matting in place for access by the Cedar tree.			

Comments / Actions: Present – JS for Sacha Barnes Ltd. Tom Hassard for Red Square.

Six pits were dug to a depth of 500mm in the locations shown on the attached Plan SB/JS/616/TPE. A few minor feeder roots were found in pits 1, 4, 5 & 6 in the topsoil layer to a depth of 250mm. The roots are very likely to be from nearby garden shrubs that include Hydrangea, Camelia, Skimmia and Box. There was no evidence of any substantial tree roots which suggests very strongly that the brick boundary wall has acted as a barrier to roots from the Oak tree T2 and Silver Birch tree T3 in the adjacent garden (see attached Tree Schedule). Pits 1, 2 and 3 had to be excavated through the concrete base of the former summer house / shed building. The concrete base was approximately 180mm deep and reinforced with steel bars. Below that was a deep fill of hardcore rubble. The concrete and rubble base has also inhibited the spread of roots from the Sycamore tree T4 on the northern boundary. Pits 4, 5 and 6 were dug into deeper garden soil. See photographs of the six pits below.

Conclusion: The tall brick boundary wall has acted as an effective root barrier and has prevented the spread / extension of roots from the Oak tree and Silver Birch tree into and below the site of the proposed Orangery building. From an arboricultural point of view the foundation for the Orangery as designed will cause no harm to the Oak tree and Silver Birch tree in the adjacent garden and the Sycamore tree on the northern boundary. As a precaution the heavy duty matting should be extended across the lawn to protect the roots of the large Cedar tree T1 adjacent to the house and the Sycamore tree T4 on the northern boundary (see attached Tree Survey and protection Plan SB/JS/616/TS).

Inspected by: Jeremy Sacha

Signed : *Jeremy Sacha*

For and on behalf of
Sacha Barnes Ltd.

Photographic record:



Test Pit 1.



Test Pit 2.



Test Pit 3.



Test Pit 4.



Test Pit 5.



Test Pit 6.



Concrete and rubble dug out of test pits 1, 2 and 3.



Oak tree T2 in centre photograph and Silver Birch tree T3 just to the left, in the adjacent garden on the far side of the brick boundary wall.



Sycamore /Maple tree T4 on the northern boundary.

Approximate location of Oak tree.



T2

T3



Boundary wall

T4



1.

2.

3.

4.

6.

Orangery

6 trial pits to be dug 500 x 500 x 500mm at 2.0 metres apart along the line of the proposed foundation for the Orangery building. If tree roots larger than 25mm diameter are found, the excavation of that pit should stop and be reported to the Project Arboriculturalist.

5.

Estimated extent of the possible Root Protection Area. The roots may be partially or possibly totally obstructed by the foundations of the boundary wall.

Main House

SCALE METERS
SCALE MAY NOT BE ACCURATE DUE TO PDF



Project:
Land at 6 Templewood Avenue,
London NW3.

Drawing:
Trial Pit Excavations for Tree Roots.
Required for Orangery building.

Scale:
1:100 @ A3

Date:
May 2019

Drawing No.
SB/JS/616/TPE

Sacha Barnes Ltd

The Colin Sanders Innovation Centre, Mewburn Road,
Banbury, OX16 9PA

Tele: 01295 817640, email: enquiries@sachabarnes.com

Drawing based on Garden Design Plan by Hewitt Landscapes.

Tree Schedule – 6 Templewood Avenue NW3.

Tag No.	Species	Height [m]	Stem Dia. [mm]	Ground Clearance to Canopy	Tree spread (m)				Age Class	Life Exp (Y)	Physiological and structural condition	Management	BS 5837 - 2012 classification	Priority
					N	E	S	W						
T1	Atlas Cedar <i>Cedrus atlantica</i>	14	650	6.0m	6.8	7.4	6.5	6.3	Mature	>30	Good form with moderate vigour. Slight lean to north. Main stem forks at 8.5m. Past pruning has raised crown to 6.0m. Roots part restricted by stone slab patio on the north side and stone slab path on the west and south sides. Minor dead branches throughout crown.	Protect with barrier fencing and ground mats in context of the proposed access and construction work for the Orangery.	A	High
T2	English Oak <i>Quercus robur</i>	27.0	Est 900	4.5	12.0	11.5	9.0	Est 9.0	Mature	>40	In adjacent garden. Good form. Major lower limbs pruned in past. Shoots up stem and all major limbs. One dead branch on lowest limb on southwest side.	Remove dead wood.	A	Medium
T3	Silver Birch <i>Betula pendula</i>	8.0	Est 280	2.8	3.8	5.0	7.0	0	Mature	>25	In adjacent garden. Fair form but suppressed by Oak tree T2 and leaning over boundary wall. One weeping limb hanging low over garden. Clearance from lawn just 1.0m.	Remove / prune one limb hanging low over lawn of 6 Templewood Avenue.	C	Medium
T4	Sycamore / Maple <i>Acer pseudoplatanus</i> Var.	18.5	500 400 320	3.0	Est 6.0	6.0	6.8	6.5	Mature	>35	Good multi stem form. 5 stems rise from forks at 1.0m 1.5m and 1.8m. Moderate dead branches	Remove dead wood. Crown raise over roof of house to clear roof by 1.8m.	B	Medium

Tree Schedule – 6 Templewood Avenue NW3.

Tag No.	Species	Height [m]	Stem Dia. [mm]	Ground Clearance to Canopy	Tree spread (m)				Age Class	Life Exp (Y)	Physiological and structural condition	Management	BS 5837 - 2012 classification	Priority
					N	E	S	W						
										throughout crown. Hanging low over tiled roof of adjacent house.	Protect with barrier fencing and ground mats in context of the proposed access and construction work for the Orangery.			

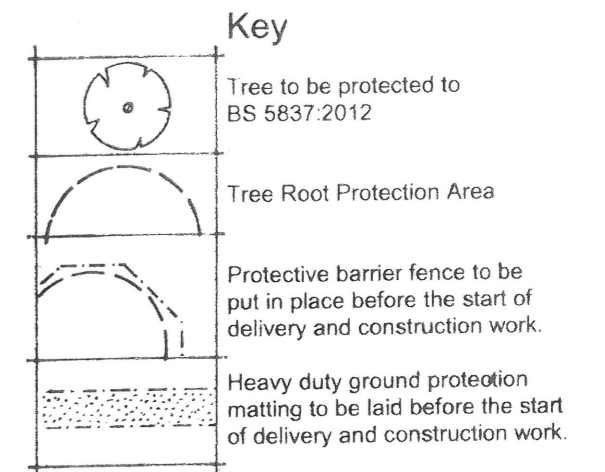
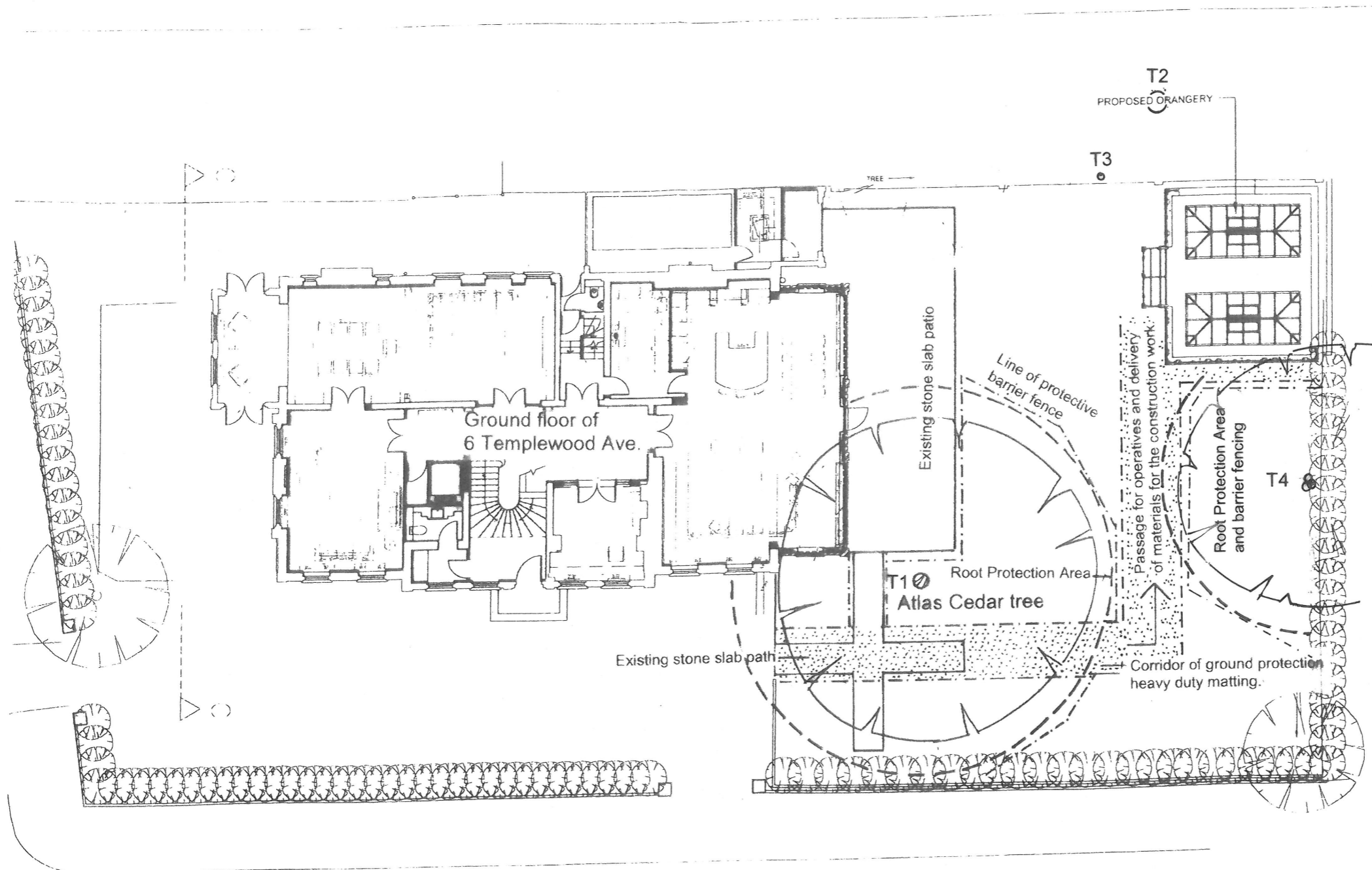

Project: Land at 6 Templewood Avenue, London NW3.	
Drawing: Tree Survey and Protection Plan.	
Scale: 1:200 @ A3	Date: October 2018
Drawing No. SB/JS/616/TS	
Sacha Barnes Ltd	
The Colin Sanders Innovation Centre, Mewburn Road, Banbury, OX16 9PA Tele: 01295 817640, email: enquiries@sachabarnes.com	
Drawing based on proposed plan layout by Hampton Conservatories.	