

5th floor flat 53
West Elevation

Dualslide aluminium framed horizontal sliders inserted into existing hardwood frames shown dark
existing hardwood frames shown dark

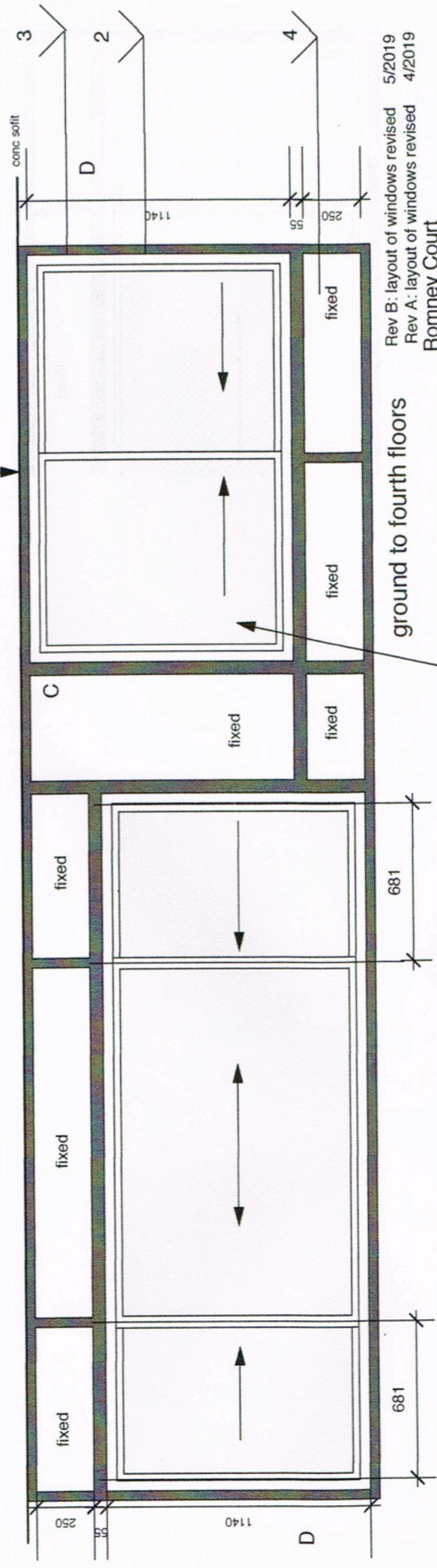

ground to fourth floors

Dualslide aluminium framed horizontal sliders inserted into existing hardwood frames

Rev B: layout of windows revised 5/2019
Rev A: layout of windows revised 4/2019
Romney Court
Existing Hardwood Windows
with Dualslide Aluminium Sliders
inserted in openings
Flats 1, 4, 24 and 53
Scale @ A4 1:25
Dec 2018

Elevation Flats 1 East elevation
4 and 24 West elevation