

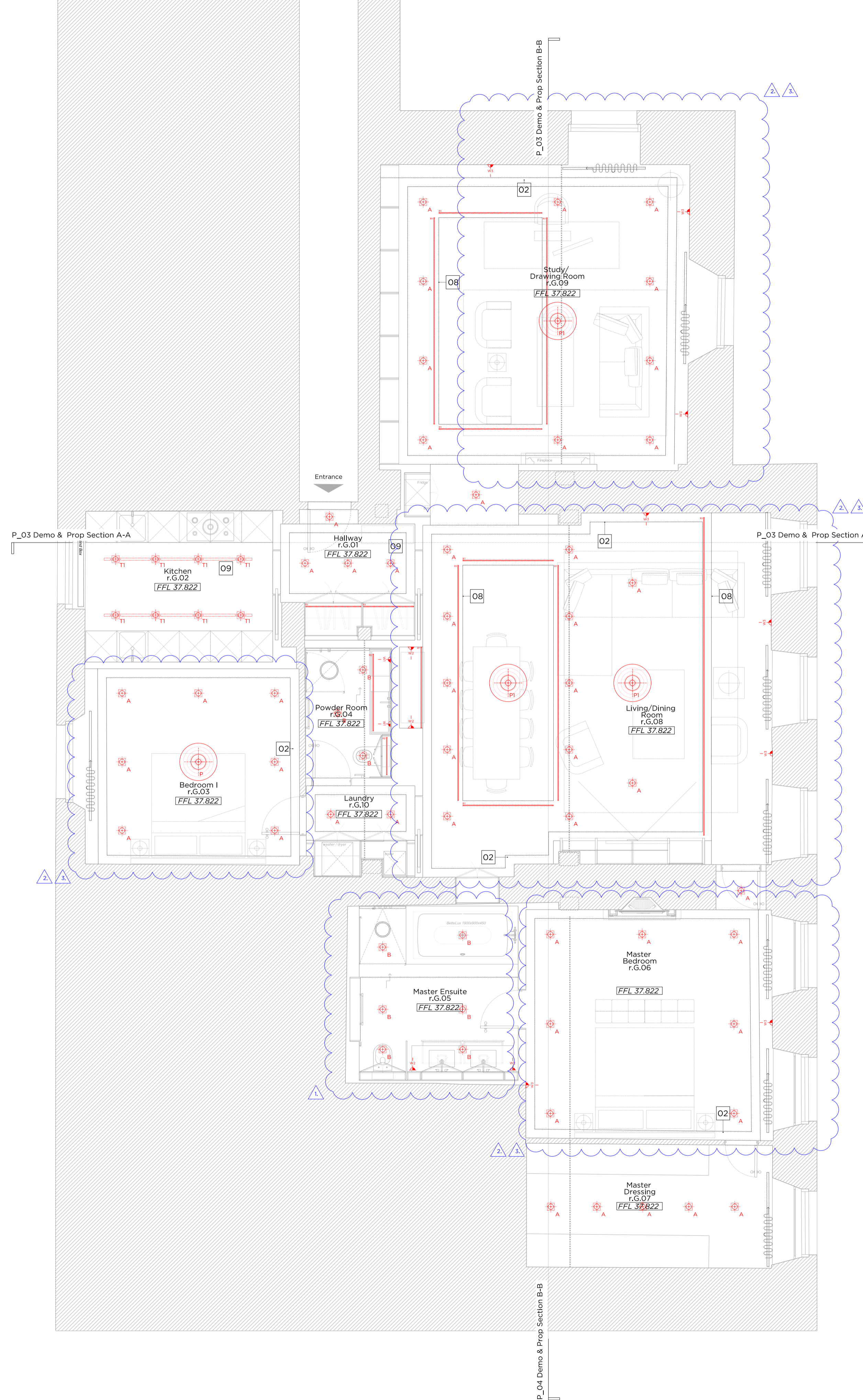

Demolition Ground Floor RCP Plan



Proposed Ground Floor RCP Plan

Key Site Plan 1:250

Key:

- Hatch denotes area of demolition of existing non-original suspended ceiling
- Red line denotes existing non-original mouldings to be removed

Light Fittings:

- Pendant
- Fixed down light
- Recessed track mounted downlight, adjustable
- Strip light
- Internal wall light

Other fittings:

- Curtains & recessed curtain track
- Recessed showerhead fitting

Non-original partitions to be removed.

Removal of masonry to create enlarged opening.

Non-original door to be removed and replaced. Refer to Door Schedule.

Non-original suspended ceiling to be removed and replaced. Refer to Schedule of Proposed Works.

Non-original cornice to be removed and replaced. Refer to Schedule of Proposed Works.

Non-original fireplace and surround to be carefully removed and reinstated.

Non-original sanitaryware fittings to be removed.

Non-original joinery to be removed.

Non-original kitchen to be removed and replaced.

Removal of masonry to create new opening for decorative fireplace.

Proposed Notes:

- New non-load bearing internal partition.
- New traditionally detailed cornice. Refer to Schedule of Proposed Works.
- Proposed decorative fireplace and surround to be traditionally detailed.
- New hardwood paneled door and architrave. Refer to Door Schedule.
- New hardwood paneled pocket door and architrave. Refer to Door Schedule.
- Enlarged opening within existing wall retaining downstand above to reinstata cornice.
- New opening within existing wall retaining downstand above to reinstata cornice.
- New suspended ceiling with recessed coffered ceiling to increase ceiling heights in principal rooms, with concealed LED light fittings.
- New suspended ceiling with concealed LED light fittings.
- New hardwood joinery with cornice above.
- New freestanding joinery, independent to existing wall and mouldings.
- New traditionally detailed skirtings.
- New traditionally detailed paneled walls to principal rooms.
- Existing window to be retained and redecorated.
- New hardwood kitchen (reusing existing hob extraction).
- New floor to ceiling joinery.
- New vertical secondary glazing unit.

- Rev B - For Planning
- Bathroom layout amended; light locations adjusted
 - Omission of coffered ceiling detail due to site discoveries
 - Amendment to lighting layout due to revised room layout
- Rev A - For Planning
- Existing dressing room walls and joinery retained; master bedroom location amended
 - Bathroom layout amended
 - Lighting layout updated to suit amended room layouts
- Rev - For Planning
- 06.04.18

PLANNING

Project No. 17080

Client Simon Gold

Date June 2019

Scale 1:50@A1 / 1:100@A3

Project No. 29 Cumberland Terrace

Drawing Title: Demolition and Proposed Ground Floor Plan - RCP

Drawing No. P_04 Rev. B

Drawn SW	Approved RD	Signed
----------	-------------	--------

Marek Wojciechowski Architects

66-68 Margaret Street W1W 8SR T. 020 7580 9336 www.mw-a.co.uk

Copyright Marek Wojciechowski Architects Limited. No implied license exists. This drawing should not be used to calculate areas for the purposes of valuation. All dimensions to be checked on site by the contractor and such dimensions to be their responsibility. Do not scale drawings. All work must comply with relevant British Standards and Building Regulations requirements. Drawing errors and omissions to be reported to the architect.

0 0.5m 1m 2m 3m 4m 5m