

LEGEND

1. High quality engineered brickwork
2. Textured brick panel
3. Natural stone column
4. Natural stone sill / horizontal banding
5. Coping stone
6. Perforated metal solar shading
7. Basement retaining wall - Subject to SE specification
8. 250x600mm RC column - Subject to SE specification
9. 325x325mm RC column - Subject to SE specification
10. RC walls
11. RC staircase
12. Steel staircase - Location TBC
13. Knockout panel for wheelchair platform
14. Blue roof
15. Narrow profiled metal glazing system
16. Metal balustrade and handrail
17. Retail unit entrance door
18. Residential entrance door
19. Entrance canopy
20. Partition wall with plastered finish (Tiled to bathroom/en suite)
21. Separating wall with plasterboard finish
22. Kitchen units
23. Wardrobe
24. External balcony / terrace
25. Planter
26. Fire curtain
27. Louvered door
28. Gate
29. New bus stop post
30. New bus stop shelter
31. Photovoltaics - Subject to ME specification
32. Flue extract - Subject to ME specification
33. Cast in shower tray & trap beneath bath

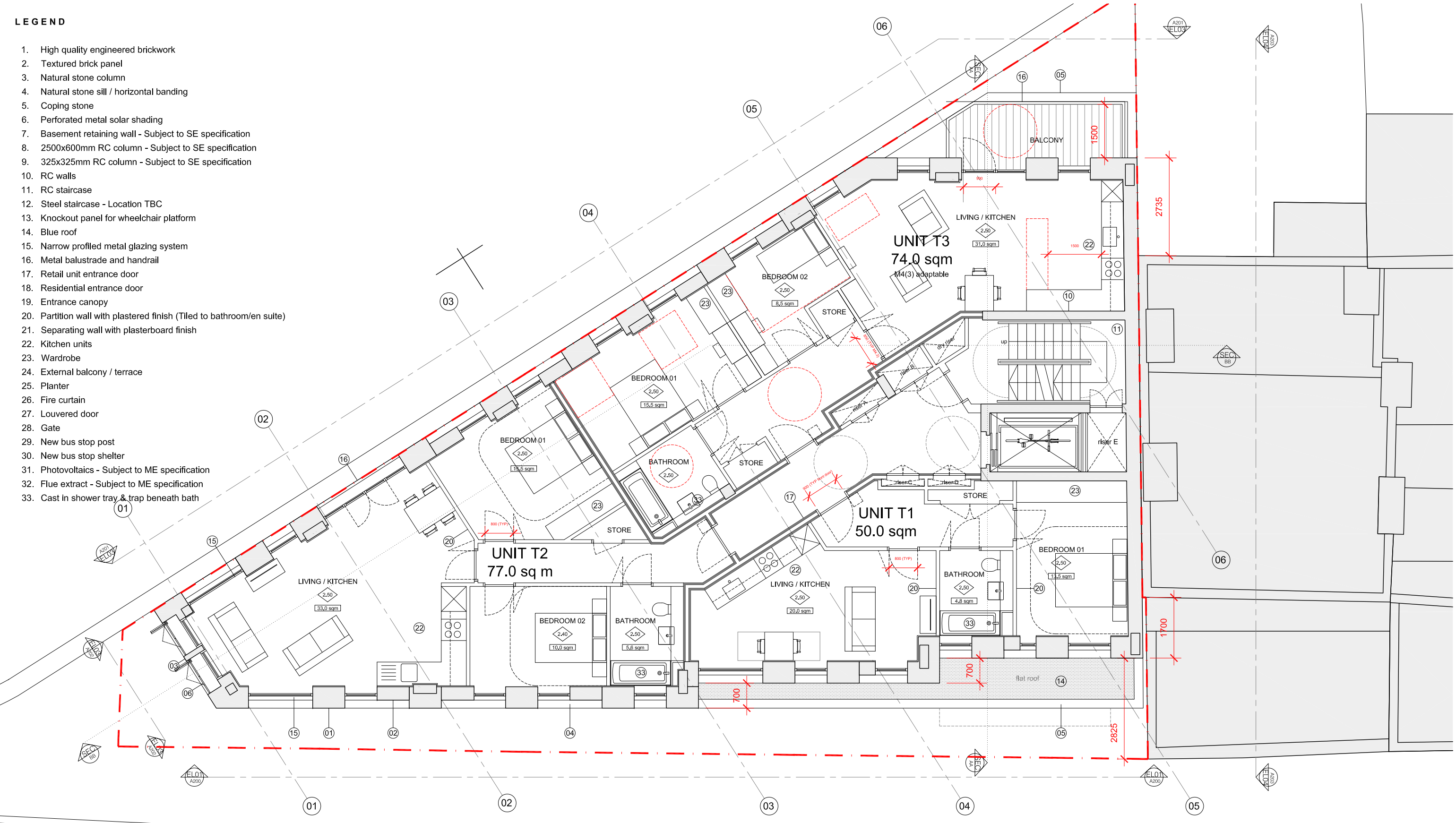

01 PROPOSED TYPICAL FLOOR PLAN
A101 Scale 1:50 @ A1 / 1:100 @ A3

date	rev	revisions
12.04.19	A	Updated design following DRP comments
29.05.19	B	Additional furniture and door nibs shown to demonstrate accessibility

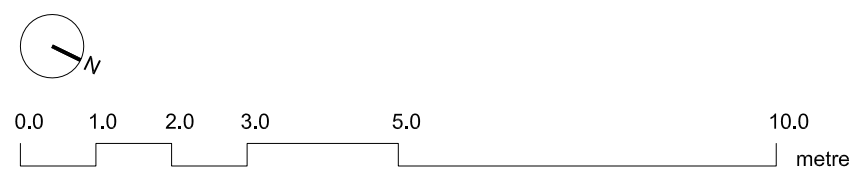

notes

DMFK Architects Ltd take no responsibility for dimensions obtained by scaling from this drawing. If no dimension is shown the recipient must ascertain the dimension specifically from the architect or by site measurement and may not rely on the drawing. Supply of the drawing in digital form is solely for convenience and no reliance may be placed on any data in digital form. All data must be checked against hard copy. This drawing is issued for design intent only and should not be used for construction unless stated.

copyright
 This drawing is the property of dMFK Architects Ltd. No disclosure or copy of it may be made without the written permission of dMFK Architects Ltd.

DE METZ FORBES KNIGHT ARCHITECTS
 the old library 119 chalmley gardens london nw6 1aa t 020 7435 1144 f 020 7435 0884 mail info@dmfk.co.uk
 project Kentish Town Road (369-377) drawing title

PROPOSED DRAWINGS
 TYPICAL FLOOR PLAN

client	scale at A1	scale at A3	drawn	date
-	1:50	1:100	LS	APRIL 19
	project no.	drawing no.	revision	
	2115	A101	B	

