



Electronic file reference:

Revision	Status	Date
1	Information	06/05/2019

Key

- ① Fixed rooflight to flat roof
- ② Single ply membrane to flat roof
- ③ Traditionally detailed timber glazed French door
- ④ Glazed balustrade with metal (painted) Handrail
- ⑤ Steel beam (painted grey)
- ⑥ Fineline Aluminium System 22 glazed sliding doors
- ⑦ Fineline Aluminium System 22 glazed pivot doors

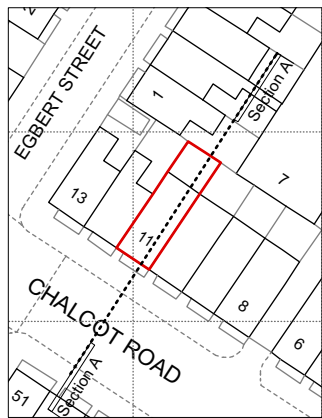

CLIENT
Ms S McKinnon

PROJECT TITLE
11 Chalcot Road
London, NW1

DRAWING TITLE
Section AA
Proposed

SCALE @ A3
1:100

DRAWING N° AS026 275 STATUS & REVISION P1

Purpose of Issue
Information ☐ Approval ☐
Comment ☐ Construction ☐

General Notes

All setting out must be checked on site.
All levels must be checked on site and refer to Ordnance Datum.
All fixings and weatherings must be checked on site.
All dimensions must be checked on site.
This drawing must be read in conjunction with all other relevant drawings.
This drawing must not be used for land transfer purposes.
Calculated areas in accordance with Atnica Ltd. Definition of Areas for Schedule of Areas
Atnica Ltd. has prepared this document in accordance with the instructions of the Client under the agreed Terms of Business. This document is for the sole and specific use of the Client and Atnica Ltd. shall not be responsible for any use of its contents for any purpose other than that for which it was prepared and provided. Should the Client require to pass electronic copies of the document to other parties, this should be for co-ordination purposes only, the whole of the file should be so copied, but no professional liability or warranty shall be extended to other parties by Atnica Ltd. in this connection without the explicit written agreement thereto by Atnica Ltd.

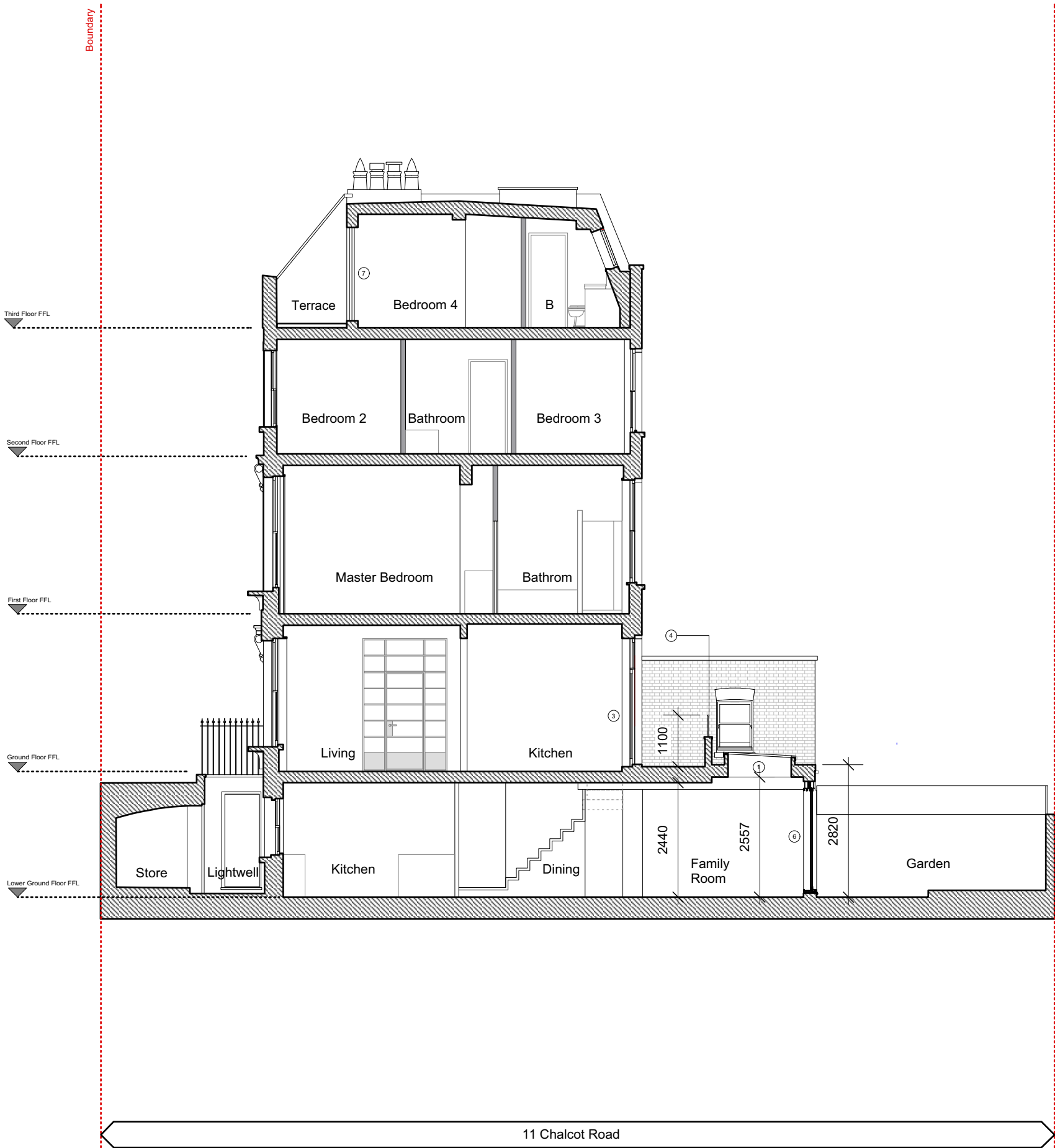

Section AA Proposed
Scale: 1:100