

Notes:

1. This drawing should be read in conjunction with JSH mechanical services specification ref: EB/CR/5557/M.
2. The School has advised that there is asbestos products in the working areas. The Contractor shall communicate with the Main Contractor and the School prior to any works being undertaken.

Legend:

- Existing Pipework run in ceiling void (CV)
- - - Existing Pipework run at high level (HL)
- Existing Pipework run at low level (LL)
- - - Existing Pipework run below ground level (UG)
- Existing Pipework drop / rise
- ⊘ Isolating valve (IV)
- ⊘ Commissioning set (CS)
- ⊘ Radiator

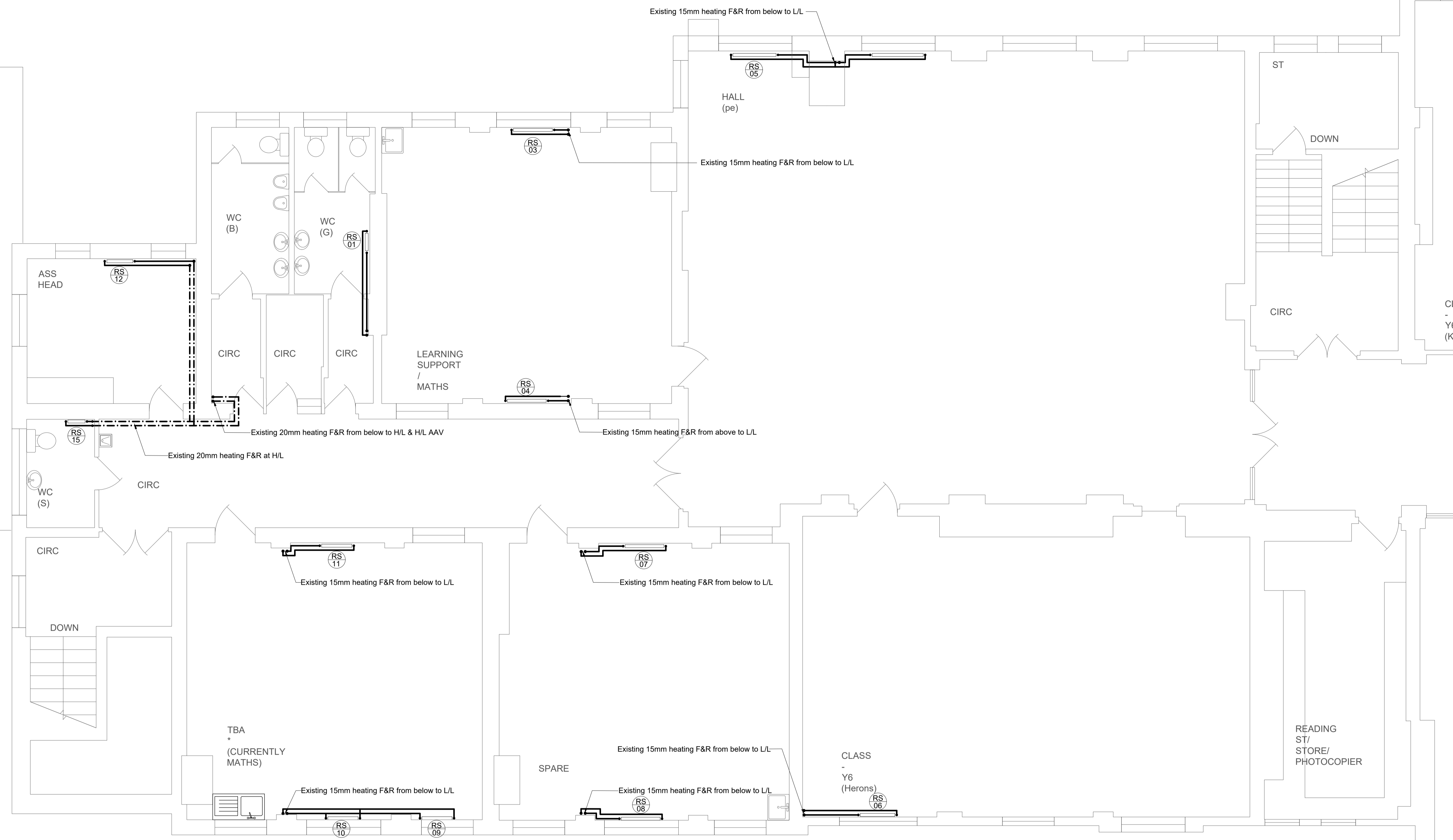

Radiators Schedule									
RAD REF	LOCATION	MANUFACTURER	MODEL	TYPE	HEIGHT (mm)	LENGTH (mm)	OUTPUT (W)	VALVES	NOTES
RS1	WC (G)	-	-	-	-	-	956	-	Existing
RS3	Learning Support/Maths	-	-	-	-	-	2150	-	Existing
RS4	Learning Support/Maths	-	-	-	-	-	2150	-	Existing
RS5	Hall	-	-	-	-	-	2389	-	Existing
RS6	Class - Y6	-	-	-	-	-	1911	-	Existing
RS7	Spare	-	-	-	-	-	2150	-	Existing
RS8	Spare	-	-	-	-	-	2150	-	Existing
RS9	Maths	-	-	-	-	-	1672	-	Existing
RS10	Maths	-	-	-	-	-	1672	-	Existing
RS11	Maths	-	-	-	-	-	1672	-	Existing
RS12	ASS Head	-	-	-	-	-	1433	-	Existing

P01	Tender Issue	CR	EB	05/19
REV	DESCRIPTION	DR'WN	CHK'D	DATE

Johns Slater and Haward
 Chartered Building Services Consultants
 Ardennais House, 6 Sorrel Horse Mews, Grimwade St, Ipswich IP4 1LN
 01473 255965, engineers@jshipswich.co.uk, www.jshipswich.co.uk



CLIENT:

PROJECT:
 Primrose Hill Primary School ARP

DRG TITLE:
 Second Floor
 Existing Heating Layout

SCALE: 1:50 @ A1	STATUS: D2 - Tender	PROJECT: 5557.00	ORIGINATOR: JSH
ZONE: XX	LEVEL: 02	TYPE: DR	DRG No. REV M-0254 P01