

COPYRIGHT
This drawing is copyright and may not be altered, reproduced or used other than for the Contract Works for which it is issued without written permission.
© : Johns Slater and Haward Ltd.

Notes:

1. This drawing should be read in conjunction with JSH mechanical services specification ref: EB/CR/5557/M.
2. The School has advised that there is asbestos products in the working areas. The Contractor shall communicate with the Main Contractor and the School prior to any works being undertaken.

Legend:

- Existing Pipework run in ceiling void (CV)
- Existing Pipework run at high level (HL)
- Existing Pipework run at low level (LL)
- Existing Pipework run below ground level (UG)
- Existing Pipework drop / rise
- Isolating valve (IV)
- Commissioning set (CS)
- Radiator

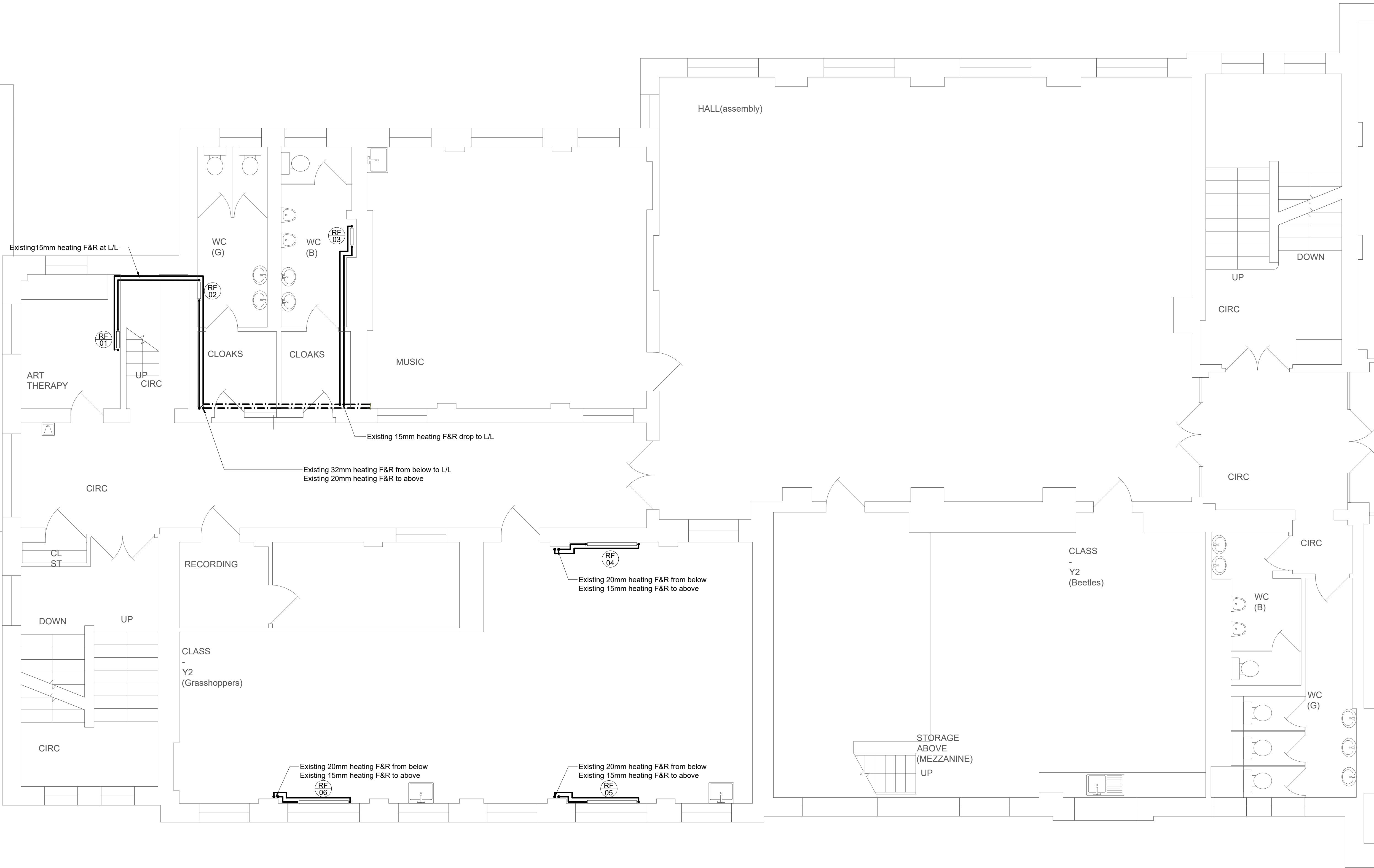

Radiators Schedule									
RAD REF	LOCATION	MANUFACTURER	MODEL	TYPE	HEIGHT (mm)	LENGTH (mm)	OUTPUT (W)	VALVES	NOTES
RF1	Art Therapy	-	-	-	-	-	956	-	Existing
RF2	WC (G)	-	-	-	-	-	956	-	Existing
RF3	WC (B)	-	-	-	-	-	956	-	Existing
RF4	Class - Y2	-	-	-	-	-	2867	-	Existing
RF5	Class - Y2	-	-	-	-	-	2867	-	Existing
RF6	Class - Y2	-	-	-	-	-	2867	-	Existing

P01	Tender Issue	CR	EB	05/19
REV	DESCRIPTION	DR'WN	CHK'D	DATE

Johns Slater and Haward
Chartered Building Services Consultants
Ardennais House, 6 Sorrel Horse Mews, Grimwade St, Ipswich IP4 1LN
01473 255965, engineers@jshipswich.co.uk, www.jshipswich.co.uk



CLIENT:



PROJECT:

Primrose Hill Primary School ARP

DRG TITLE:

First Floor
Existing Heating Layout

SCALE: 1:50 @ A1	STATUS: D2 - Tender	PROJECT: 5557.00	ORIGINATOR: JSH
ZONE: XX	LEVEL: 01	TYPE: DR	DRG No. REV M-0253 P01