

**Notes:**

1. This drawing should be read in conjunction with JSH mechanical services specification ref: EB/CR/5557/M.
2. The School has advised that there is asbestos products in the working areas. The Contractor shall communicate with the Main Contractor and the School prior to any works being undertaken.

**Legend:**

- Pipework run in ceiling void (CV)
- - - - - Pipework run at high level (HL)
- \_\_\_\_\_ Pipework run at low level (LL)
- - - - - Pipework run below ground level (UG)
- Pipework drop / rise
- - - - - Existing Pipework run in ceiling void (CV)
- - - - - Existing Pipework run at high level (HL)
- \_\_\_\_\_ Existing Pipework run at low level (LL)
- - - - - Existing Pipework run below ground level (UG)
- Existing Pipework drop / rise
- ⊘ Isolating valve (IV)
- ⊘ Commissioning set (CS)
- Radiator

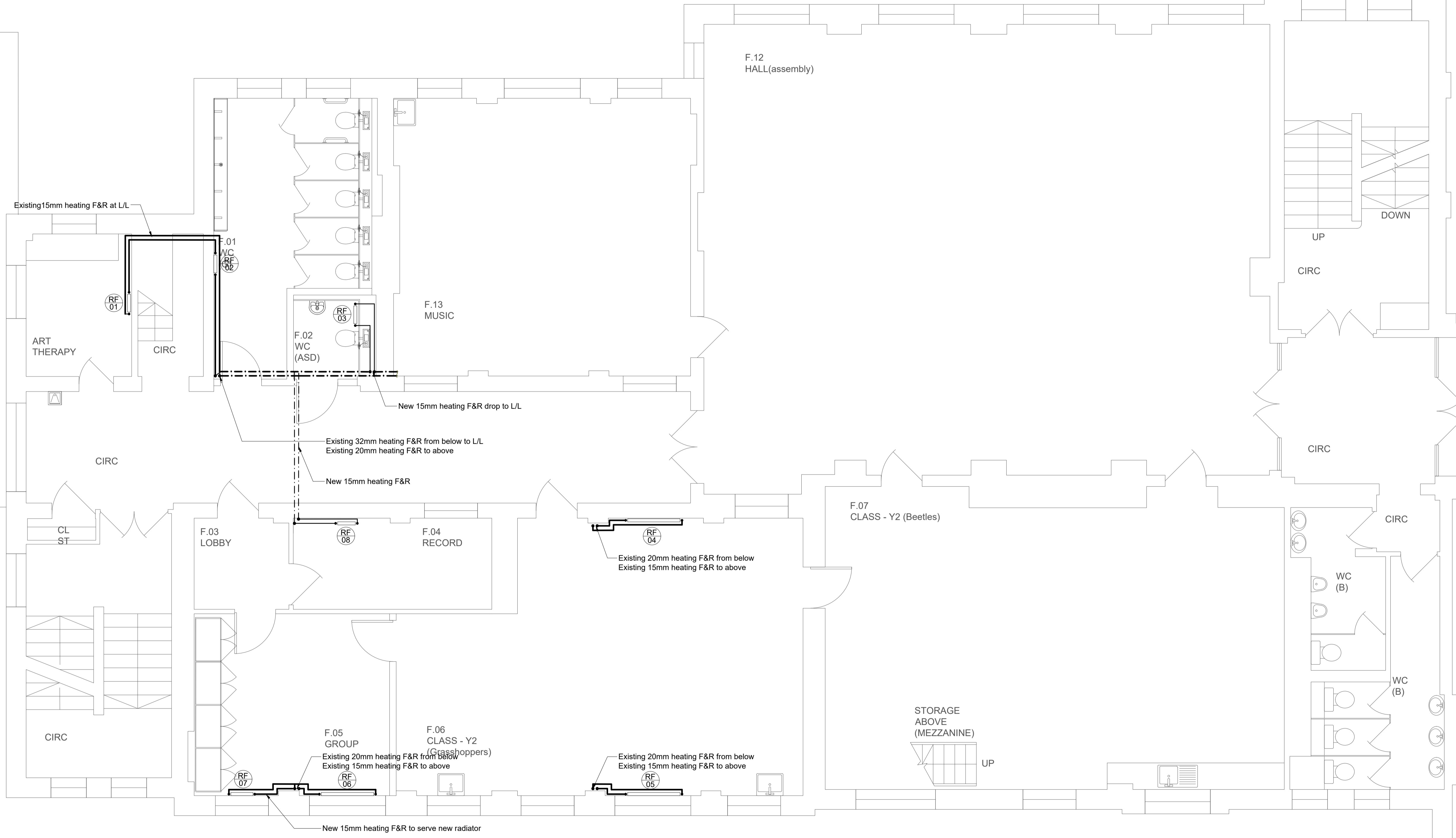

Radiators Schedule									
RAD REF	LOCATION	MANUFACTURER	MODEL	TYPE	HEIGHT (mm)	LENGTH (mm)	OUTPUT (W)	VALVES	NOTES
RF1	Art Therapy	-	-	-	-	-	956	-	Existing
RF2	WC (G)	-	-	-	-	-	956	-	Existing
RF3	WC (ASD)	-	-	-	-	-	956	-	Existing
RF4	Class - Y2	-	-	-	-	-	2867	-	Existing
RF5	Class - Y2	-	-	-	-	-	2867	-	Existing
RF6	Group Room	-	-	-	-	-	2867	-	Existing
RF7	Group Room	Stelrad	Compact	K2	600	500	866	TRV/LSV	New
RF8	Record Room	Stelrad	Compact	K2	600	500	866	TRV/LSV	New

P01	Tender Issue	CR	EB	05/19
REV	DESCRIPTION	DR'WN	CHK'D	DATE

**Johns Slater and Haward**  
 Chartered Building Services Consultants  
 Ardennais House, 6 Sorrel Horse Mews, Grimwade St, Ipswich IP4 1LN  
 01473 255965, engineers@jshipswich.co.uk, www.jshipswich.co.uk



CLIENT:

PROJECT:  
 Primrose Hill Primary School ARP

DRG TITLE:  
 First Floor  
 Proposed Heating Layout

SCALE: 1:50 @ A1	STATUS: D2 - Tender	PROJECT: 5557.00	ORIGINATOR: JSH
ZONE: XX	LEVEL: 01	TYPE: DR	DRG No. REV M-0203 P01