

Rev:	Date:	By:	Check:	Appr:	Description:
P1	26.02.19	KR	KM	DG	First issue
P2	12.04.19	NW	KM	DG	Draft tender
T1	07.05.19	NW	KM	DG	Tender Issue

General Notes

This drawing should be read in conjunction with all relevant GA drawings, specification and detail drawings.

M&E fittings such as lights, detectors and grilles: refer to M&E spec and drawings for details. Setting out of fittings to be fully coordinated before Construction issue.

Fitting pattress requirements TBC by M&E Eng.

Please note: acoustic absorption wall panels requirements are not shown on RCPs refer to detail room layout drawings for details.

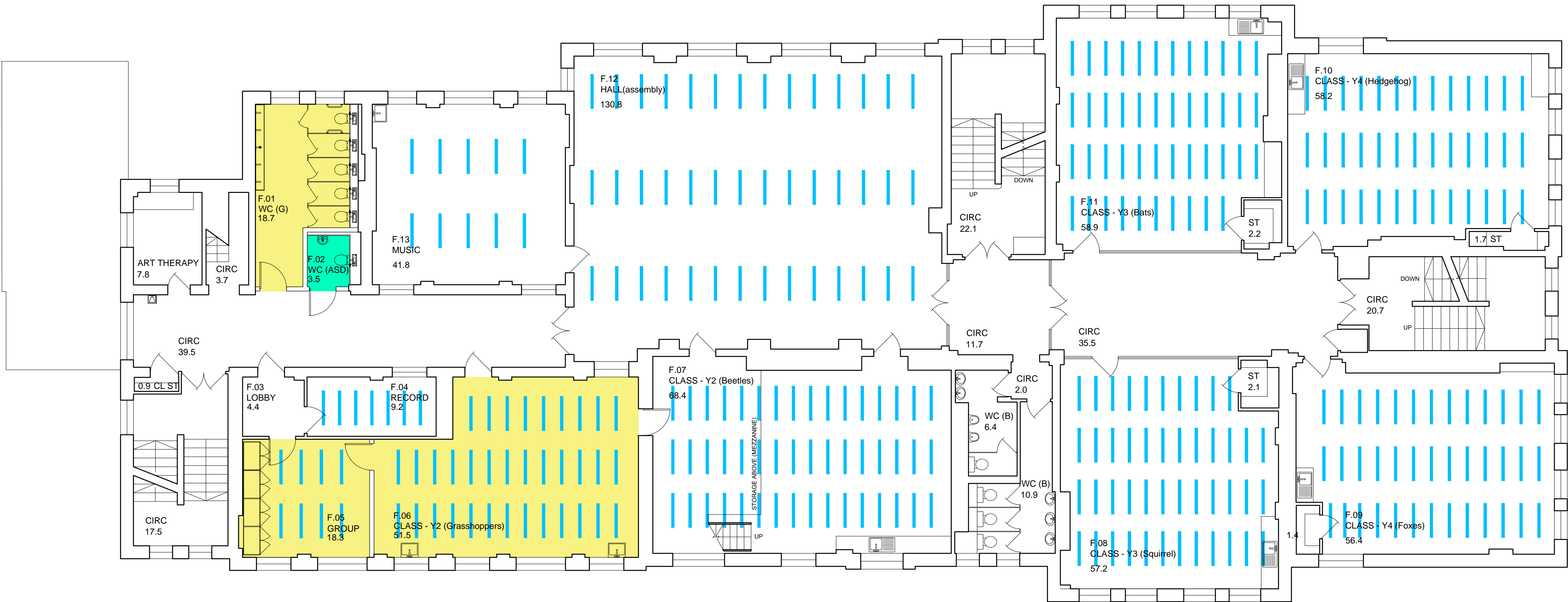

Ceiling Finishes Key

- Ceiling type C1**
Make good and decorate existing ceiling
- Ceiling type C2 K10/220**
New plasterboard ceiling
- Ceiling type C3 K40/115A**
New class A acoustic Baffle
- Ceiling type C4 K13/170A**
Acoustic panel lining
- Plasterboard vertical Lining K10/220A** Plasterboard vertical lining to change of level/bulkhead. Allowance required as requirement is subject to coordination M&E strategy.

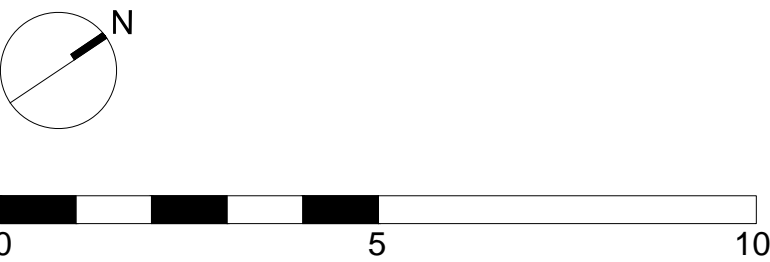

Haverstock LLP
Studio 10, Cliff Road Studios
Cliff Road, London NW1 9AN

tel +44 (0)20 7267 7676
info@haverstock.com
www.haverstock.com

Client:
London Borough of Camden

Job Title:
Primrose Hill Primary School ARP

Drawing Title:
Proposed Ceiling Scope
First

Job/Dwg No/Rev:	1161	1106	T1
-----------------	------	------	----

Drawn:	Checked:	APPR:	Date:
KR	KM	DG	26.02.19

Drawing status: Tender
Do not scale from this drawing. Check all dimensions on site before ordering.

Scale(s):
1:100 @ A1