

Rev:	Date:	By:	Chk:	App:	Description:
P1	26.02.19	KR	KM	DG	First issue
P2	12.04.19	NW	KM	DG	Spec refs added
T1	07.05.19	NW	KM	DG	Tender Issue

General Notes

This drawing should be read in conjunction with all relevant GA drawings, specification and detail drawings.

Floor gullies and drains not shown refer to detail room layout drawings for details.

Allow for threshold strips at change in flooring as M50/740

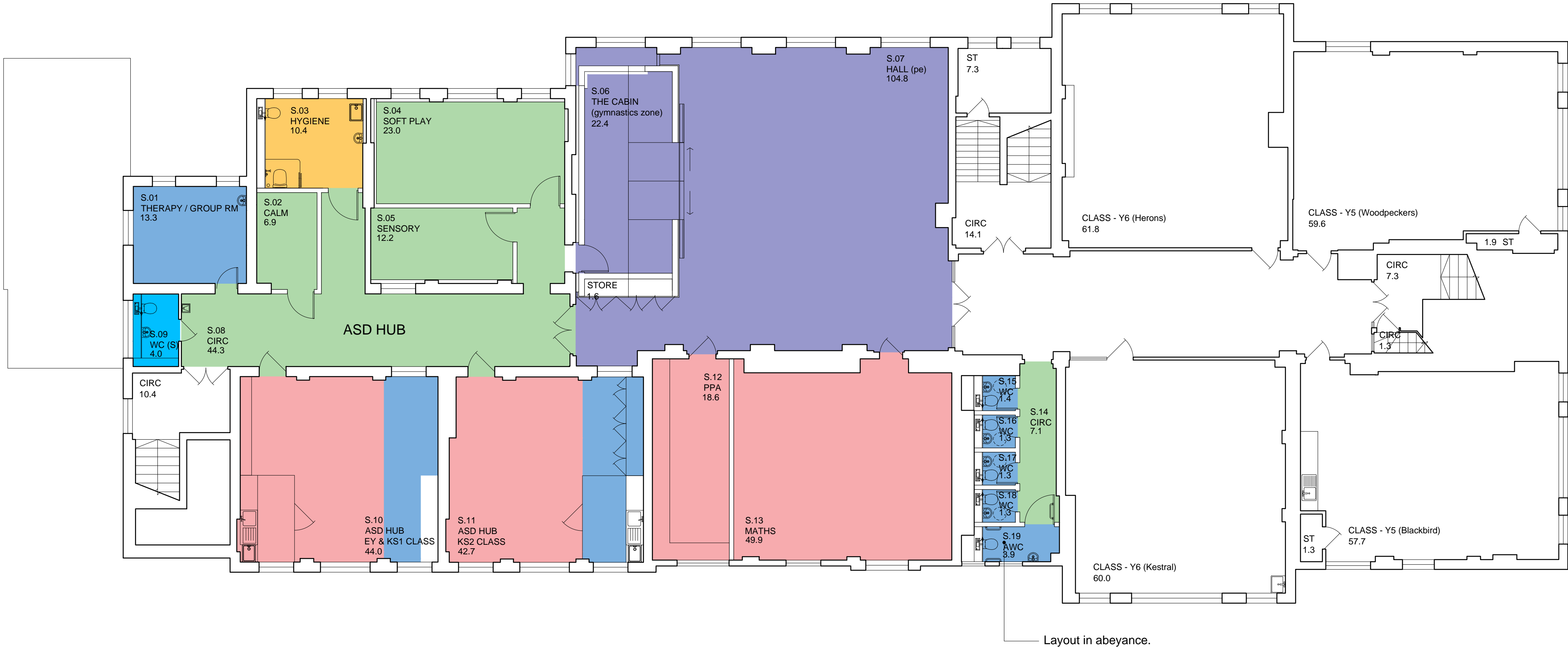

Floor Finishes Legend

- M50/130 Carpet Tiles
Including covered skirting
- M50/151 R9 Linoleum
Including covered skirting
- M50/152 R10 Linoleum
Including covered skirting
- M50/153 R10 Wet Room Vinyl
Including covered skirting
- M42/110A Existing Parquet
Including covered skirting
- Spec TBC Transition Strip

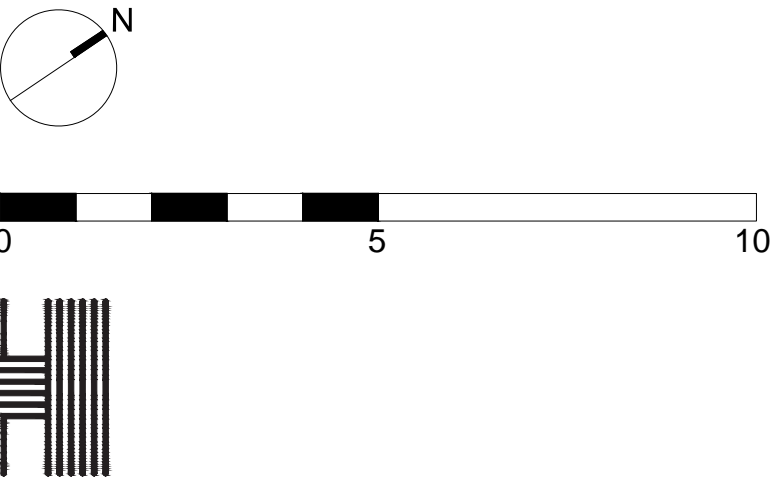

Haverstock LLP
Studio 10, Cliff Road Studios
Cliff Road, London NW1 9AN

tel +44 (0)20 7267 7676
info@haverstock.com
www.haverstock.com

Client:
London Borough of Camden

Job Title:
Primrose Hill Primary School ARP

Drawing Title:
Proposed Floor Finishes Scope
Second

Job/DwgNo/Rev:	1161	1103	T1
----------------	------	------	----

Drawn:	Checked:	APPR:	Date:
KR	KM	DG	26.02.19

Drawing status: Tender
Do not scale from this drawing. Check all dimensions on site before ordering.

Scale:
1:100 @ A1