

Rev.	Date	By	Check	Appr	Description
P1	06.02.19	KM	KM	DG	First issue
P2	26.02.19	KM	KM	DG	Updates following CEM with school and LBC.
P3	12.04.19	KM	KM	DG	Draft tender
T1	07.05.19	NW	KM	DG	Tender issue

General Notes

Based on plan provided by LBC as part of feasibility study. Detailed survey plans of existing required.

- To be read in conjunction with:
- Demolition Plans 1161-1050 to 1053
 - Fire Strategy Plans 1161-1150 to 1156
 - Ceiling Scope Plans 1161-1104- to 1107
 - Proposed Floor Finishes Scope Plans 1161-1100 to 1103
 - Internal Partition Type Drawing 1161-3000
- Decoration & Applied Finishes Scope Plans 1161-1108 to 1111
Internal Elevations 1161-2150 to 2160

Detailed Scope of Works Notes

- 1.0 Partitions / Walls / Ceilings excl acoustic treatment**
- 1.1 New full height partition, acoustic rating TBC by acoustician
 - 1.2 New full height wall lining
 - 1.3 New partition, height to underside of existing picture rail 2.9m with feature timber paneling to hall side - detail TBC
 - 1.4 Tanking to localised damp to existing coal chute
 - 1.5 Allowance required to make good external walls to lightwell inc gratings over
 - 1.6 New full height wall lining with insulated plasterboard
 - 1.7 New suspended MF plasterboard ceiling, height TBA
 - 1.8 New full height partition, to encapsulate high-level existing glazed screen.

- 2.0 Doors / Glazed Screens**
- 2.1 New internal door within new partition
 - 2.2 New internal door within existing door opening
 - 2.3 New internal door within new opening in existing wall
 - 2.4 Existing door to be refurbished
 - 2.5 New sliding folding screen with pass door- omitted.
 - 2.6 New internal door within existing cill height glazed screen opening. Allowance required for retaining & making good glazed screen over.
 - 2.7 Existing door leaf and frame to be removed. Allowance required for making good high-level glazed screen over

- 3.0 Windows**
- 3.1 New timber sash windows to existing window opening. Allowance required for new internal cill

- 4.0 Sanitary**
- 4.1 New toilets, trough sinks and IPS / cubicles. Refer to room elevations for details
 - 4.2 New clinical sink with elbow taps (location TBA to best suit existing drainage)

- 5.0 FFE (indicative only, further consultation with LBC required)**
- 5.1 New blinds
 - 5.2 New kitchenette with s/s sink, belfast sink & undercounter fridge, with low level gate & screen for separation with classroom.
 - 5.3 Soft play fitout by specialist
 - 5.4 Sensory room fitout by specialist
 - 5.5 Gym fitout by specialist
 - 5.6 New classroom storage wall
 - 5.7 New fitted desk

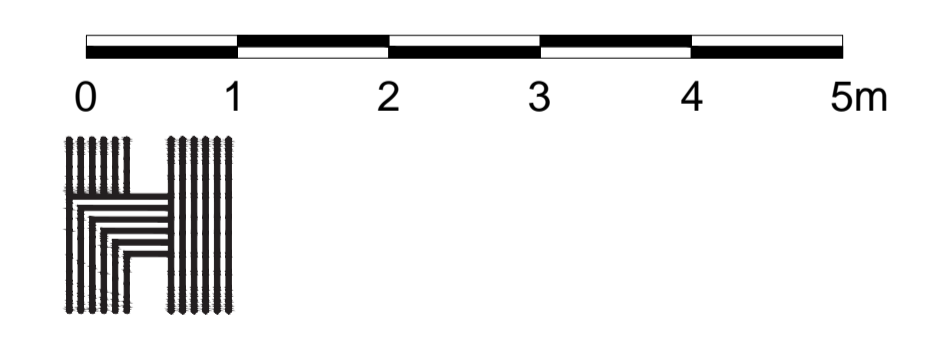
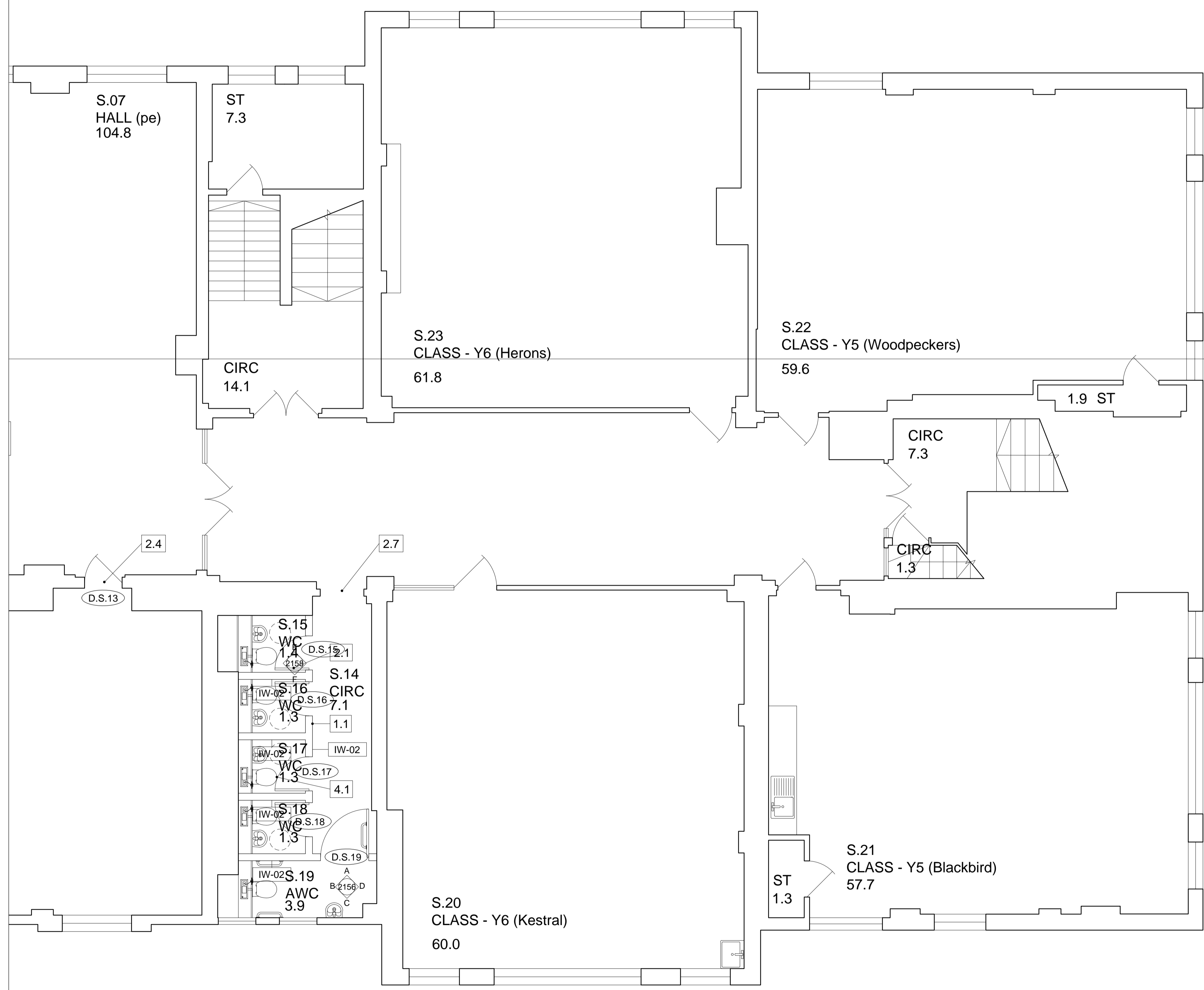

Haverstock LLP
Studio 10, Cliff Road Studios
Cliff Road, London NW1 9AN

tel +44 (0)20 7267 7676
info@haverstock.com
www.haverstock.com

Client:
London Borough of Camden

Job Title:
Primrose Hill Primary School ARP

Drawing Title:
Proposed 1.50 Plan - Second Floor - 2 of 2

Job / Dwg No / Rev.	1161	1028	T1
Drawn:	Checked:	APPR:	Date:
KR	KM	DG	06.02.19

Drawing status: Tender
Do not scale from this drawing. Check all dimensions on site before ordering.

Scale:
1:50 @ A1