

Rev.	Date	By	Chk	Appr	Description
P1	17.01.19	KM	KM	DG	First issue
P2	06.02.19	KM	KM	DG	General updates as clouded
P3	12.04.19	NW	KM	DG	Draft tender
P4	01.05.19	NW	KM	DG	General updates as clouded
T1	07.05.19	NW	KM	DG	Tender Issue

**General Notes**

Based on plan provided by LBC as part of feasibility study.  
Detailed survey plans of existing required.

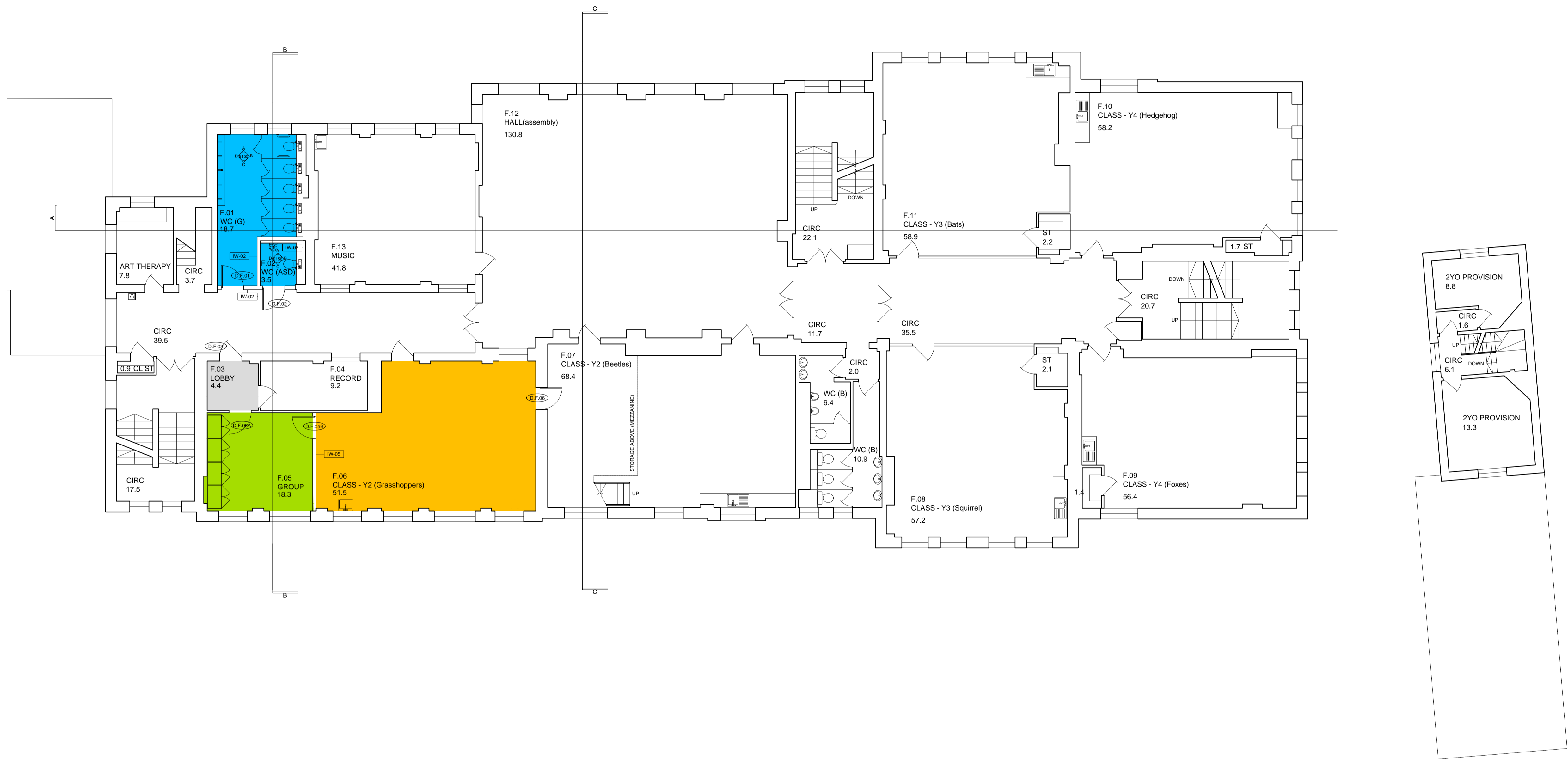

**Key**

- Circulation
- Classrooms
- Learning resource
- Staff
- Hall / dining
- Store
- Plant / kitchen
- Sanitary

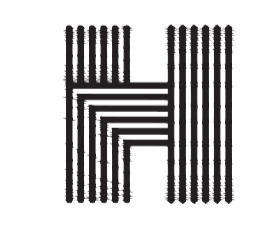
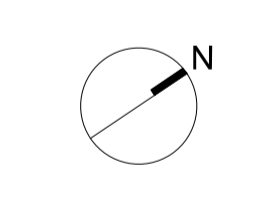

**Haverstock LLP**  
Studio 10, Cliff Road Studios  
Cliff Road, London NW1 9AN

tel +44 (0)20 7267 7676  
info@haverstock.com  
www.haverstock.com

**Client:**  
London Borough of Camden

**Job Title:**  
Primrose Hill Primary School ARP

**Drawing Title:**  
Proposed Plan - First

Job / Dwg No / Rev.	1161	1013	T1
Drawn:	Checked:	APPR:	Date:
KM	KM	DG	17.01.2018

**Drawing status:** Tender  
Do not scale from this drawing. Check all dimensions on site before ordering.

**Scale:**  
1:100 @ A1