

Existing crossover to be replaced with pavement to provide additional on-street parking

Existing external hard landscaping and garden walls to be demolished

Outline of existing 2 storey building. Entire building to be demolished.

Site Boundary

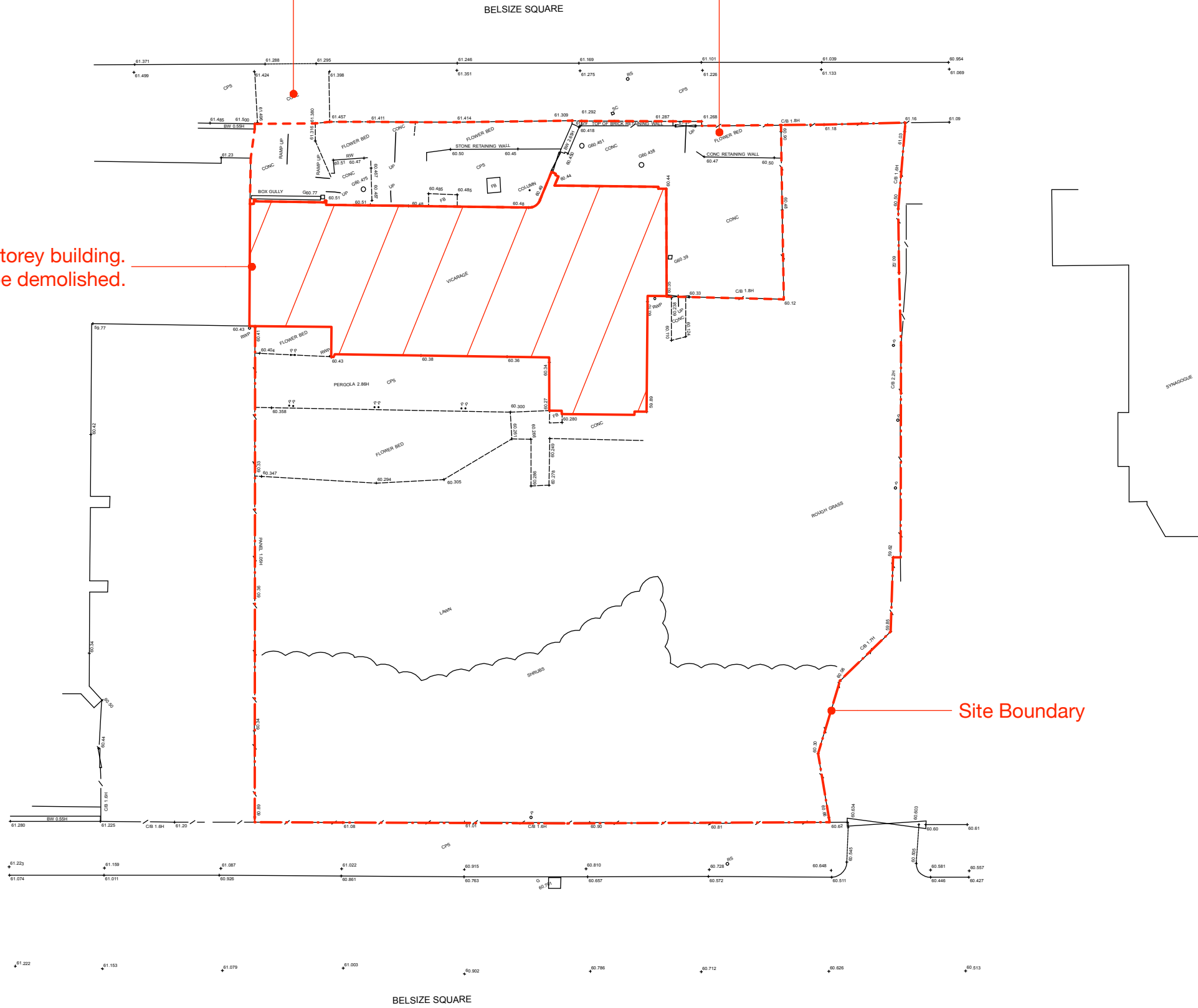

Client
The Diocese of London

Project
St Peter's Vicarage
53 Belsize Square, NW3 4HY

Drawing Status
Planning

Title Drawing
Existing Site Plan
Demolition Drawing

Scale
1:200 @ A3

Date
16.12.2015

Drawing No
1984-01-DRG-050

Revision
-

Checked
GM

**JOHNSON
NAYLOR**

020 7490 8885 | jn@johnsonnaylor.co.uk
13 Britton Street London EC1M 5SX
johnsonnaylor.co.uk

Copyright Johnson Naylor. All dimensions to be Checked on Site by Contractor. DO NOT SCALE.

1984-01-DRG-050

