

OSPRINGE ROAD

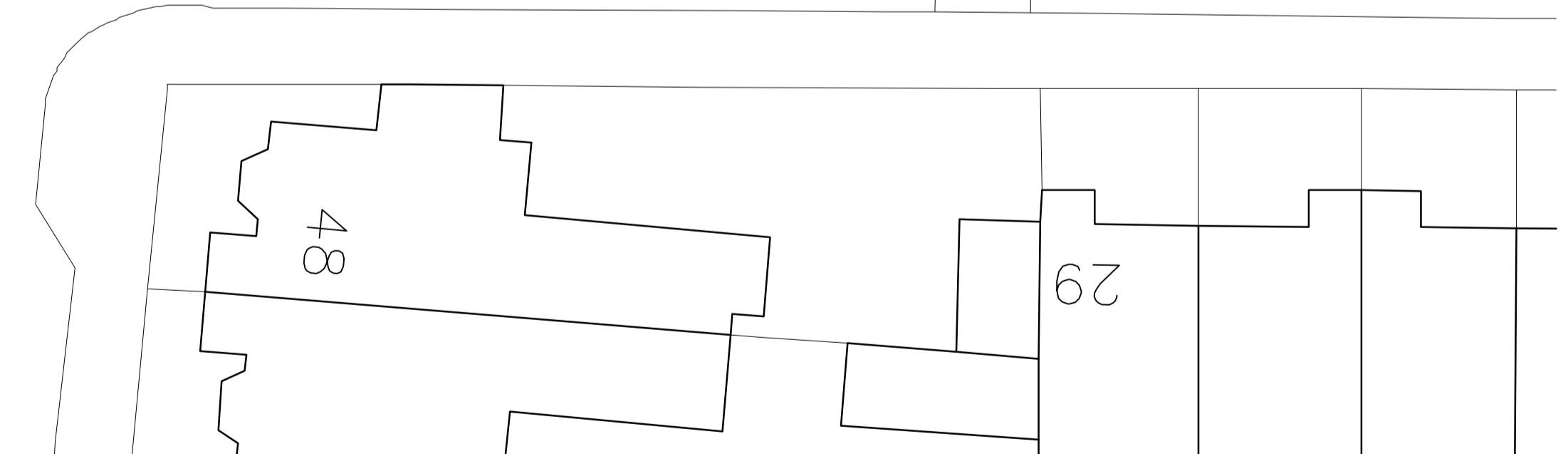

 Area approved under PD within Application 2019/2203/P
 Hatch indicates new first floor addition
 Site Boundary

B	21.05.2019	Planning Application re-submitted.	MLR	DA
A	24.04.2019	Permitted Development Application	MLR	DA
--	21.01.2019	first issue	MLR	DA



scale bar - do not scale from this drawing - scale bar is included as a requirement of statutory approvals only
 note to contractor - use only figured dimensions for construction

1.1250_A3 	<h1 style="margin: 0;">DISTRICT</h1> <p style="font-size: small; margin: 0;"> Unit 3 . 1 Oakhurst Grove . London . SE22 9AH +44 (0)7525 179 525 studio@districtarchitects.co.uk www.districtarchitects.co.uk this drawing is copyright . </p>	<p>Planning</p> <p>Existing Block Plan</p> <p>project 50 Lady Margaret Road Kentish Town . London . NW5 2NR</p> <p>client Mr. and Mrs. Haugen</p>	<p>job no. 033. (3) stage .0 type / place .002 series / number B revision</p>
---------------	---	--	--