

- LEGEND**
01. Existing brickwork wall rebuilt due to movement/cracking to match the existing.
02. Frameless double glazed roof and wall panels.
03. Timber painted double glazed sliding doors.
04. Existing opening width increased by 600mm (300mm either side).
05. Stone paving.

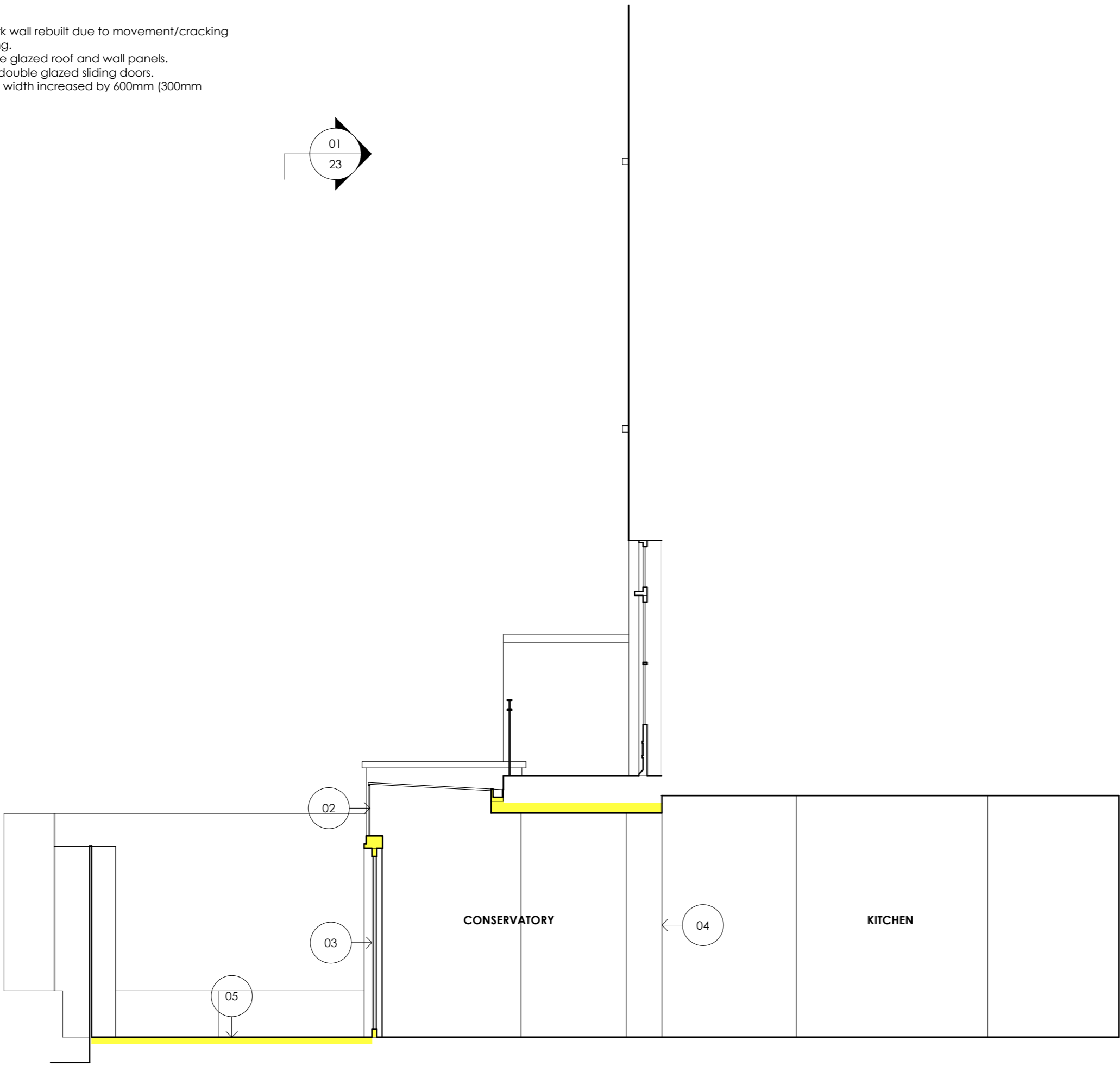

01
35

PROPOSED SECTION

1:50@A3

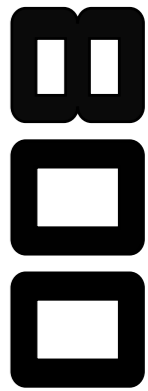

Client
Mr & Mrs Jacobson

Project
29 Langland Gardens
London
NW3 6QE

Drawing
Proposed Section

Dwg No.	Rev
229-35	-

Scale	Date
1:50@A3	Mar 2019

800 Group
Cranborne Road
Potters Bar
Hertsfordshire
EN6 3JN

Telephone
01707 663 075

Facsimile
01707 662 076