

Schueco- External Doors
 Schueco- AWS 75 SI BS Window system refer to KSR PL-4-XXX and 8-XXX series for details, sizes and locations. Powder Coated Metal to a bronze finish

Door with blanking panel and insulated wall lining to internal face

APT 13-02
 Kitchen

Lateral Design threshold drain
 Threshold drain Aqaulevel CT1
 Metsec upstand with insulation
 Visqueen
 To be installed on site to manufacturers details.

Level EEEEE Third Floor
 12343023430

In situ reinforced concrete floor 250 mm
 Minimum density 2400 Kg/cm³

ExW6 Insulated Render on MetSec (Recessed balconies)
 - Sto Render 20mm
 - Sto EPS K90 100 mm
 - Sheathing board (non combustible) 12 mm
 - Thermal Insulation mineral wool between studs 100 mm
 - 100 metal C Studs to S.E. Details 100 mm (Metsec or similar)
 - Vapour Control Layer
 - LW3 lining type

12 mm plywood
 Insulation
EPDM
 To be attached to the window in the factory, ready for installation on site. To manufacturers details.

APT 11-02
 Kitchen

Schueco- External Doors
 Schueco- AWS 75 SI BS Window system refer to KSR PL-4-XXX and 8-XXX series for details, sizes and locations. Powder Coated Metal to a bronze finish

Door with blanking panel and insulated wall lining to internal face

8

XD 03 06
 Type 01B

APT 13- E01
 Terrace 1

F-13 Balcony

- Stone paving slabs 20mm (laid flat, open joints)
 - Paver supports - Bauder DPH min 17 mm (39 mm shown)
 - Bauder Top Layer / Cap Sheet 15 mm
 - Bauder Underlayment
 - Screed (laid to falls) min 6 mm (15 mm shown)

In situ reinforced concrete floor 250 mm

In situ reinforced concrete floor 150 mm

APT 11- E01
 Balcony

Powder coated MS railings

30 x 10mm balusters

50 x 15mm supports

30 x 10mm bottom rail

Cementitious render

Cast Stone Coping / Fascial / Terrace openings

General notes:
 This drawing is copyright of KSR architects. This drawing must be read in conjunction with the Designer's Risk Assessment, specification and all other relevant documentation and drawings. KSR architects accept no liability for any expense, loss or damage of whatsoever nature and however arising from any variation made to this drawing or in the execution of the work to which it relates which has not been referred to them and their approval obtained.
 Do not scale from this drawing or the digital data, only figured dimensions are to be used. For Planning refer to linear scale. Check all dimensions on site prior to carrying out any works - advise of any discrepancy

Notes/Legends

C	Railing and coping details revised	30 Apr 19	BS
B	Planning conditions	28 Feb 19	SAS
A	Final Planning Details Sign-off	09 Jan 19	SE
Rsk	Discretion	Date	Check

© KSR architects
 Stamp:

Planning

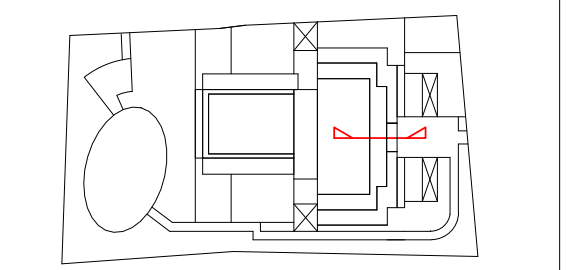

KSRARCHITECTS
 KSR Architects LLP
 14 Greenland Street
 London, NW1 0ND
 Email: info@ksrarchitects.com
 Tel: +44 (0)20 7692 5000
 Website: www.ksrarchitects.com

Project:
29 NEW END

Title:
Section C Details 3

Date:	12/09/18	Drawn By:	Author	Checked:	Check
Scale:	1:5 @ A1	1:50 @ A1	Status:	Planning	

Project Ref:	Drawing No:	Revision:
NEN	NEN - PL-4-132.1	C

DIAGRAM SECTION C - SOUTH
 1 : 50

3F BALCONY DETAIL 1
 1 : 5

