

LOFT VOID ROCKWOOL FIRE BARRIER ELEVATION
SCALE 1:10

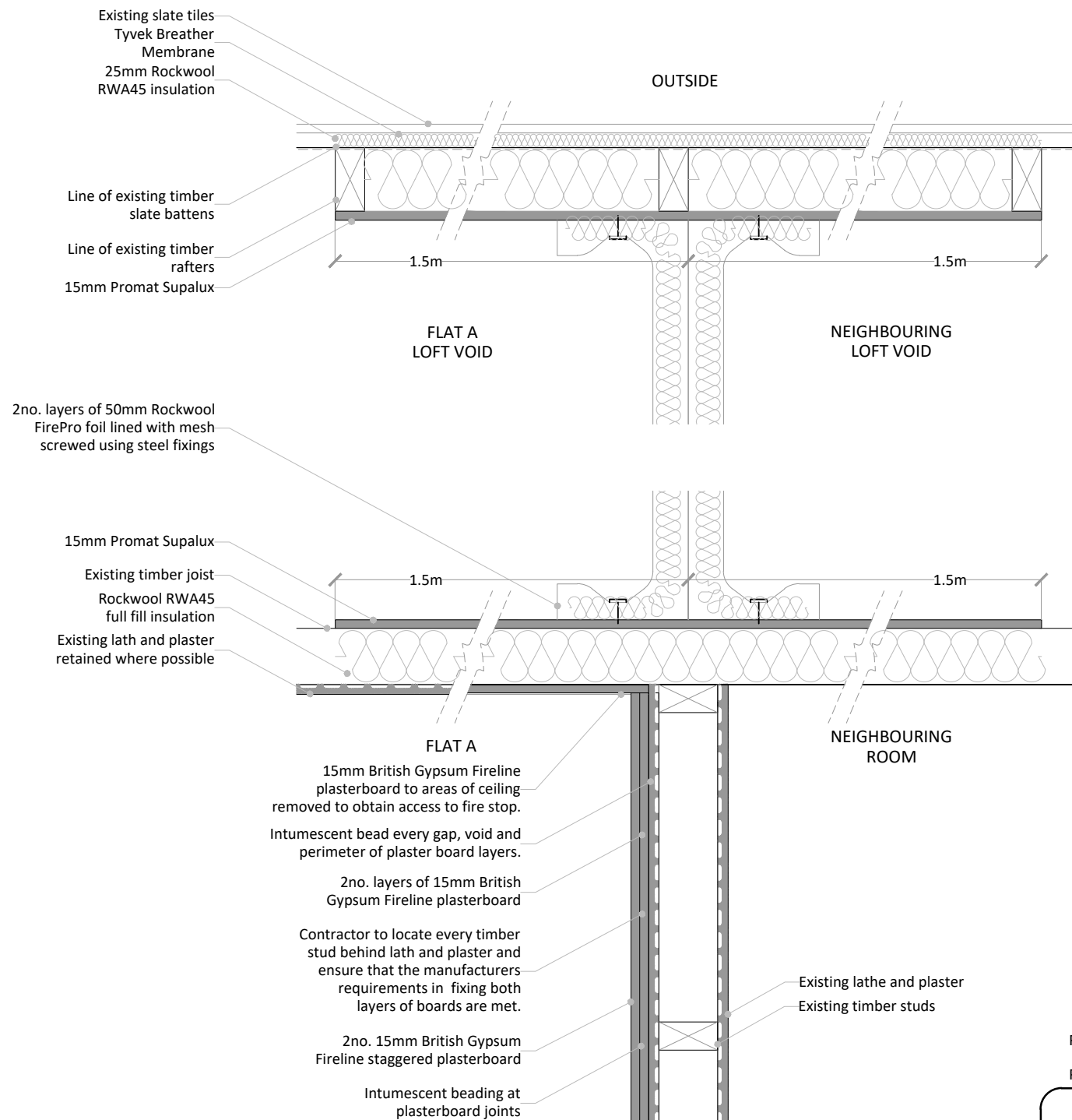

LOFT VOID ROCKWOOL FIRE BARRIER SECTION
SCALE 1:10

All dimensions to be checked on site.
Do not scale from this drawing
Drawings to be read in conjunction
with other consultant's information, all
drawings and specifications

Structure:

All structural elements to be confirmed by
Engineer.

NOTE:

Roof Void

Compartment walls in roof space to
be 1hr fire resistant.

Refer to Rockwool Fire Barrier
systems literature for fire barrier
installation.

Refer to Promat Supalux literature
for installation.

Party Walls Below Ceiling
Lath and plaster linings are
considered not to achieve any fire
rating. The requirement for retaining
the lath and plaster provides the
only option available to increase the
fire performance by using
plasterboard over boarding.

Party walls below the ceiling can no
longer be specified to achieve 1hr
fire resistance. Any improvements of
fire performance can only be
achieved from Flat A.

P1	Works to compartment walls to meet Historic England requirements	08.04.2019
P0	Planning	25.02.2019

SITE: **1 New Square, WC2A 3SA**

PROJECT:	Refurbishment		
COUNCIL:	London Borough of Camden		
INTERIM:	COMPARTMENT WALL TIMBER PARTITION DETAIL		
SCALE	1:10@A3	STATUS:	PLANNING
DRAWN BY:	H	DRAWING DATE:	OCT 18

L24 - 850

P1