

NOTE:
No dimensions are to be scaled from this drawing.
All contractors must visit the site and be responsible
for taking and checking all dimensions relative to
this work.
The designer must be notified of any discrepancies
in writing.

- Rad RADIATOR
- + SPOT LEVEL
- Ce FINISHED FLOOR - CEILING HEIGHT
(f) INDICATES FALSE CEILING
- f-c FINISHED FLOOR - CILL HEIGHT
- c-h CILL - HEAD HEIGHT
- BH FINISHED FLOOR - BEAM UNDERSIDE HEIGHT
- f-cr/c-cr FLOOR or CILL - ARCH CROWN HEIGHT
- f-sp/c-sp FLOOR or CILL - ARCH SPRINGER HEIGHT
- DH FINISHED FLOOR - DOOR HEAD HEIGHT
- CF (G, S, T) CEILING FALL (G: GLASS, S: SLATE, T: TILE)

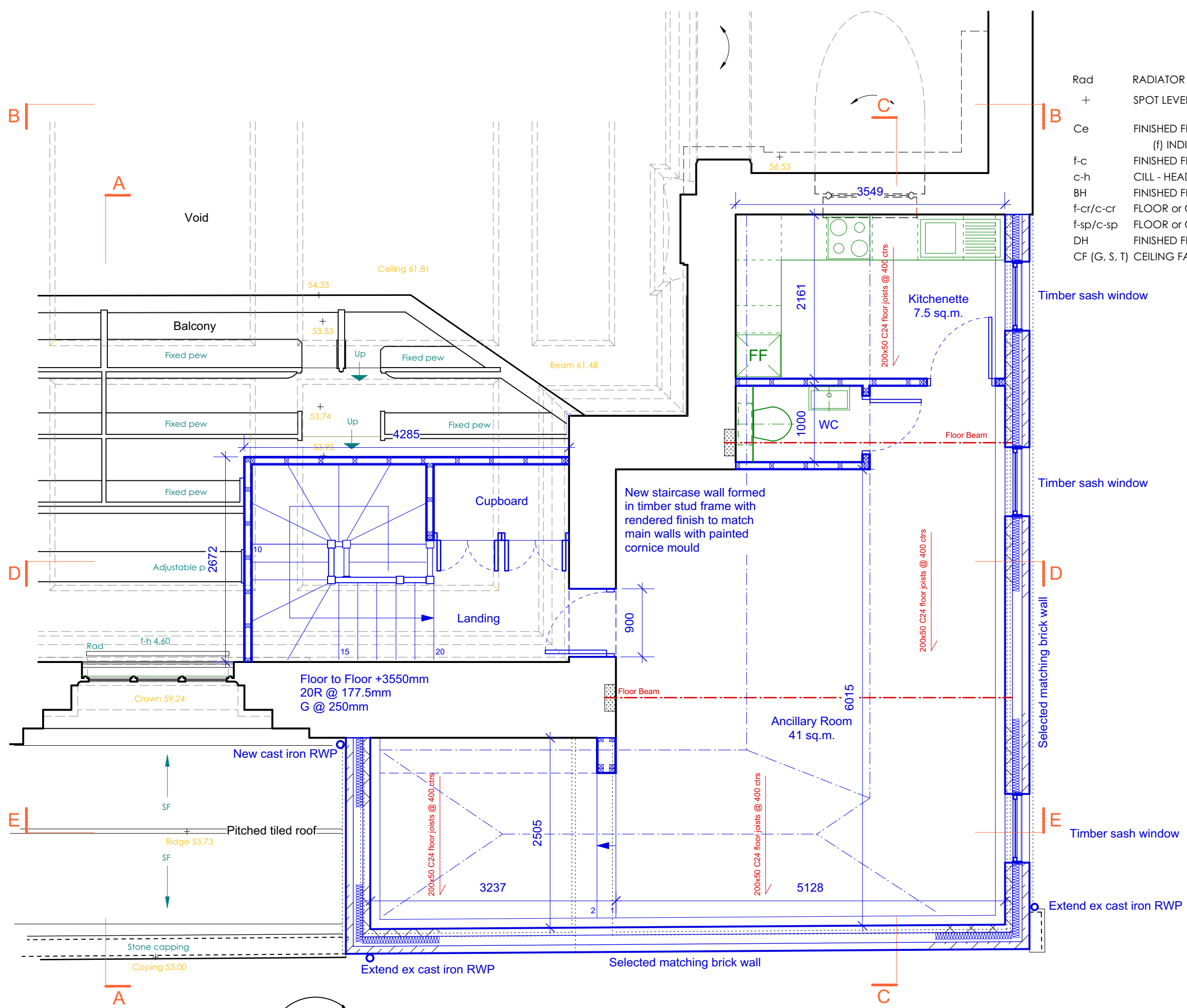

PROPOSED FIRST FLOOR PLAN 1:50

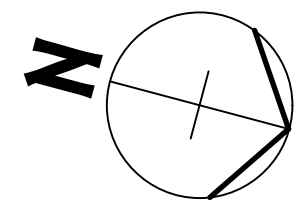

REVISIONS:

at design
10 waterloo cottages, 10th
richmond upon thames, tw9 2ba
m. 07980 290 860
en. at@atdesignarch.com

CLIENT:
ANTIOCHIAN ORTHODOX
SOCIETY OF
BRITAIN

PROJECT:
ST GEORGES CATHEDRAL
LONDON
NW1 4BG

DRWG TITLE:
PROPOSED
FIRST FLOOR
LOCALISED PLAN

DRWN BY:	SCALE:	
	1:50 @ A3	
DATE:	DRWG No.:	REV.
11/04/19	PA/204	