

Do not scale from this drawing.
Contractors must confirm site dimensions before starting work on shop drawings.

| Rev. | Description | Date | Auth. |
|------|--------------------|------------|-------|
| C1 | CONSTRUCTION ISSUE | 22/09/2017 | GSK |

Door frame cill section to be incorporated into curtain wall channel which is to remain consistent about the perimeter of the light well glazing. Proprietary unit by specialist subcontractor.

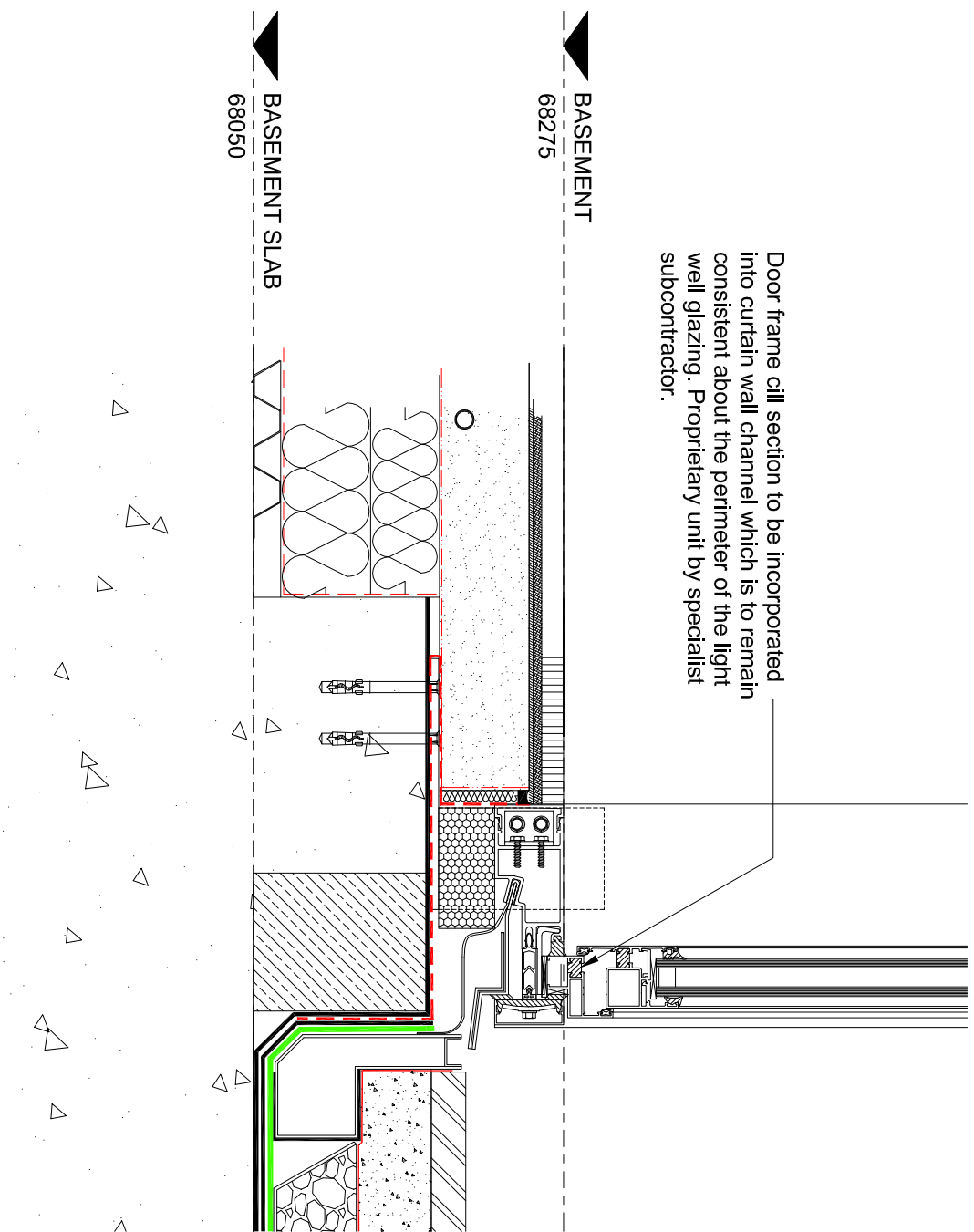

NOTE
FOR MAIN NOTES & DIMENSIONS REFER TO
DRAWING 1601-TFP-LG-B2-DR-A-6006

| | |
|-------------------|-------------|
| Purpose of Issue: | TFP Job No. |
| CONSTRUCTION | 4948 |

VABEL LONDON
LYNDHURST GARDENS
LONDON NW3

**BASEMENT DETAIL
LIGHTWELL GLAZING CILL
WITH DOOR OPENING**

| | | | |
|--------------------------|-----------------------|-------------|-------|
| Drawing Number: | Scale: | Sheet: | Rev.: |
| 1601-TFP-LG-B2-DR-A-6007 | 1/5 | S4 | C1 |
| Drawn: MRC/GSK | Approved: [Signature] | Date: | |
| | | 03 FEB 2017 | |

The Tooley & Foster Partnership
ARCHITECTS • DESIGNERS

Warwick House, 118 Parkerson Road
London, W14 9AB
Tel: 020 8944 9771
Fax: 020 8968 1779
e-mail: architects@tooleyfoster.com
www.tooleyfoster.com

© ALL RIGHTS RESERVED

