





USE KEY

-  **A3 (restaurant)**  
AREA: 240m<sup>2</sup>
-  **B1c (light industrial)**  
AREA: 0m<sup>2</sup>
-  **B1c (jewellery)**  
AREA: 300m<sup>2</sup>
-  **B1 (business)**  
AREA: 261m<sup>2</sup>

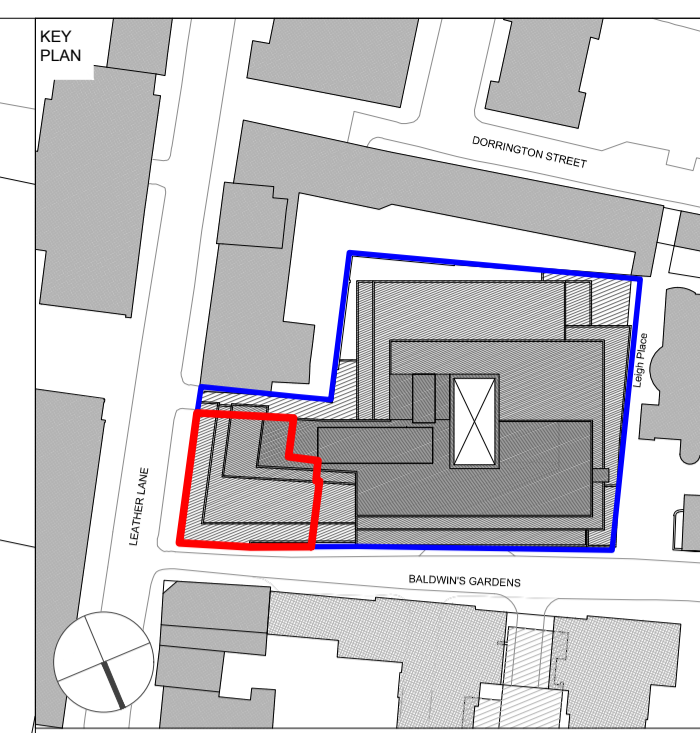
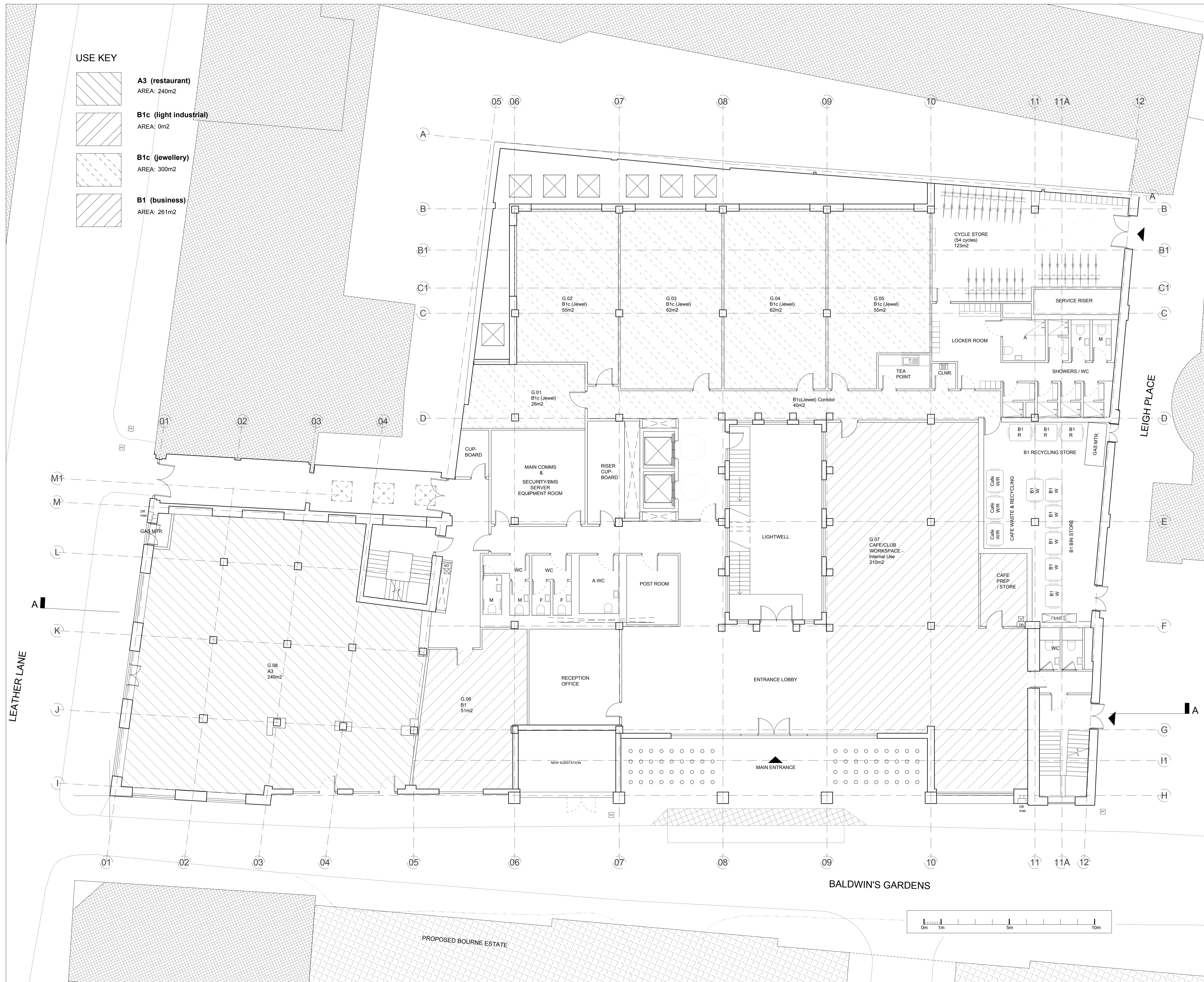

CLIENT  
**WORKSPACE**  
 Chester House  
 Kennington Park  
 Business Centre  
 1-3 Brixton Road  
 London SW9 6DE  
 Phone: 0845 564 1216  
 Fax: 020 7247 0157

DO NOT SCALE FROM THIS DRAWING.  
 THIS DRAWING IS BASED ON DIMENSIONAL SURVEY INFORMATION PROVIDED BY OTHERS. THE ARCHITECT CANNOT ACCEPT RESPONSIBILITY FOR THE ACCURACY OF THIS SURVEY INFORMATION.  
 ALL DIMENSIONS ARE SHOWN IN METRIC.  
 THIS DRAWING REMAINS THE COPYRIGHT OF KARAKUSEVIC CARSON ARCHITECTS.

NOTES  
 Key  
 - Application Boundary  
 - Ownership Boundary

04	Key plan updated	08.05.2019
03	Use classes updated	24.04.2019
02	Hatching & use key amended	02.02.2017
01	Hatching amended, use key amended, scale bar added	03.05.2016
Rev	Reason for issue	Date

**karakusevic carson architects**  
 The Gymnasium  
 56 Kingsway Place, Sans Walk  
 London EC1R 0LU  
 Tel: +44 207 566 6300  
 Fax: +44 207 566 7381  
 Email: mail@karakusevic-carson.com

PROJECT  
**Hatton Square**  
 London Borough of Camden  
 London

TITLE  
**Existing  
 Ground Floor Plan**

DRAWING NUMBER  
**203\_A\_P\_110\_01**

REVISION  
**04**

STATUS  
**PLANNING**

DATE	DRAWN BY	SCALE
14/03/2016	ML	1/100 @ A1
PLOT DATE	CHECKED BY	PROJECT NUMBER
08/05/2019	KS	203

