

**Front Elevation**  
Scale 1:50

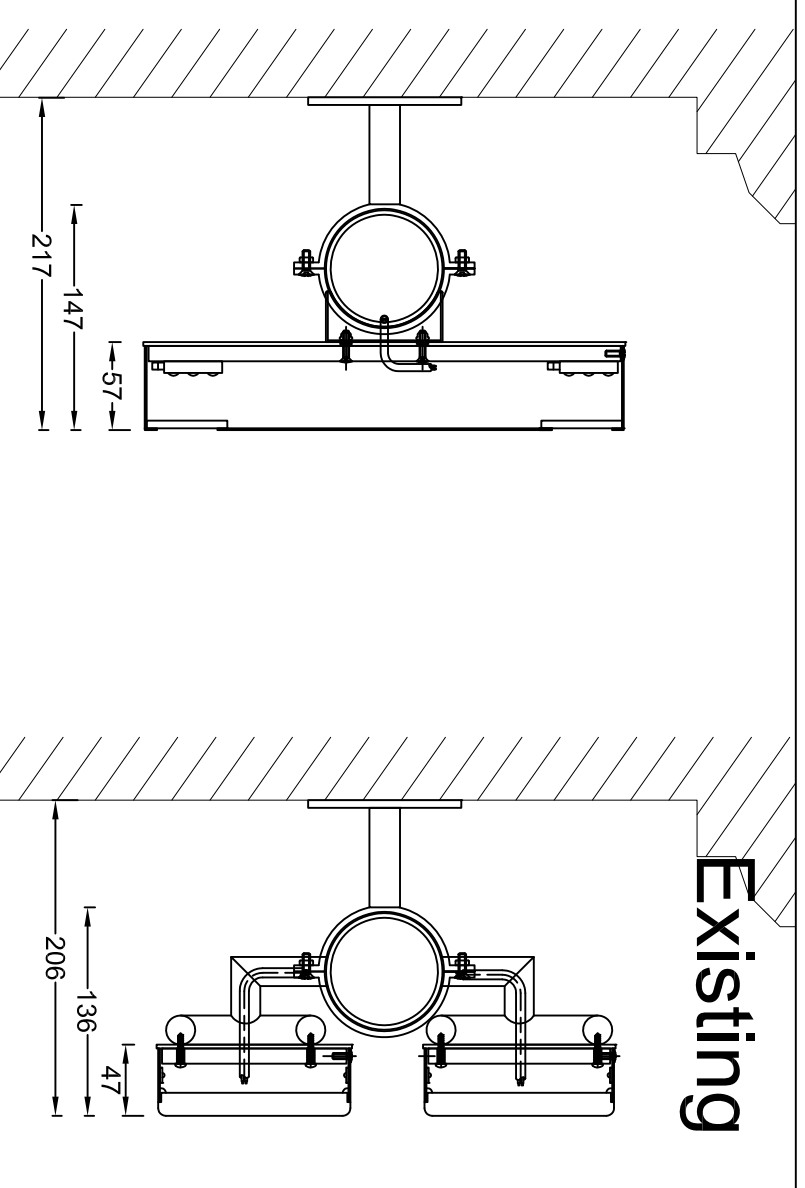

Section A-A through the text  
Scale 1:5

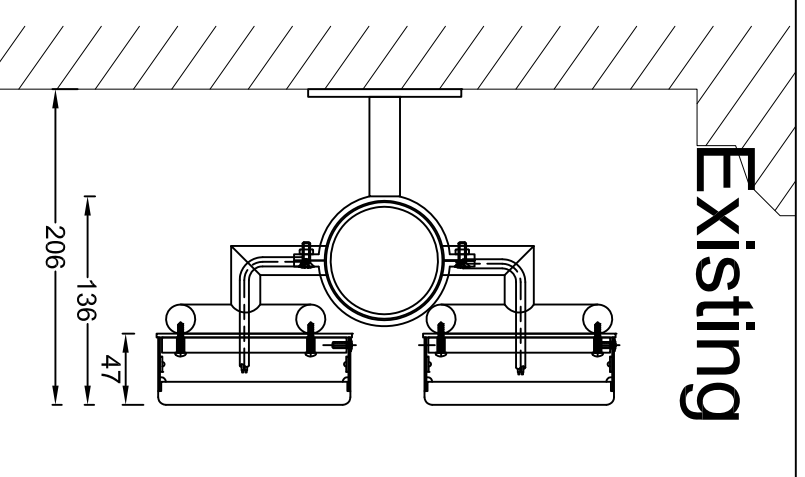

Section B-B through the text  
Scale 1:5

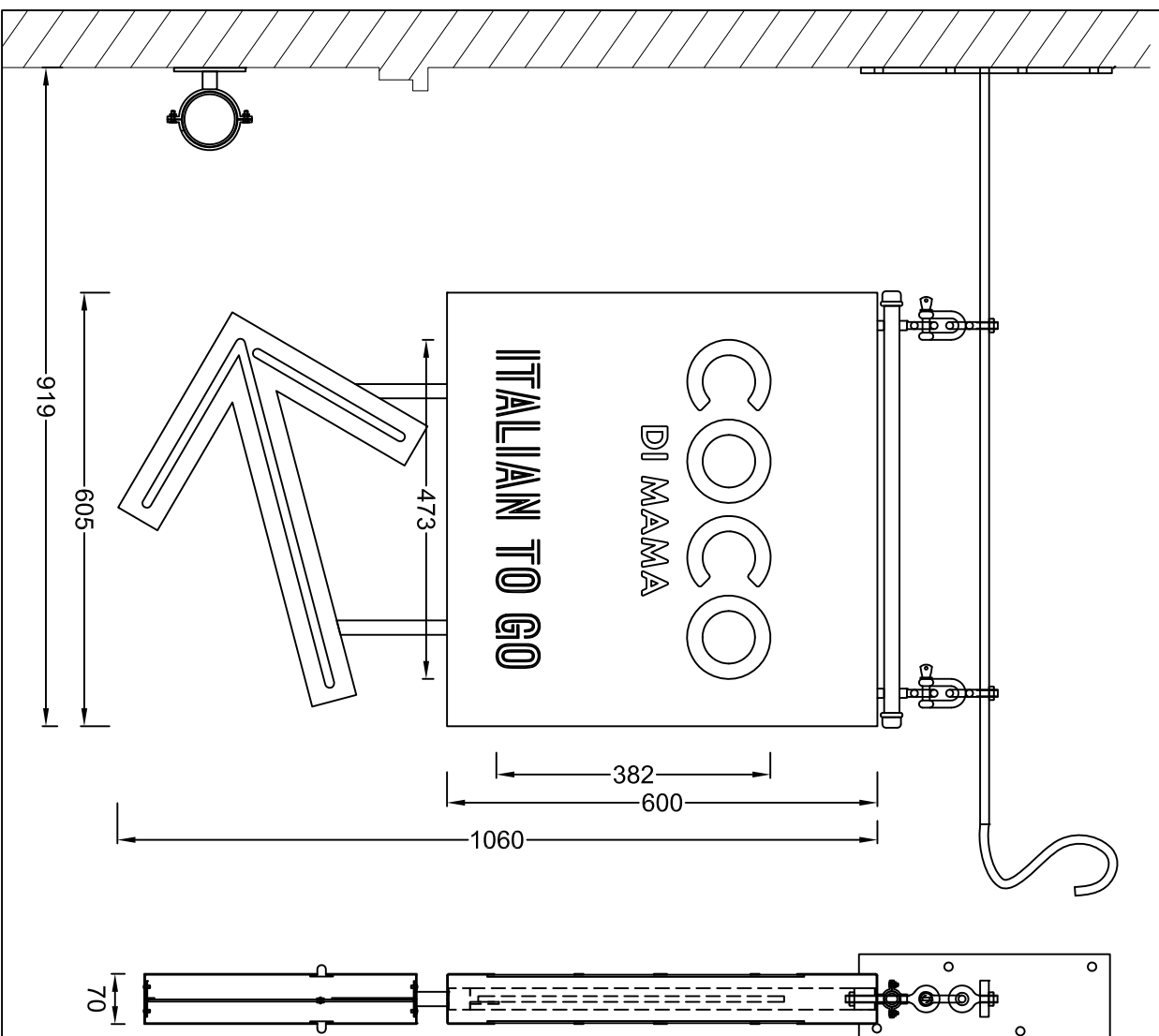

Projected sign - 1 off  
Scale 1:10

Hanging sign has a steel inner frame covered by outer panels which are folded and welded 1.2mm dark patina zinc. Fret cut text in the panel faces is fitted with acrylic. The 'COCO' letters are red 440 acrylic and the 'ITALIAN TO GO' letters are opal acrylic. Internally illuminated by low energy warm white LEDs. Sign hangs from a black steel projecting arm.

Additional built-up arrow fixes to the underside of the square sign with 20Ø CHS drops. Faces and returns of the arrow are 1.2mm dark patina zinc and fret cut lines in the centre of the faces are fitted with opal acrylic which is internally illuminated by low energy warm white LEDs.

Built-up 'COCO' letters have 1.2mm descaled stainless steel face rims and returns which are finished red Dulux 10YR 13/437. Rims hold 5mm opal acrylic faces which have red vinyl on the face which have lines cut out to reveal the opal acrylic. Fitted with low energy warm white LEDs for face illumination of the exposed lines.

Built-up 'DI MAMA' letters text to have 1.2mm descaled stainless steel returns which are finished red Dulux 10YR 13/437. Bullnosed 15mm opal acrylic faces have stained glass red paint. Fitted with low energy red LEDs for face illumination.

Built-up 'ITALIAN TO GO' letters have rebated 5mm opal acrylic faces which have 1.2mm dark patina zinc inlaid flush into the face. 1.2mm dark patina zinc soldered returns. Fitted with low energy warm white LEDs for face illumination of the exposed opal acrylic.

All the letters are fixed to a 76Ø CHS black steel horizontal rail which has decorative cast joiners, round end caps & munsen ring pipe clamps.

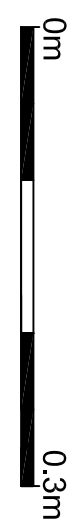

Section C-C through the text  
Scale 1:5

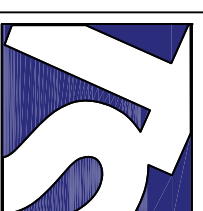

**Technical Signs**  
Floor 1 - Unit 3  
Hille Business Centre  
132 St Albans Road  
Watford, Herts, WD24 4AE  
Tel: 01923 811999  
Fax: 01923 811998  
E-mail: info@technicalsigns.co.uk

Client: Coco Di Mama	Address/Job details 9-11 Tottenham St Fitzrovia W1T 2AQ
Job No: -	Existing Signage
Drawn by: DN	Date: 27/03/19
Scale: As specified (A3)	Drawing No: 596080-1
	Rev: