

Ground Floor - Proposed Joinery Layout

PROPOSED JOINERY - KEY	
Existing and replacement joinery details in accordance with drawing no's 26849-13-A, 26849-13-B and 26849-13-C.	
<div></div>	Existing joinery retained
<div></div>	Replacement joinery
A1	Architrave Detail 1
A2	Architrave Detail 2
A3	Architrave Detail 3
B1	Balustrade Detail 1
C1	Overstair Cupboard Detail 1
D1	Door - Detail 1
D2	Door - Detail 2
DD1	Dado Rail Detail 1
PD2	Door - Detail 2
PD2	Door - Detail 2
PD3	Door - Detail 3
PD4	Door - Detail 4
P1	Picture Rail Detail 1
P2	Picture Rail Detail 2
S1	Skirting Board Detail 1
S2	Skirting Board Detail 2
N/A	Not Applicable - No detailed joinery

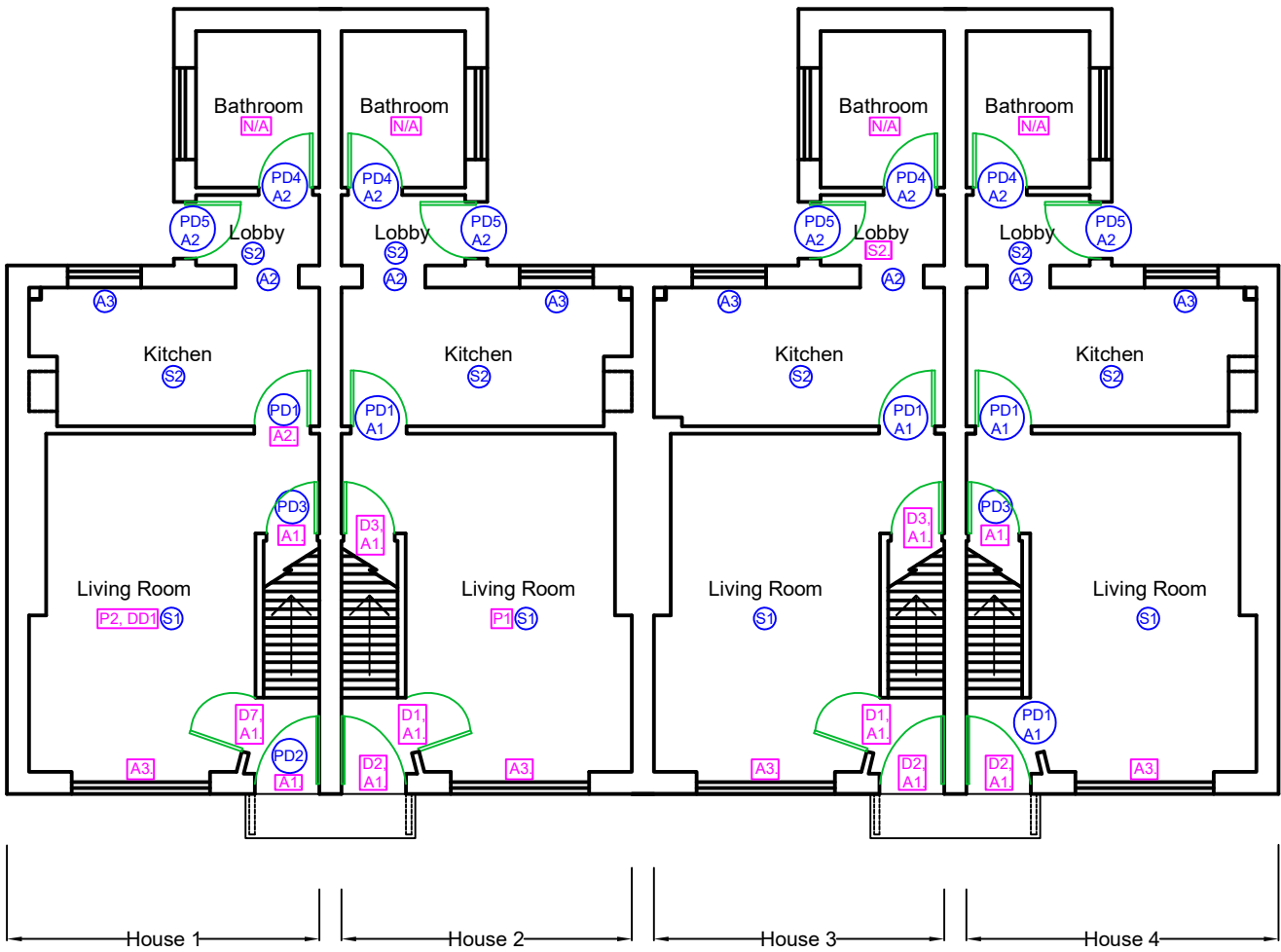

FRONT

First Floor - Proposed Joinery Layout

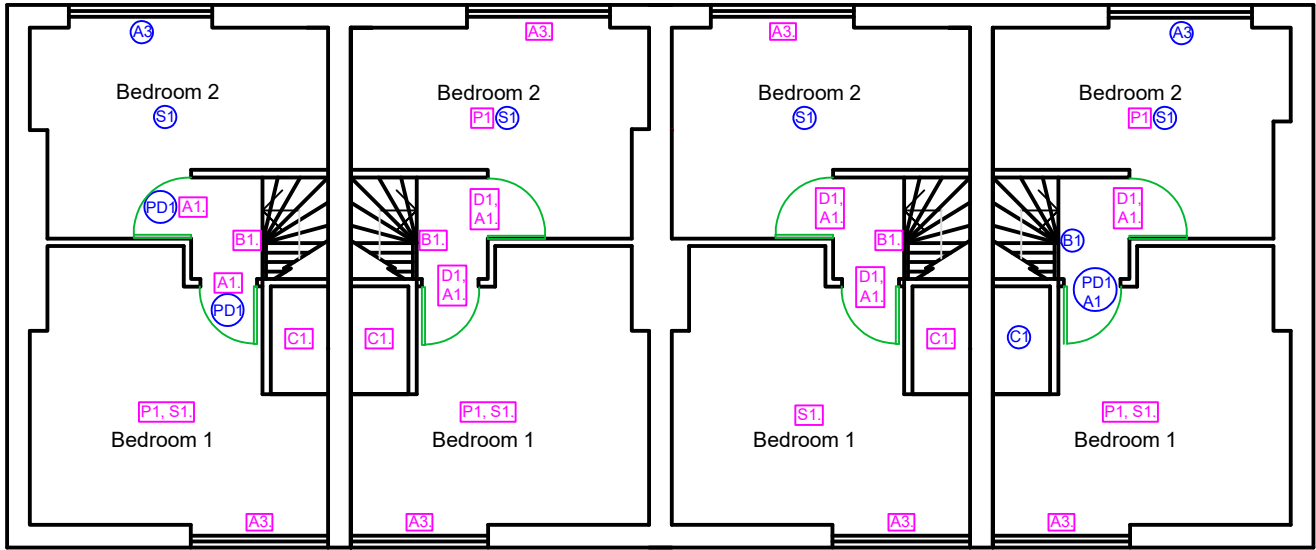

FRONT

Rev.

Date

Details

All dimensions and levels are to be checked on site by the Contractor and any discrepancies are to be referred to the Surveyors before any works are put in hand.

Client

Site Address

Project

Drawing Title

London Fire Commissioner

West Hampstead Fire Station
325 West End Lane
West Hampstead, NW6

Firefighter's Cottages

Replacement Interior Joinery Layout

Job no.

26849

Drawn by

CD

Printed

10/04/19

Scale

1:100

Print size

A3

Cad Ref.

droncity@dronwright.co.uk

DRON & WRIGHT

PROPERTY CONSULTANTS

18 St Swithins Lane

London EC4N 8AD

T: 020 7891 2345

Drawing Sheet no.

26849-13-E