

Window Section A-A

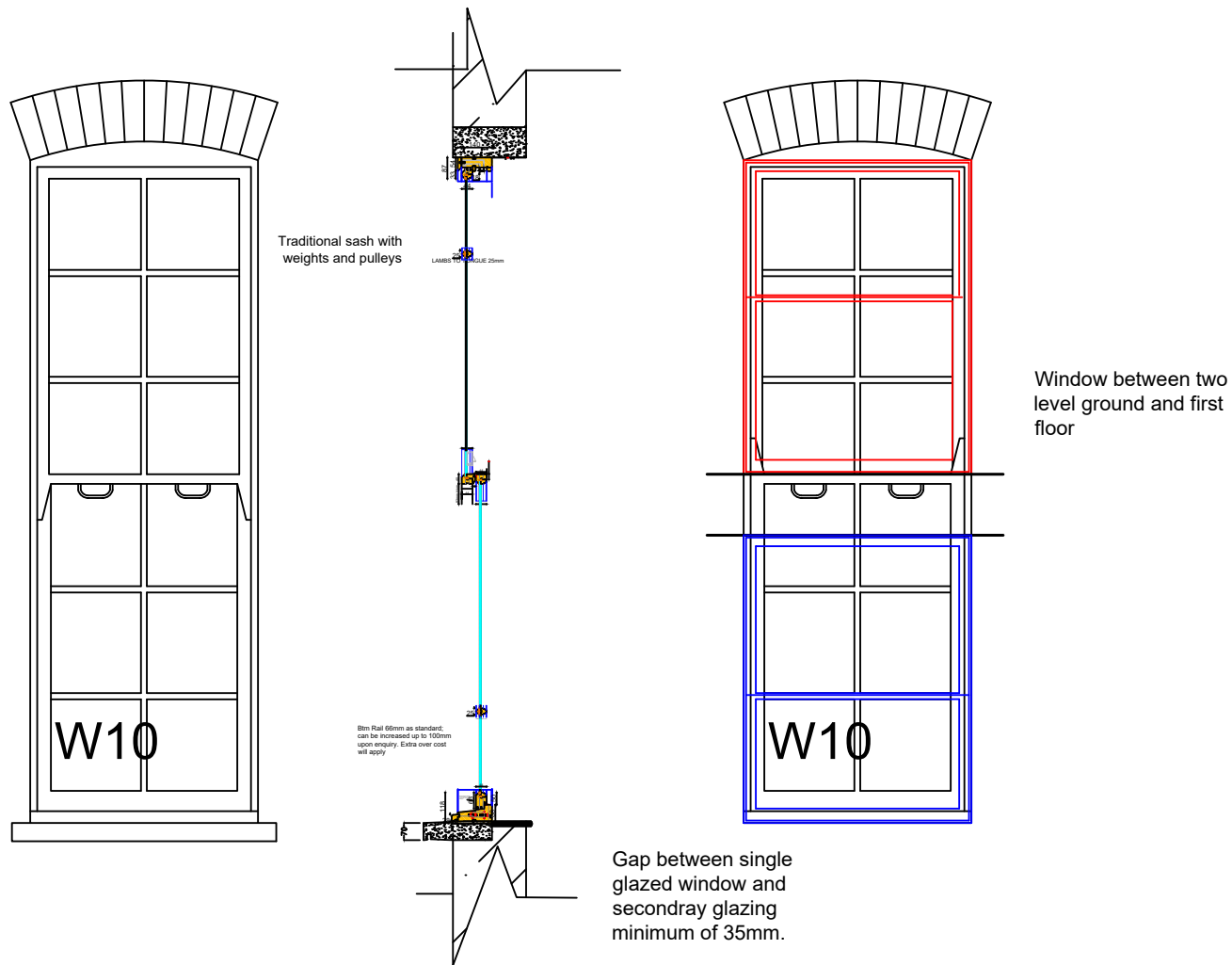

Existing single glazed timber window to be exactly same to keep the heritage look of the building and new two secondary glazing to be fitted for thermal proposes to stop condensation and noises

Notes:

1:20

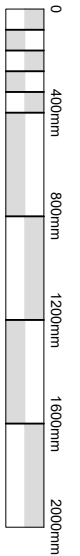

**walke**  
CONSTRUCTION CONSULTANT

EMPLOYER'S AGENTS & PROJECT MANAGE

Unit A Court House 11a High Street Barr

LONDON EN5 5UJ

TEL: 020 8446 5537

E-MAIL: [INFO@WALKERMANAGEMENT.CO.UK](mailto:INFO@WALKERMANAGEMENT.CO.UK)

TITLE  
Window section with Secondary glazing

PROJECT  
27 Randolph Street

CLIENT  
CIRCLE 33 HOUSING / KIER

SCALE: AS IDENTIFIED  
CAD FILE: -  
DATE: 18.04.18  
DRAWN BY: WM  
CHECKED:

PROJECT NO.  
3851

DRAWING NO.  
3851/WM/11

REVISION  
R-2