

**Traditional Open In Flush Entrance Door  
Sidelight Head**

DIMENSIONS	PLOT SIZE	SCALE	DATE	REV	DWG NO.
MM	A4	1:1	08.03.2011	A	<b>2303</b>
Please consider the environment before printing					

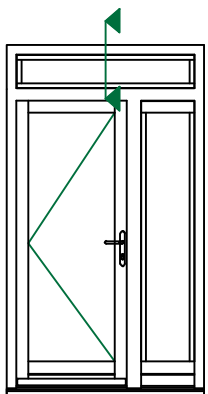
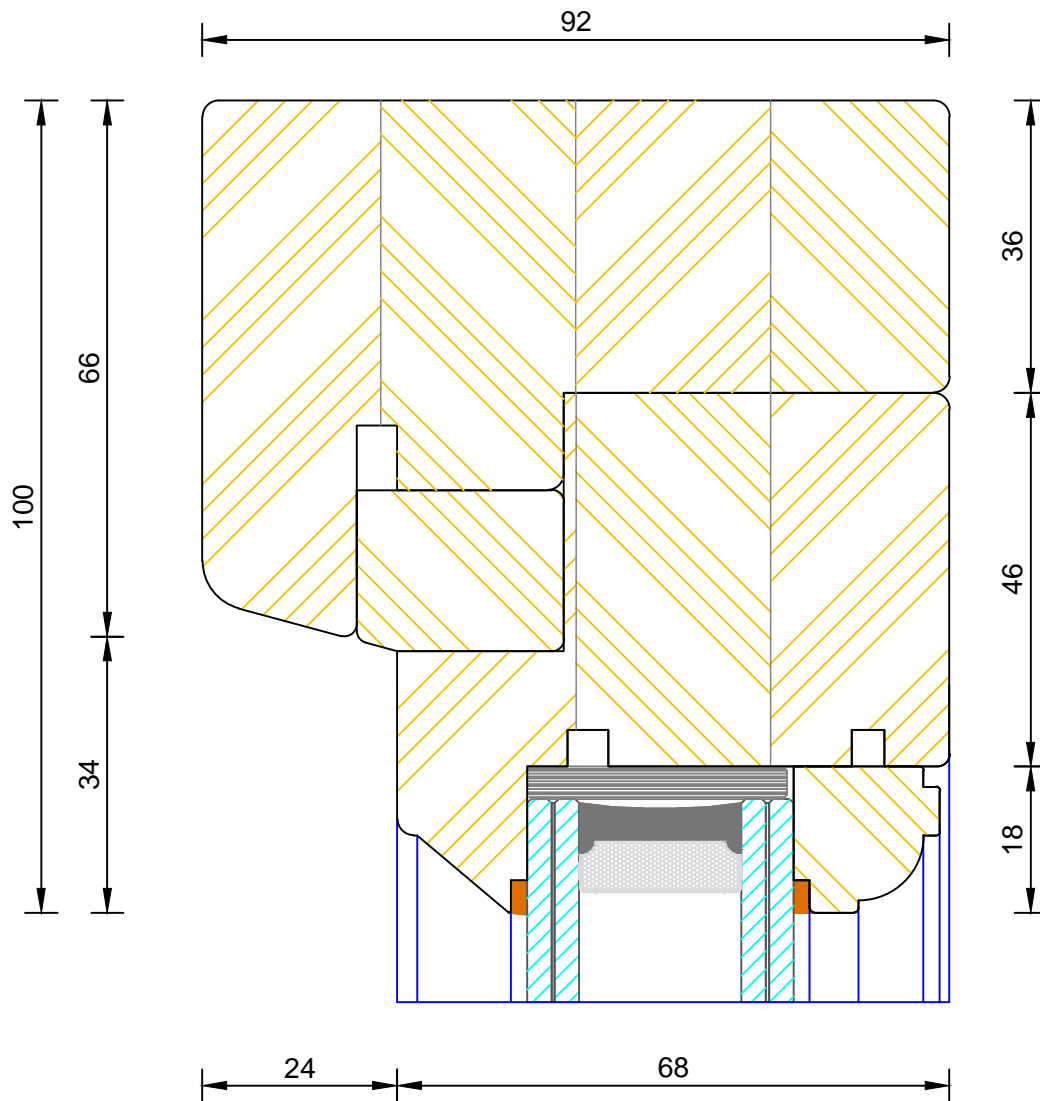

**Traditional Open In Flush Entrance Door  
Fanlight Head**

DIMENSIONS	PLOT SIZE	SCALE	DATE	REV	DWG NO.
MM	A4	1:1	08.03.2011	A	<b>2304</b>
Please consider the environment before printing					

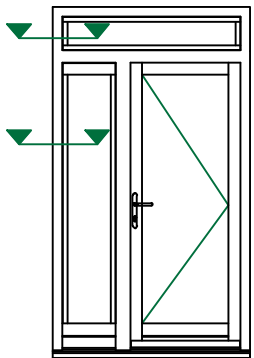
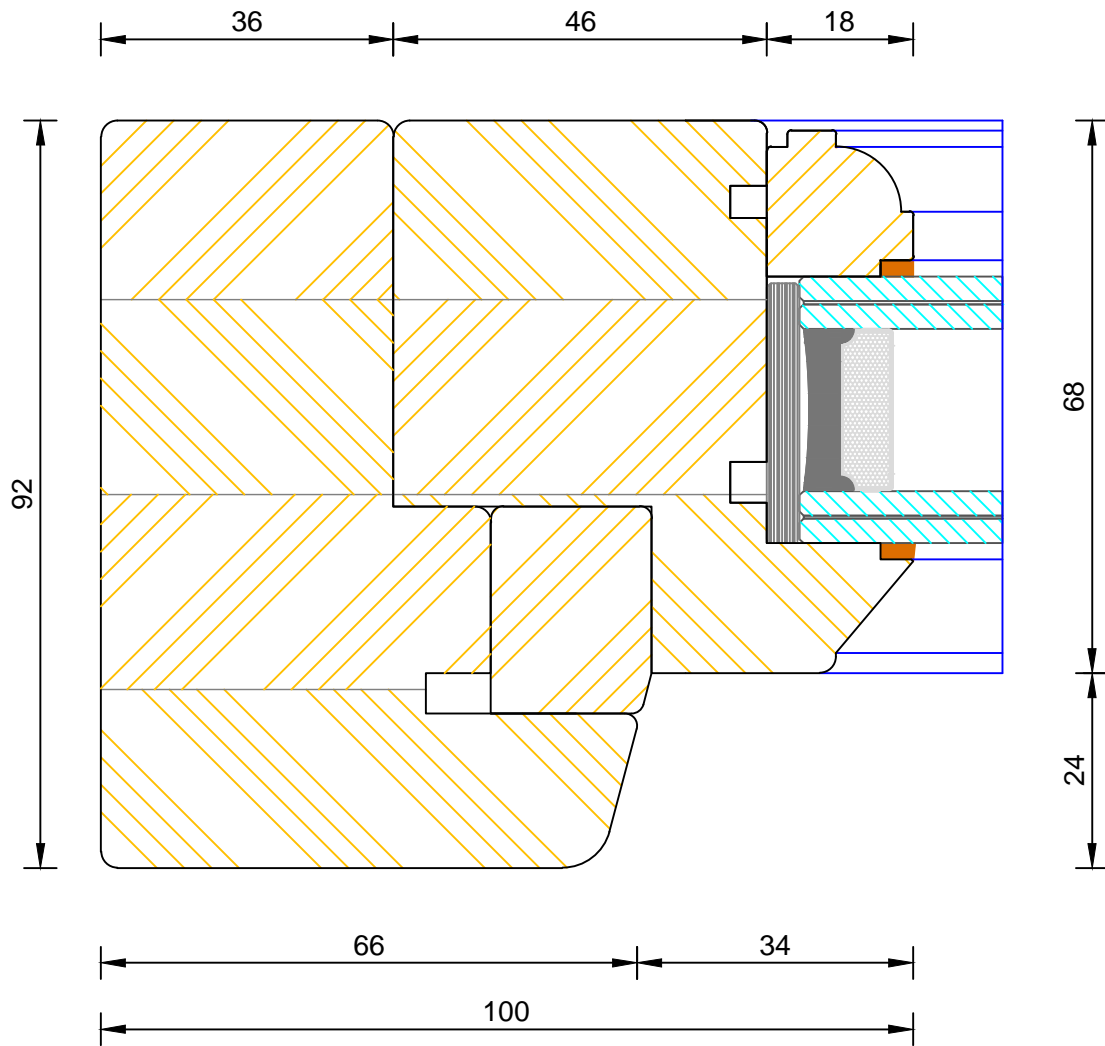

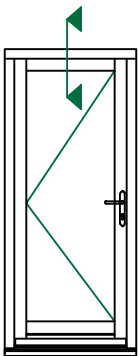
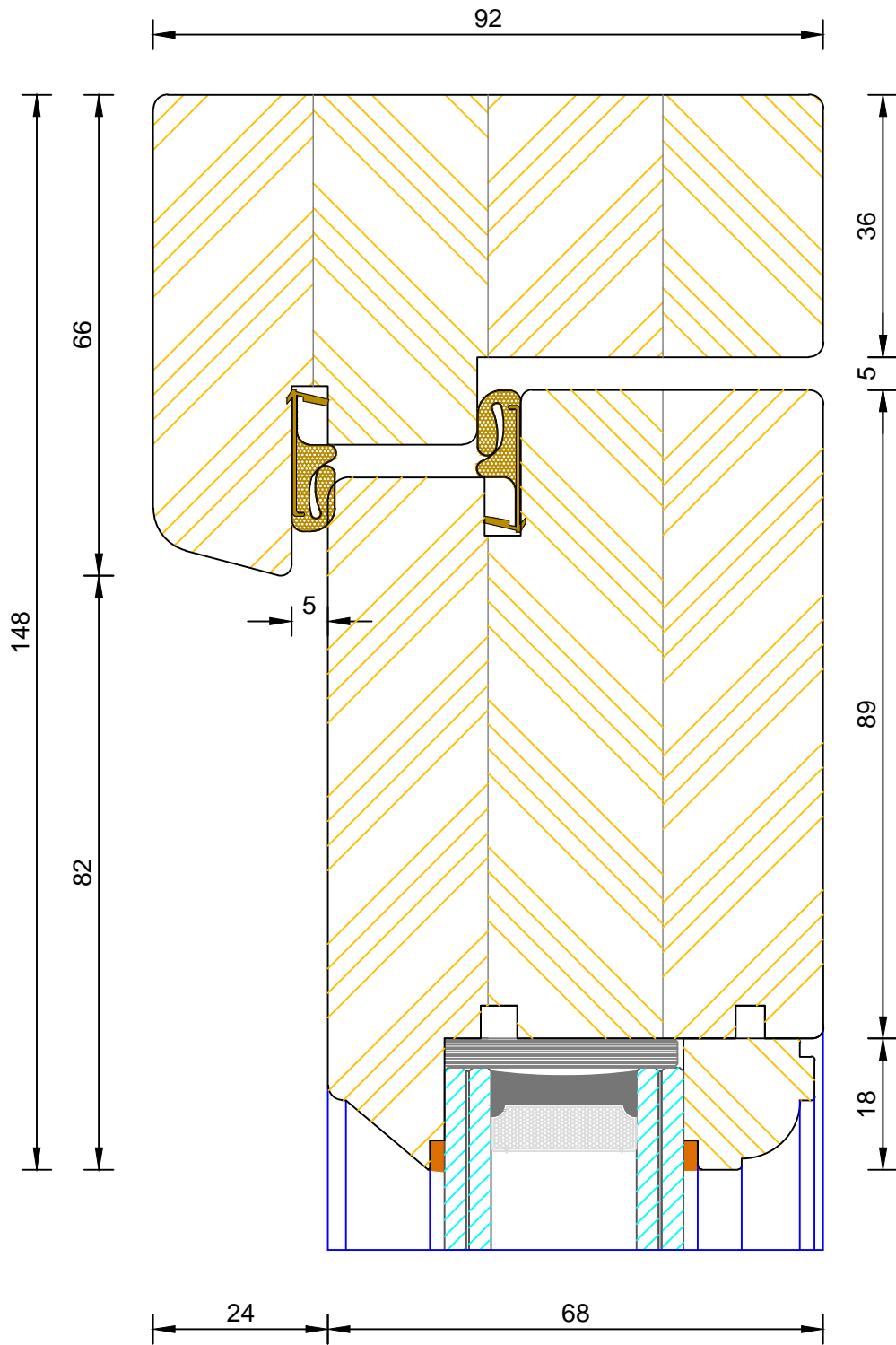

**Traditional Open In Flush Entrance Door  
Frame & Leaf Head**

DIMENSIONS	PLOT SIZE	SCALE	DATE	REV	DWG NO.
MM	A4	1:1	08.03.2011	A	<b>2309</b>

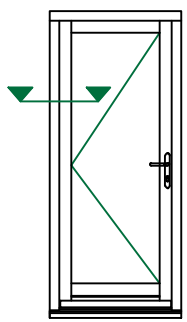
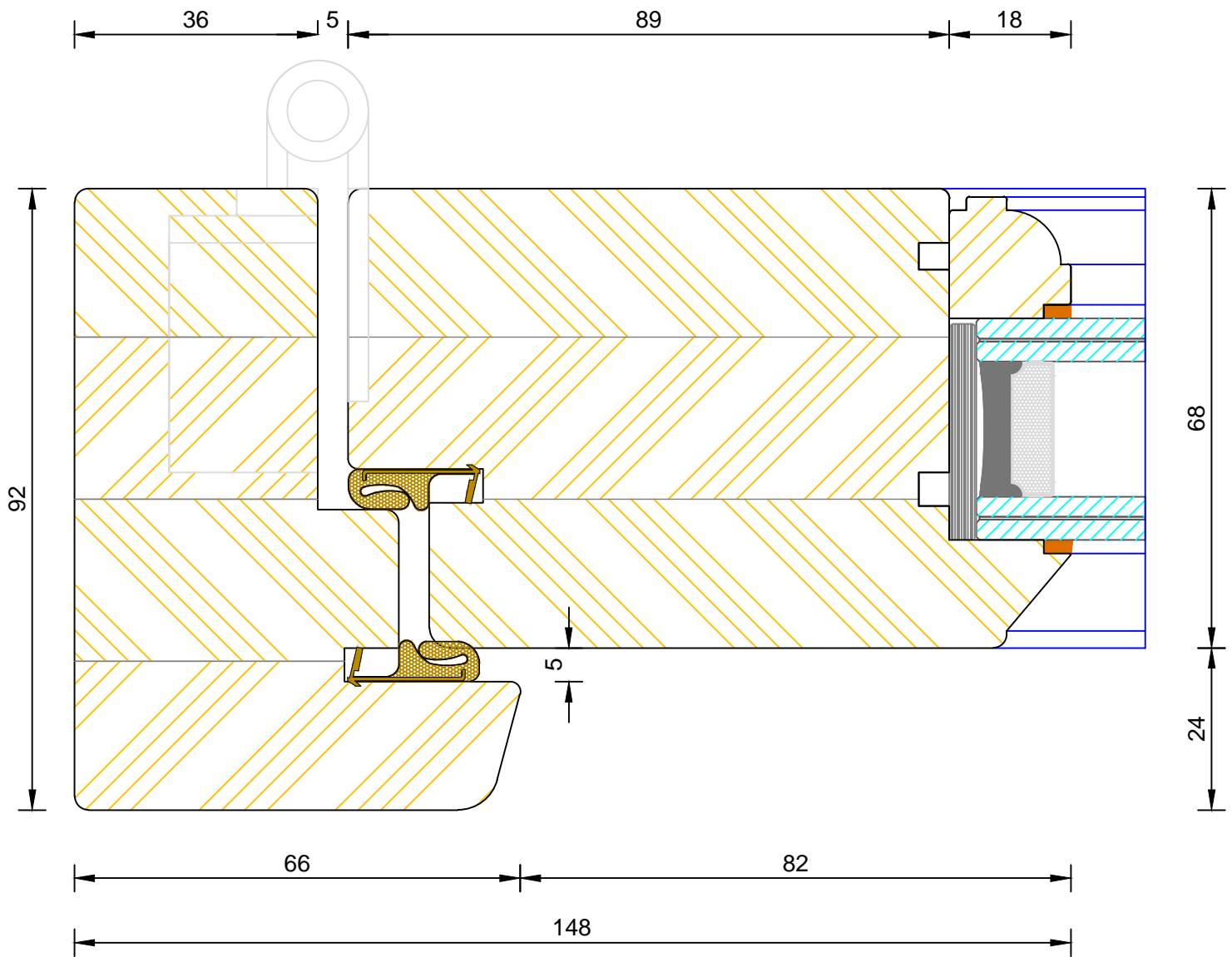

**Traditional Open In Flush Entrance Door  
Frame & Leaf Jamb (Hinge Side)**

DIMENSIONS	PLOT SIZE	SCALE	DATE	REV	DWG NO.
MM	A4	1:1	08.03.2011	A	<b>2310</b>

Please consider the environment before printing

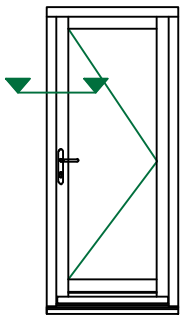
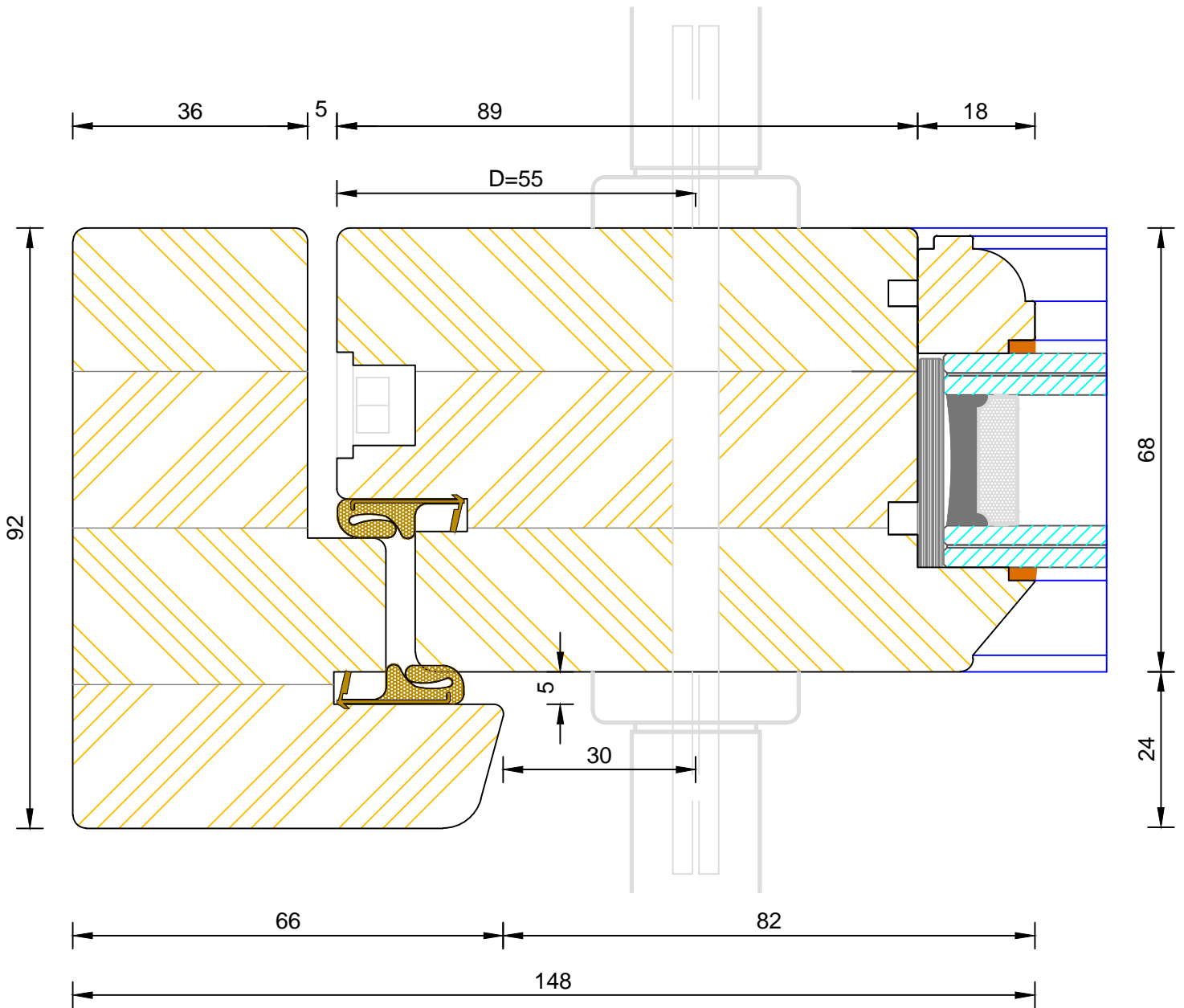

DIMENSIONS	PLOT SIZE	SCALE	DATE	REV	DWG NO.
MM	A4	1:1	08.03.2011	A	<b>2311</b>
Please consider the environment before printing					



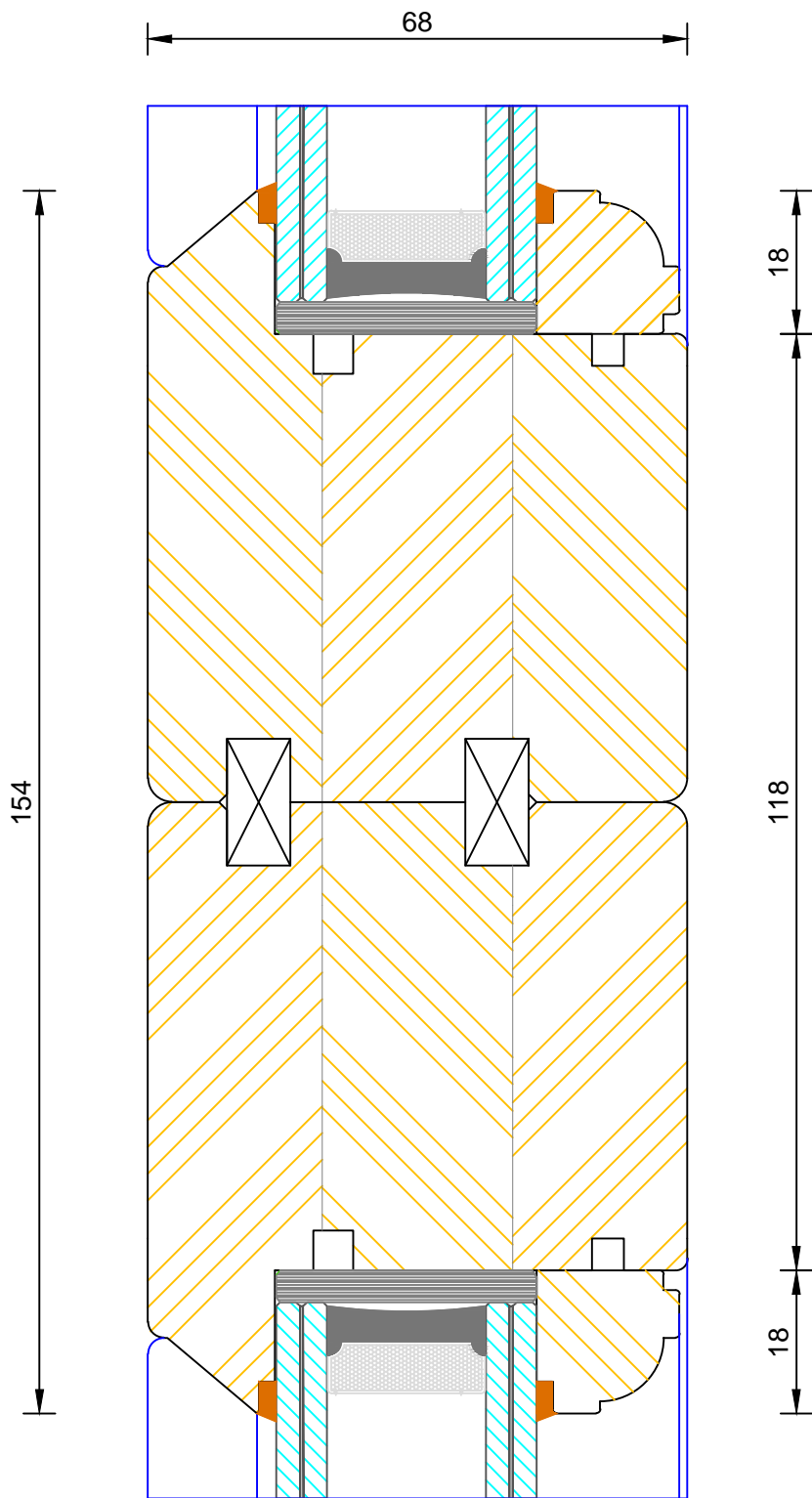
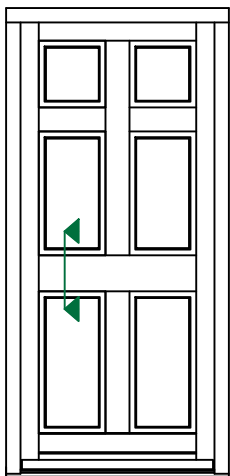

**Traditional Open In Flush Entrance Door  
Mid Rail (Optional 154mm)**

DIMENSIONS	PLOT SIZE	SCALE	DATE	REV	DWG NO.
MM	A4	1:1	08.03.2011	A	<b>2325</b>
Please consider the environment before printing					

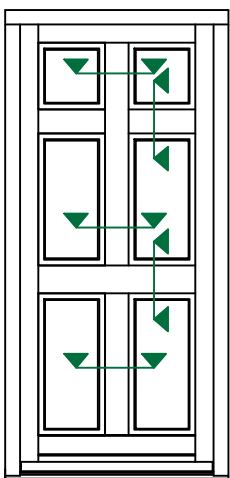
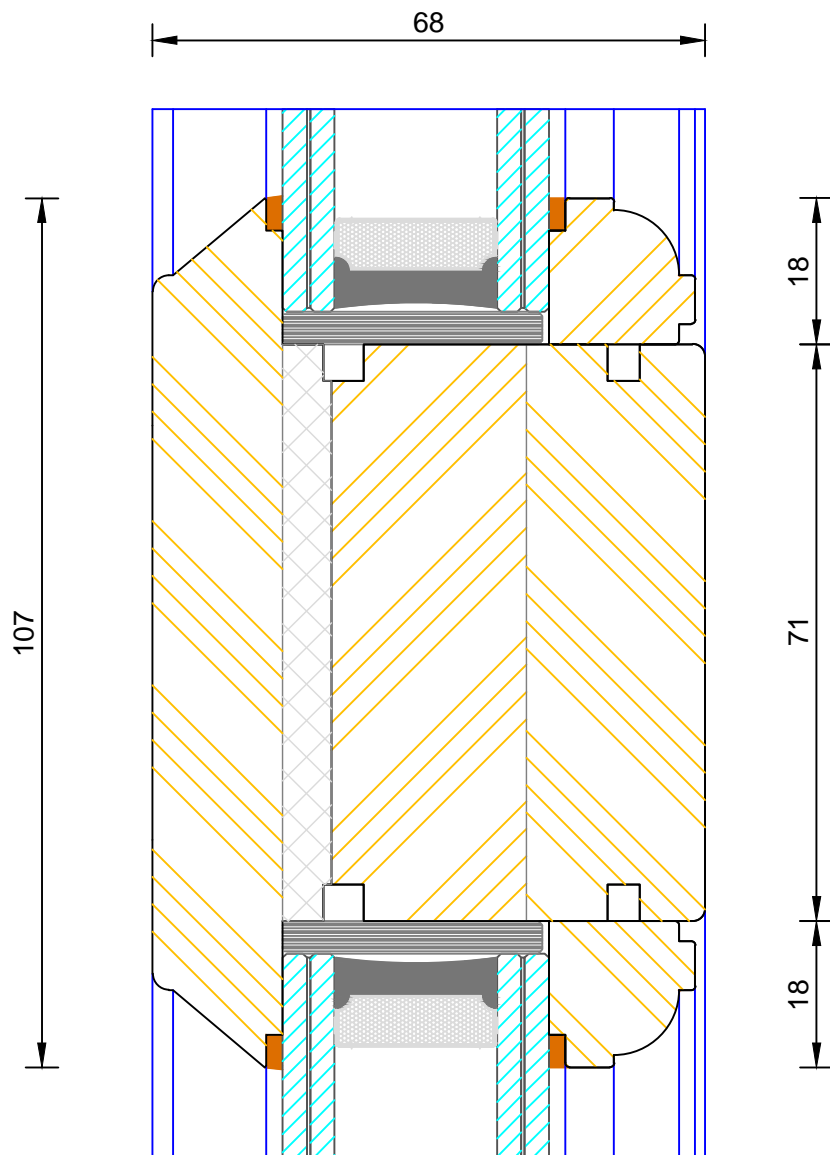

**Traditional Open In Flush Entrance Door  
Mid Rail (107mm)**

DIMENSIONS	PLOT SIZE	SCALE	DATE	REV	DWG NO.
MM	A4	1:1	08.03.2011	A	<b>2315</b>
Please consider the environment before printing					

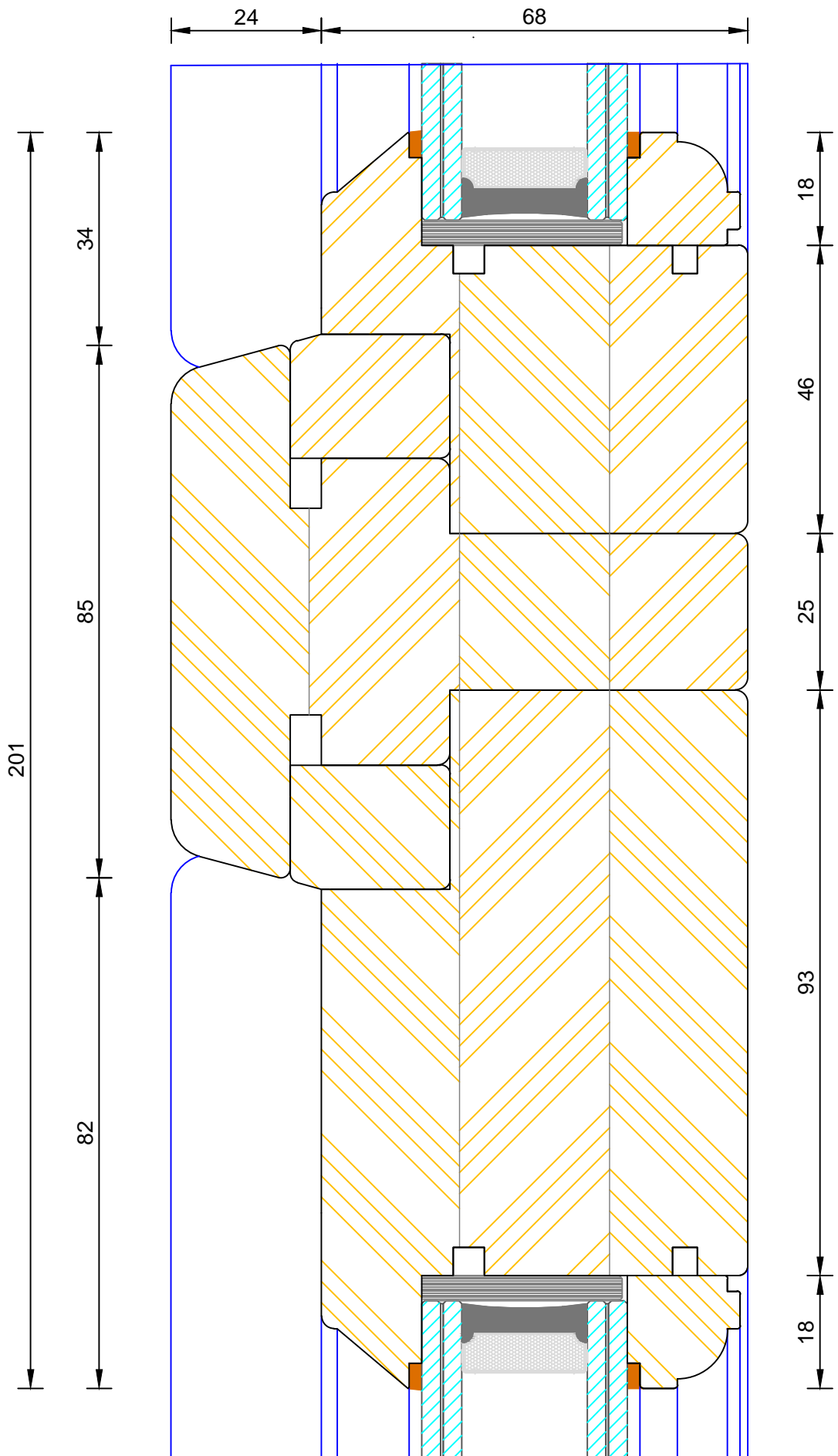
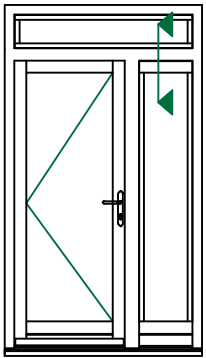

**Traditional Open In Flush Entrance Door  
Solid Transom (Fanlight / Sidelight)**

DIMENSIONS	PLOT SIZE	SCALE	DATE	REV	DWG NO.
MM	A4	1:1	08.03.2011	A	<b>2316</b>

Please consider the environment before printing

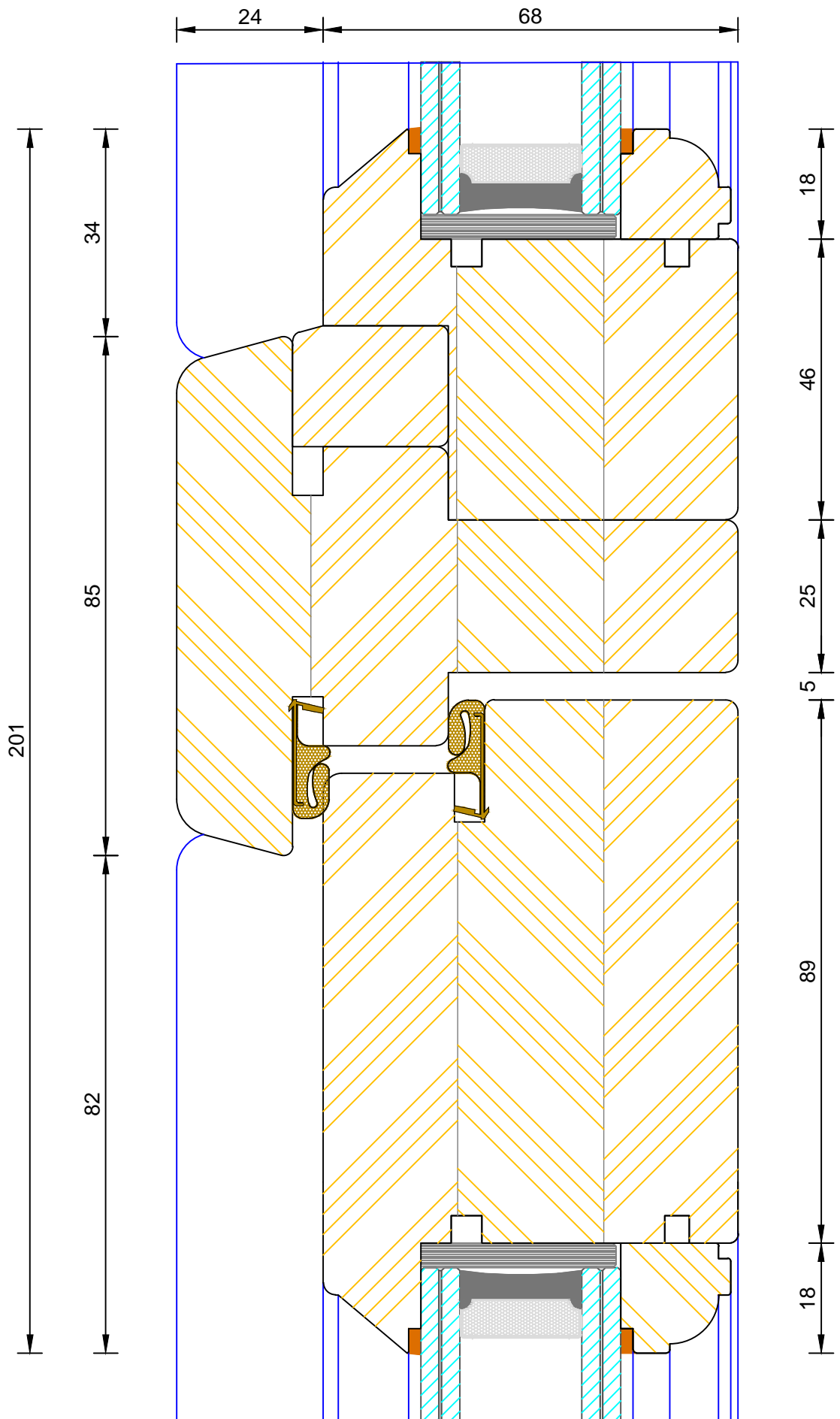
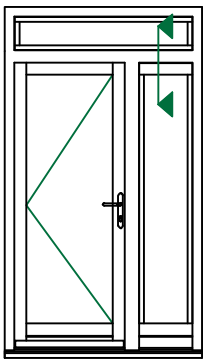

**Traditional Open In Flush Entrance Door**  
**Solid Transom (Fanlight / Door Leaf)**

DIMENSIONS	PLOT SIZE	SCALE	DATE	REV	DWG NO.
MM	A4	1:1	08.03.2011	A	<b>2317</b>

Please consider the environment before printing



# Bereco

## Traditional Open In Flush Entrance Door Solid Mullion (Fixed Light / Fixed Light)

DIMENSIONS	PLOT SIZE	SCALE	DATE	REV	DWG. NO.
MM	A4	1:1	08.03.2011	A	2318

Please consider the environment before printing

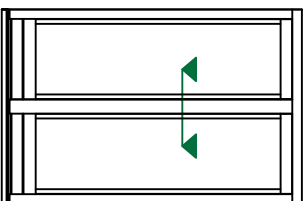
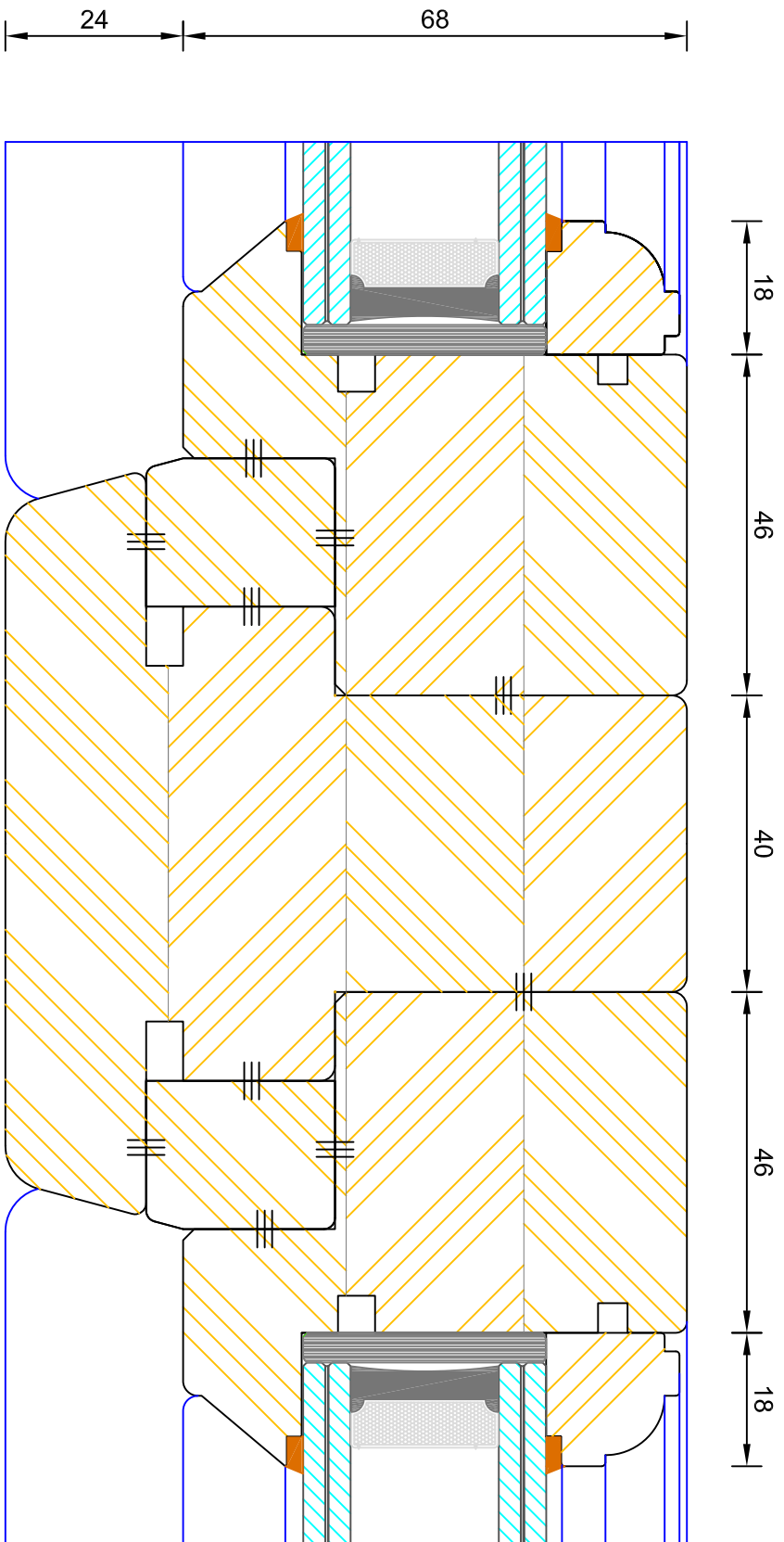

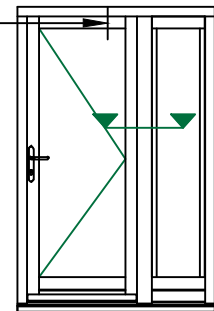
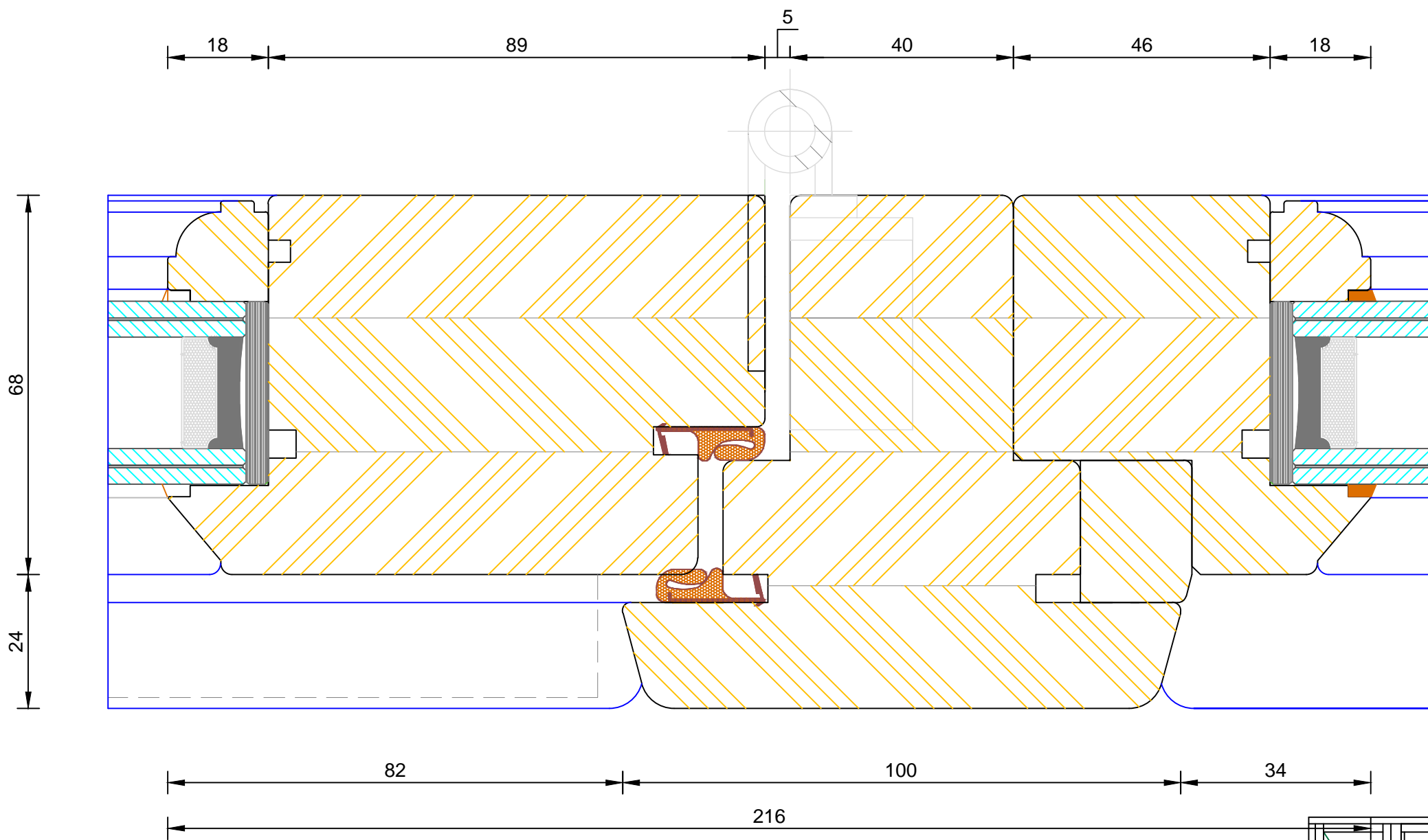

**Traditional Open In Flush Entrance Door  
Solid Mullion (Leaf / Side Light)**

DIMENSIONS	PLOT SIZE	SCALE	DATE	REV	DWG NO.
MM	A4	1:1	08.03.2011	A	<b>2319</b>
Please consider the environment before printing					

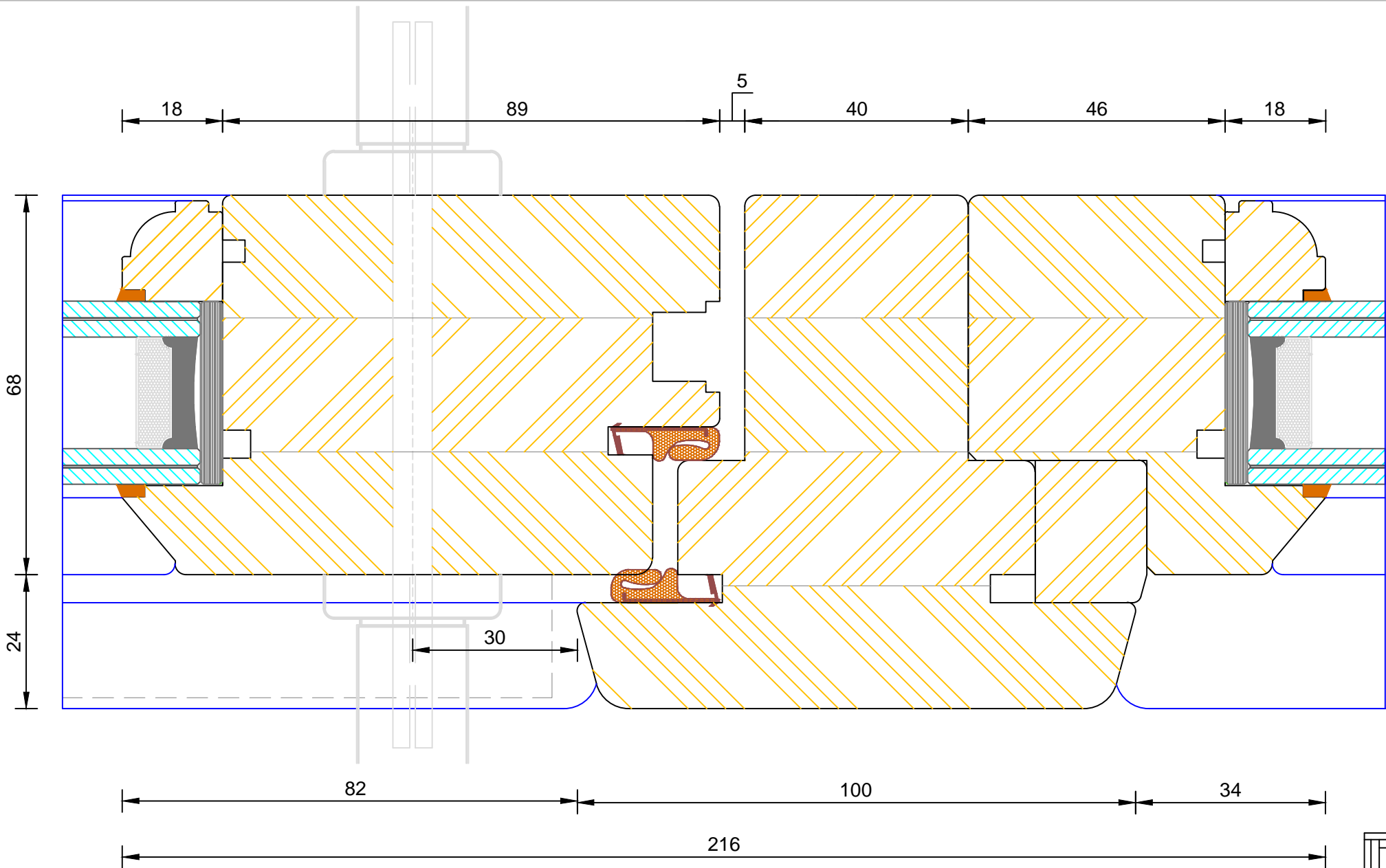

**Traditional Open In Flush Entrance Door  
Solid Mullion (Leaf / Side Light)**

DIMENSIONS	PLOT SIZE	SCALE	DATE	REV	DWG NO.
MM	A4	1:1	08.03.2011	A	<b>2320</b>
Please consider the environment before printing					

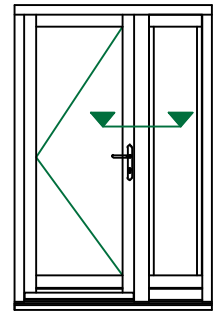

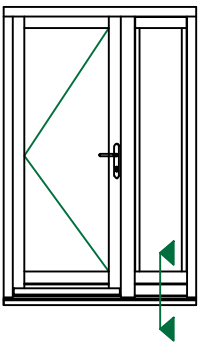
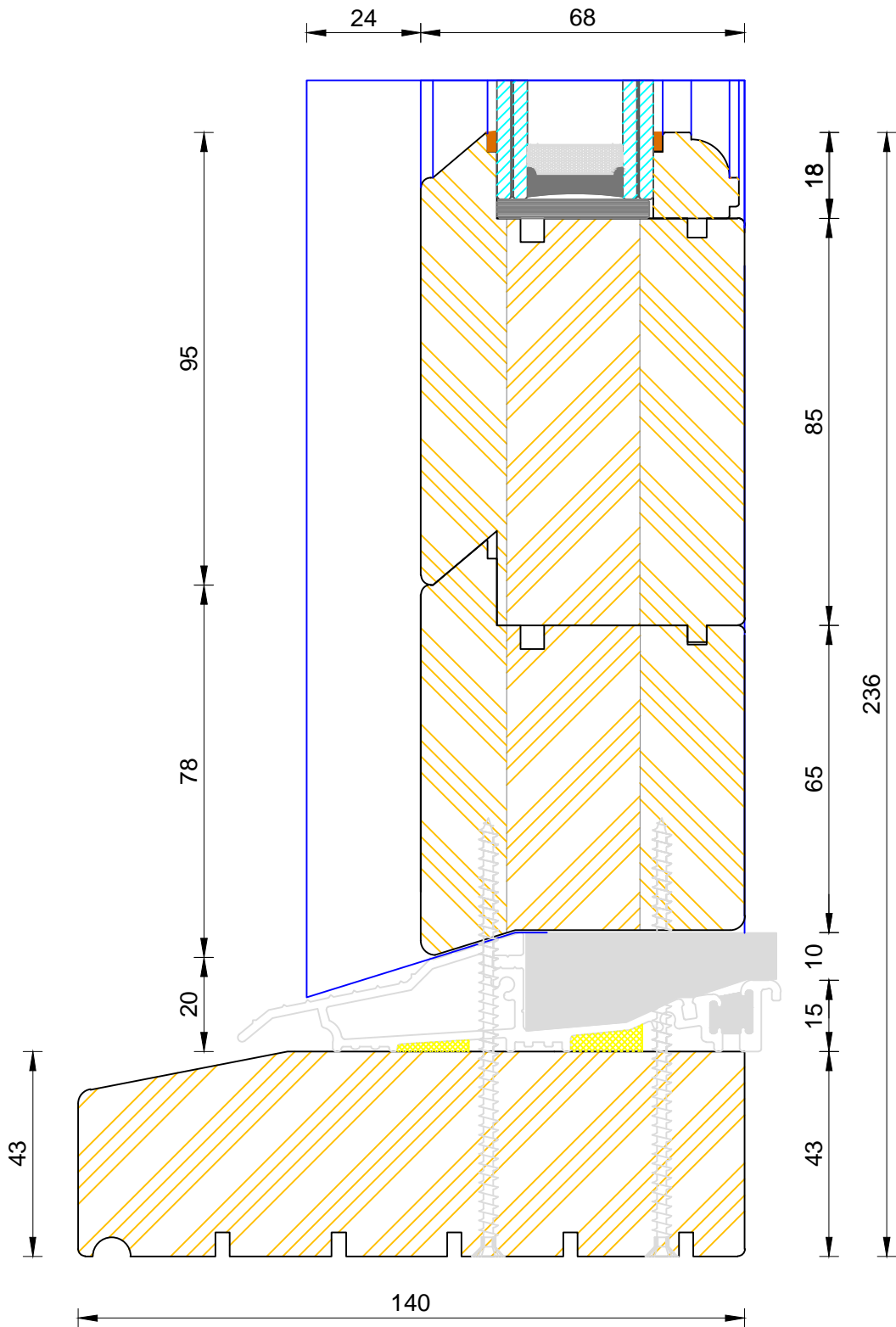

If not otherwise stated, Hardwood Threshold will be stained 5064 Walnut.



**Traditional Open In Flush Entrance Door  
Standard Thresh (Sidelight)**

DIMENSIONS	PLOT SIZE	SCALE	DATE	REV	DWG NO.
MM	A3	1:1	08.03.2011	A	<b>2306</b>
Please consider the environment before printing					



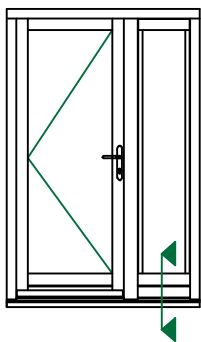
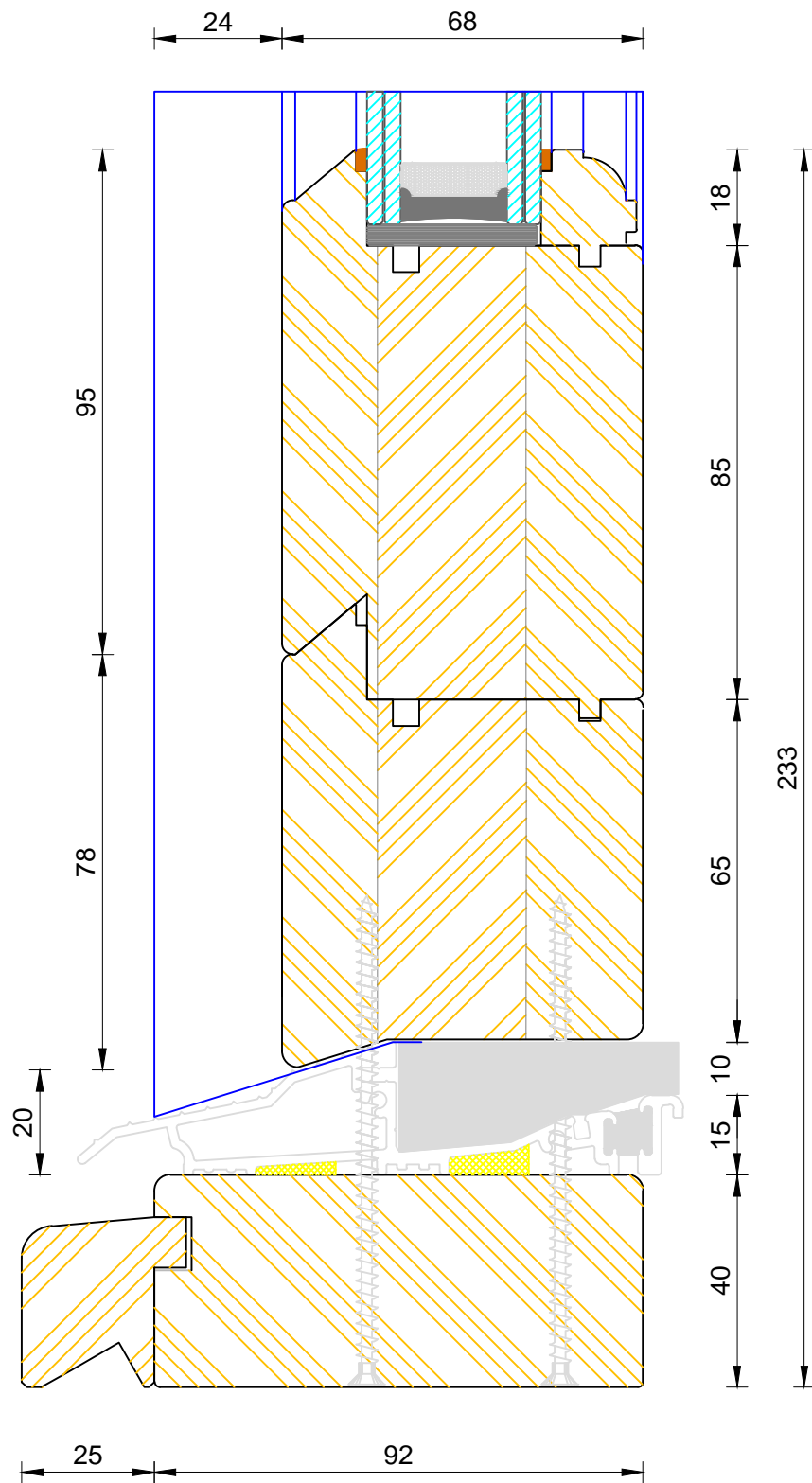

CILL EXTENSION - available options: 25mm (117mm o/a) / 47mm (139mm o/a) / 62mm (154mm o/a) / 87mm (179mm o/a) / 114mm (206mm o/a) / 125mm (217mm o/a) / 140mm (232mm o/a)

NOTE: Cill Extensions should be supported from underneath; the maximum overhang over Brick / Blockwork for cill extension should not exceed 25mm in order to avoid damage when stepped on. Warranties are invalidated when fitted with overhang in excess to that.

If not otherwise stated, Hardwood Threshold will be painted the same colour as Frame.



### Traditional Open In Flush Entrance Door Coupling Thresh (Sidelight)

DIMENSIONS	PLOT SIZE	SCALE	DATE	REV	DWG NO.
MM	A3	1:1	08.03.2011	A	<b>2307</b>
Please consider the environment before printing					

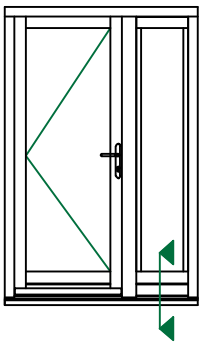
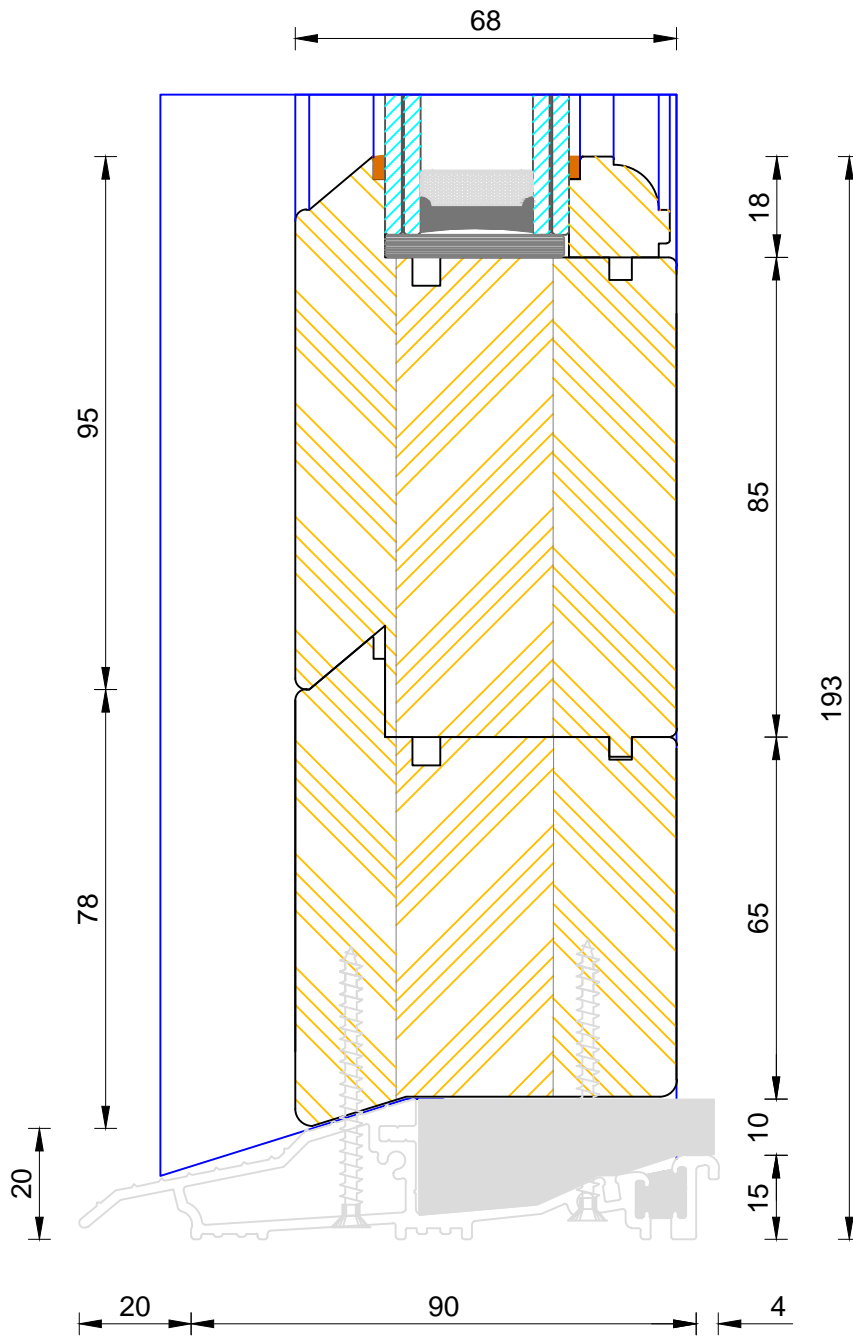

**Traditional Open In Flush Entrance Door  
Mobility Thresh (Sidelight)**

DIMENSIONS	PLOT SIZE	SCALE	DATE	REV	DWG NO.
MM	A3	1:1	08.03.2011	A	<b>2308</b>

Please consider the environment before printing

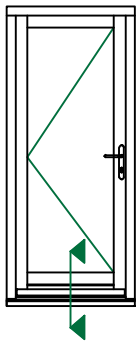
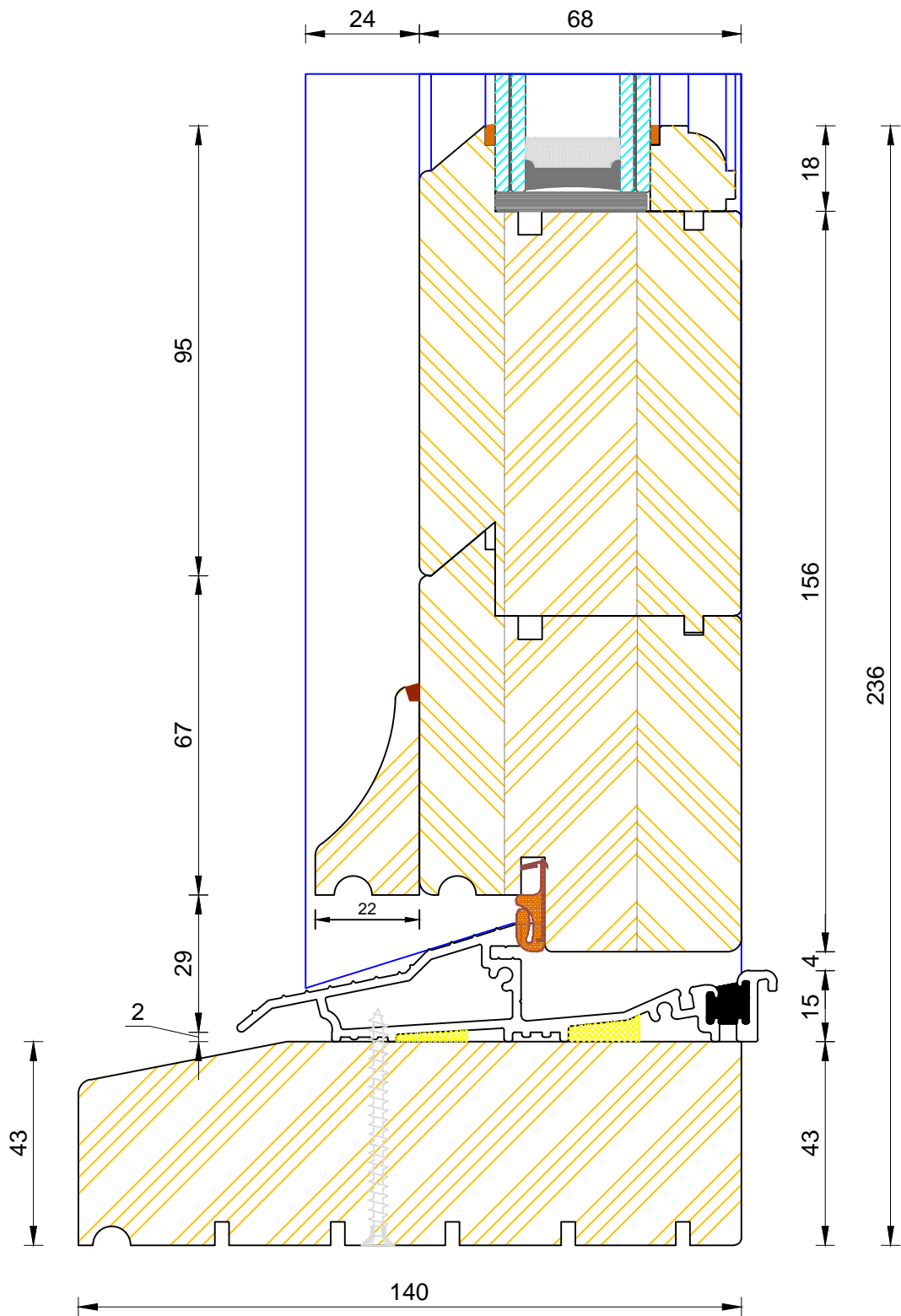

If not otherwise stated, Hardwood Threshold will be stained 5064 Walnut.

### Traditional Open In Flush Entrance Door Standard Thresh (140x43mm)

DIMENSIONS	PLOT SIZE	SCALE	DATE	REV	DWG NO.
MM	A3	1:1	08.03.2011	A	<b>2312</b>
Please consider the environment before printing					

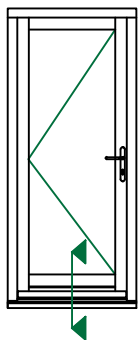
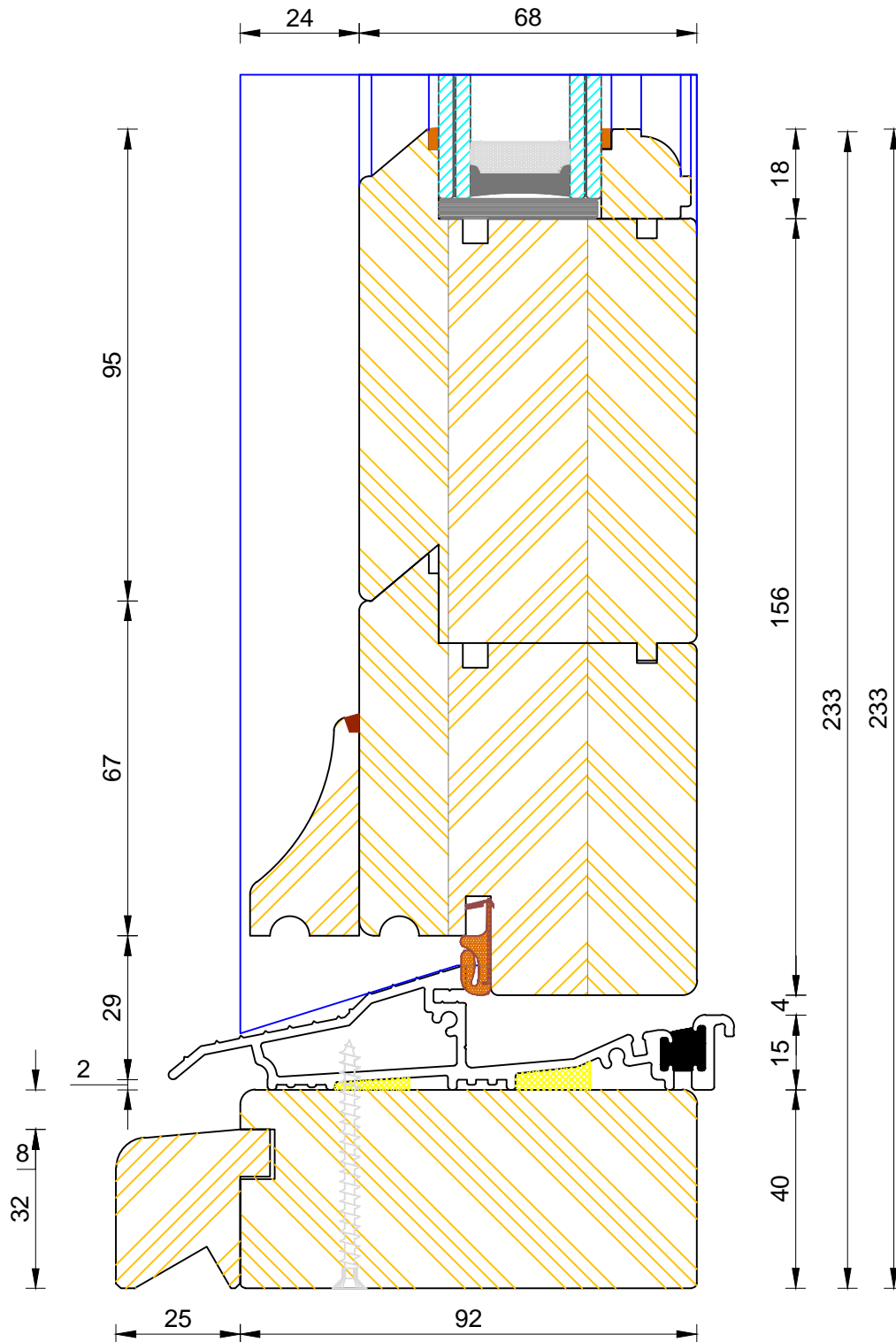

CILL EXTENSION - available options: 25mm (117mm o/a) / 47mm (139mm o/a) / 62mm (154mm o/a) / 87mm (179mm o/a) / 114mm (206mm o/a) / 125mm (217mm o/a) / 140mm (232mm o/a)

NOTE: Cill Extensions should be supported from underneath; the maximum overhang over Brick / Blockwork for cill extension should not exceed 25mm in order to avoid damage when stepped on. Warranties are invalidated when fitted with overhang in excess to that.

If not otherwise stated, Hardwood Threshold will be painted the same colour as Frame.

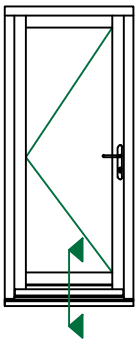
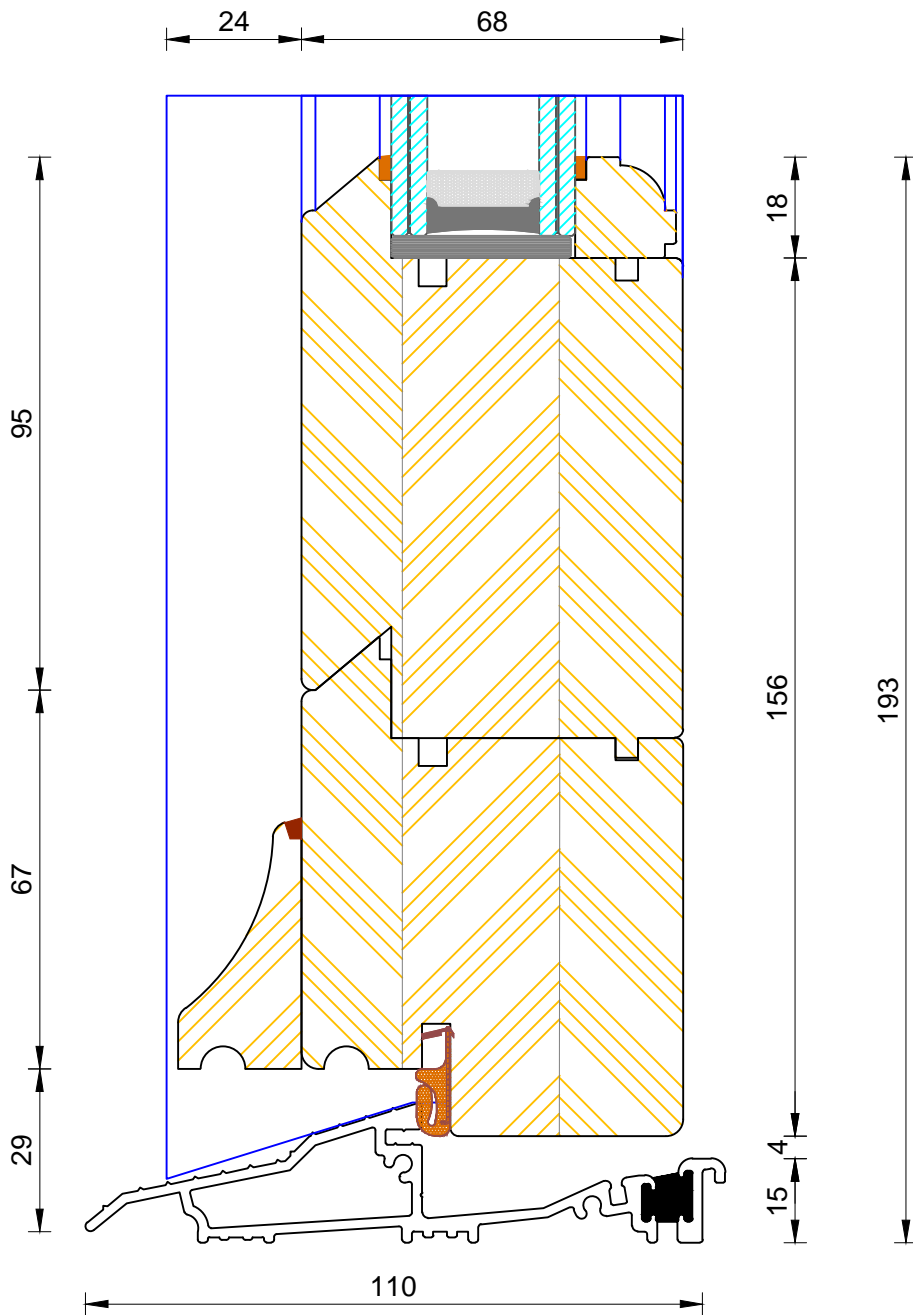

**Traditional Open In Flush Entrance Door  
Mobility Thresh**

DIMENSIONS	PLOT SIZE	SCALE	DATE	REV	DWG NO.
MM	A3	1:1	08.03.2011	A	<b>2314</b>
Please consider the environment before printing					