

SOUND RESISTANT WALL DETAIL

DETAIL A

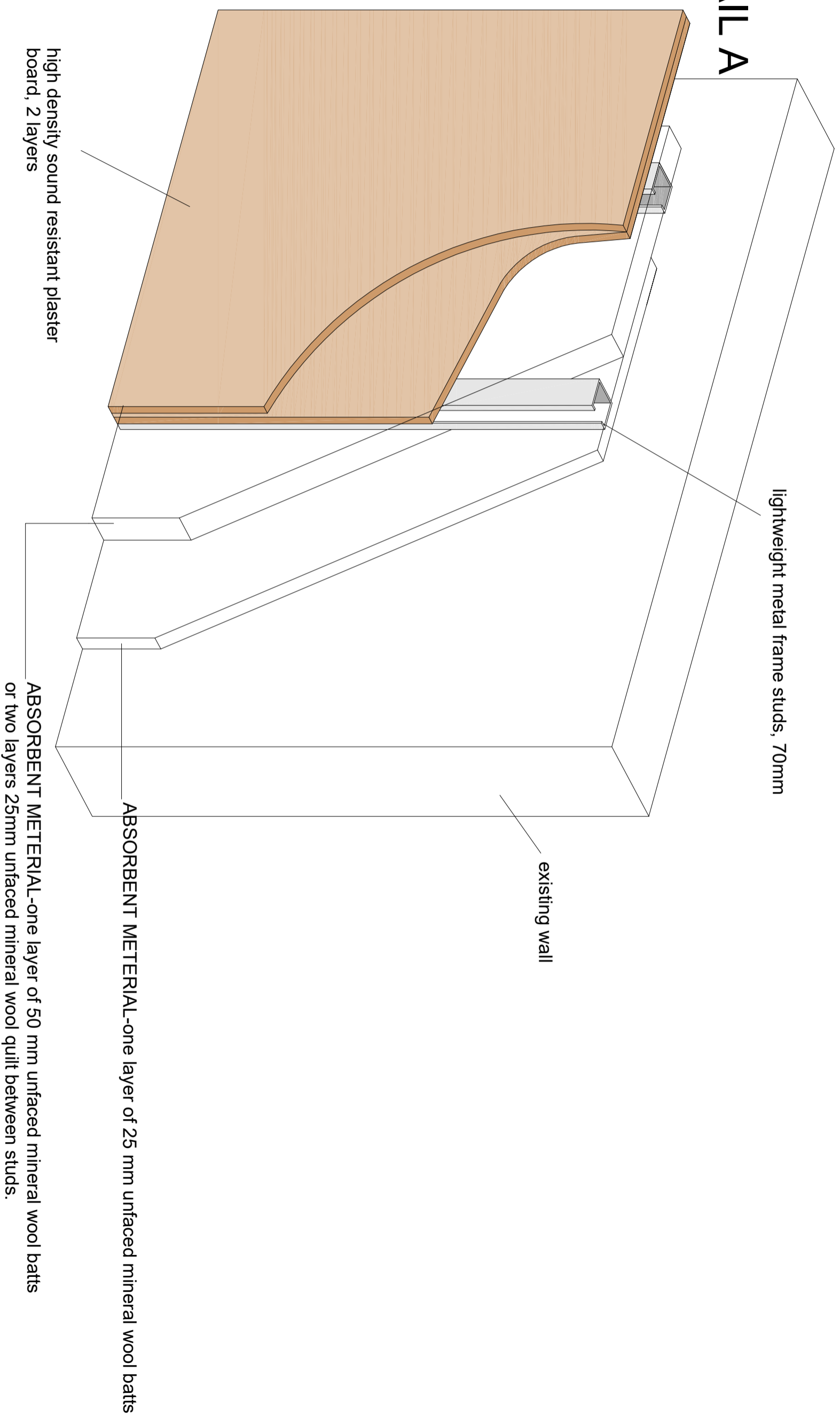

TITLE PROPOSED DRAWINGS ADDRESS FLAT 10, CHURCH STUDIOS, 49-51 CAMDEN PARK ROAD
LONDON NW1

CLIENT RAINBOW PROPERTIES LTD SCALE 1:100 @ A3 DATE MAY 2019

DRAWING NO. 190510/10 REV.